



# INSTRUCTION BULLETIN

No. 340068  
Machine: 6080/3640  
Published: 9-99/01  
System: SWEEPING

**NOTE: DO NOT DISCARD the Parts List from the Instruction Bulletin. Place the Parts List in the appropriate place in your machine manual for future reference. Retaining the Parts List will make it easier to reorder individual parts and will save you the cost of ordering an entire kit.**

*NOTE: Numbers in parenthesis ( ) are reference numbers for parts listed in Bill of Materials.*

Installation Instructions for Kit number 80302

## SYNOPSIS / PROBLEM:

This kit contains the parts needed to install a new side brush lift cable on the model 6080 and 3640 sweepers. Please follow step-by-step instructions.

## SPECIAL TOOLS / CONSIDERATIONS: None

(Estimated time to complete: 2 hour)

## INSTALLATION:

(Refer to FIG. 1, 2 and 3)

**FOR SAFETY: Before leaving or servicing machine, stop on level surface and set parking brake. Then turn off machine and remove key.**

1. Remove the filter cover from the rear of the machine. Remove the handle stop bracket from the upper/left side of the filter compartment. (Refer to FIG. 1)
2. Pull up on the two handle locks and move the handle assembly to its lowest position. (Refer to FIG. 3)

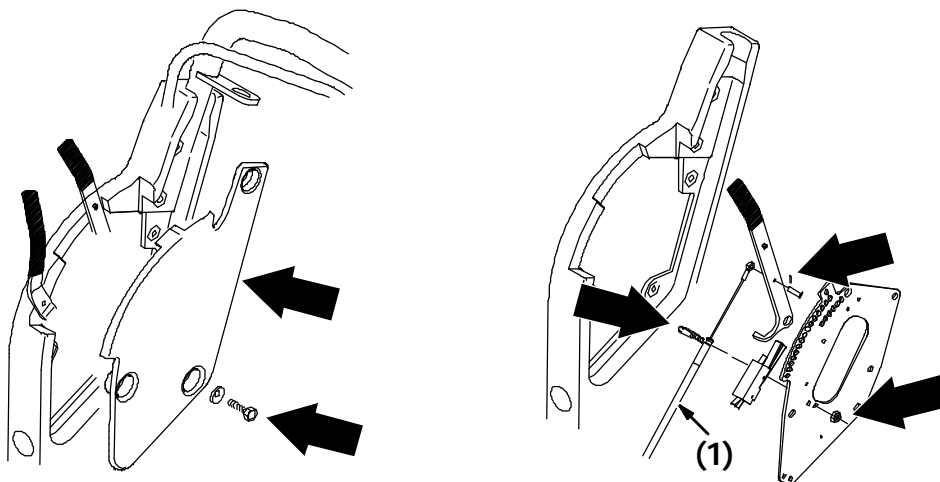

**FIG. 1 - Cover Plate And Handle**

3. Remove the three hex screws holding the cover plate to the inside of the right side handle tower. Remove the cover plate from the machine. (Refer to FIG. 1)
4. Remove the bolt holding the pivot plate to the plastic side arm. This will allow the plate and handle assembly to be pulled away from the plastic arm for easy access. (Refer to FIG. 1)

5. Remove the cotter pin and clevis pin from the end of the side brush lift cable where it attaches to the side brush lift lever. (Refer to FIG. 1)
6. Remove the nut from the clamp holding the side brush cable to the mount plate. (Refer to FIG. 1)
7. Remove the debris hopper from the machine.
8. Locate the side brush lower mount bracket on the right side of the frame, near the right front caster. (Refer to FIG. 2)
9. Remove the two hex screws holding the side brush lower mount bracket to the machine frame. (Refer to FIG. 2)

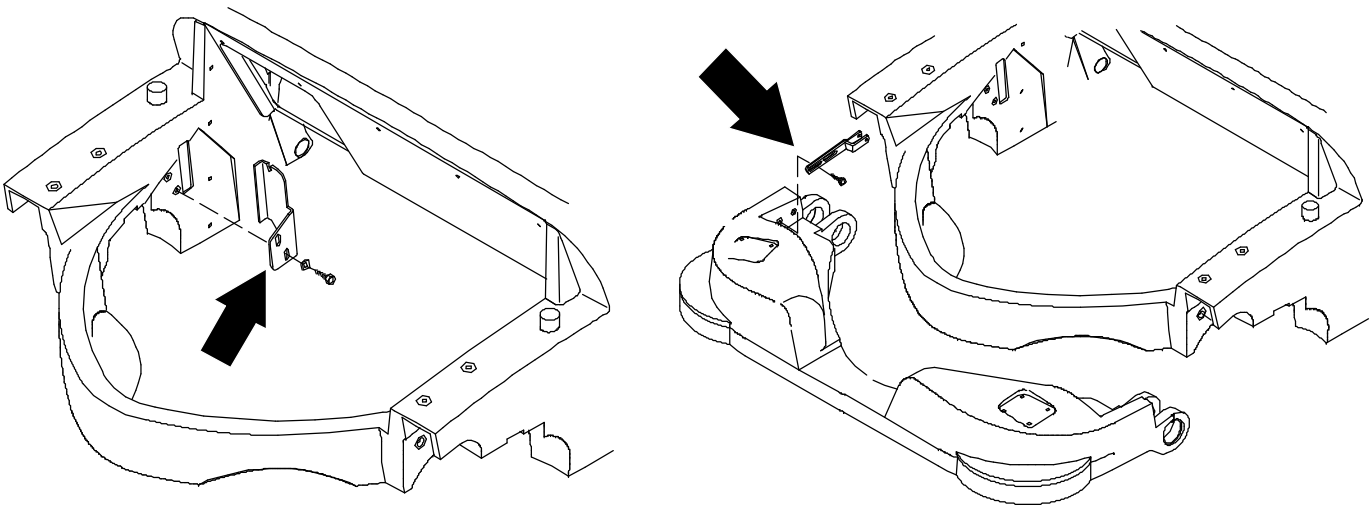

**FIG. 2 - Side Brush Bracket And Cable**

10. Pull the mount bracket out of the hole in the frame. Pull the side brush cable out of mount slot. (Refer to FIG. 2)
11. Remove the two hex screws holding the side brush lift cable spring assembly to the right side of the machine frame, out near the right side brush. (Refer to FIG. 2)
12. Pull the spring and cable assembly out of the machine frame. (Refer to FIG. 3)
13. Remove the clevis pin holding the side brush lift cable to the spring assembly. Remove the side brush lift cable from the spring assembly. (Refer to FIG. 3)
14. Route the new lift cable (1) down the handle assembly, thru the hole in the handle, into the hole in the main frame, and down to the right side of the frame. Next, reach in the frame hole and grab the cable.

***NOTE: Add the cable tie (2) around the new side brush cable (1) and the existing stiff main brush lift cable. This will prevent the new side brush lift cable from drooping down and rubbing on the brush drive pulley.***

15. Reconnect the cable to the side brush spring assembly. Reinstall the spring assembly on the frame. Tighten the two hex screws to 7.6 - 9.9 Nm (6 - 8 ft lb). (Refer to FIG. 3)
16. Position the side brush lift cable in the slot on the lower mount bracket. Reinstall the lower mount bracket in the machine. Tighten the two hex screws to 8 - 24 Nm (15 - 20 ft lb). (Refer to FIG. 2)

17. Go up to the main brush lift lever and install the nut on the main brush lift cable mount clamp. Tighten the nut to 7.6 – 9.9 Nm (6 – 8 ft lb). (Refer to FIG. 1)
18. Install the clevis pin and cotter pin in the end of the new cable where it attaches to the main brush lift lever. (Refer to FIG. 1)
19. Reinstall the right side handle assembly cover plate. Tighten the three hex screws to 18 – 24 Nm (15 – 20 ft lb). (Refer to FIG. 1)

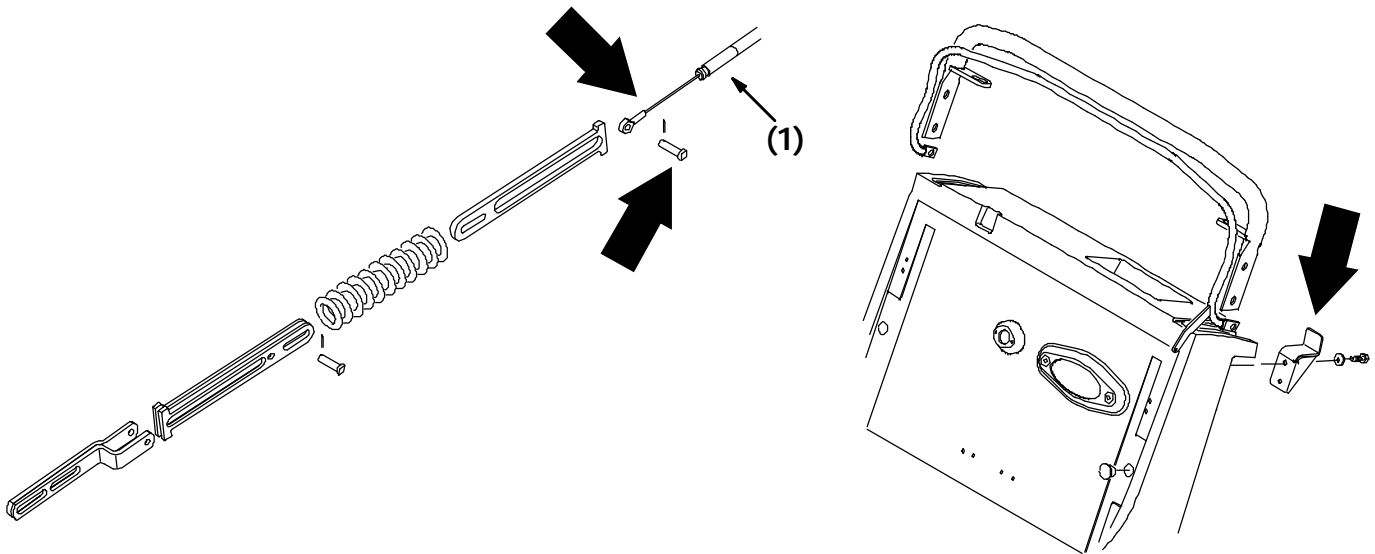

**FIG. 3 - Cable Assembly And Stop Bracket**

20. Move the handle assembly up to one of the four adjustment holes.
21. Reinstall the filter cover and the handle stop bracket. (Refer to FIG. 3)
22. Reinstall the hopper.
23. Start the machine and check the side brush lift cable for proper operation.
24. Close the machine cover.

**BILL OF MATERIALS FOR SIDE BRUSH CABLE KIT 80302**

Ref.	TENNANT Part No.	Description	Qty.
1	80191	Side brush cable	1
2	49266	Cable tie	1

TENNANT COMPANY  
P. O. Box 1452  
Minneapolis, MN 55440-1452