

# Technical Service Bulletin

**MODEL(S) T7 AMR Autonomous Rider Scrubber**
**AFFECTED:** Models manufactured before serial number 10981578 (April 3, 2020)

**SUBJECT:** Off-board charger interlock switch failure (i.e. damaged or loss of adjustment). The failure may occur if the charger connector is roughly connected or disconnected to and from machine. Switch failure will prevent machine from powering up.

**PURPOSE:** To prevent potential interlock switch failure, install Replacement Switch Kit 9020923. The kit includes a guide connector bracket to protect switch from failure as shown below.

**NOTES:** **Warranty Information:** Standard warranty terms apply. All machines manufactured after April 3, 2020 are equipped with the guide connector bracket.

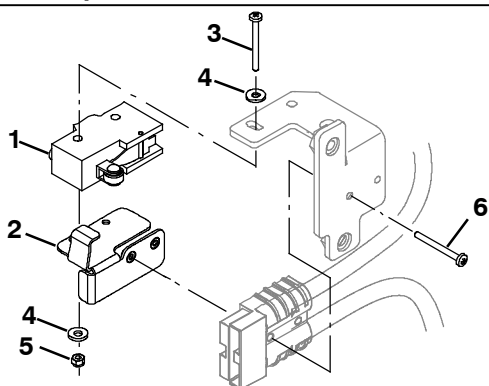
**9020923 Replacement Switch Kit Contents**

Ref.	Part No.	Description	Qty.
1	1244049	Switch, Snap, RLR (Interlock)	1
2	1251809	Bracket Assy, Guide, Connector	1
3	06930	Screw, Pan, Phl, M4 x 0.70 x 30, 4.8	2
4	19065	Washer, Flat, 0.19B 0.44D .05, PL 08	4
5	33932	Nut, Hex, Lock, M4 x 0.70, NL, SS	2
6	25005	Screw, Pan, Phl, 06-32 x 1.00, G1	2

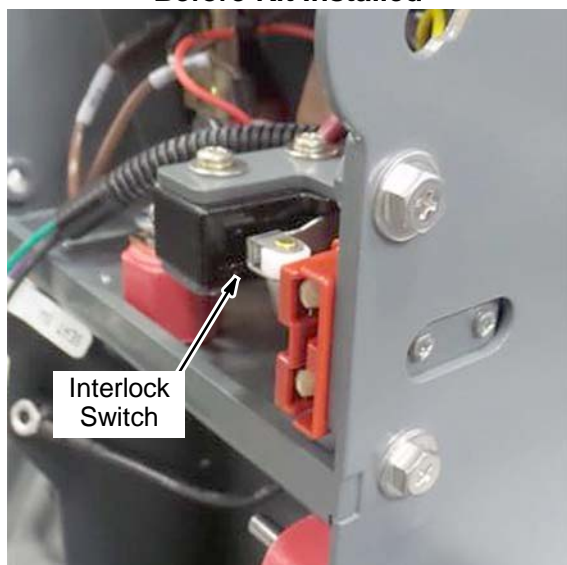
**Before Kit Installed**

**After Kit Installed**
