

# Technical Service Bulletin

**MODEL(S) AFFECTED: T500/T500e Walk-behind Scrubber**

N. America and APAC models manufactured before May 11, 2017  
EMEA models manufactured before serial number T500-U10117 (May 15, 2017)

**SUBJECT:** Potential drive wheel mounting hardware issue. The axle nut may back off and cause the wheel to become loose and possibly damage wheel and axle.

**PURPOSE:** To prevent axle nut from backing off, install improved hardware listed below.

**NOTES:** **Warranty Information:** When servicing machine on a non-related issue, replace the wheel mounting hardware accordingly. Standard warranty terms apply.

Ref.	Part No.	Description
1	09741	Nut, Hex, Lock, M12 x 1.75, NL, SS
2	140058	Washer, Flat, 0.54b 0.88d .06, SS

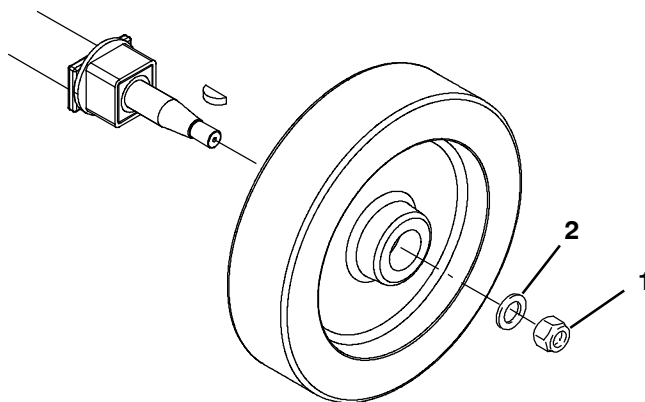

Maximum torque 24 Nm/18 ft-lbs. Do not over tighten nut. Higher torques will deform the center of the wheel, compromising the conical fit to the transaxle.