



INSTRUCTION BULLETIN

No. 3778
Machine: 426
Published: 1-96/00
System: SCRUBBING

NOTE: DO NOT DISCARD the Parts List from the Instruction Bulletin. Place the Parts List in the appropriate place in your machine manual for future reference. Retaining the Parts List will make it easier to reorder individual parts and will save you the cost of ordering an entire kit.

NOTE: Numbers in parenthesis () are reference numbers for parts listed in Bill of Materials.

Installation Instructions for Kit number 78584

SYNOPSIS / PROBLEM:

This kit contains the parts needed to replace the rear squeegee assembly on the model 426 walk behind scrubber. Please follow step-by-step instructions.

SPECIAL TOOLS / CONSIDERATIONS: None

(Estimated Time to complete: 1 hour)

PREPARATION:

(Refer to FIG. 1)

FOR SAFETY: Before leaving or servicing machine, stop on level surface and set parking brake. Then turn off machine and remove key.

1. Remove the hair pin holding the squeegee bracket and squeegee assembly to the back of the machine. Remove the bracket and squeegee assembly from the machine.
(Refer to FIG. 1)
2. Remove the two hex screws holding the squeegee bracket to the squeegee frame. Remove and retain the squeegee bracket. Discard the rest of the old squeegee assembly parts. (Refer to FIG. 1)

TO INSTALL SQUEEGEE ASSEMBLY:

(Refer to FIG. 1)

1. Install the old squeegee mount bracket on the top of the new squeegee assembly. Using the wing screw (17), adjustable washer (16), and flat washer (18).
Firmly tighten the hardware. (Refer to FIG. 1)
2. Reinstall the new squeegee assembly on the back of the machine. Reinstall the hair pin in the shaft on the squeegee mount bracket. (Refer to FIG. 1)
3. Operate the machine and check the squeegee for proper operation. (Refer to FIG. 1)

NOTE: Order replacement parts from the new bill of material on page 3. Discard the parts list in the machine manual.

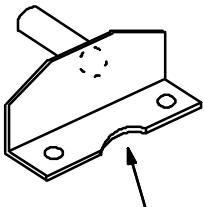

Remove and retain
this squeegee bracket (89212)

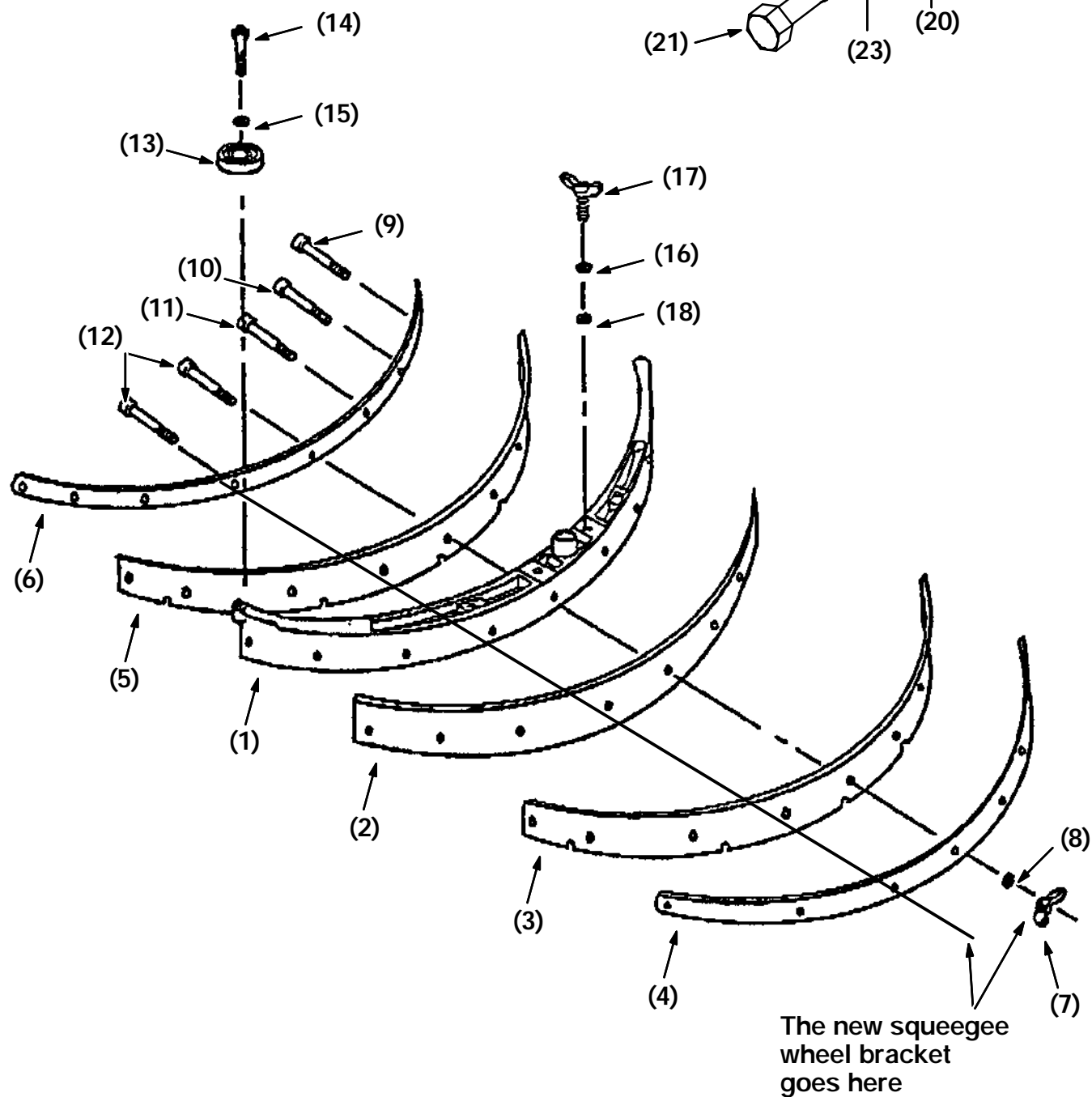
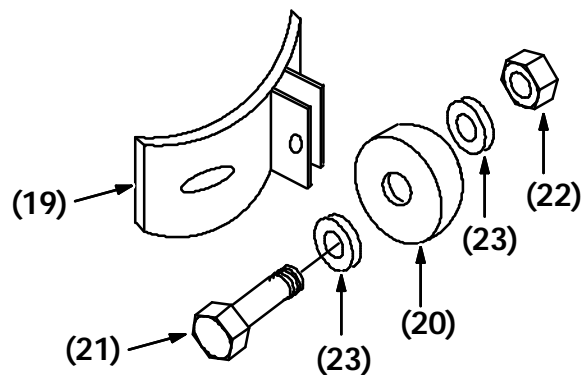

FIG. 1 - New Rear Squeegee Assembly

BILL OF MATERIALS FOR REAR SQUEEGEE ASSEMBLY 78584

Ref.	TENNANT Part No.	Description	Qty.
1	78586	Squeegee frame	1
2	89031	Rear squeegee blade	1
3	89035	Rear squeegee blade backup strip	1
4	78587	Rear squeegee blade retainer band	1
5	89034	Front squeegee blade	1
6	78588	Front squeegee blade retainer band	1
7	31703	Wing nut	8
8	78589	Flat washer, 9MM	8
9	612184	Carriage bolt, 1-1/2 in.	2
10	612185	Carriage bolt, 2 in.	2
11	612186	Carriage bolt, 2-1/2 in.	2
12	612187	Carriage bolt, 3 in.	2
13	630450	Rubber wheel	2
14	39251	5/16 in. hex screw	2
15	01684	Flat washer, 1/4 in.	2
16	78595	Adjustable washer	2
17	78596	Wing screw. 1/2 in.	2
18	41619	Flat washer, 1/2 in.	2
19	600184	Squeegee wheel bracket	1
20	630477	Squeegee wheel, 2 in.	1
21	600187	Shoulder screw, 3/8 in.	1
22	59165	3/8 in. nyloc nut	1
23	01686	Flat washer, 3/8 in.	2

TENNANT COMPANY
P. O. Box 1452
Minneapolis, MN 55440-1452