



INSTRUCTION BULLETIN

No. 3766
Machine: 830
Published: 12-95/00
System: SWEEPING

NOTE: DO NOT DISCARD the Parts List from the Instruction Bulletin. Place the Parts List in the appropriate place in your machine manual for future reference. Retaining the Parts List will make it easier to reorder individual parts and will save you the cost of ordering an entire kit.

NOTE: Numbers in parenthesis () are reference numbers for parts listed in Bill of Materials.

Installation Instructions for Kit number 761501

SYNOPSIS / PROBLEM:

This kit contains two lifting brackets needed to remove the filter bag assembly from the model 830 sweeper. Please follow step-by-step instructions.

SPECIAL TOOLS / CONSIDERATIONS: Overhead hoist or lifting device

(Estimated Time to complete: 1 hour)

TO REMOVE HOPPER FILTER BAG:

(Refer to FIG. 1)

FOR SAFETY: Before leaving or servicing machine, stop on level surface and set parking brake. Then turn off machine and remove key.

1. Remove the four M10 nyloc nuts and washers holding the filter bag cover to the hopper. (Refer to FIG. 1)
2. Lift the the filter bag cover off the machine. (Refer to FIG. 1)
3. Remove the six M8 nyloc nuts and washers holding the two long and three short filter brackets to the hopper frame. (Refer to FIG. 1)
4. Insert the two lifting brackets (1) in the first envelope on both the front and rear of the filter frame. The lifting brackets (1) are first placed in the horizontal position, then pulled up vertical. *Make sure the lifting brackets are centered on the frame.* Attach a chain or lifting strap in the holes in the lifting brackets. (Refer to FIG. 1)

*NOTE: A clean filter bag weighs **150 lbs.** -- a dirty filter bag may weigh up to **500 lbs.***

5. Lift the filter shaker frame and filter out of the hopper. (Refer to FIG. 1)

TO INSTALL HOPPER FILTER BAG:

(Refer to FIG. 1)

1. Reinstall the filter shaker frame and filter back in the hopper. (Refer to FIG. 1)
2. Remove both lifting brackets (1). (Refer to FIG. 1)
3. Reinstall the six M8 nyloc nuts and washers. Tighten to 18 - 24 Nm (15 - 20 ft lb). (Refer to FIG. 1)
4. Reinstall the filter bag cover and four M10 nyloc nuts and washers. Tighten to 37 - 48 Nm (26 - 34 ft lb). (Refer to FIG. 1)

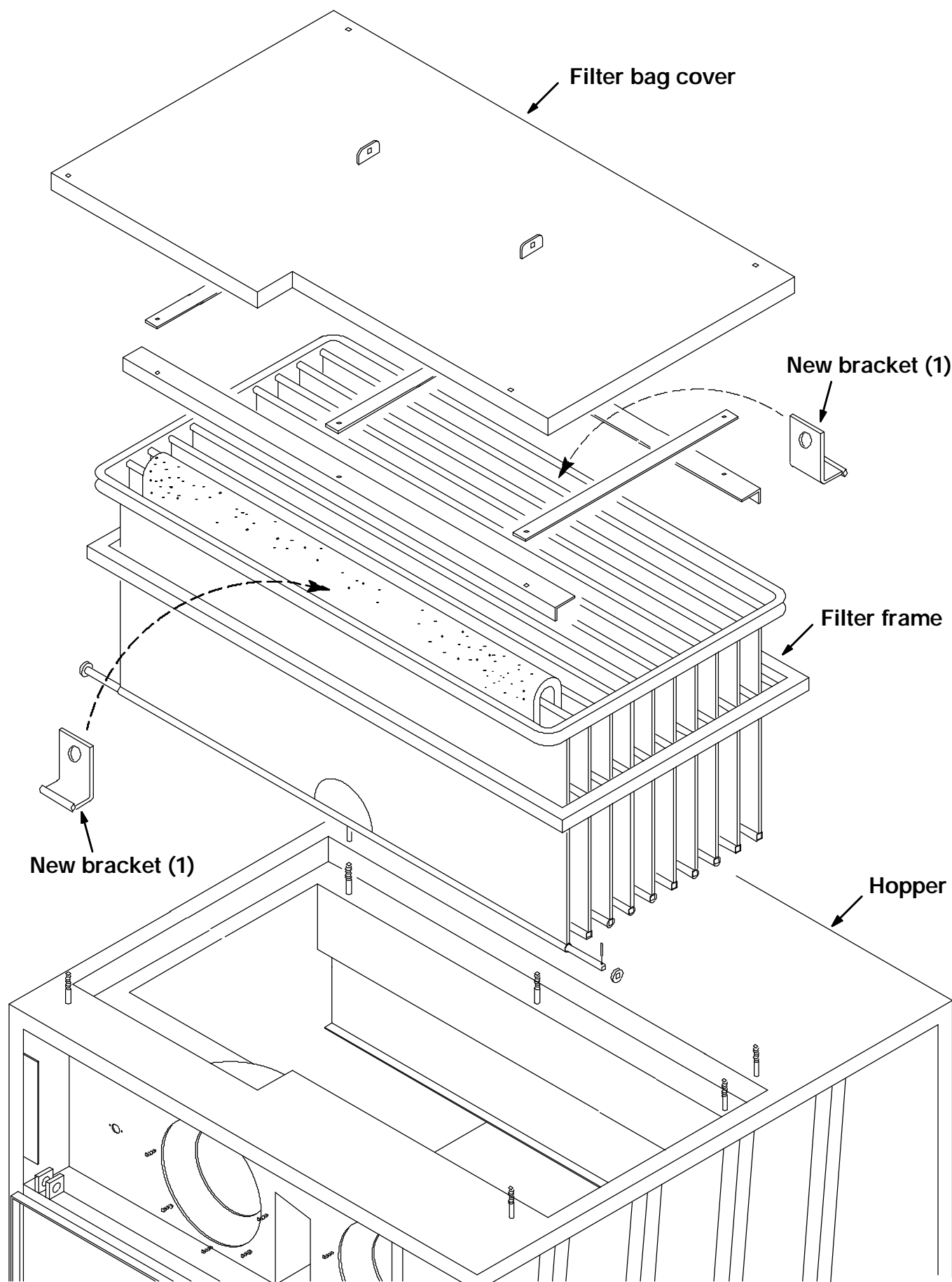

FIG. 1 - Filter Bag Assembly

BILL OF MATERIALS FOR FILTER BAG LIFT KIT 761501

Ref.	TENNANT Part No.	Description	Qty.
1	761791	Angle weldment	2

TENNANT COMPANY
P. O. Box 1452
Minneapolis, MN 55440-1452