



INSTRUCTION BULLETIN

No. 3762
Machine: 8400 LPG
Published: 1-96/00
System: ENGINE

NOTE: DO NOT DISCARD the Parts List from the Instruction Bulletin. Place the Parts List in the appropriate place in your machine manual for future reference. Retaining the Parts List will make it easier to reorder individual parts and will save you the cost of ordering an entire kit.

NOTE: Numbers in parenthesis () are reference numbers for parts listed in Bill of Materials.

Installation Instructions for Kit number 84630

SYNOPSIS / PROBLEM:

This kit contains the parts needed to replace the engine LP hose on the model 8400 LP machine. The engine may now bog down with the factory installed hose. The new hose will eliminate this problem. Please follow step-by-step instructions.

SPECIAL TOOLS / CONSIDERATIONS: None (Estimated Time to complete: 1 hour)

PREPARATION:

(Refer to FIG. 1)

1. Close the valve on the LP tank and start the engine. Run the engine until all the LP gas has been run out of the lines.

FOR SAFETY: Before leaving or servicing machine, stop on level surface and set parking brake. Then turn off machine and remove key.

2. Open the engine cover and side door.
3. Remove and discard the LP hose running between the engine carburetor and the LP lock-off/vaporizer. (Refer to FIG. 1)
4. Remove and discard the fitting from the LP carburetor. (Refer to FIG. 1)
5. Remove and discard the fitting from the bottom of the LP lock-off/vaporizer. (Refer to FIG. 1)

INSTALLATION:

(Refer to FIG. 1)

1. Place a small amount of PST sealant (4) on the **pipe** threads of the two fittings provided in this kit. (Refer to FIG. 1)
2. Install the smaller fitting (2) in the engine carburetor. Orientate the fitting in the direction of the LP lock-off/vaporizer. (Refer to FIG. 1)
3. Install the larger fitting (3) in the bottom of the LP lock-off/vaporizer. Orientate the fitting in the direction of the engine carburetor. (Refer to FIG. 1)
4. Install the new LP hose (1) on the new fittings. Open the valve on the LP tank and check the fittings and hose for any leaks. (Refer to FIG. 1)
5. Close the engine cover and side door. Operate the machine and check for proper operation.

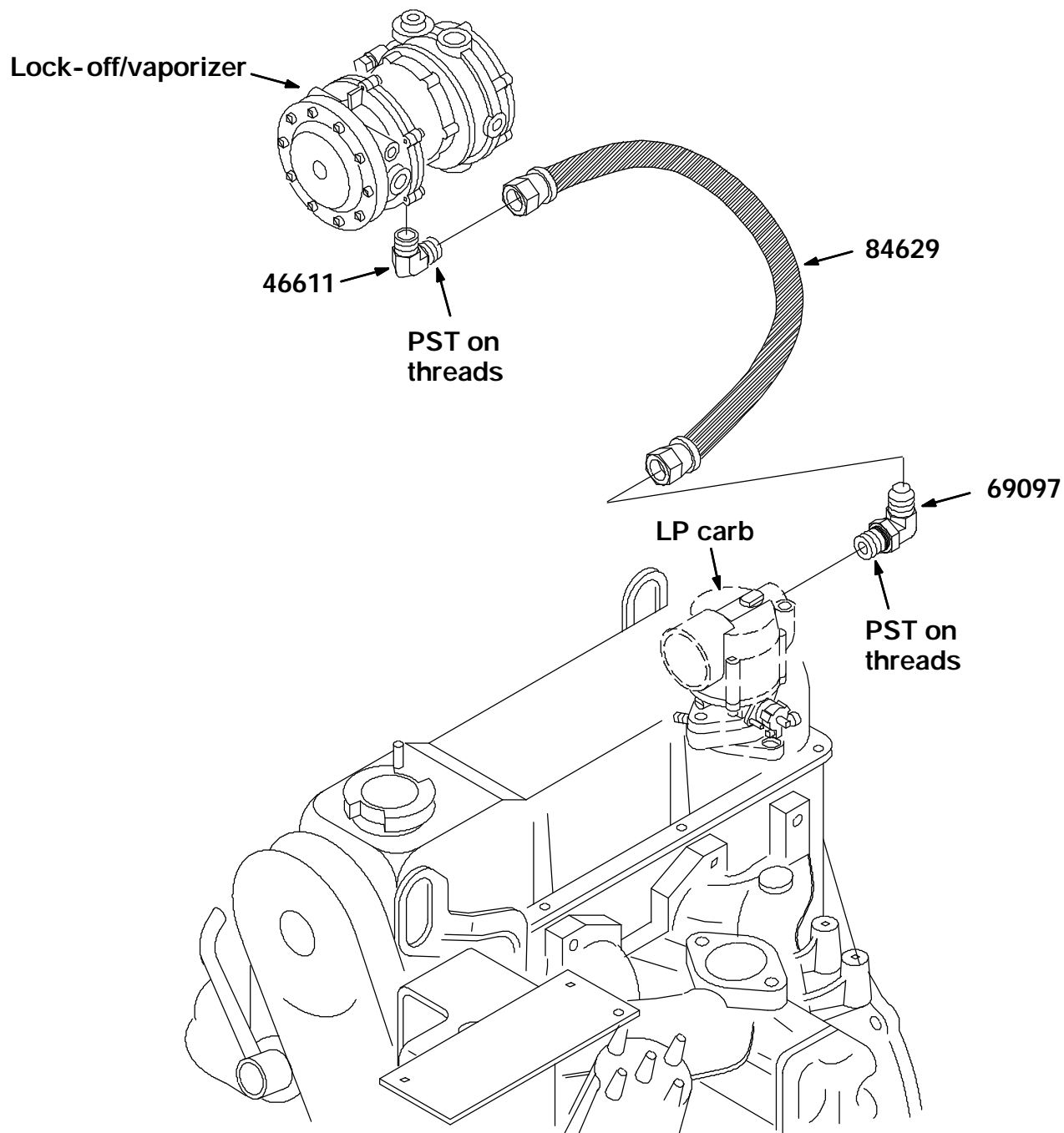

FIG. 1 - Hose And Fitting Installation
BILL OF MATERIALS FOR LP HOSE REPLACEMENT KIT 84630

Ref.	TENNANT Part No.	Description	Qty.
1	84629	LP hose, 14" L	1
2	69097	90° hyd fitting, 6-10	1
3	46611	90° hyd fitting, 8-10	1
4	04415	PST sealant, 6ml	1

TENNANT COMPANY
P. O. Box 1452
Minneapolis, MN 55440-1452