



INSTRUCTION BULLETIN

No. 3743

Machine: 800/810 D, 355/385
Gas&D, 8400 Gas&D

Published: 4-96/01

System: ENGINE

NOTE: DO NOT DISCARD the Parts List from the Instruction Bulletin. Place the Parts List in the appropriate place in your machine manual for future reference. Retaining the Parts List will make it easier to reorder individual parts and will save you the cost of ordering an entire kit.

NOTE: Numbers in parenthesis () are reference numbers for parts listed in Bill of Materials.

Installation Instructions for Kit numbers 21720 and 84656

SYNOPSIS / PROBLEM:

This kit contains the parts needed to replace the fuel pump on the machines listed above. Please follow step-by-step instructions.

SPECIAL TOOLS / CONSIDERATIONS: 1. Hand drill 2. 1/4 in. drill bit (8400 diesel only)
(Estimated Time to complete: 2 hours)

PREPARATION FOR 800/810 DIESEL:

(Refer to FIG. 1)

FOR SAFETY: Before leaving or servicing machine, stop on level surface and set parking brake. Then turn off machine and remove key.

1. Disconnect battery cables from machine.



WARNING: Always disconnect battery cables from machine before working on electrical components.

2. Raise the seat assembly.
3. For better access to the old fuel pump--remove the seat support assembly from the machine.
4. Disconnect the old fuel pump from the main electrical harness.
5. Disconnect the two fuel lines at the old fuel pump. (Refer to Fig. 1)

NOTE: Place a drain pan under the machine in the area of the fuel pump to catch any fuel that may run out of the disconnected lines.

6. Remove and retain the two hex screws holding the old fuel pump to the machine frame. Remove the pump from the machine. (Refer to Fig. 1)
7. Remove the fittings from the old fuel pump and install in the same orientation on the new fuel pump (1). (Refer to Fig. 1)

INSTALLATION ON A 800/810:

(Refer to FIG. 1)

1. Install the new fuel pump mounting plate (2) on the machine using the two existing mount holes. Use the two hex screws (4), washers (5), and flange nuts (6) provided in this kit. (Refer to Fig. 1)

NOTE: The fuel pump mounting plate faces the rear of the machine. (Refer to Fig. 1)

2. Plug the connector of the new harness (3) into the connector on the new fuel pump (1).

NOTE: Make sure to place the ring terminal on the fuel pump grounding wire under one of the hex screws when mounting the new fuel pump.

3. Plug the new harness (3) into the main machine harness.
4. Position the new fuel pump on the mounting plate. Install the hardware that was removed in step 6 of the PREPARATION FOR 800/810 DIESEL instructions. (Refer to Fig. 1)

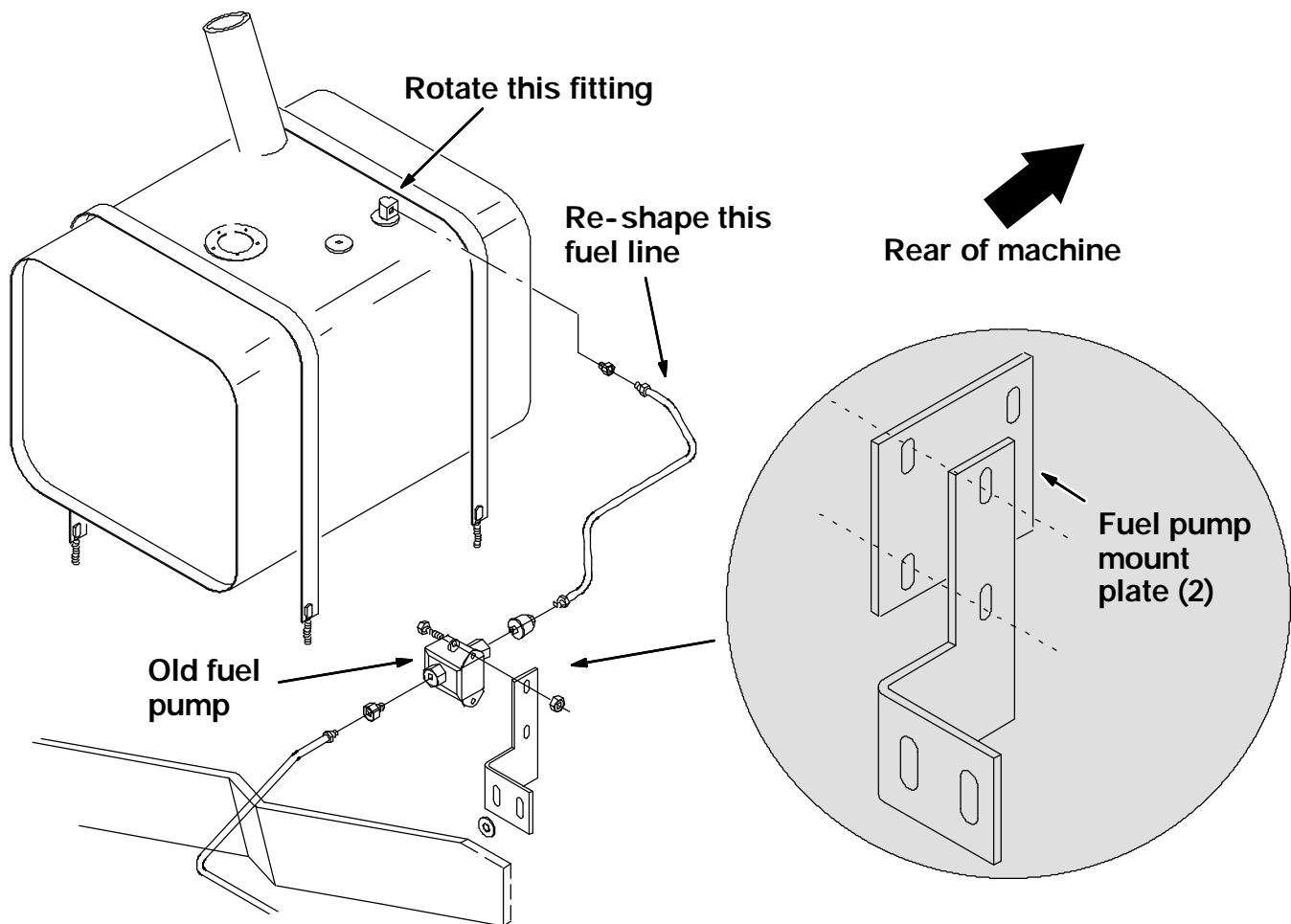

FIG. 1 - 800/810 Diesel Fuel Pump Installation

5. Reconnect the fuel lines. The fuel line that runs from the pump to the engine can be installed without any major modifications. The fuel line that runs from the tank to the pump may have to be re-shaped and the fitting on the tank rotated slightly in order for the fuel line to fit properly. (Refer to Fig. 1)
6. Reconnect the battery cables and start the machine. Check for any leaks at the new fuel pump. (Refer to Fig. 1)

PREPARATION FOR 8400 GAS AND DIESEL:

(Refer to FIG. 2 and 3)

FOR SAFETY: Before leaving or servicing machine, stop on level surface and set parking brake. Then turn off machine and remove key.

1. Disconnect battery cables from machine.



WARNING: Always disconnect battery cables from machine before working on electrical components.

2. Raise the seat assembly.
3. For better access to the old fuel pump--remove the RH rear access panel from the machine. (Refer to Fig. 3)

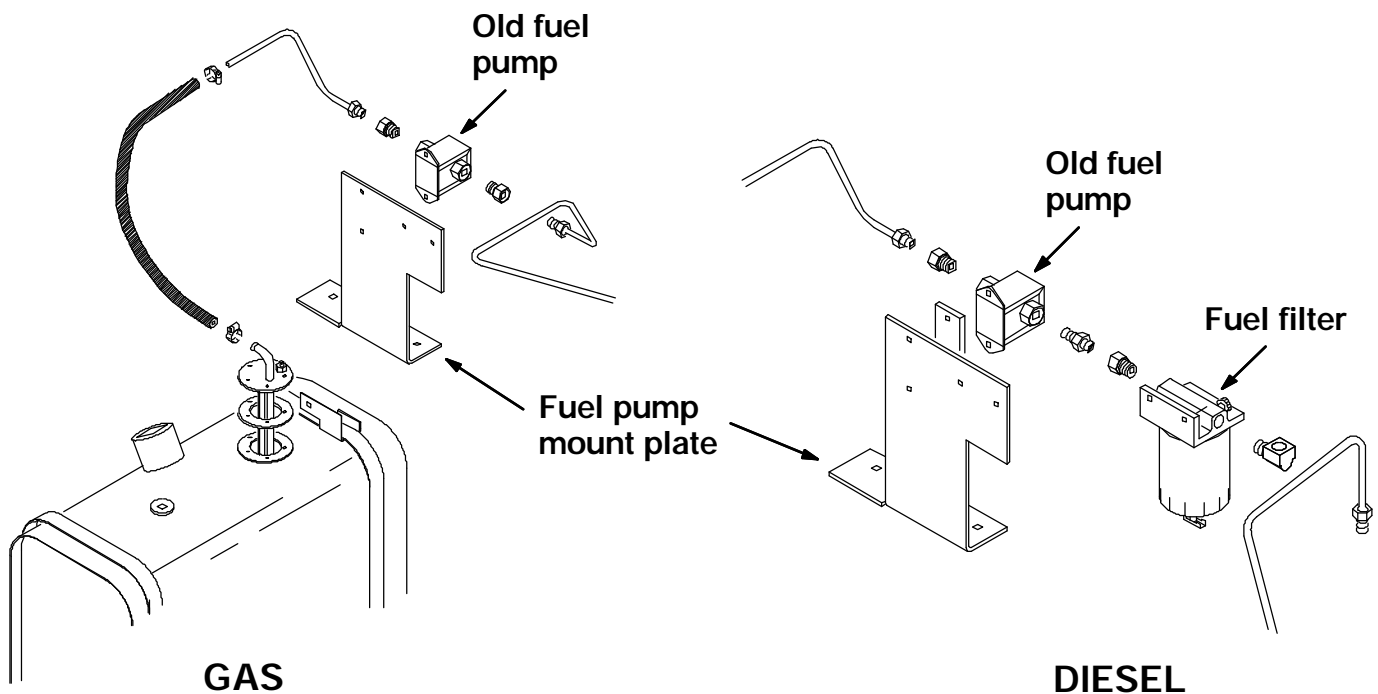

FIG. 2 - 8400 Fuel Pump Installation

4. Disconnect the old fuel pump from the main electrical harness. (Refer to Fig. 2)
5. Disconnect the fuel lines from the inlet port of the old fuel pump and the outlet port on the fuel filter **(diesel machine only)**. The gas machine does not have a filter in this location. (Refer to Fig. 2)

NOTE: Place a drain pan under the machine in the area of the fuel pump to catch any fuel that may run out of the disconnected lines. (Refer to Fig. 2)

6. Remove and retain the hardware holding the old fuel pump to the fuel pump mount plate. Remove the old fuel pump from the machine **(gas machine only)**. (Refer to Fig. 2)
7. Remove and retain the hardware holding the fuel filter to the fuel pump mount plate. Remove the filter and pump assembly **(diesel machine only)**. (Refer to Fig. 2)

8. Un-screw the fitting from the inlet port on the old fuel pump where it attaches to the fuel filter. Remove the old fuel pump from the machine **(diesel machine only)**. (Refer to Fig. 2)
9. Remove the fittings from the old fuel pump and install in the same orientation on the new fuel pump (1). (Refer to Fig. 2 and 3)

INSTALLATION ON A 8400 GAS AND DIESEL:
(Refer to FIG. 2 and 3)

1. Install the new fuel pump (1) on the existing fuel filter **(diesel machine only)**.
(Refer to Fig. 2)
2. Mount the filter and pump assembly on the pump mount plate. (Refer to Fig. 2 and 3)
3. Mark and drill the holes for the new fuel filter. Install the hardware. (Refer to Fig. 2 and 3)

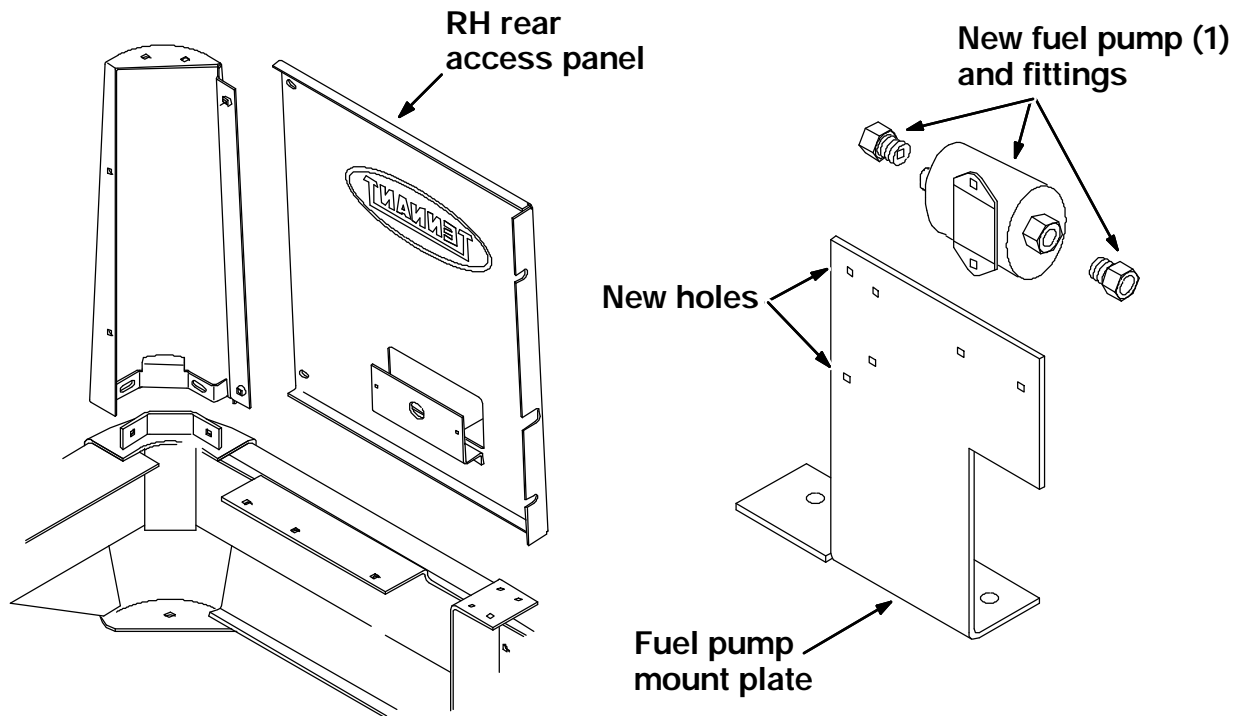

FIG. 3 - 8400 Fuel Pump Installation

4. Plug the connector of the new harness (3) into the connector on the new fuel pump (1).

NOTE: Make sure to place the ring terminal on the fuel pump grounding wire under one of the hex screws when mounting the new fuel pump.

5. Plug the new harness (3) into the main machine harness.
6. Reconnect the fuel lines to the new fuel pump (1). (Refer to Fig. 2 and 3)
7. Reinstall the RH rear access panel. (Refer to Fig. 3)
8. Reconnect the battery cables and start the machine. Check for any leaks at the new fuel pump. (Refer to Fig. 2)

PREPARATION FOR 355/385 GAS AND DIESEL:
(Refer to FIG. 4 and 5)

FOR SAFETY: Before leaving or servicing machine, stop on level surface and set parking brake. Then turn off machine and remove key.

1. Raise the seat assembly.
2. Disconnect battery cables from machine.



WARNING: Always disconnect battery cables from machine before working on electrical components.

3. For better access to the old fuel pump--open the RH rear grill and remove the seat assembly.

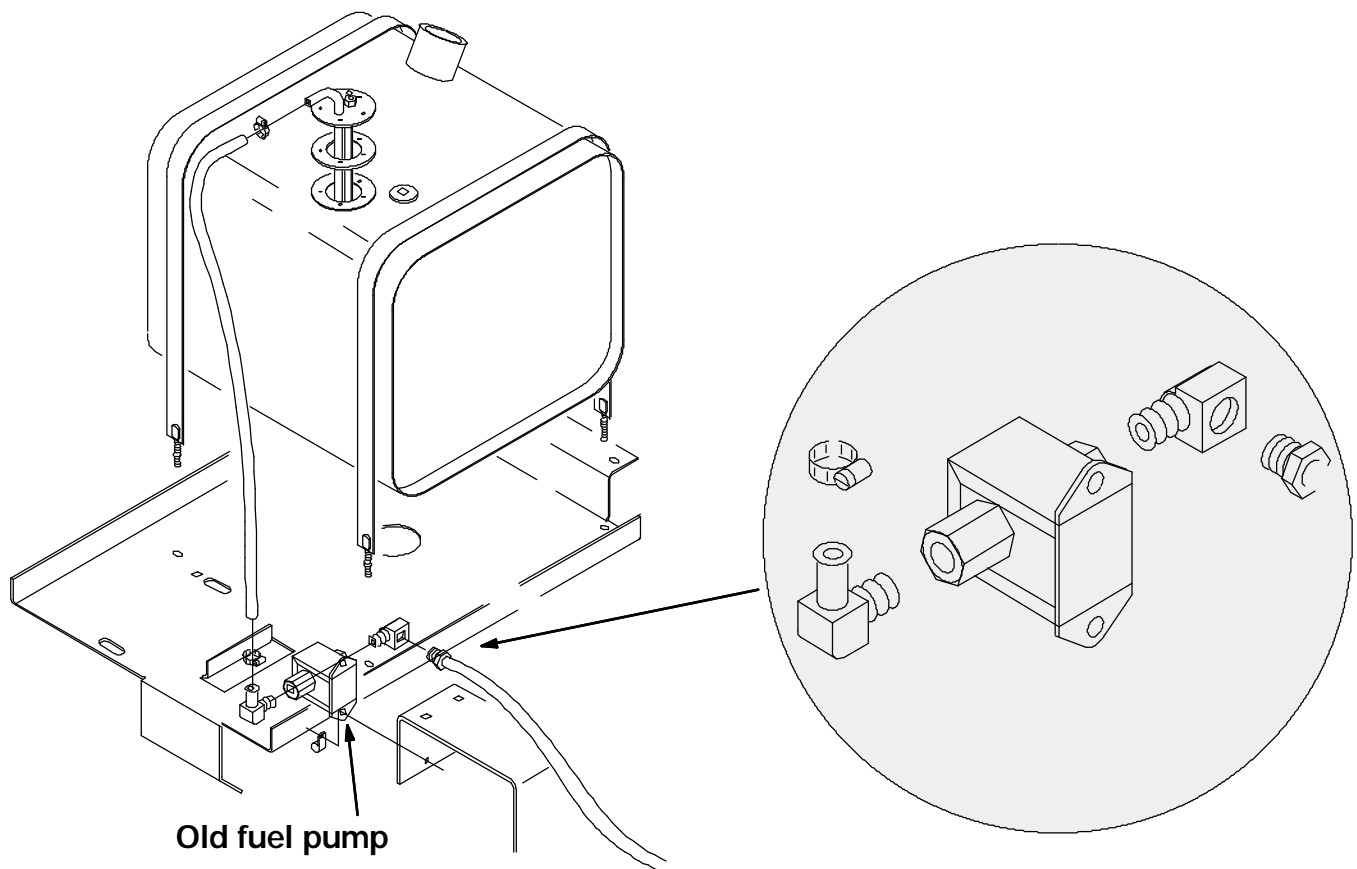

FIG. 4 - 355/385 Fuel Pump Installation

4. Disconnect the old fuel pump from the main electrical harness. (Refer to Fig. 4)
5. Disconnect the fuel lines from the old fuel pump. (Refer to Fig. 4)

NOTE: Place a drain pan under the machine in the area of the fuel pump to catch any fuel that may run out of the disconnected lines. (Refer to Fig. 4)

6. Remove and retain the hardware holding the old fuel pump to the fuel pump mount plate. Remove the old fuel pump from the machine. (Refer to Fig. 4)
7. Remove the fittings from the old fuel pump and install in the same orientation on the new fuel pump (1). (Refer to Fig. 4)

INSTALLATION ON A 355/385 GAS AND DIESEL:

(Refer to FIG. 4 and 5)

1. Install the new fuel pump (1) on the machine frame mount plate. (Refer to Fig. 4 and 5)
2. Reinstall the hardware removed in step 6 of the PREPARATION FOR 355/385 GAS AND DIESEL instructions. (Refer to Fig. 4 and 5)
3. Plug the connector of the new harness (3) into the connector on the new fuel pump (1).

NOTE: Make sure to place the ring terminal on the fuel pump grounding wire under one of the hex screws when mounting the new fuel pump.

4. Plug the new harness (3) into the main machine harness.

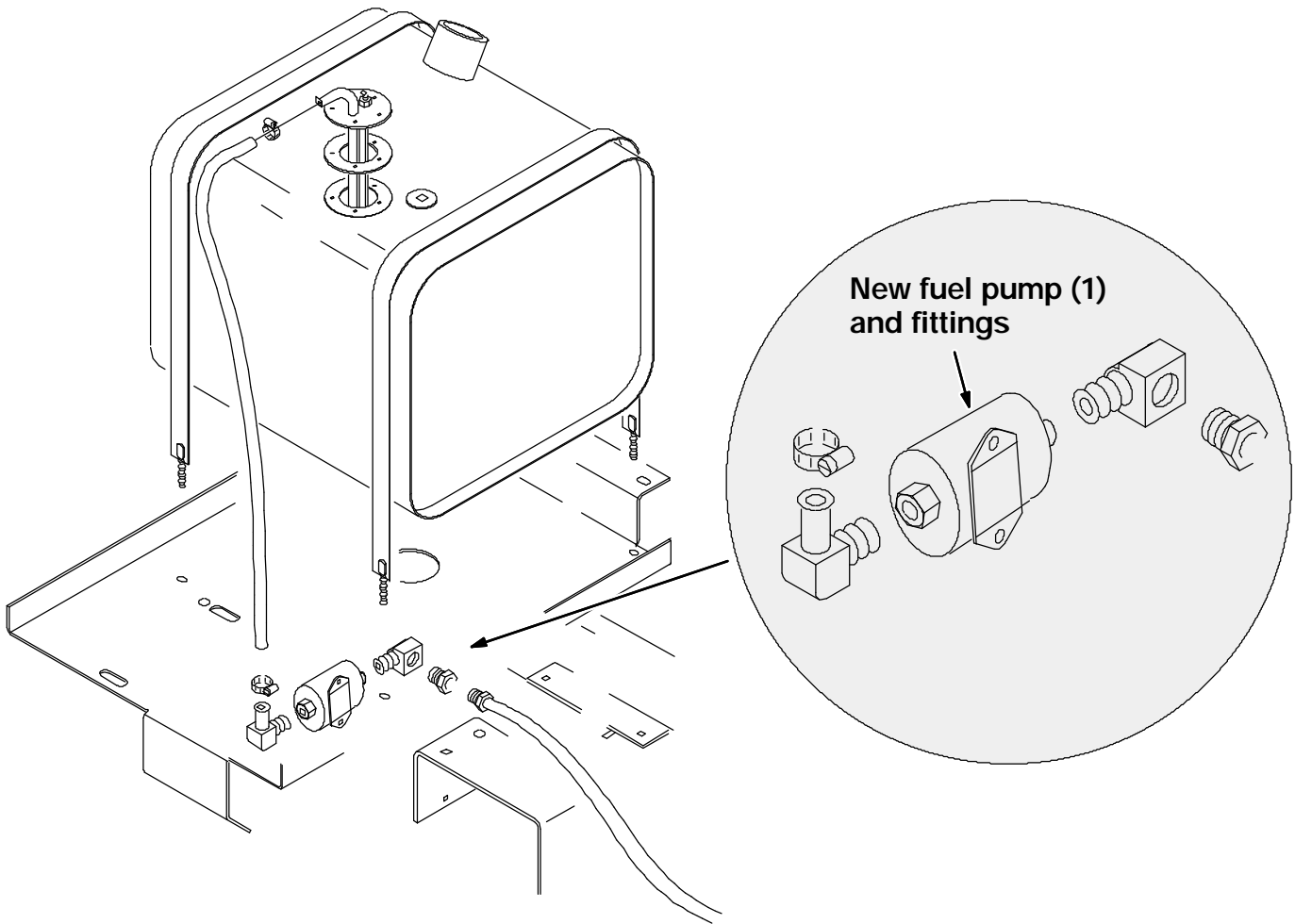

FIG. 5 - 355/385 Fuel Pump Installation

5. Reconnect the fuel lines to the new fuel pump (1). (Refer to Fig. 4 and 5)
6. Close the RH rear grill and reinstall the seat assembly
7. Reconnect the battery cables and start the machine. Check for any leaks at the new fuel pump. (Refer to Fig. 4 and 5)

BILL OF MATERIALS FOR FUEL PUMP REPLACEMENT KIT 21720

Ref.	TENNANT Part No.	Description	Qty.
1	59015	Fuel pump	1
2	21718	Mounting plate	1
3	21715	Electrical harness	1
4	06942	M6 hex screw, 16m	2
5	32490	1/4 in. flat washer	2
6	07790	M6 flange nut	2

BILL OF MATERIALS FOR FUEL PUMP REPLACEMENT KIT 84656

Ref.	TENNANT Part No.	Description	Qty.
1	59015	Fuel pump	1
2	84657	Fuel pump adaptor harness	1

TENNANT COMPANY
P. O. Box 1452
Minneapolis, MN 55440-1452