



INSTRUCTION BULLETIN

No. 3189
Machine: All 550's
Published: 5-89

Installation Instructions for Vacuum Fan Bracket Kit 25641.

Vacuum Fan Bracket 31619 and Mounting Bracket 75467 have been replaced with Bracket Assembly 25640, (2) Mounting Brackets 25639, and new hardware. Please follow the step-by-step directions.

PROCEDURE:

Park the machine on a level surface. Turn off the engine/motor and set the parking brake.

FOR SAFETY: Always turn off the engine or motor and set the parking brake before working on the machine.

REMOVAL OF VACUUM FAN BRACKET:

1. Remove the spring, eyebolt, nuts, and vacuum fan drive sheave. Save for later use. See Fig. 1.

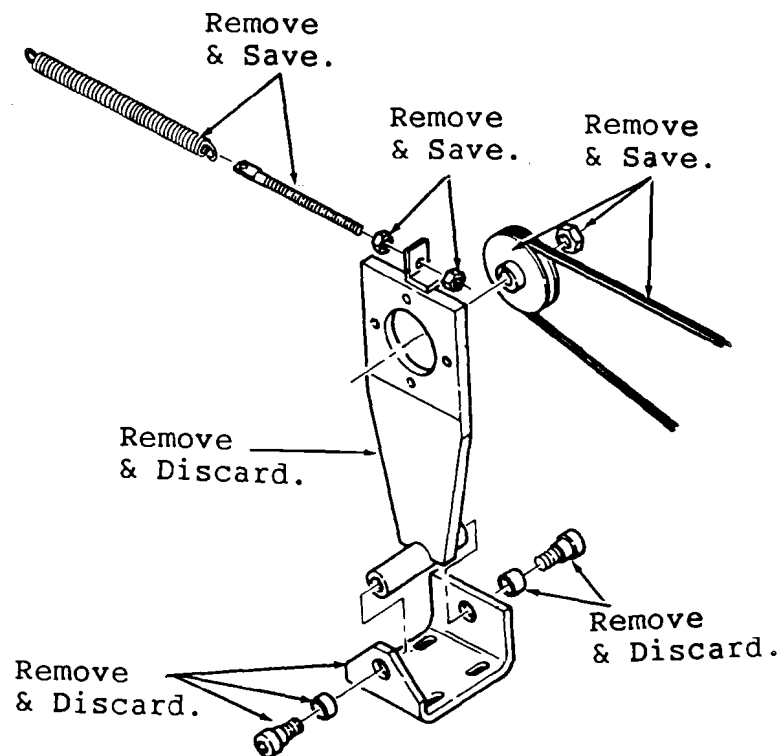

Fig. 1 - REMOVAL OF VACUUM FAN BRACKET 31619

- a. Remove jam nuts on the tension spring eyebolt to release belt tension.
- b. Remove and save belt.

- c. Remove vacuum fan drive sheave. Save sheave, nut, and key.
2. Remove and save the (4) bolts holding vacuum fan assembly to fan bracket.
3. Remove the (4) bolts holding the mounting bracket to the frame. Discard all parts.

INSTALLATION OF KIT PARTS:

1. Drill (4) new slots as shown in Fig. 2 (Gasoline, LPG, and Diesel).

NOTE: For Electric machines, cut a 5/8" x 1-1/2" slot out of machine frame, then drill (4) new slots. See Fig. 3.

2. Mount the Angle Brackets so the ends with the (2) holes point into each other. Use --

(2) 3/8" Flat washers
(2) Hexlocknylon nuts, 3/8 - 16. Each side

3. Insert the threaded rod 25637 through the mounting bracket and through the new fan bracket assembly 25640, and out through the hole of the second mounting bracket. Fasten each end with --

(1) 1/2" Flat washer
(1) Hexlocknylon nut, 1/2 - 13 Each side

4. Remount the vacuum fan assembly and the vacuum fan drive sheave to the new bracket with the hardware previously removed.
5. Reinsert the eyebolt and jam nuts. Loop the V-Belt over the sheave. Attach the spring, and adjust the tension on the V-Belt.

V-BELT TENSION ADJUSTMENT:

Vacuum fan drive belt tension should be checked every 100 hours. Turn the eyebolt in to increase tension, out to decrease. Tension the belt to 65±5 lbs static, or a 1/4" deflection at approximately 4.5 lbs exerted at midpoint of belt.

TENNANT COMPANY
P. O. Box 1452
Minneapolis, MN 55440-1452

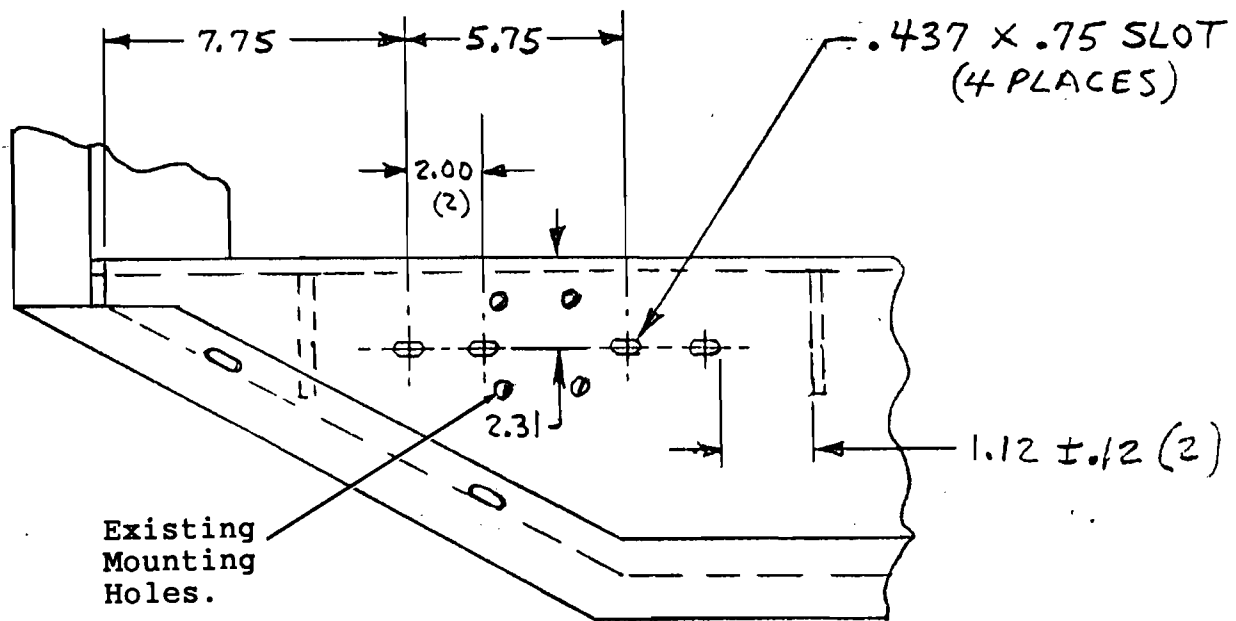
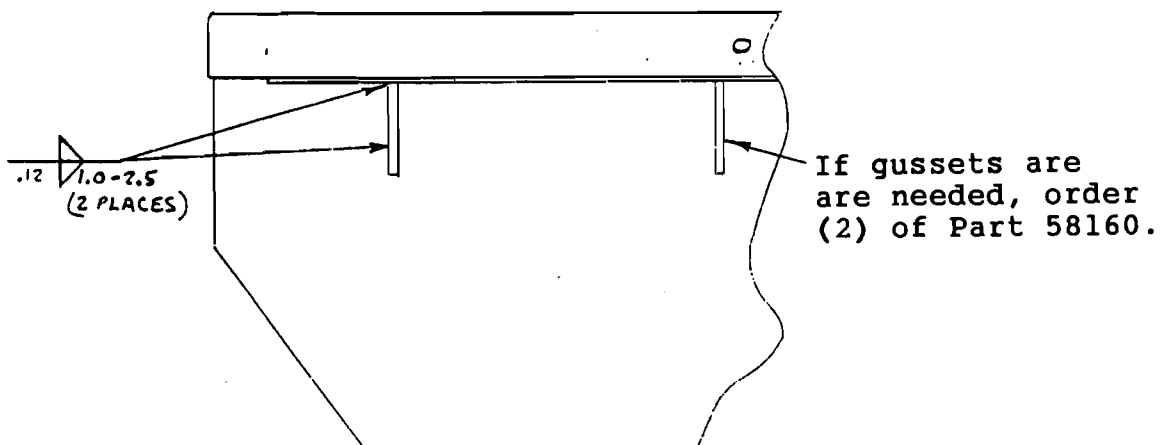

Fig. 2 - HOLE LOCATIONS FOR TENNANT GAS, LPG, & DIESEL MODELS
(Top view of frame - vacuum fan area)



SIDE VIEW OF FRAME

BILL OF MATERIAL FOR FAN BRACKET ASSEMBLY KIT 25641

TENNANT Part No.	Description	Qty.
25640	FAN BRACKET ASSEMBLY	1
25637	THREADED ROD	1
32985	NUT, Hexlocknylon, 1/2 - 13	2
32486	WASHER, Flat, 1/2"	2
25639	ANGLE BRACKET	2
50902	NUT, Hexlocknylon, 3/8 - 16	4
32492	WASHER, Flat, 3/8"	4

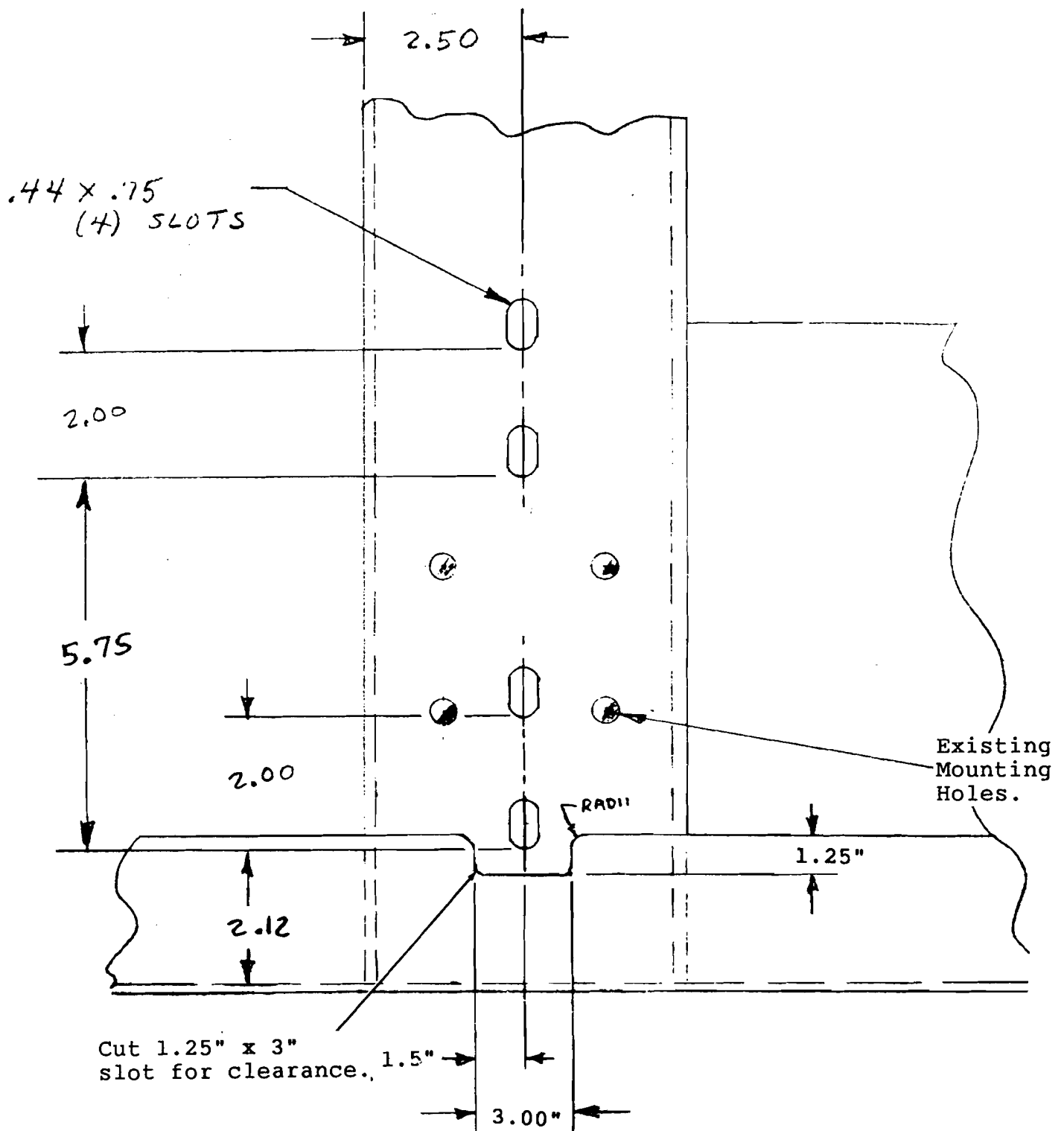

Fig. 3 - SLOTS FOR TENNANT MODEL 550E MOUNTING BRACKETS 25639

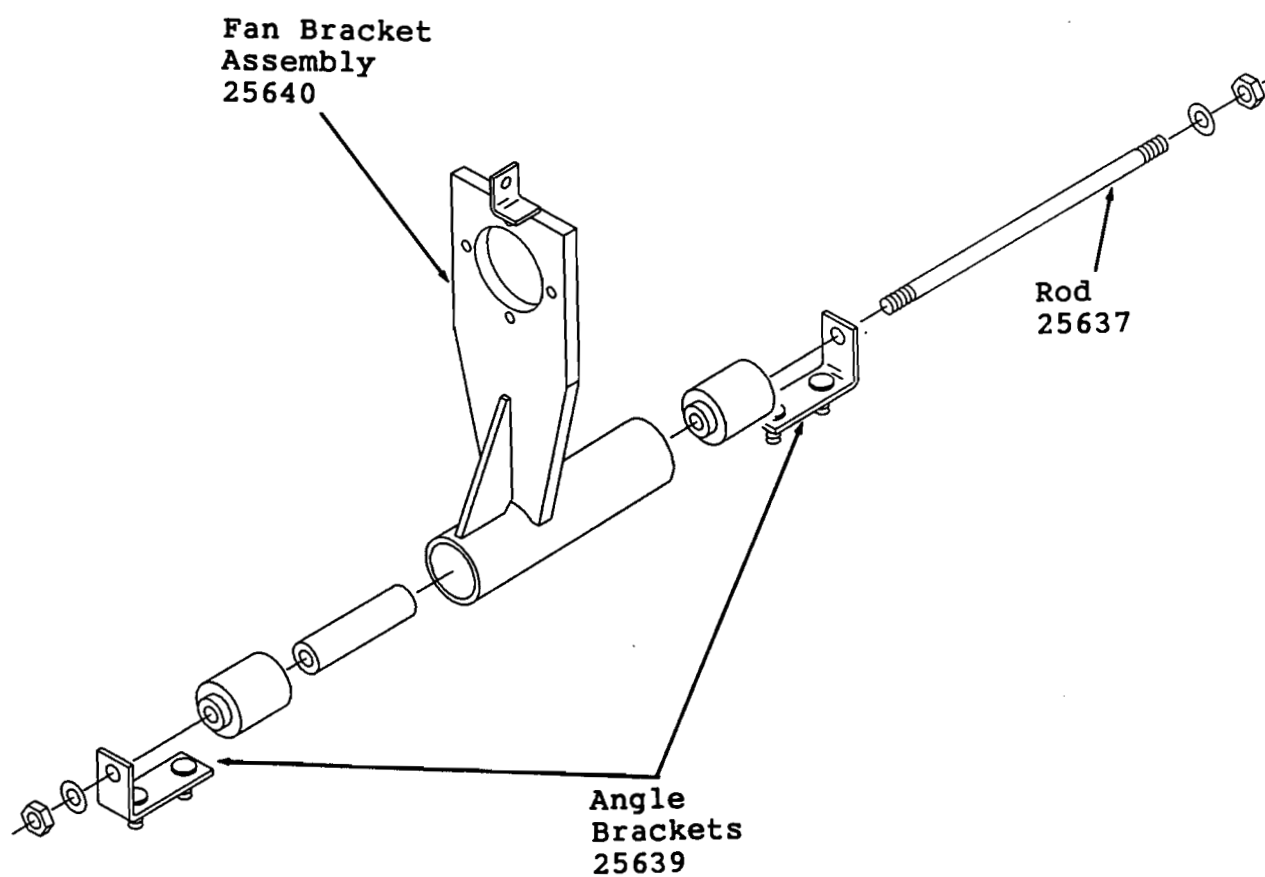

Fig. 4 - NEW BRACKET ASSEMBLY