



INSTRUCTION BULLETIN

No. 2166
Machine: 42HD, Gas,
LPG
Published: 7-89

Installation Instructions for Regulator-Rectifier Replacement Kit SK 2166.

The rectifier in this kit is for use on the TENNANT Model 42 HD, gas and LP gas machines only. This rectifier has the same wiring connections as the old unit with one exception. This is at the ignition switch. Please follow the step-by-step directions.

PROCEDURE:

1. Park the machine on a level surface. Turn off the engine.

FOR SAFETY: Always turn off the engine before working on the machine.

2. Remove the battery cables from the battery. Remove the negative (-) cable first.

WARNING: Always remove the battery cables from the battery before working on machine electrical components.

3. Unhook and remove the old regulator-rectifier.
4. Install the new regulator-rectifier. Hook wires up according to Fig. 1. Wire 1 which was connected to Wires 5 and 13 to one terminal of the ignition switch, should be hooked up to the terminal where Wire 8 is connected.

BILL OF MATERIAL FOR SK 2166

| TENNANT Part No. | Description | Qty. |
|---------------------|---------------------|------|
| 27222-2 | REGULATOR/RECTIFIER | 1 |

TENNANT COMPANY
P. O. Box 1452
Minneapolis, MN 55440-1452

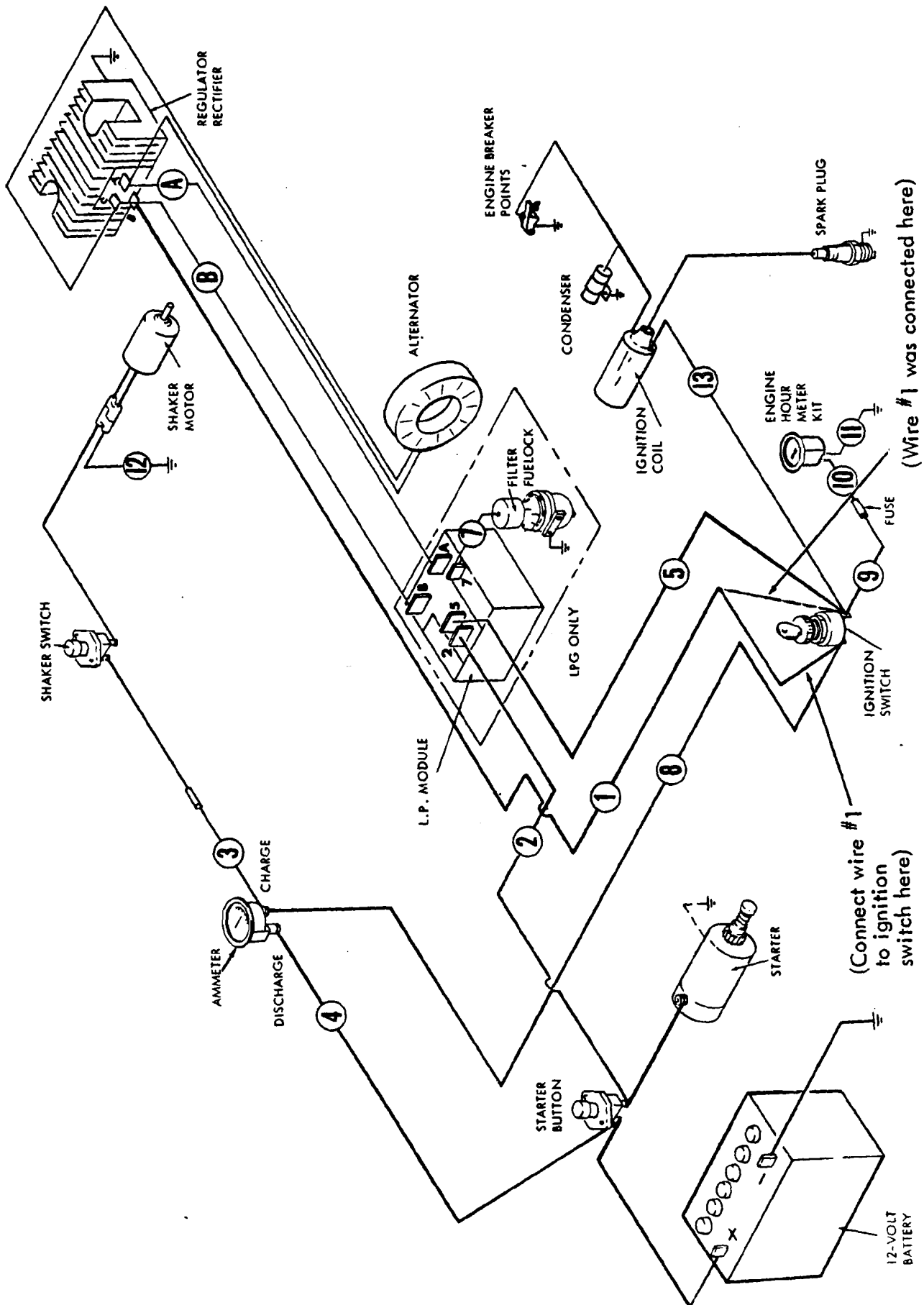

Fig. 1 - WIRING DIAGRAM FOR REGULATOR-RECTIFIER 27222-2