



INSTRUCTION BULLETIN

No. 9045220
Machine: S16
Published: 01-2021
Rev. 00

NOTE: DO NOT DISCARD the Parts List from the Instruction Bulletin. Place the Parts List in the appropriate place in the machine manual for future reference. Retaining the Parts List will make it easier to reorder individual parts and will save the cost of ordering an entire kit.

NOTE: Numbers in parenthesis () are reference numbers for parts listed in Bill of Materials.

Installation instructions for **kit number 9045207**

Kit installation must be performed by TennantTrue[®] service or an authorized service provider.

SYNOPSIS:

This kit contains the parts needed to install a strobe light/backup alarm and headlight/taillight kit on S16 sweepers.

Please follow step-by-step instructions.

SPECIAL TOOLS / CONSIDERATIONS: NONE

(Estimated time to complete: 3 hours)

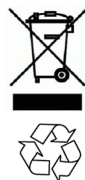

PROTECT THE ENVIRONMENT

Please dispose of packaging materials, used machine components such as batteries and fluids in an environmentally safe way according to local waste disposal regulations.

Always remember to recycle.

PREPARATION:

1. Remove the left side shroud from the machine. Set the left side shroud aside.
2. **Machines with high dump only:** Turn key switch to ON, lift the hopper to the fully raised position, engage the hopper support, and turn key switch OFF. Hopper must be raised to access area where alarm (5) will be installed onto the machine.



WARNING: Lift arm pinch point. Stay clear of hopper lift arms.



WARNING: Raised hopper may fall. Engage hopper support bars.

FOR SAFETY: Before leaving or servicing machine, stop on level surface, turn off machine, and remove key.

3. Lift the operator seat open and secure the seat into the fully open position.

4. Disconnect the battery cable from the machine.



WARNING: Always disconnect battery cables from machine before working on electrical components.

5. Open and/or remove the electrical compartment cover to access the rear breaker bracket/main wire harness connections behind the rear breaker bracket. (Fig. 1)



FIG. 1

6. Remove the front access panel from the steering channel to access the circuit breaker bracket. Set the front access panel aside. (Fig. 2)



FIG. 2

INSTALLATION:

1. Route the light harness (10) through the the leg of the light bracket (1) that will be installed on the left side of the machine. (Fig. 3)
2. Use four SEMS M8 hex screws (2) to install the light bracket (1) onto the bulkhead bracket. (Fig. 3)
3. Route the light harness (10) into the electrical compartment near the rear breaker bracket and connect the light harness to the main wire harness. (Fig. 3)
4. Use four M5 button screws (4) to install the strobe light (3) onto the light bracket (1). (Fig. 3)
5. Connect the light harness (10) to the strobe light (3). (Fig. 3/Fig. 4)
6. Connect the light harness (10) to the taillight (17). (Fig. 3/Fig. 4)
7. Use two M4 pan screws (18) to install the taillight (17) onto the light bracket (1). (Fig. 3)
8. Use the wire tie (11) to secure the light harness (10) to the light bracket (1). (Fig. 3)
9. Insert a 2.5- Amp circuit breaker (9) into circuit breaker location CB8 on the rear breaker bracket. (Fig. 3)
10. Connect the main wire harness to the 2.5- Amp circuit breaker (9) installed in the previous step. (Fig. 3/Fig. 4)
11. Connect the main wire harness to the backup alarm (5). (Fig. 3/Fig. 4)
12. Use a hex screw (7) and a flat washer (6) to install the backup alarm (5) onto the bulkhead bracket. (Fig. 3)
13. Remove the hardware securing the control panel to the front shroud and carefully lift the control panel from the shroud. Do not break any wire or cable connections when lifting the panel from the shroud. (Fig. 3)
14. Remove the hole plug from the location where the rocker switch (8) is to be installed on the control panel. Discard the plug. (Fig. 3)
15. Insert the rocker switch (8) into the control panel. (Fig. 3)
16. Connect the main wire harness to the rocker switch (8). (Fig. 3/Fig. 4)
17. Reinstall the control panel onto the front shroud. (Fig. 3)
18. Insert a 2.5- Amp circuit breaker (9) into circuit breaker location CB14 in the circuit breaker bracket. (Fig. 4)
19. Connect the main wire harness to the 2.5- Amp circuit breaker (9) installed in the previous step. (Fig. 3/Fig. 4)
20. Reinstall the front access panel onto the steering channel.
21. Reinstall/close the electrical compartment cover.

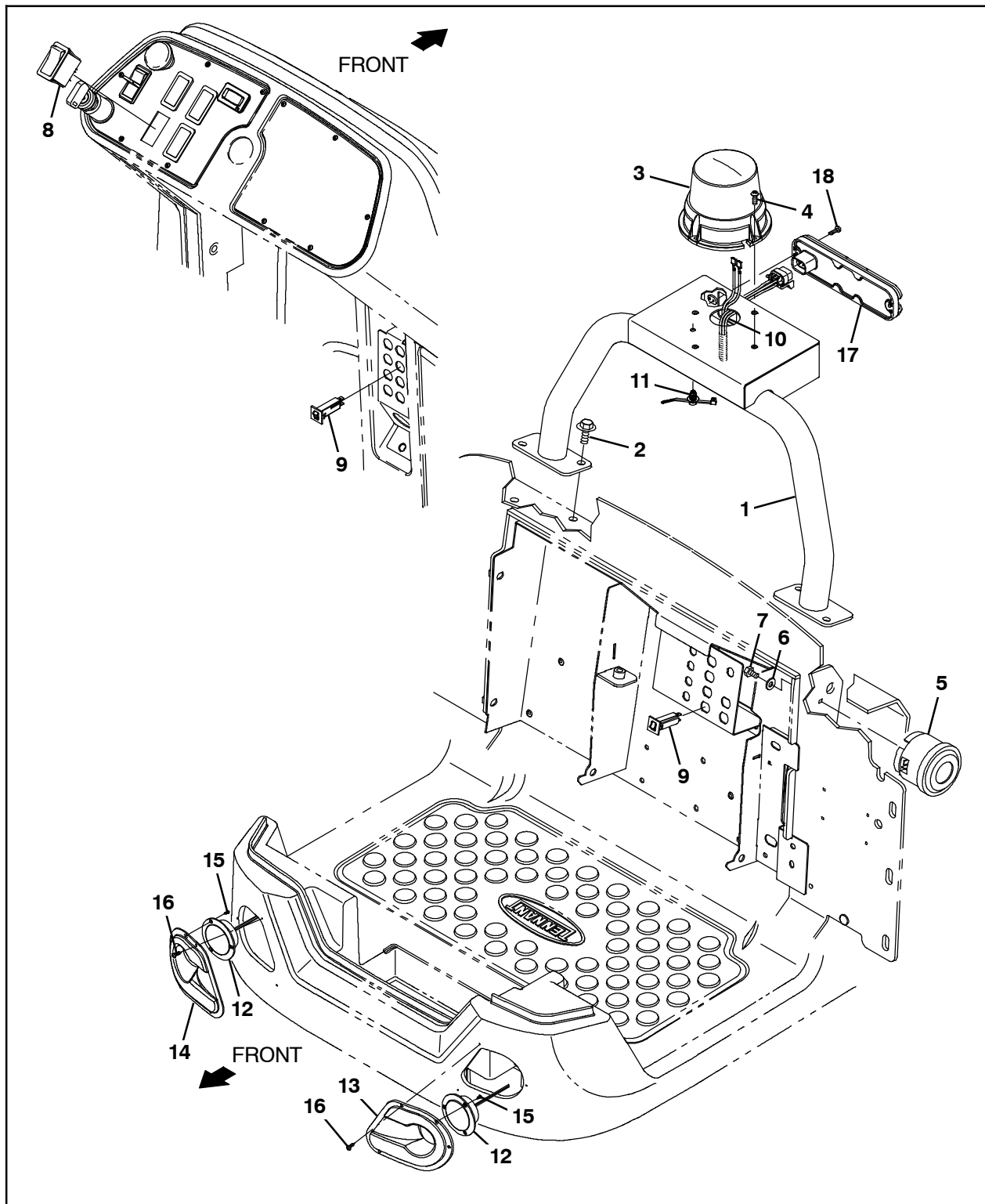

FIG. 3

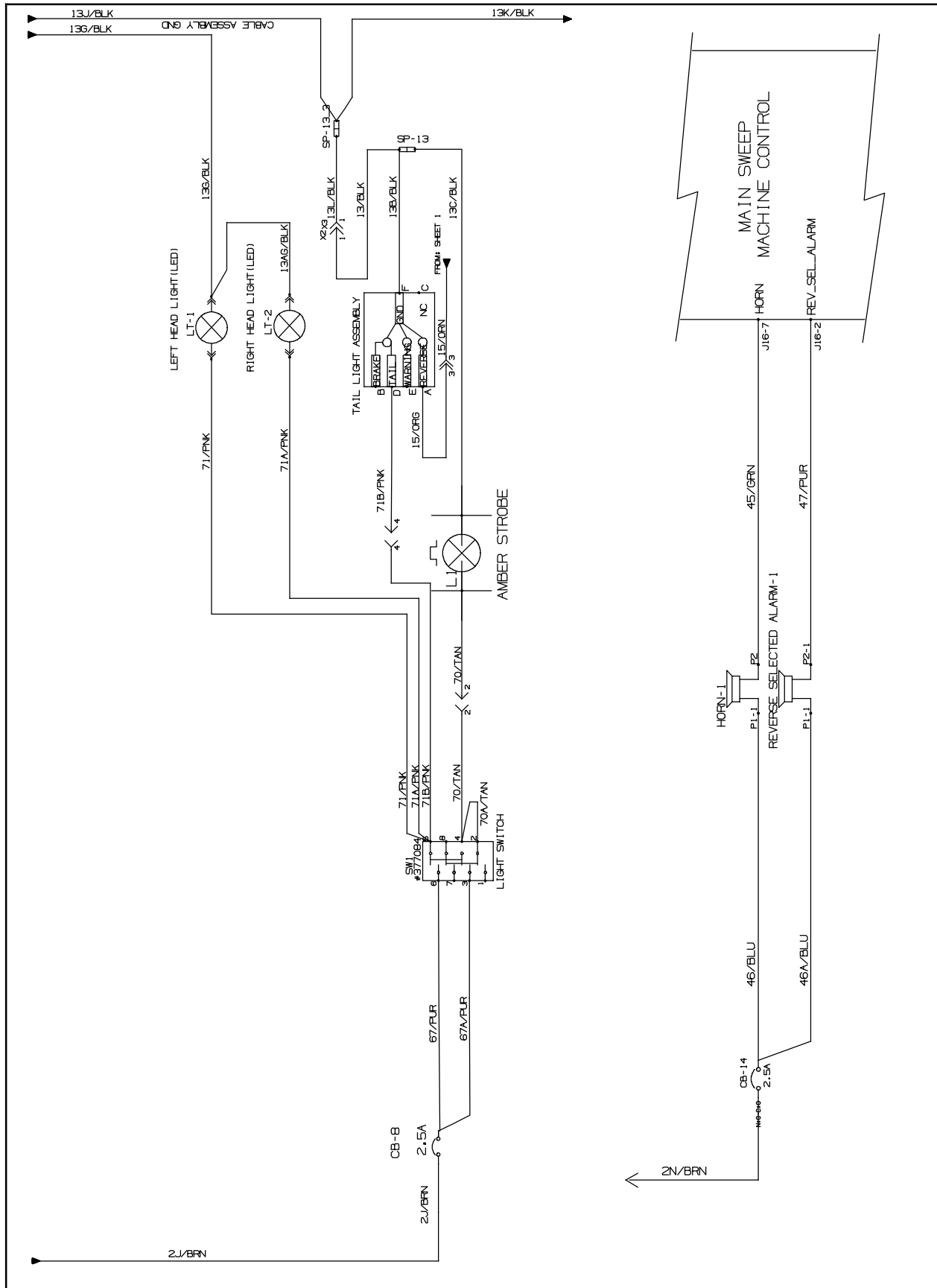

FIG. 4

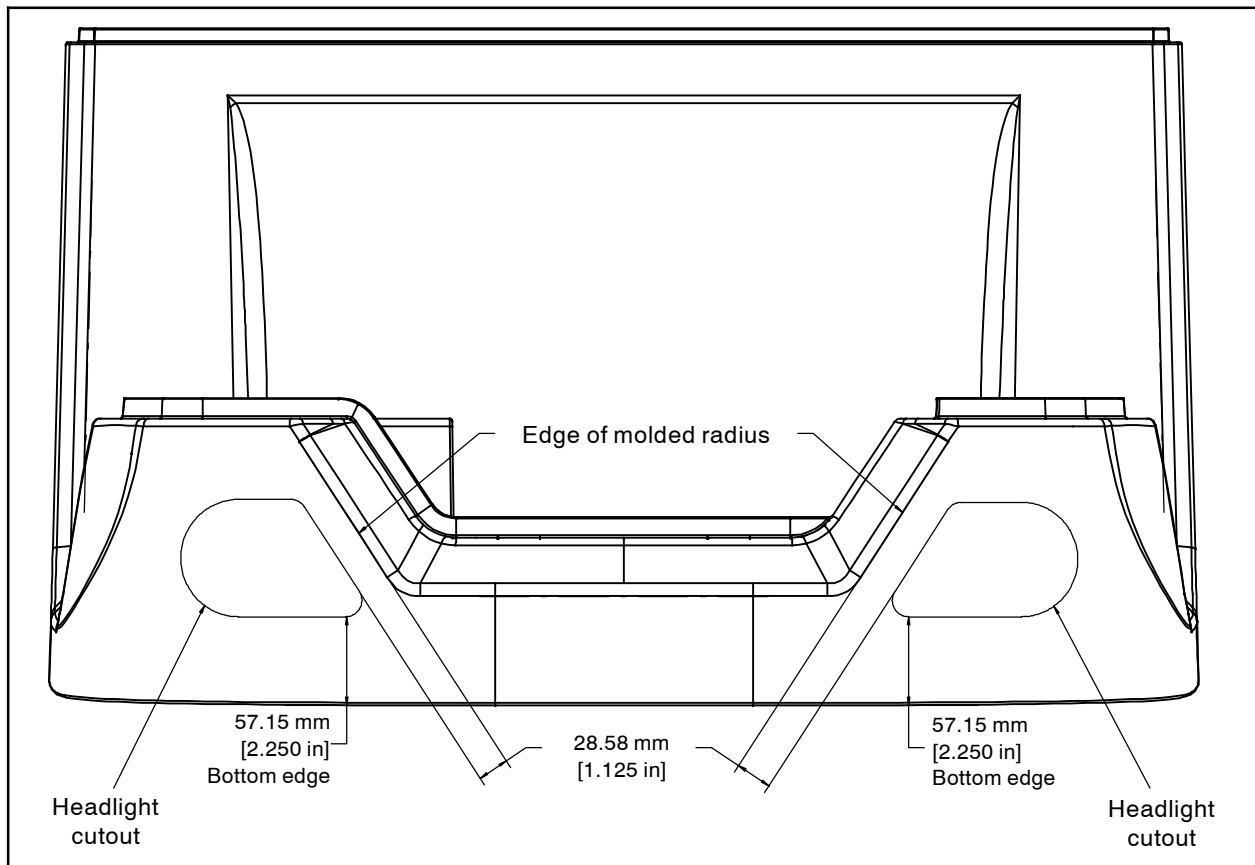

FIG. 5

22. Tape both headlight bezel templates (20) onto the lower operation station. (Fig. 6/Fig. 5)

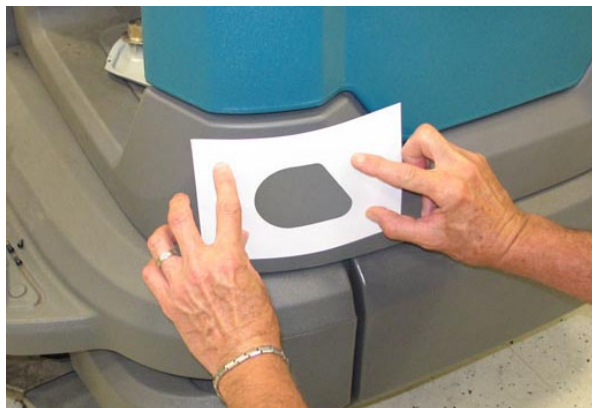

FIG. 6

23. Cut the holes for both headlights into the lower operator station. (Fig. 7/Fig. 5)



FIG. 7

24. Clean up both newly cut holes as necessary so the left headlight bezel (13) and right headlight bezel (14) easily fit into the holes.

25. Remove the headlight bezel templates (20) from the lower operator station and discard both templates.

26. Use the right headlight bezel (14) as a template and drill a 0.078" (1.98 mm) hole through each of the three holes in the bezel and through the lower operator station. (Fig. 8/Fig. 3)



FIG. 8

27. Use the left headlight bezel (13) as a template and drill a 0.078" (1.98 mm) hole through each of the three holes in the bezel and through the lower operator station. (Fig. 3)
28. Use three M3 pan screws (15) to install a light assembly (12) into the left headlight bezel (13). (Fig. 3)
29. Use three M3 pan screws (15) to install a light assembly (12) into the right headlight bezel (14). (Fig. 3)
30. Connect the main wire harness to both light assemblies (12). (Fig. 3/Fig. 4)

31. Use three pan screws (16) to install the left headlight bezel (13) onto the lower operator station. (Fig. 3)

32. Use three pan screws (16) to install the right headlight bezel (14) onto the lower operator station. (Fig. 9/Fig. 3)



FIG. 9

33. Turn on and test the machine. Place the light switch into the ON position and ensure both front lights and the taillight function. Operate the machine in reverse to ensure the backup alarm functions.

Bill Of Materials For Light Kit, Head/Tail Lights, CI [S16] - 9045207

Ref.	Tennant Part No.	Description	Qty.
1	1251334	Bracket Wldt, Light	1
2	1020341	Screw, Hex, M8 X 1.25 X 20, SS, SEMS	4
3	1075283	Light, Strobe, Amb, 12- 48VDC [LED]	1
4	1205799	Screw, Btn, M5 X 0.8 X 16, 8.8, NL, Torx	4
5	1058694	Alarm, Backup, 12- 48VDC, Adj	1
6	32483	Washer, Flat, 0.25, SAE	1
7	19315	Screw, Hex, .25- 20 X 0.50, G5	1
8	377084	Switch, Rocker, Prgrsv	1
9	1064184	Circuit Breaker, 02.5A, Resettable	2
10	1076607	Harness, Ele [Lights, S16]	1
11	1210807	Wire, Tie [w/.25" Fir Tree Clip]	1
12	1058004	Light, LED, 36VDC	2
13	1202870	Bezel, Headlight, LH [w/Inserts]	1
14	1202892	Bezel, Headlight, RH [w/Inserts]	1
15	06920	Screw, Pan, Phl, M3 X 0.50 X 10, 4.8	6
16	222267	Screw, Pan, Phl, 06- 20 X 0.50, Fmg/Ab	6
17	1248392	Taillight [24- 36VDC, JW Speaker]	1
18	06927	Screw, Pan, Phl, M4 X 0.70 X 16, 4.8	2
19	55272	Terminal, Bullet, Mal, .157D, 12GA	4
20	1208746	Template, Bezel, Headlight [T12]	1

TENNANT COMPANY
P. O. Box 1452
Minneapolis, MN 55440-1452