



# INSTRUCTION BULLETIN

No. 9018920  
Machine: M17  
Published: 12-2023  
Rev. 01

**NOTE: DO NOT DISCARD the Parts List from the Instruction Bulletin. Place the Parts List in the appropriate place in the machine manual for future reference. Retaining the Parts List will make it easier to reorder individual parts and will save the cost of ordering an entire kit.**

*NOTE: Numbers in parenthesis ( ) are reference numbers for parts listed in Bill of Materials.*

Installation instructions for **kit number 9018837**

Kit installation must be performed by TennantTrue<sup>®</sup> service or an authorized service provider.

## SYNOPSIS:

This kit contains the parts needed to replace the direct throw sweep arm on M17 sweeper scrubbers equipped with the direct throw main sweep brush.  
Please follow step-by-step instructions.

## SPECIAL TOOLS / CONSIDERATIONS: NONE

(Estimated time to complete: 2 hours)

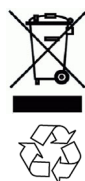

### PROTECT THE ENVIRONMENT

Please dispose of packaging materials, used machine components such as batteries and fluids in an environmentally safe way according to local waste disposal regulations.

Always remember to recycle.

## PREPARATION:

**FOR SAFETY: Before leaving or servicing machine, stop on level surface, turn off machine, set parking brake, and remove key.**

1. Disconnect the battery cable from the machine.



**WARNING: Always disconnect battery cables from machine before working on electrical components.**

2. Remove the main sweep brush from the sweeping assembly. Set the brush aside. Refer to the *MAINTENANCE SECTION* of the *OPERATOR MANUAL* for instructions how to remove the main sweep brush from the machine.

3. Remove the left brush panel from the machine. Set the left brush panel and all mounting hardware aside. (Fig. 1).



**FIG. 1**

## INSTALLATION:

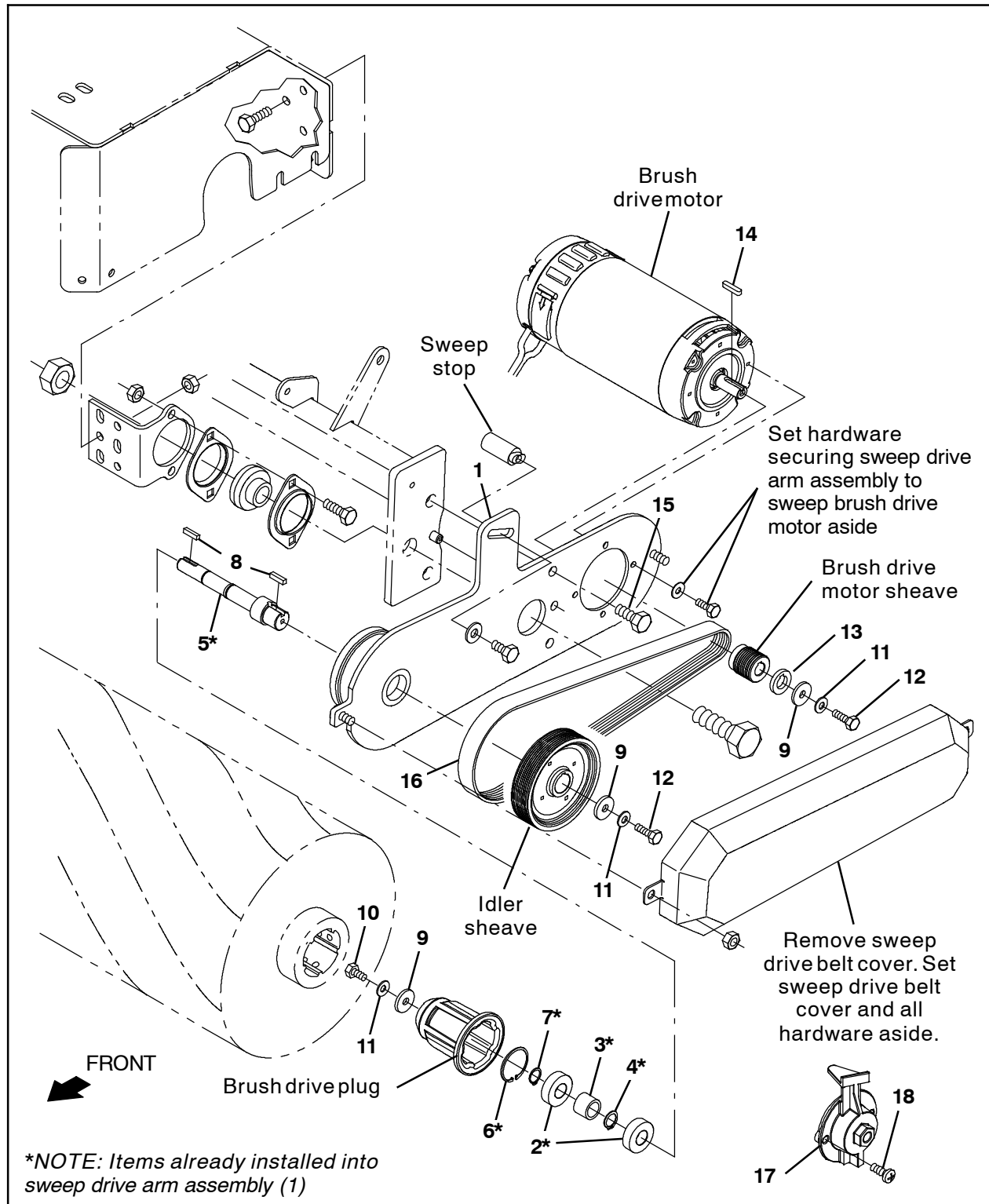

FIG. 2

*NOTE: It may be necessary to slightly jack up the front end of the machine to remove the sweep drive arm assembly from the machine.*

**FOR SAFETY:** When servicing machine, block machine tires before jacking machine up. Use a hoist or jack that will support the weight of the machine. Jack machine up at designated locations only. Support machine with jack stands.

1. Remove the sweep drive belt cover from the sweep drive arm assembly. Set the sweep drive belt cover and all mounting hardware aside. (Fig. 2/ Fig. 3)



**FIG. 3**

2. Disconnect the main wire harness from the direct throw main brush motor. (Fig. 2)
3. Remove the existing sweep drive arm assembly from the machine. Set all hardware previously securing the sweep drive arm assembly to the sweep head aside. (Fig. 2)
4. Remove the belt from the sweep drive arm assembly. Discard the belt. (Fig. 2)
5. Remove the hardware securing the brush drive motor to the sweep drive arm assembly. Set the removed hardware aside. (Fig. 2)
6. Remove the idler sheave and brush drive hub from the sweep drive arm assembly. Set the idler sheave and brush drive hub aside. Discard all hardware used to secure these items to the sweep drive arm assembly. (Fig. 2)
7. Remove the sweep stop from the sweep drive arm assembly. Set the sweep stop and mounting hardware aside. (Fig. 2)
8. Apply a coat of blue Loctite® 243™ onto the threads of the M6 hex screw (12) to be used to install the idler sheave onto the drive shaft (5). (Fig. 2)
9. Place a key (8) into the notch in the drive shaft (5) where the idler sheave is to be installed and use one M6 hex screw (12), one Belleville washer (11), and one flat washer (9) to install the idler sheave onto the drive shaft (5). (Fig. 2)
10. Apply a coat of blue Loctite® 243™ onto the threads of the M6 hex screw (10) to be used to install the brush drive plug onto the drive shaft (5). (Fig. 2)
11. Place a key (8) into the notch at the other end of the drive shaft (5) and use one M6 hex screw (10), one Belleville washer (11), and one flat washer (9) to install the brush drive plug onto the drive shaft (5). (Fig. 2)
12. Apply a coat of blue Loctite® 243™ onto the threads of the M6 hex screw (12) to be used to install the brush drive motor sheave onto the brush drive motor. (Fig. 2)
13. Place a key (14) into the notch in the brush drive motor and use one M6 hex screw (12), one Belleville washer (11), one flat washer (9), and a spacer (13) to install the brush drive motor sheave onto the brush drive motor. (Fig. 2)
14. Install the sweep stop onto the sweep drive arm assembly. (Fig. 2)
15. Use the saved hardware to secure the brush drive motor to the sweep drive arm assembly. (Fig. 2)
16. Use two M10 hex screws (15) to install the new sweep drive arm assembly assembled in the previous steps onto the machine. (Fig. 2)
17. Use two M6 hex screws (18) to install belt installation tool (17) onto the idler sheave. (Fig. 4)
18. Position the belt (16) onto the smaller sheave and then over onto the belt installation tool (17). (Fig. 2)

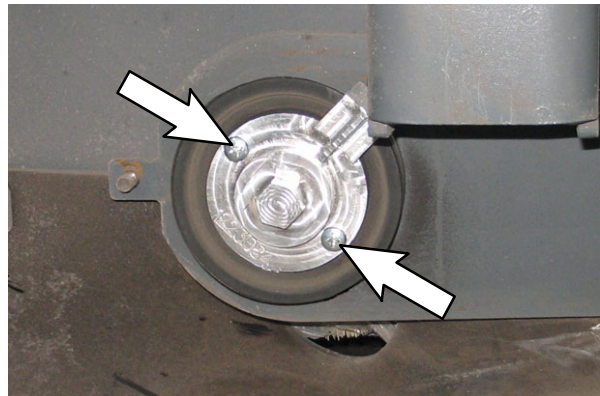

**FIG. 4**

19. Turn the belt installation tool (17)/sheave clockwise to install the belt (16) onto both sheaves. (Fig. 5)

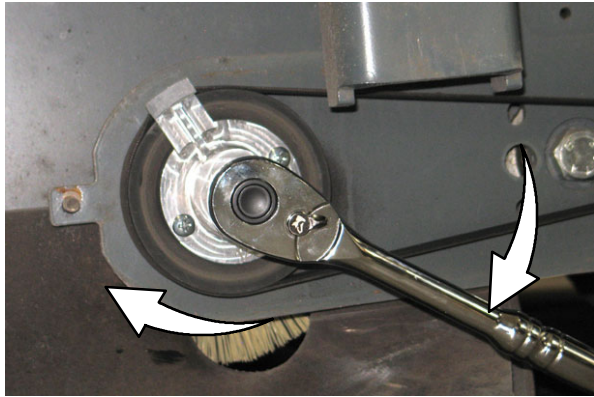

**FIG. 5**

20. Rotate the belt on the sheaves and use fingers to work the belt the rest of the way onto the sheaves.

*NOTE: Take care to not pinch fingers in the belt (16) and the sheaves while rotating the belt onto the sheaves.*

21. Remove the belt installation tool (17) from the sheave.
22. Reconnect the main wire harness to the direct throw main brush motor. (Fig. 2)
23. Reconnect the battery cable to the machine.
24. Turn the key switch ON, turn on sweep mode, drive a short distance to allow the sweep head to completely lower, and turn the key switch OFF.

25. Observe sweep head frame position with the floor. If the frame is touching the floor use the sweep head stop adjustment to adjust the sweep head so only the brush, and not the sweep head frame is touching the floor. (Fig. 6)

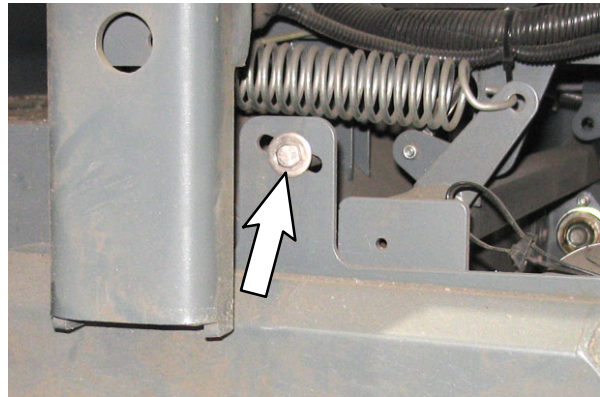

**FIG. 6**

26. Turn the key switch ON, raise the scrub head, and turn the key switch OFF.
27. Reinstall the belt cover onto the machine. (Fig. 2/Fig. 3)
28. Reinstall the the sweep brush into the sweep compartment. Refer to the *MAINTENANCE SECTION* of the *OPERATOR MANUAL* for instructions how to reinstall the brushes into the machine.
29. Reinstall the left brush panel onto the machine. (Fig. 1/Fig. 3)

---

**Bill Of Materials For Arm Kit, Drive, Swp, Direct, Afmkt [M17] - 9018837**

<b>Ref.</b>	<b>Tennant Part No.</b>	<b>Description</b>	<b>Qty.</b>
1	1231518	Arm Wldt, Drive, Swp	1
2	28010	Bearing, Ball, 0.62b 1.38d 0.43w	2
3	1219608	Spacer, Brg	1
4	18136	Ring, Retaining, Ext, 0.59d, Basic	1
5	1231524	Shaft, Drive	1
6	01513	Ring, Retaining, Int, 1.38d, Basic	1
7	01516	Ring, Retaining, Ext, 0.59d, Basic	1
8	00911	Key, Sq, 0.19 X 0.19, 0.75l	2
9	1017218	Washer, Flat, 0.32b 1.00d .12, SS	3
10	11329	Screw, Hex, M6 X 1.00 X 16, NI, SS	1
11	41185	Washer, Belleville, .25	3
12	06944	Screw, Hex, M6 X 1.00 X 25, 8.8	2
13	1241255	Spacer, Drive, Swp	1
14	1014328	Key, Sq, 05mm X 05mm, 25mml	1
15	09770	Screw, Hex, M10 X 1.50 X 25, NI, SS	2
16	1227083	Belt Kit, Swp, Direct, Afmkt [M17]	1
17	1223084	Tool, Installation, Belt	1
18	06942	Screw, Hex, M6 X 1.00 X 16, 8.8	2
18	09164	Screw, Pan, Phl, M8 X 1.00 X 20, 4.8	2

TENNANT COMPANY  
10400 Clean Street  
Eden Prairie, MN 55344- 2650