



INSTRUCTION BULLETIN

No. 9012516
Machine: T16
Published: 11-2014
Rev. 00

NOTE: DO NOT DISCARD the Parts List from the Instruction Bulletin. Place the Parts List in the appropriate place in the machine manual for future reference. Retaining the Parts List will make it easier to reorder individual parts and will save the cost of ordering an entire kit.

NOTE: Numbers in parenthesis () are reference numbers for parts listed in Bill of Materials.

Installation instructions for **kit number 9012508**

SYNOPSIS:

This kit contains the parts needed to replace the controller on T16 scrubbers.
Please follow step-by-step instructions.

SPECIAL TOOLS / CONSIDERATIONS: NONE

(Estimated time to complete: 2 hours)



PROTECT THE ENVIRONMENT

Please dispose of packaging materials, used machine components such as batteries and fluids in an environmentally safe way according to local waste disposal regulations.

Always remember to recycle.

PREPARATION:

1. Park the machine on a clean level surface, turn off the machine, and remove the key.

FOR SAFETY: Before leaving or servicing machine, stop on level surface, turn off machine, and remove key.

2. Disconnect the battery cable from the machine.



WARNING: Always disconnect battery cables from machine before working on electrical components.

INSTALLATION:

*NOTE: **Do Not** discard any removed parts unless instructed to do so. Set removed parts aside. Most parts are later reinstalled onto the machine.*

1. Remove the hardware holding the electrical panel to the machine. (Fig. 1)

NOTE: Mark the back of the electrical panel with wire locations to make later reassembly easier.



FIG. 1

2. Remove the access panel from the machine. (Fig. 5)

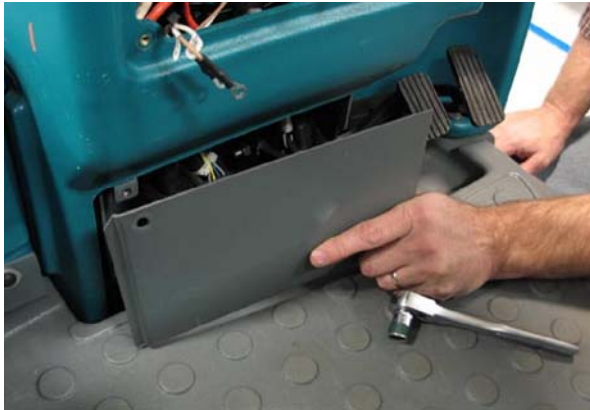

FIG. 2

3. Loosen the set screws from the bracket inside the steering weldment. (Fig. 6)

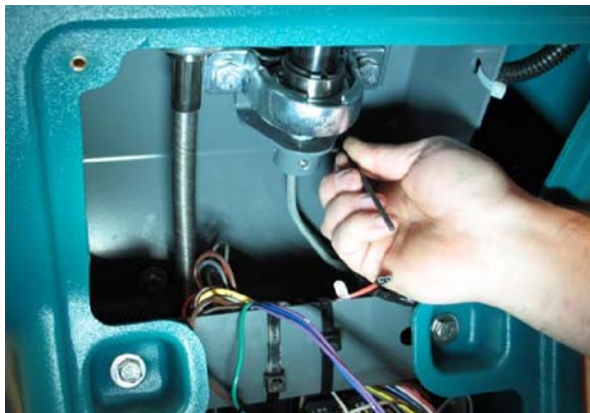

FIG. 3

4. Disconnect the main wire harness from the steering touch panel assembly.
5. Pull the steering touch panel assembly out from the steering assembly. (Fig. 4)



FIG. 4

6. Remove the 1-11/16 in jam nut from the steering assembly. (Fig. 5)



FIG. 5

7. Remove the steering wheel from the machine. (Fig. 5)



FIG. 6

8. Remove both control panels from the machine.
(Fig. 7 / Fig. 8)

NOTE: Mark panels with wire locations to make later reassembly easier.



FIG. 7

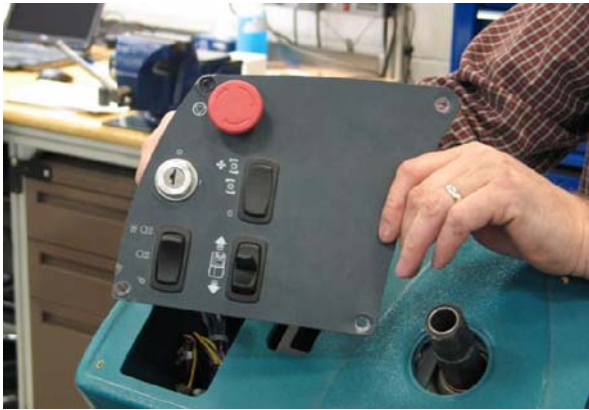

FIG. 8

9. Remove the headlight, if equipped, from the shroud. (Fig. 9)



FIG. 9

10. Remove the hardware securing the shroud to the machine and lift the shroud from the machine. (Fig.10)

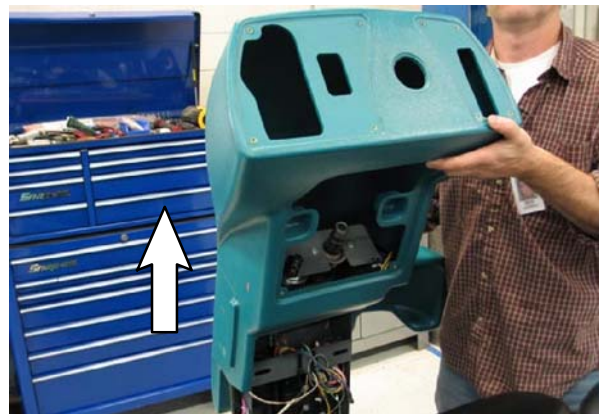

FIG. 10

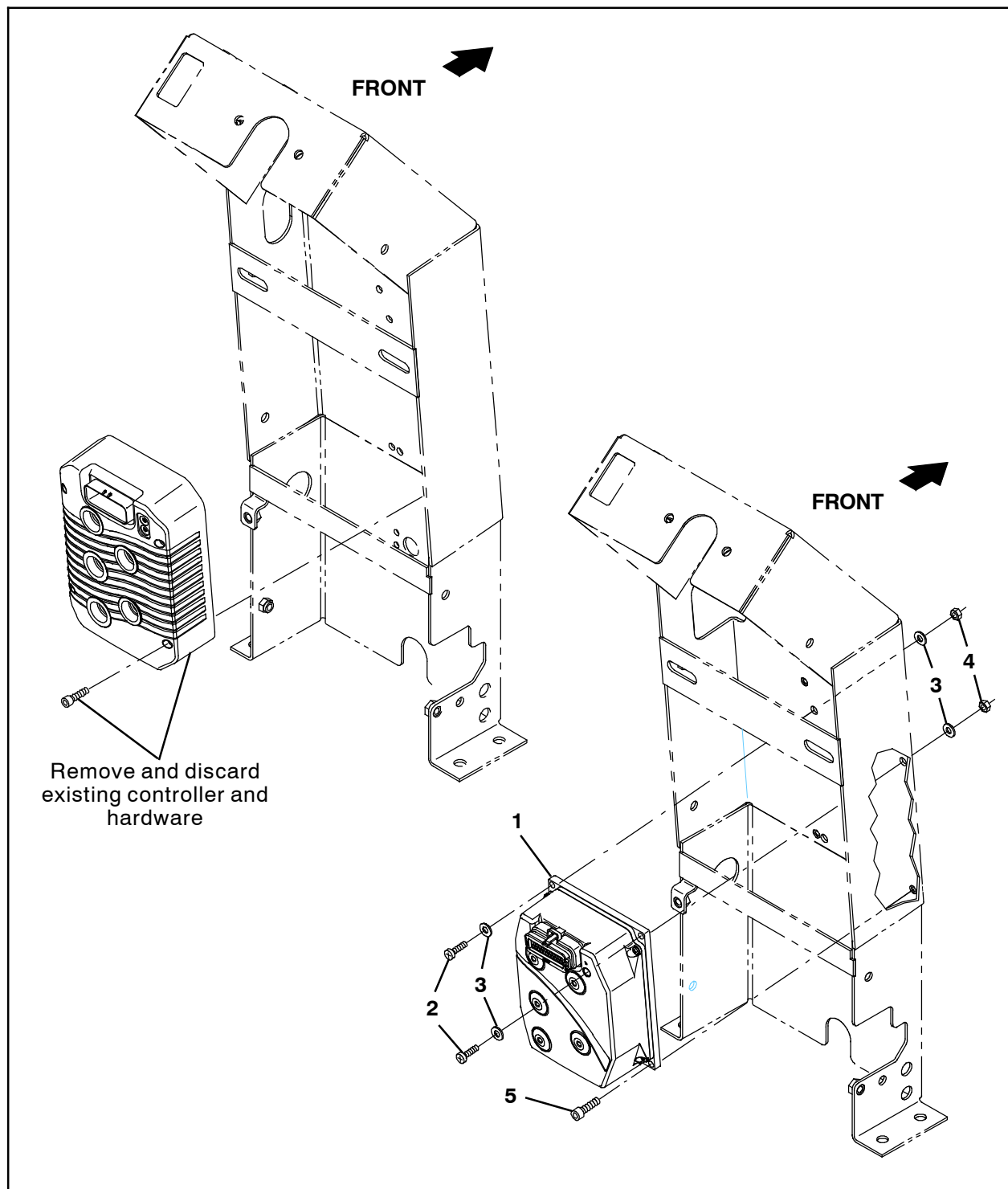

FIG. 11

11. Disconnect the main wire harness from the controller and remove the controller from the machine. Discard the removed controller and hardware. (Fig. 11)

12. Use two M5 pan screws (2), four flat washers (3), two M5 hex nuts (4), and one M6 socket screw (5) to install the new controller (1) onto the machine. (Fig.11)

13. Straighten the front wheel so it is pointing forward. (Fig. 12)

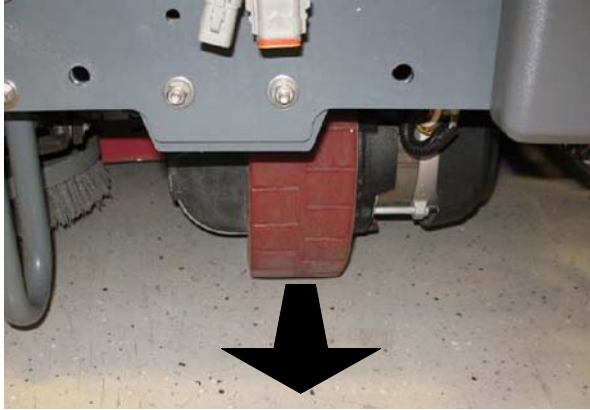

FIG. 12

14. Install the steering wheel. **DO NOT INSTALL THE JAM NUT ONTO THE STEERING WHEEL / STEERING COLUMN.**
15. Position the steering wheel on the steering column as shown in Fig. 13.

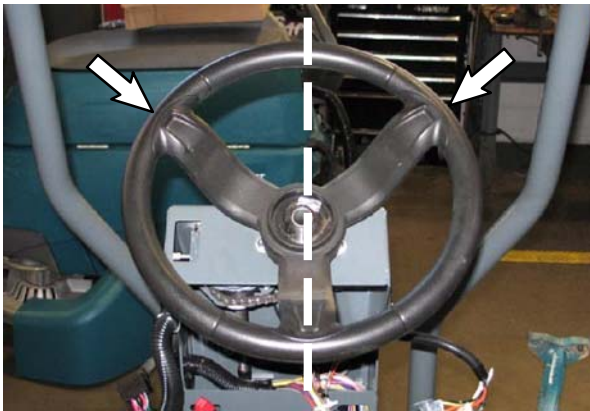

FIG. 13

16. Chock the rear wheels of the machine and jack the machine up until the front wheel is approximately 25mm (1 in) off the floor.
17. Turn the steering wheel so the front wheel is again pointing straight to the front of the machine.
18. Lower the machine to the floor and remove the jack from under the machine.
19. Reinstall the shroud onto the machine.
20. Reinstall the headlight, if equipped, onto the shroud.
21. Reinstall the control panels onto the shroud.
22. Reinstall the access panel onto the shroud.
23. Reinstall the steering wheel jam nut. Torque the jam nut to 68 Nm (50 ft / lbs).
24. Reinstall the steering touch panel assembly into the steering assembly and reconnect the main wire harness to the steering touch panel assembly
25. Reconnect the battery cables to the batteries.
26. Start and test the machine. Operate the machine and ensure all cleaning functions are fully operational.

Bill of Materials For Controller Kit, CI [T16] - 9012508

Ref.	Tennant Part No.	Description	Qty.
▽	9012508	Controller Kit, CI [T16]	1
▲ 1	1073647	Controller, Propel, 36vdc 200a [AC]	1
▲ 2	24196	Screw, Pan, Phl, M5 X 0.80 X 20, SS	2
▲ 3	01683	Washer, Flat, 10, SS	4
▲ 4	09739	Nut, Hex, Lock, M5 X 0.80, NL, SS	2
▲ 5	33951	Screw, Soc, M6 X 1.00 X 20, 12.9	1

TENNANT COMPANY
P. O. Box 1452
Minneapolis, MN 55440-1452