

Switch Replacement Kit

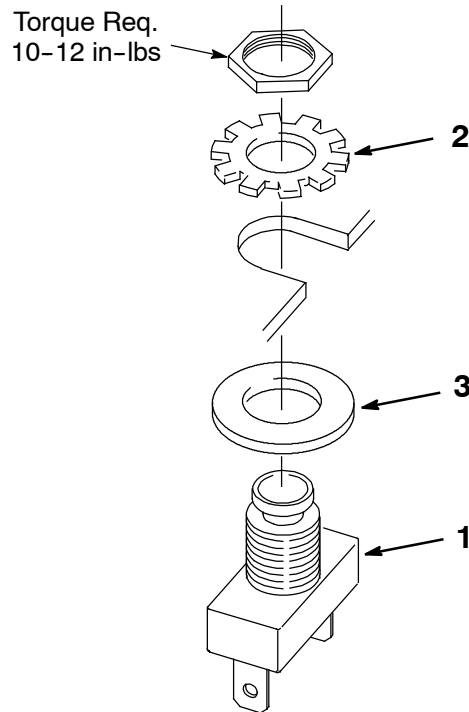

NOTICE: The original switch (p/n 130712) has been discontinued and replaced by this kit. To improve switch retention and durability when installing replacement switch, use the supplied washers as shown below.



KIT CONTENTS:

REF	PART #	DESCRIPTION	QTY.
▽	9008568	SWITCH KIT, W/ WASHERS	1
▲ 1	NA	SWITCH, PUSH, SPST, NO	1
▲ 2	1065856	WASHER, FLAT, 0.52B 0.88D .06, STL, PL	1
▲ 3	1067431	WASHER, LOCK, EXT, 0.50 STL, PL	1