



INSTRUCTION BULLETIN

No. 9006871
Machine: T15, 7200
Published: 08-2009
Rev. 00

NOTE: DO NOT DISCARD the Parts List from the Instruction Bulletin. Place the Parts List in the appropriate place in the machine manual for future reference. Retaining the Parts List will make it easier to reorder individual parts and will save the cost of ordering an entire kit.

NOTE: Numbers in parenthesis () are reference numbers for parts listed in Bill of Materials.

Installation instructions for **kit number 9006872**

SYNOPSIS:

This kit contains the parts needed to replace the scrub head actuator and spring mounting channel on T15 / 7200 machines with actuator located inside the battery compartment. Discard the spring mounting channel and replace only the actuator if the actuator is located elsewhere on the machine. (machines with rollout battery option)
Please follow step-by-step instructions.

SPECIAL TOOLS / CONSIDERATIONS: NONE

(Estimated time to complete: 1 hour)

PREPARATION:

1. Park the machine on a clean level surface, lower the scrub head, turn off the machine, remove the key, and set the parking brake.

FOR SAFETY: Before leaving or servicing machine, stop on level surface, turn off machine, and remove key.

2. Disconnect the battery cables from the batteries.



WARNING: Always disconnect battery cables from machine before working on electrical components.

3. Open the battery cover / operator seat and lock the seat open.
4. Disconnect the main wire harness from the seat switch.
5. Remove the battery compartment cover / seat from the machine. Set the removed components and hardware aside.

INSTALLATION: (Machines with scrub head actuator located in battery compartment only)

1. Disconnect the actuator shaft from the lift channel. Set the cotter pin and clevis pin aside. Refer to Fig. 1.
2. Remove the actuator assembly from the machine. Set all mounting hardware aside. Refer to Fig. 1.
3. Remove the spring mounting channel and actuator from the mounting bracket. Set all mounting hardware and components aside. Discard the actuator and spring mounting channel. Refer to Fig. 1.
4. Install the new spring mounting channel (1) and actuator (2) onto the mounting bracket. Refer to Fig. 1.
5. Install the actuator assembly onto the actuator support bracket. Refer to Fig. 1.
6. Install the shaft of the new actuator (2) onto the lift channel. Refer to Fig. 1.
7. Reinstall the battery compartment cover / seat onto the machine and reconnect the main wire harness to the seat switch.
8. Reconnect the battery cables to the batteries.

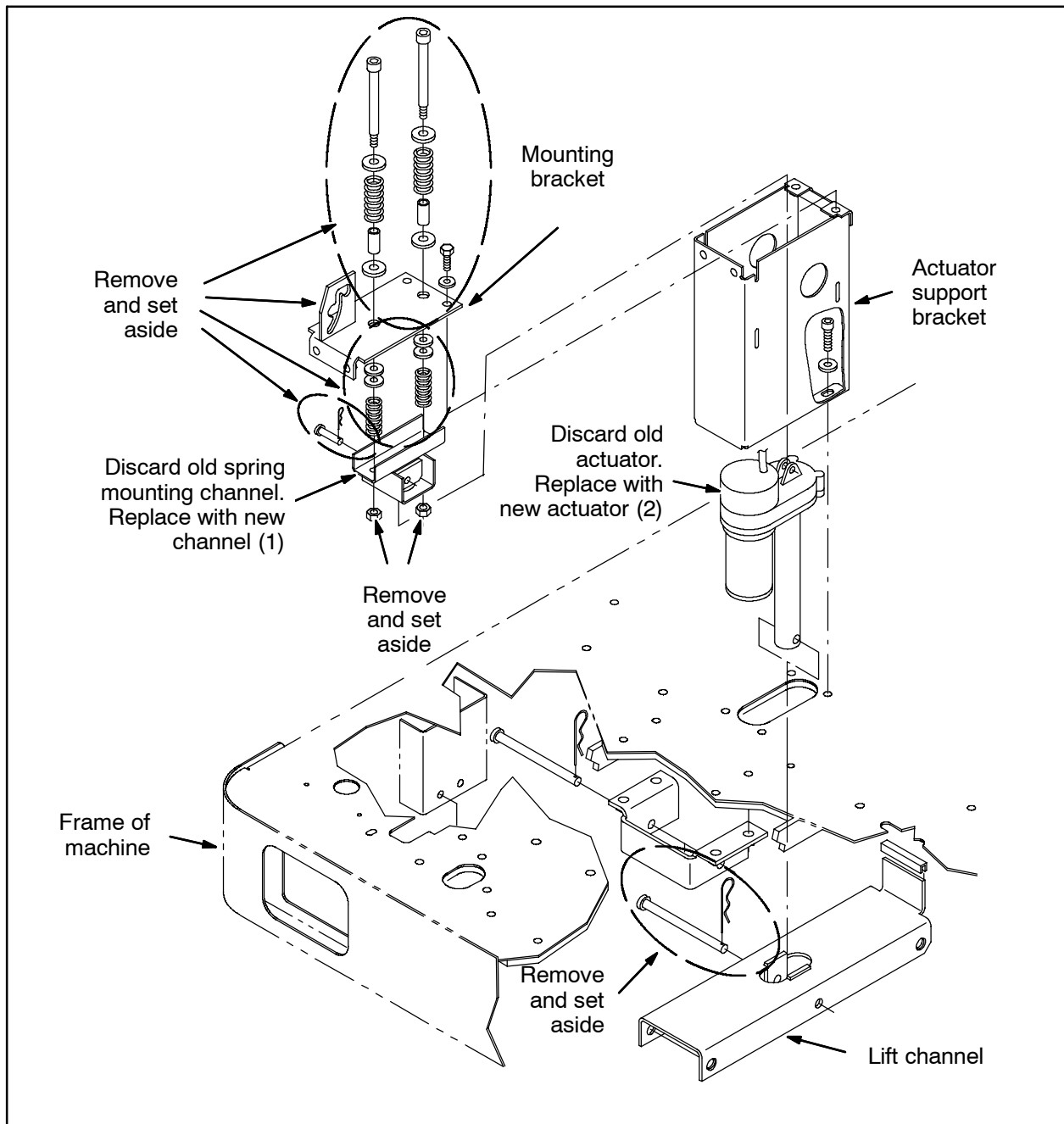

FIG. 1

Bill of Material for Actuator Kit, Replmt [T15] - 9006872

Ref.	Tennant Part No.	Description	Qty.
▽	9006872	Actuator Kit, Replmt [T15]	1
▲ 1	1057894	Channel Wldt, Mtg, Actuator / Spring	1
▲ 2	1053340	Actuator, 36VDC [Head Lift]	1

TENNANT COMPANY
P. O. Box 1452
Minneapolis, MN 55440-1452