



Brush Motor Replacement Kit

Models: T7 Cylindrical / Speed Scrub Rider Cylindrical



This motor replacement kit is intended for machines manufactured before serial number 10405584. Brush motor p/n 604980 has been discontinued and replaced by this kit which includes additional parts for proper installation. Carefully follow the installation instructions below.

INSTALLATION INSTRUCTIONS:

⚠ WARNING: Electrical Hazard. Disconnect Battery Cables Before Servicing Machine.

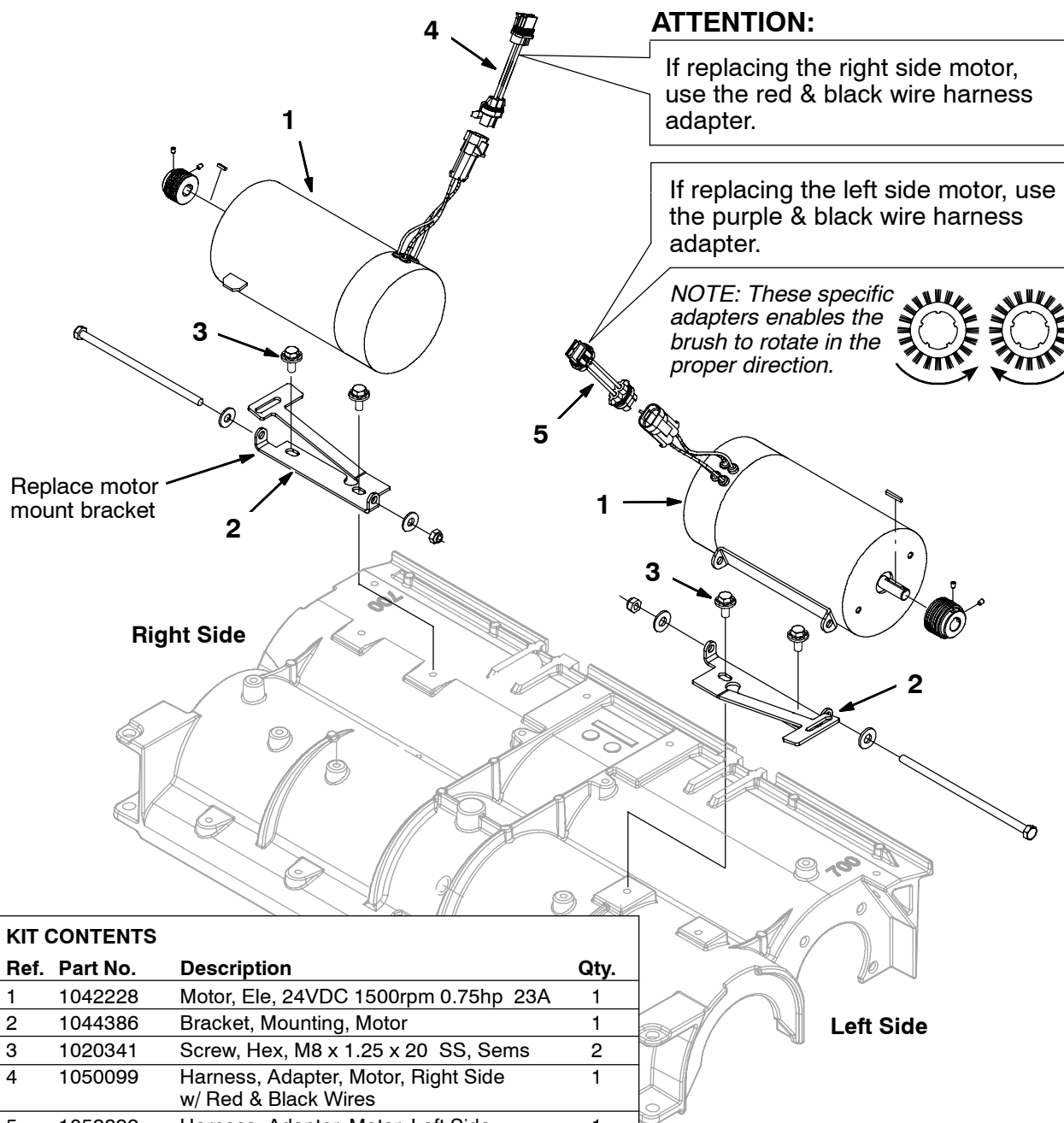

KIT CONTENTS

Ref.	Part No.	Description	Qty.
1	1042228	Motor, Ele, 24VDC 1500rpm 0.75hp 23A	1
2	1044386	Bracket, Mounting, Motor	1
3	1020341	Screw, Hex, M8 x 1.25 x 20 SS, Sems	2
4	1050099	Harness, Adapter, Motor, Right Side w/ Red & Black Wires	1
5	1052892	Harness, Adapter, Motor, Left Side w/ Purple & Black Wires	1