



Model: 7100

# RECOVERY TANK REPLACEMENT KIT



## NOTICE: Machines Manufactured before S/N 10130121

If the machine was manufactured before serial number 10130121, you will need to replace the liquid level sensor with the new sensor assembly supplied with kit. The new tank is not compatible with old style sensor. Install new sensor assembly as illustrated below.

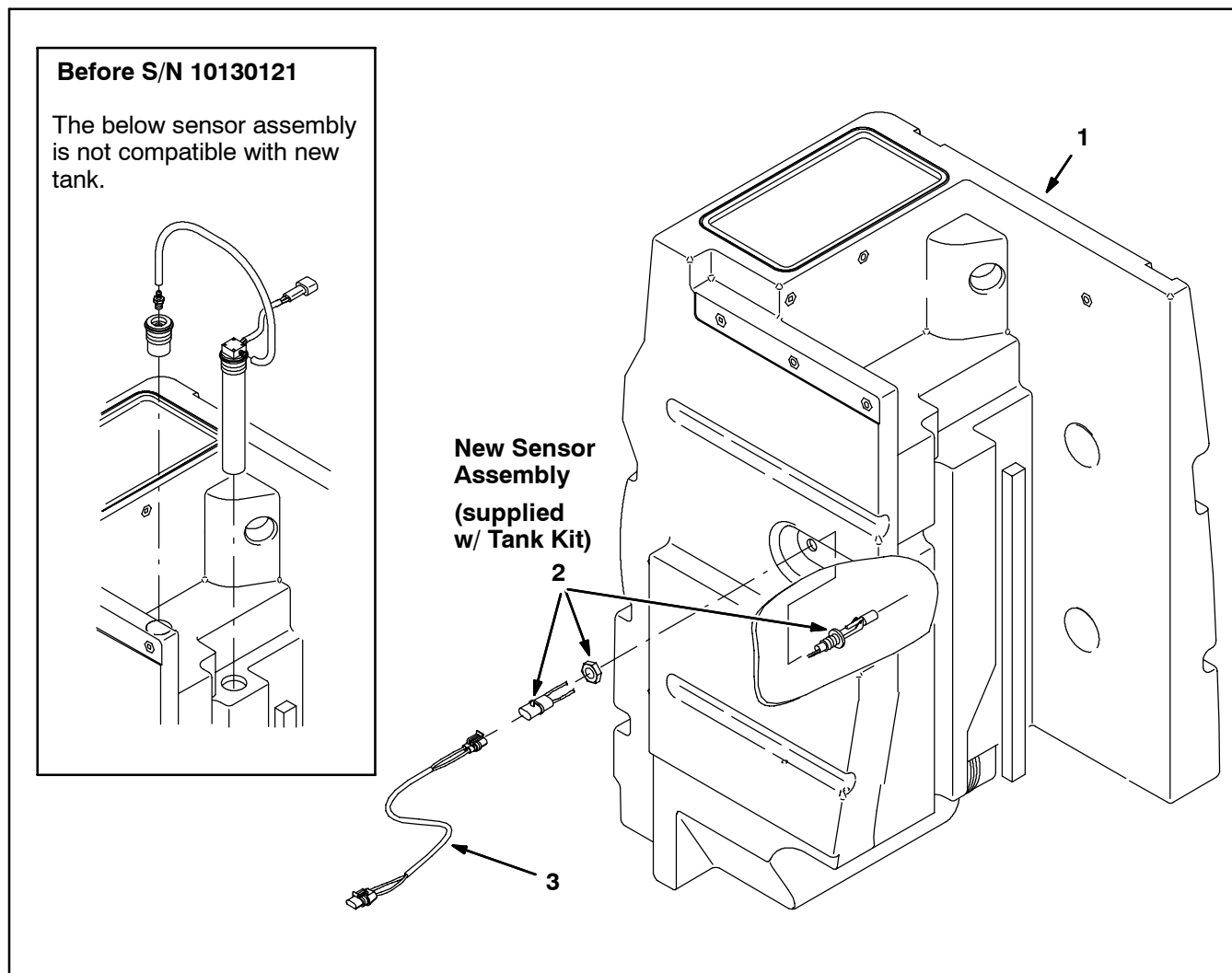

## KIT CONTENTS:

REF	PART #	DESCRIPTION	QTY.
▽ 1	390726	TANK KIT, RECOVERY	1
▲ 2	385685	SENSOR, LEVEL, LIQUID	1
▲ 3	1035054	HARNESS, SENSOR, JUMPER	1

**Please keep this sheet with your owner's manual for future reference.**