

SQUEEGEE CASTER RETROFIT KIT

This kit is designed to allow the squeegee support wheels to pivot in a forward direction when cleaning along walls and while turning. The two caster design also stabilizes the squeegee assembly.

INSTALLATION INSTRUCTIONS:

Installation Time: 1/2 Hour

TOOLS REQUIRED: Philips Screw Driver, 14mm Open End Wrench, 7/16", 1/2", 3/4" Socket Wrench.

1. Remove the old squeegee mount bracket from the machine as shown.

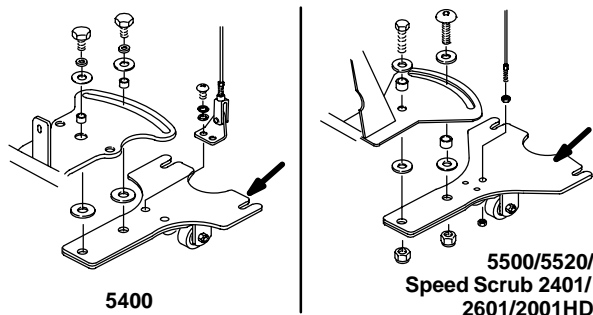

2. Install the new squeegee mount bracket, supplied with kit, in its place. Use existing hardware.
3. Remove the two bumper wheels from the squeegee assembly and install the new caster mounting brackets as shown.

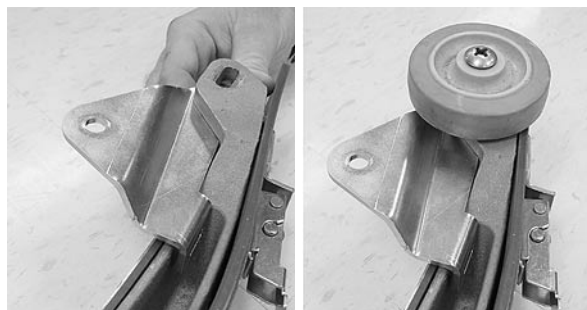

4. Install the casters onto the mounting brackets as shown. Do not tighten the caster nuts at this time.



KIT CONTENTS

P/N	DESCRIPTION	QTY.
1011342	BRACKET, SQUEEGEE MOUNT	1
1010488	BRACKET, CASTER MTG, SWIVEL, RH	1
1006347	BRACKET, CASTER MTG, SWIVEL, LH	1
1006343	CASTER, 2", M10 X 1.5 THD STEM	2
39312	NUT, HEX, STD, M10 X 1.5	4
611489	SCREW, TRS, .31-18 X 1.88, PHL, SS	2

5. With the squeegee assembly removed from the machine and placed on a level surface, adjust the height of the casters approximately 1/16" off the surface. Tighten nuts.

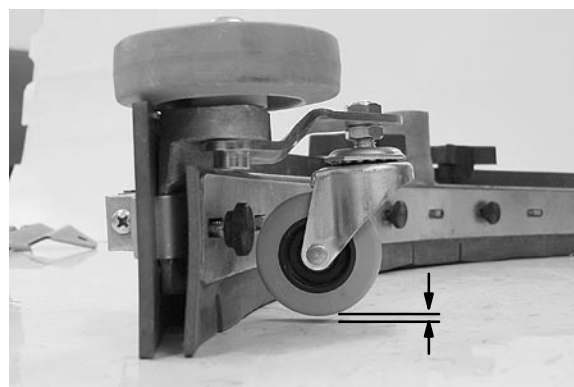

6. Attach the squeegee assembly to the machine. Lower the squeegee to floor and push the machine slightly forward. Check the blade for proper deflection. Readjust caster height if necessary.

