

KEY SWITCH KIT

Models: 2510, 2550, Speed Gleam and Speed Gleam Plus

INSTALLATION INSTRUCTIONS:

(Installation Time: 15 min.)

TOOLS REQUIRED: Phillips Screwdriver, 9/16" Wrench, 7/8" Wrench, Wire Cutters

FOR SAFETY: Before installing kit, disconnect positive (+) battery cable from batteries.

1. Remove four Phillips head screws from control console panel to access electrical components.
2. Remove key switch plug from panel.
3. Install key switch. Position switch face with arrow pointing upwards.
4. Connect wiring as instructed below.

KIT CONTENTS

P/N.	Description	Qty.
607475	Switch, Keylock, 12A	1
601222	Asm, Wire #14x12" Red (OBC w/ E-stop)	1

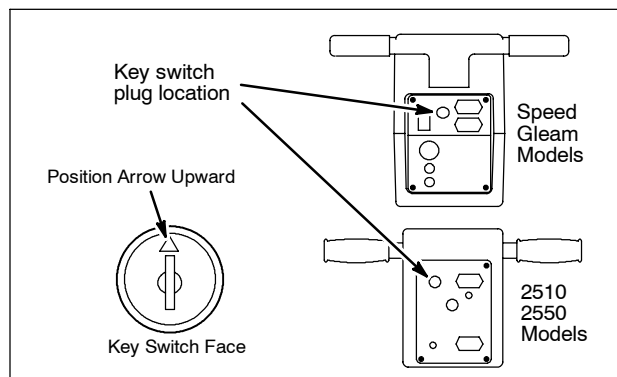

Main Wire Harness
inside Console

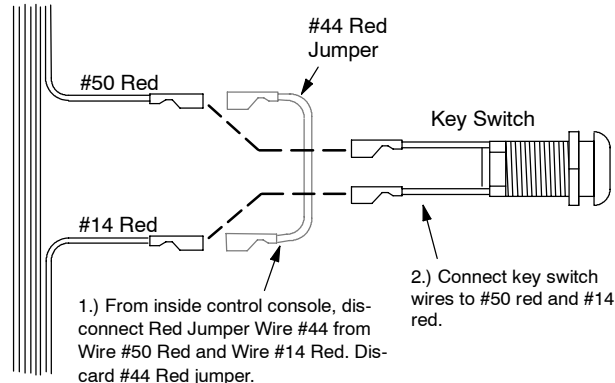

Machine equipped with Emergency Stop Button

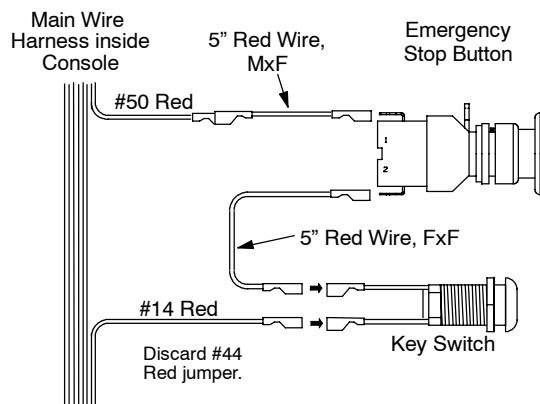

Machine equipped with On-board Battery Charger

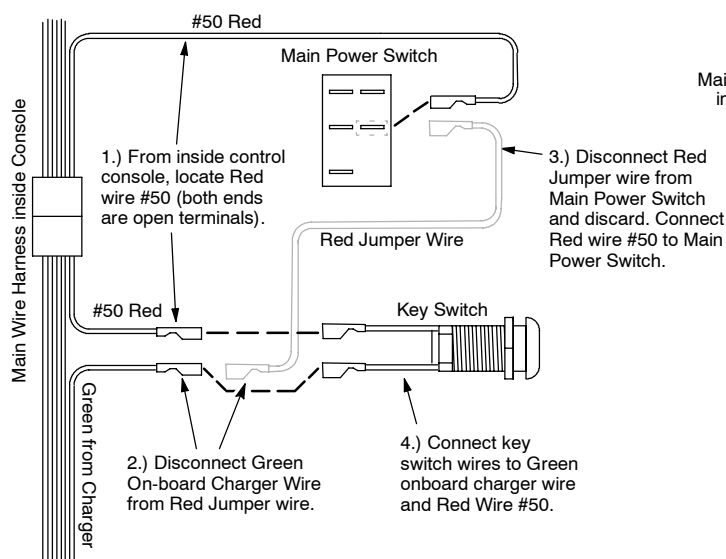

Machine equipped with On-board Battery Charger and Emergency Stop Button

