

MOTOR LIFT BRACKET KIT

INSTALLATION INSTRUCTIONS:

(Installation Time: 1 Hour)

TOOLS REQUIRED: 9/16" & 3/4" Socket Wrench, Pliers, Torque Wrench and Phillips Screwdriver.

NOTE: If installing multiple kits, thoroughly read all kit instructions prior to installation.

1. Turn machine power on. Press pad pressure switch (+) until actuator is fully extended. Turn machine power off.
2. Remove batteries and battery tray from machine, 9/16" wrench required.

FOR SAFETY: Wear protective gloves when handling batteries or battery cables. Avoid contact with battery acid.

3. Lay machine on it's side and remove pad driver, 1/2" socket wrench required (Figure 1). Stand machine upright after removing pad driver.



Fig. 1

4. Remove Motor Stop Bracket, Phillips screwdriver required (Figure 2).



Fig. 2

5. Remove (5) springs from motor and dispose (4) large springs, pliers required. If Spring Assist Kit #609348 was previously installed,

KIT CONTENTS

P/N.	Description	Qty.
603273	Bracket, Motor Lift Arm	2
140431	Spring, Ext. 1.00x5.00x.095	4

do not reuse small springs that are positioned inside of large springs (Figure 3).

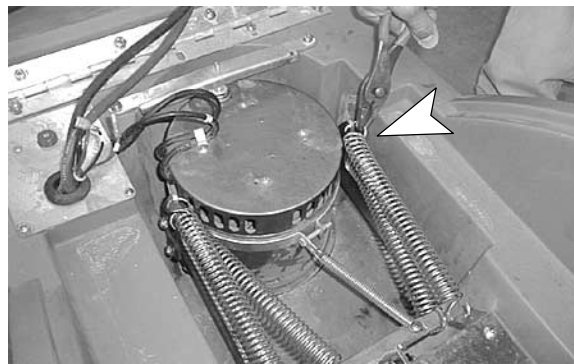

FIG. 3

6. Remove screws that fasten motor lift arm brackets to machine, 3/4" wrench required. Keep mounting hardware (Figure 4).

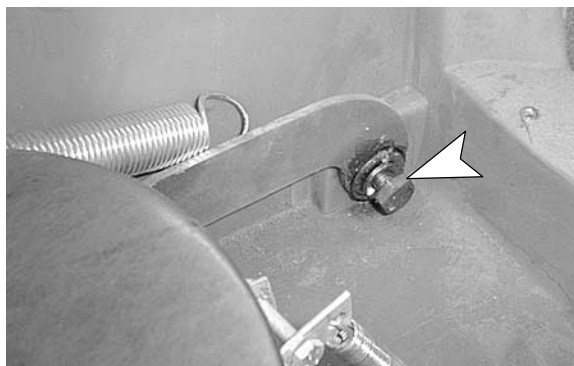

FIG. 4

7. Lift motor out and position as shown, do not disconnect wiring. Remove (2) brackets from motor and dispose, 9/16" wrench required. Keep mounting hardware (Figure 5).

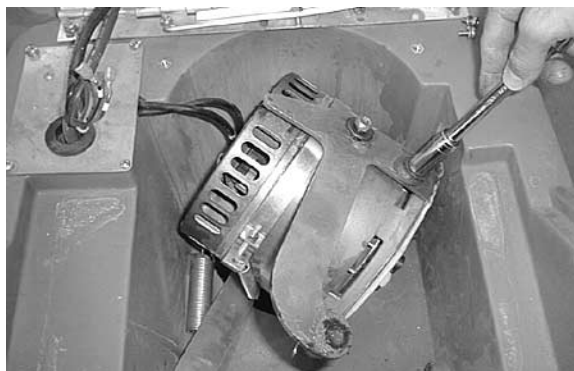

Fig. 5

INSTALLATION INSTRUCTIONS – Continued

8. Lubricate new bracket mounting holes (3 holes) with an all-purpose grease (Figure 6).



FIG. 6

9. Install new brackets using old hardware as shown (Figure 7). **IMPORTANT STEP: Using a torque wrench, tighten both nuts to 10 ft lbs (13.5 N-m) and then back nut off 1/4 turn. Brackets MUST be able to move freely. DO NOT OVER TIGHTEN NUTS. Repeat step for opposite side.**

NOTE: Make sure nylon washers stay in position when tightening.

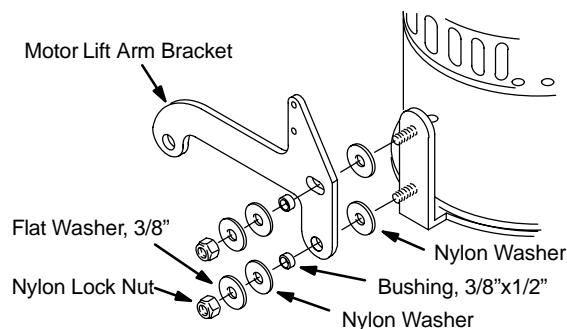

FIG. 7

10. Place motor back into position and fasten brackets to machine as shown. Put smooth side of washers against bushing. Using a torque wrench, tighten screws to 25 ft lbs (34 N-m) (Figure 8).

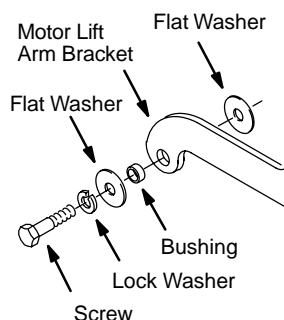

Fig. 8

11. Install (4) new springs and small spring, pliers required (Figure 9).



Fig. 9

12. Make sure motor tilts freely from side to side and moves up and down. **Motor MUST float freely for proper operation.**
13. Reinstall battery tray and batteries and check machine operation.