



INSTRUCTION BULLETIN

No. 340823
Machine: 7200
Published: 11-2006
Rev. 00

NOTE: DO NOT DISCARD the Parts List from the Instruction Bulletin. Place the Parts List in the appropriate place in the machine manual for future reference. Retaining the Parts List will make it easier to reorder individual parts and will save the cost of ordering an entire kit.

NOTE: Numbers in parenthesis () are reference numbers for parts listed in Bill of Materials.

Installation instructions for **kit number 9003011**

SYNOPSIS:

This kit contains the parts needed to replace the side brush motor on 7200 machines (below serial number 010926).

Please follow step-by-step instructions.

SPECIAL TOOLS / CONSIDERATIONS: NONE

(Estimated time to complete: 1.5 hours)

PREPARATION:

1. Park the machine on a clean level surface, turn off the machine, remove the key, and set the parking brake.

FOR SAFETY: Before leaving or servicing machine, stop on level surface, set parking brake, turn off machine, and remove key.

2. Disconnect the negative terminal from the battery.
3. Disconnect the positive terminal from the battery.



WARNING: Always disconnect battery cables from machine before working on electrical components.

INSTALLATION:

NOTE: Refer to Fig. 1 for locations of all parts and components disassembled/assembled in Steps 1 through 13.

1. Remove the side brush (A) from the machine. Set the side brush and retaining pin (B) aside.
2. Disconnect the wire harness from the side brush motor (C).
3. Disconnect the cable (O) from the motor (C). Set the hex screw (P), both flat washers (Q), and the sleeve (R) aside.

4. Disconnect the extension spring (N) from the motor mounting bracket (M).
5. Remove the side broom hub (D) from the side brush assembly. Set the side broom hub and set screw (E) aside.
6. Remove the brush bumper guard (F) and motor (C) from the side brush assembly. Set the brush bumper guard and mounting screws (G) and washers (H) aside.
7. Remove the motor mounting bracket from side brush assembly. Set the clevis pin (S), cotter pin (T), and washer (U) aside.
8. Remove the side brush plate (I) from the side brush assembly. Set the side brush plate and mounting screws (J) and washers (K) aside.
9. Remove the spring (L) from inside the motor mounting bracket (M). Set the spring aside.
10. Remove the woodruff key (V) from the motor (C). Set the woodruff key aside.
11. Discard the old motor (C) and motor mounting bracket (M).
12. Install the woodruff key (V) into the new motor (1).
13. Reassemble parts removed from the side brush assembly, with the new motor (1) and motor mounting bracket (2), in the reverse order of which they were disassembled.

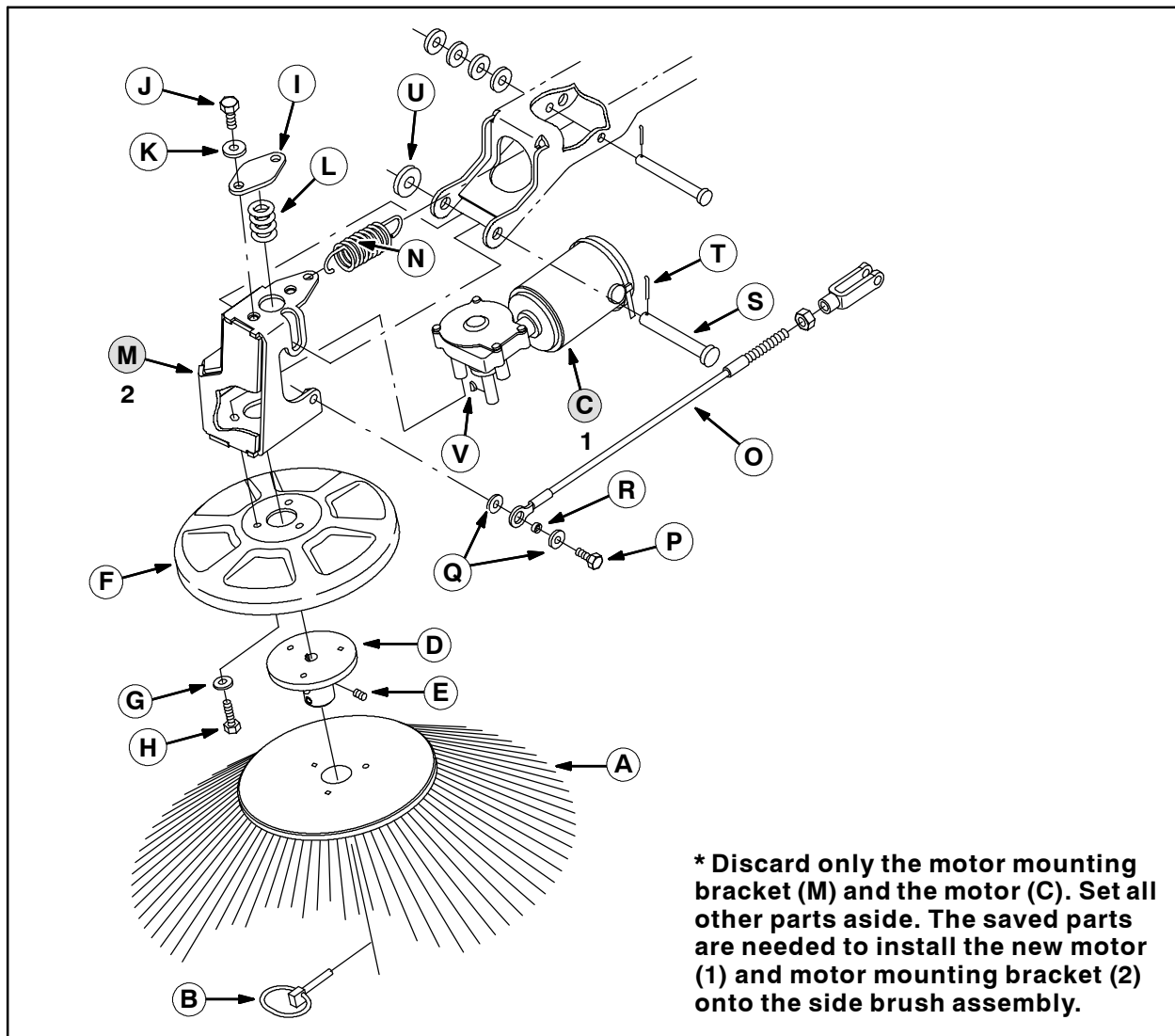

FIG. 1

14. Reconnect the positive terminal to the battery.
15. Reconnect the negative terminal to the battery.
16. Start the machine and test the side brush assembly.

Bill of Materials for Motor Kit, Side Brush, CI [7200]-9003011

Ref.	Tennant Part No.	Description	Qty.
▽	9003011	Motor Kit, Side Brush, CI [7200]	1
▲ 1	1034262	Motor, Ele, 36VDC 67RPM, RH Side*	1
▲ 2	1031717	Bracket Wldt, Mtg, Motor	1

** NOTE: It is not necessary to reorder this entire kit if replacing the motor after the kit has already been installed. Order just the motor (p/n #1034262).*

TENNANT COMPANY
P. O. Box 1452
Minneapolis, MN 55440-1452