



# INSTRUCTION BULLETIN

No. 340809  
Machine: T20  
Published: 03-2007  
Rev. 01

**NOTE: DO NOT DISCARD the Parts List from the Instruction Bulletin. Place the Parts List in the appropriate place in the machine manual for future reference. Retaining the Parts List will make it easier to reorder individual parts and will save the cost of ordering an entire kit.**

*NOTE: Numbers in parenthesis ( ) are reference numbers for parts listed in Bill of Materials.*

Installation instructions for **kit number 9002436**

## SYNOPSIS:

This kit contains the parts needed to install an instrument panel replacement kit on T20 machines. Please follow step-by-step instructions.

## SPECIAL TOOLS / CONSIDERATIONS: NONE

(Estimated time to complete: 1 hour)

*NOTE: Record hours from the hour meter before removing the old control panel from the machine. The new control panel (1) is set to zero hours. Tennant Service Representatives please call Business Administrative Associate (**NOT** Warranty).*

*NOTE: If custom settings are used (ask operator/customer), record settings before removing the control board from the machine. Machine defaults back to factory settings after circuit board is replaced. Down pressure, solution delivery, and detergent delivery settings must be changed back to custom settings if custom settings are used. Consult the Tennant Technical Support Group for instructions how to access, read, and reset custom settings.*

## PREPARATION:

1. Park the machine on a clean level surface, turn off the machine, remove the key, and set the parking brake.

**FOR SAFETY: Before leaving or servicing machine, stop on level surface, set parking brake, turn off machine, and remove key.**

2. First disconnect the negative terminal and then the positive terminal from the battery. Remove the battery from the machine.



**WARNING: Always disconnect battery cables from machine before working on electrical components.**

3. Disconnect the main wire harness from the circuit board.
4. Remove the two hex nuts holding the battery flap and retaining bar to the back of the dash panel. Set the battery flap and retaining bar aside. Mounting hardware has changed, discard existing hex nuts. Refer to Fig. 2.

5. Remove the two hex nuts holding the bottom of the control panel to the back of the dash panel. Mounting hardware has changed, discard existing hex nuts. Refer to Fig. 2.
6. Remove the instrument panel from the dash panel. **Do Not** discard the instrument panel. Send the instrument panel back to Tennant Warranty Department. Refer to Fig. 2.

## INSTALLATION:

1. Use four hex nuts (2) and four nylon bushings (3) to install the new control panel (1), battery cover, and retaining bar onto the dash panel. Refer to Fig. 2.

*NOTE: The nylon bushings (3) **must be installed** as shown in Fig. 2 to prevent static electricity from damaging the control panel (1).*

2. Reconnect the main wire harness to the control panel (1).
3. Set the battery into the battery compartment and reconnect the battery cables to the batteries. Reconnect the positive terminal first and then the negative terminal.

*NOTE: Refer to Steps 4 through 7 to reconfigure the control panel (1) so it matches the machine.*

4. To enter configuration mode: Simultaneously press and hold the 4/5 button (A) and Side Brush button (B) and turn the ignition switch to the on position (without starting machine). Refer to Fig. 1.

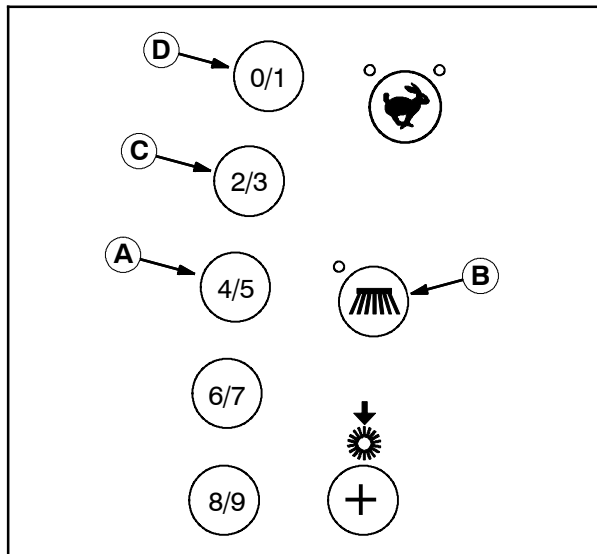

FIG. 1

5. To select configuration: Use the 2/3 button (C) to scroll to the proper mode (**ES**, **FaST**, or **No ES**, **No FaST** option from the menu) and use the 0/1 (D) button to select the applicable mode. Refer to Fig. 1.
6. If machine is equipped with the **Side Brush Sweep Only** option reenter the configuration mode and select **Side Brush Sweep Only** from the configuration menu. Refer to Fig. 1.
7. If machine is equipped with the **Disk Scrub Head** option, reenter the configuration mode (Refer to Step 4) and select **SEL BRUSH HEAD** from the menu. Use the **1-Step button** to select **DISK HEAD**. Turn the ignition switch off to save the changes.

*NOTE: If custom settings are used (ask operator/customer), record settings before removing the instrument panel from the machine. Machine defaults back to factory settings after the instrument panel is replaced. Down pressure, solution delivery, and detergent delivery settings must be changed back to custom settings if custom settings are used. Consult the Tennant Technical Support Group for instructions how to access, read, and reset custom settings.*

8. Start and test the machine. Verify the machine operates properly.

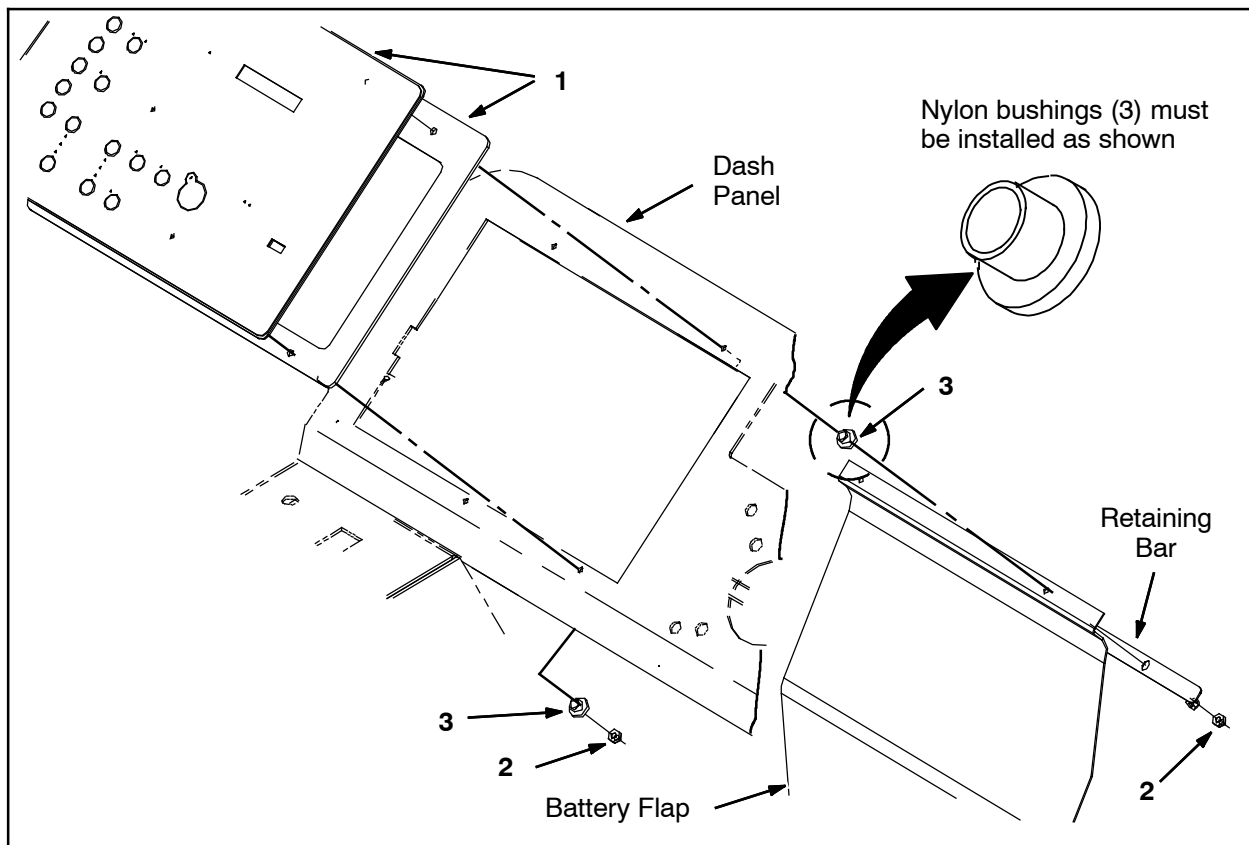

FIG. 2

---

**Bill of Materials for Panel Kit, Instmt, Replmt [T20]-9002436**

	<b>Ref.</b>	<b>Tennant Part No.</b>	<b>Description</b>	<b>Qty.</b>
▽		9002436	Panel Kit, Instmt, Replmt [T20]	1
▲	1	1027344	Panel Assy, Instmt, Afmkt [T20]	1
▲	2	33932	Nut, Hex, Lock, M4 X 0.70, NL, SS	4
▲	3	1029362	Washer, Shld, Nyl [8-32]	4

TENNANT COMPANY  
P. O. Box 1452  
Minneapolis, MN 55440-1452