



INSTRUCTION BULLETIN

No. 340803
Machine: S12
Published: 1-2006
Rev. 00

NOTE: DO NOT DISCARD the Parts List from the Instruction Bulletin. Place the Parts List in the appropriate place in the machine manual for future reference. Retaining the Parts List will make it easier to reorder individual parts and will save the cost of ordering an entire kit.

NOTE: Numbers in parenthesis () are reference numbers for parts listed in Bill of Materials.

Installation instructions for **kit number 384900**

SYNOPSIS:

This kit contains the parts needed to replace the filter cover gasket on the S12 sweeper.
Please follow step-by-step instructions.

SPECIAL TOOLS / CONSIDERATIONS: NONE

(Estimated time to complete: 1 hour)

PREPARATION:

1. Park the machine on a clean level surface, turn off the machine, remove the key, and set the parking brake.

FOR SAFETY: Before leaving or servicing machine, stop on level surface, turn off machine, and remove key.

2. Open the main cover until the cover locks completely open.
3. Loosen both clamps and remove the filter cover from the filter box. Refer to Fig. 1.



FIG. 1

INSTALLATION:

1. Remove the old filter gasket from the filter cover. Refer to Fig. 2. and Fig. 4.

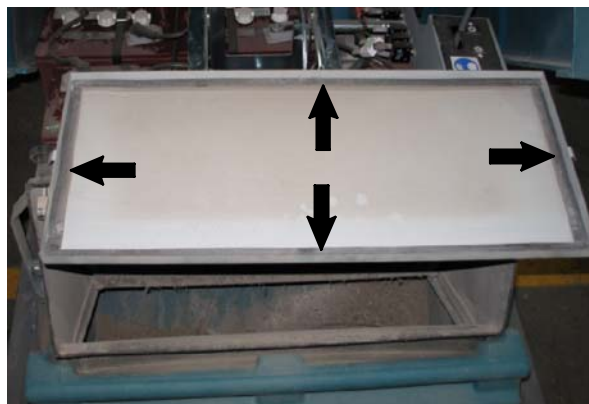

FIG. 2

2. Thoroughly clean any remaining remnants of gasket, dirt, and/or debris from the area of the filter cover where old gasket was previously installed. Refer to Fig. 2.
3. Install the new gasket (1) onto the filter cover where the old gasket was previously installed. Refer to Fig. 2 and Fig. 4.

4. Remove the hook from both clamps. Refer to Fig. 3.

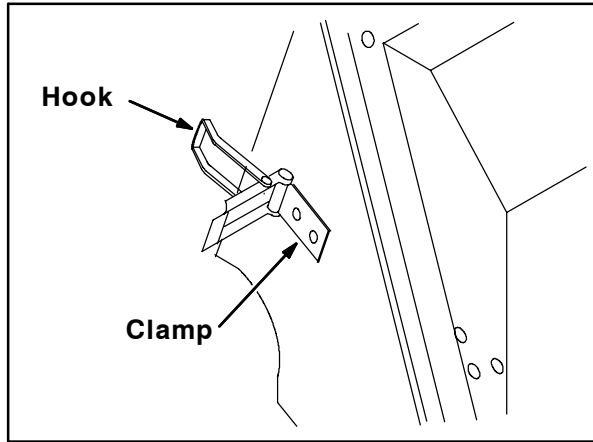

FIG. 3

5. Bend the hooks from the 35.5 mm length to a length of 30 mm.
6. Reinstall the hooks onto the clamps.
7. Reinstall the filter cover onto the filter box.
8. Close the main cover.
9. Start and test machine to ensure there is adequate vacuum in the brush compartment.

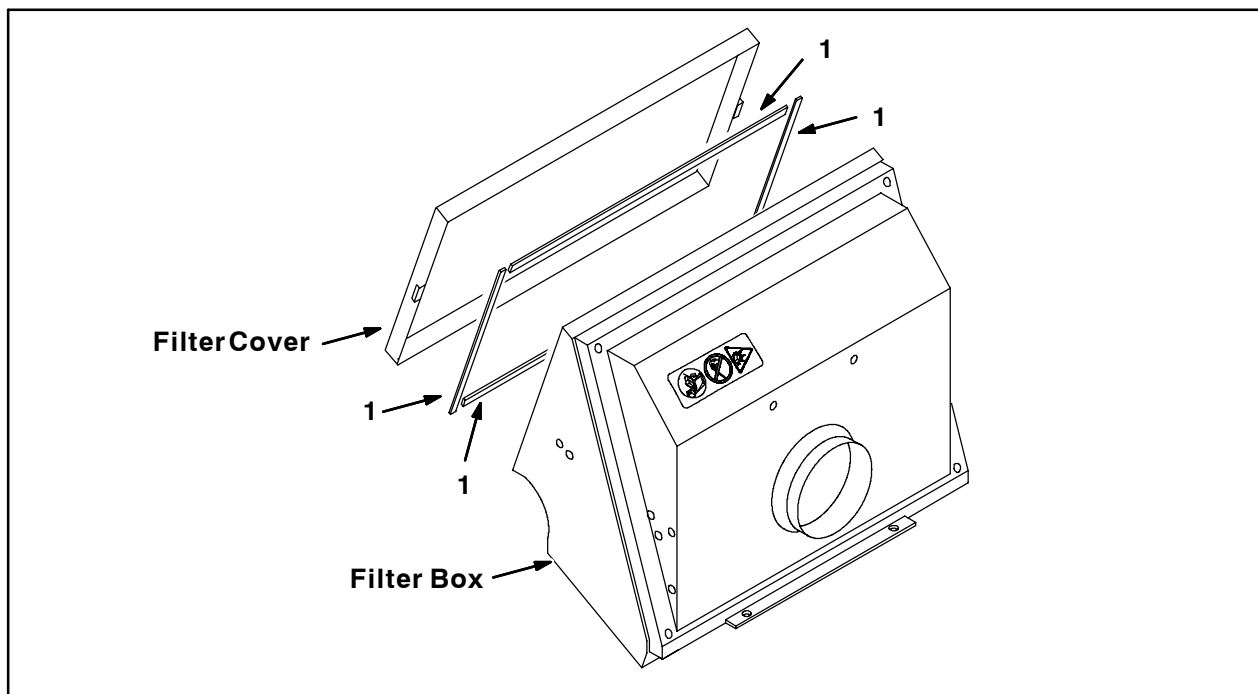

FIG. 4

Bill of Materials for Gasket Kit, F/384664, Replmt-384900

Ref.	Tennant Part No.	Description	Qty.
1	384900	Gasket Kit, F/384664, Replmt	1

TENNANT COMPANY
P. O. Box 1452
Minneapolis, MN 55440-1452