



INSTRUCTION BULLETIN

No. 340763
Machine: 6100/6100E/
7100/EZ Rider/7080
Published: 11-2005
Rev. 01

NOTE: DO NOT DISCARD the Parts List from the Instruction Bulletin. Place the Parts List in the appropriate place in the machine manual for future reference. Retaining the Parts List will make it easier to reorder individual parts and will save the cost of ordering an entire kit.

NOTE: Numbers in parenthesis () are reference numbers for parts listed in Bill of Materials.

Installation instructions for **kit number 377411**

SYNOPSIS / PROBLEM:

This kit contains the parts needed to replace the brake linkage on 6100, 7100, and EZ Rider machines.

Please follow step-by-step instructions.

SPECIAL TOOLS / CONSIDERATIONS: Floor jack or chain hoist

(Estimated time to complete: 2 hours)

PREPARATION:

1. Park the machine on a clean level surface.
2. Turn off machine, remove key, and set parking brake.

FOR SAFETY: Before leaving or servicing machine, stop on level surface, set parking brake, turn off machine, and remove key.

3. Disconnect the battery cables from the batteries.



WARNING: Always disconnect battery cables from machine before working on electrical components.

4. Block the rear wheels of the machine.

FOR SAFETY: When servicing machine, block machine tires before jacking up machine.

5. Use a jack to raise the front end of the machine. Refer to Operators Manual for more information about safely jacking up the machine.

FOR SAFETY: When servicing machine, use a hoist or jack that will support the weight of the machine.

FOR SAFETY: When servicing machine, jack machine up at designated locations only. Support the machine with jack stands.

INSTALLATION:

1. Loosen both hex screws securing the steering assembly housing to the machine frame. Refer to Fig. 1.

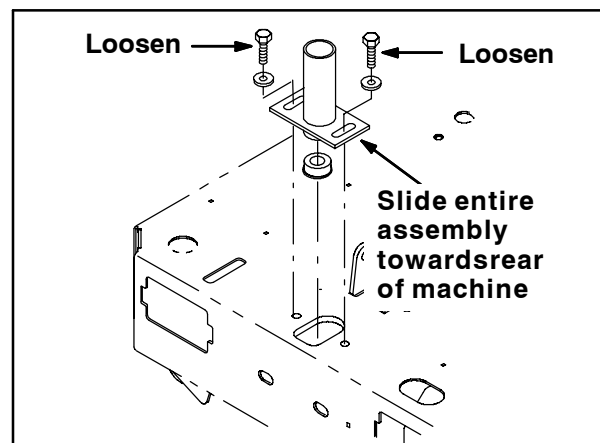

FIG. 1

2. Slide the steering assembly housing toward the rear of the machine to loosen the steering chain tension.

3. Remove the master link from the steering chain and remove the steering chain from the machine. Refer to Fig. 2.

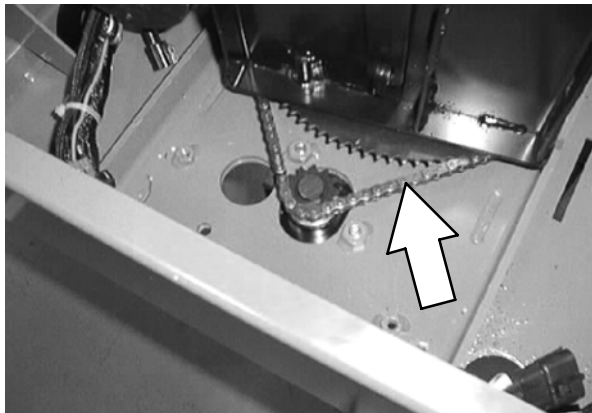

FIG. 2

4. Remove the cotter pin securing the brake link to the brake arm and remove the brake link from the side of the drive assembly. Set aside all loose parts. Refer to Fig. 3 or Fig. 4.

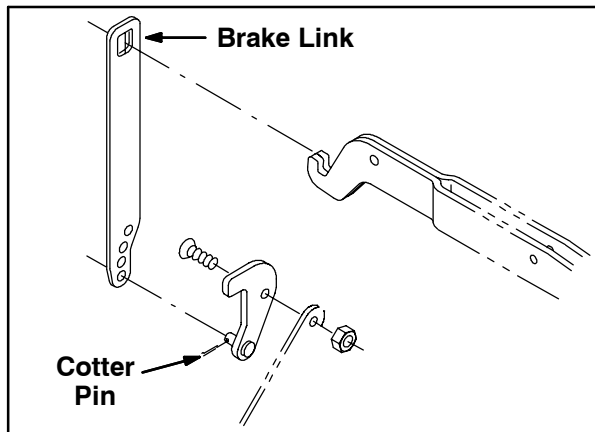

FIG. 3-Older Machines

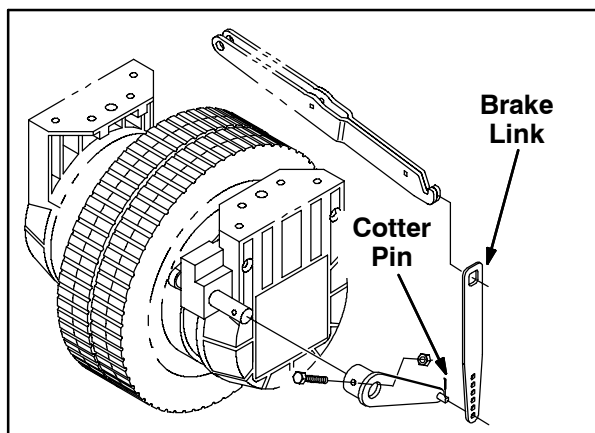

FIG. 4-Newer Machines

5. Remove the power wire cover from the side of the drive assembly. Refer to Fig. 4.

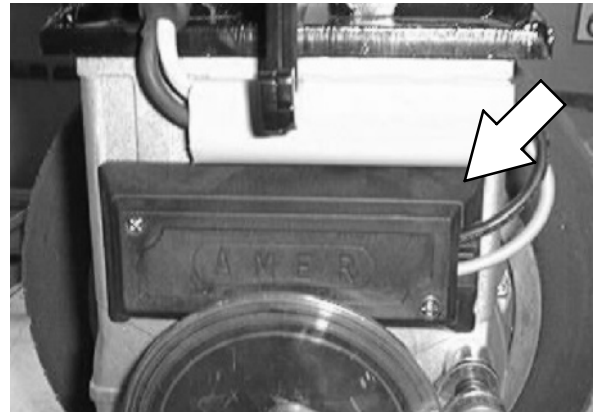

FIG. 5

6. Mark the locations of the wires connected to the drive assembly and then disconnect the wires from the assembly. Set aside all loose parts. Refer to Fig. 6.

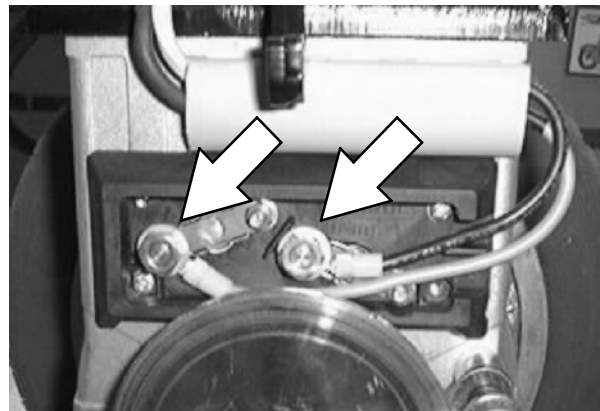

FIG. 6

7. Remove the cable clamp and pull the cable out from the duct sleeve. Set aside all loose parts. Refer to Fig. 7.

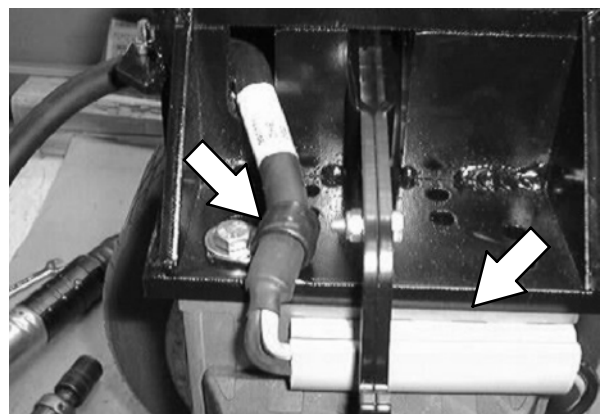

FIG. 7

8. Remove the hardware (A) securing the brake pedal assembly (B) to the machine. Set aside all loose parts. Refer to Fig. 8.

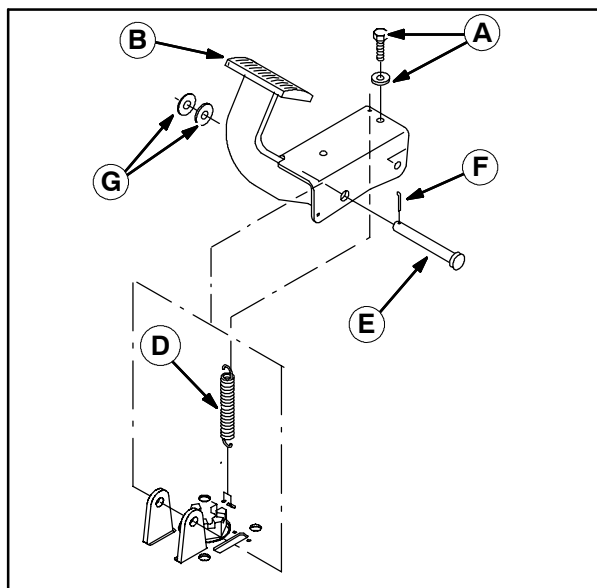

FIG. 8

9. Remove the clevis pin (E), cotter pin (F), and washers (G) from the brake pedal assembly (A). Set aside all loose parts. Refer to Fig. 8.
10. Disconnect the extension spring (D) from the brake pedal assembly (A). Set aside all loose parts. Refer to Fig. 8.
11. Remove the clevis pin (H) and cotter pin (J) from the brake mounting channel (K) and remove the brake mounting channel from the machine. Set aside the cotter pin. Discard the clevis pin. Refer to Fig. 9.

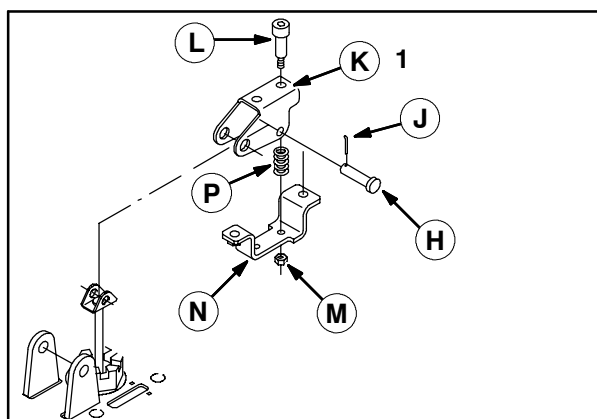

FIG. 9

12. Remove the bolts (L) and hex nuts (M) securing the spring mounting channel (N) and compression spring (P) to the brake mounting channel (K). Discard the brake mounting channel. Set aside the remaining parts. Refer to Fig. 9.

13. Use the bolts (L) and hex nuts (M) to install the compression spring (P) and spring mounting channel (N) onto the new brake mounting channel (1). Refer to Fig. 9.

14. Place a jack or blocks underneath the front drive assembly to support the assembly.

15. Remove the four button screws (Q) holding the front drive assembly to the machine and carefully remove the drive assembly from under the machine. Refer to Fig. 10.

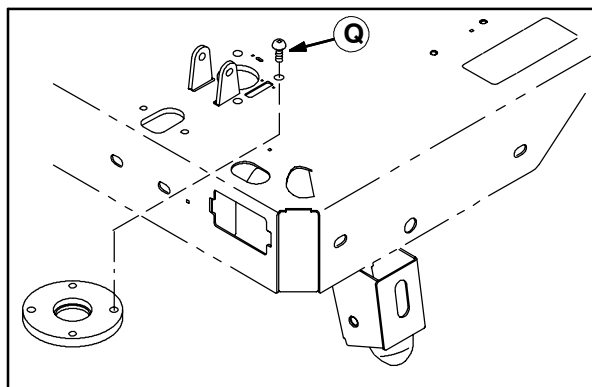

FIG. 10

16. Remove the cotter pin (R) and clevis pin (S) securing the left and right brake arms (T) to the upper brake link (U). Set aside the cotter pin and clevis pin. Refer to Fig. 11 and Fig. 12.

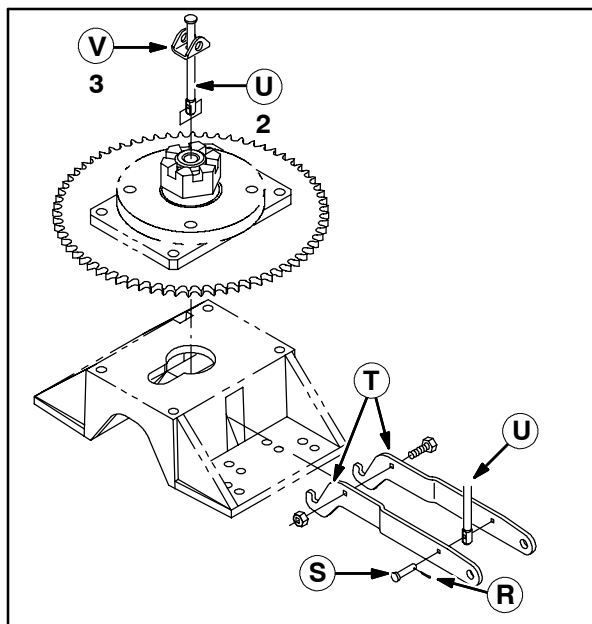

FIG. 11-Older Machines

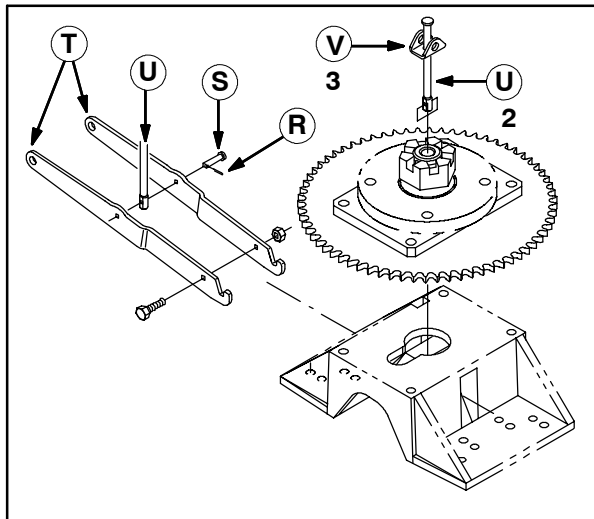

FIG. 12-Newer Machines

17. Remove the upper brake link (U) and brake channel (V) from the lower drive assembly. Discard the upper brake link and brake channel. Refer to Fig. 11 and Fig. 12.
18. Slide the brake channel (3) onto the brake link (2). Refer to Fig. 11 and Fig. 12.
19. Insert the brake link (2) into the lower drive assembly. Refer to Fig. 11 and Fig. 12.
20. Use clevis pin (R) and cotter pin (S) to secure the brake link (2) to the left and right brake arms (T). Refer to Fig. 11 and Fig. 12.
21. Use a floor jack to position the front drive assembly underneath the machine.
22. Use the button screws (Q) to reinstall the front drive assembly onto the machine. Refer to Fig. 13.

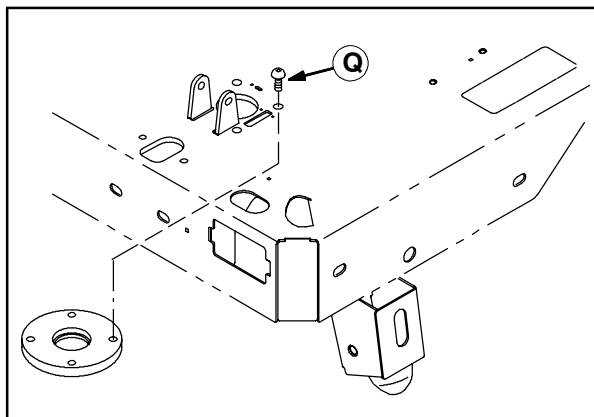

FIG. 13

23. Use the master link to reinstall the steering chain onto the machine. Refer to Fig. 14.

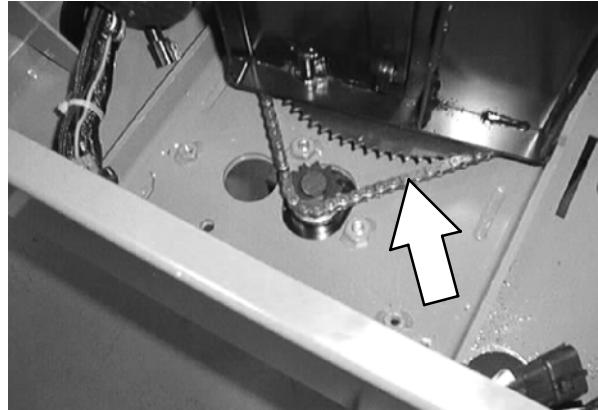

FIG. 14

24. Push the steering housing forward in the slots and tighten the hex screws to 37-48Nm (26-34 ft. lbs). Refer to Fig. 15.

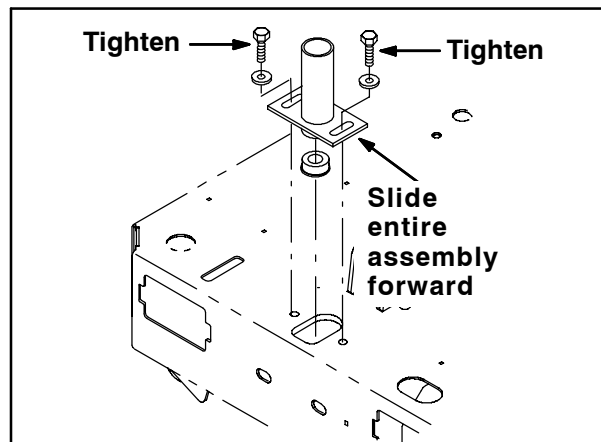

FIG. 15

25. Use clevis pin (4) and cotter pin (5) to mount the brake mounting channel (1) assembly to the brake channel (3). Refer to Fig. 16.

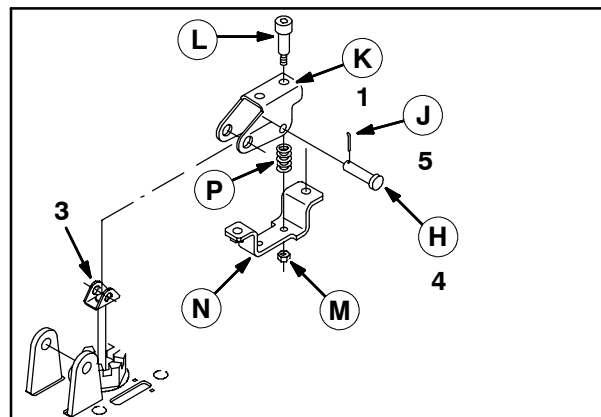

FIG. 16

26. Use hardware (A) to reinstall the brake pedal assembly (B) onto the machine. Refer to Fig. 17.

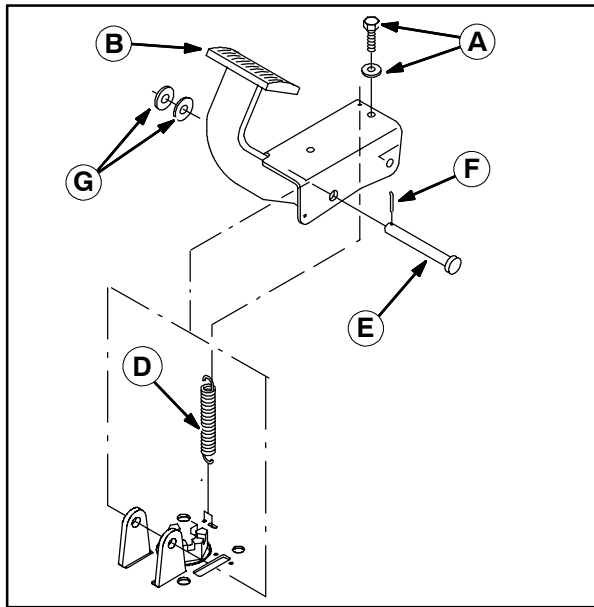

FIG. 17

27. Use cotter pin (F), clevis pin (E), and washers (G) to attach the brake pedal assembly (B) to the machine. Refer to Fig. 17.
28. Connect the extension spring (D) from the brake pedal assembly (A). Refer to Fig. 17.
29. Pull the cable through the duct sleeve and reinstall the cable clamp on the machine. Refer to Fig. 18.

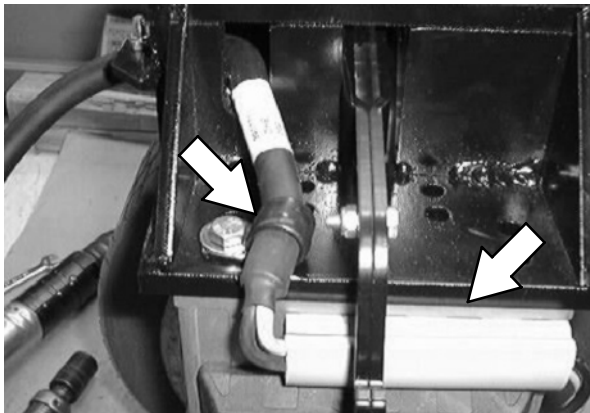

FIG. 18

30. Reconnect the wires to the drive motor. Refer to Fig. 19.

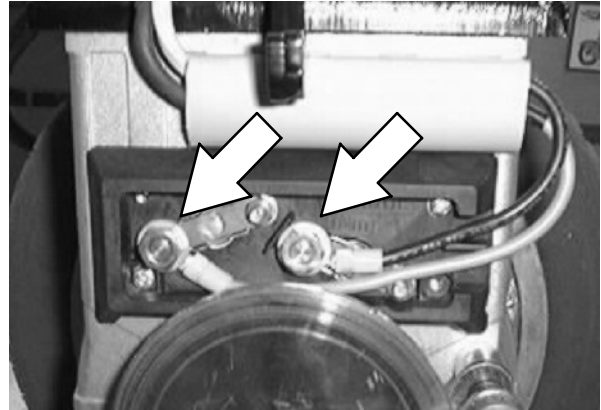

FIG. 19

31. Reinstall the power wire cover onto the side of the drive assembly. Refer to Fig. 20.

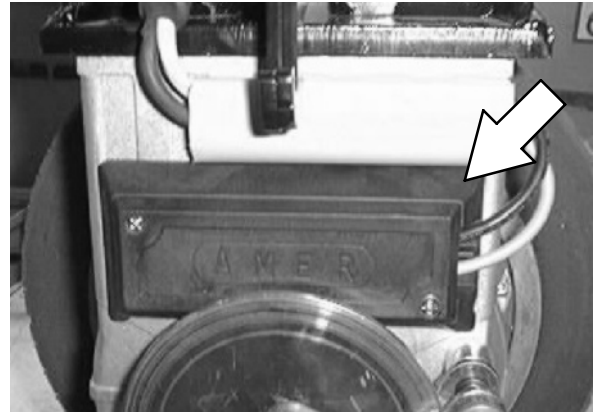

FIG. 20

32. Reinstall the brake link onto the side of the drive assembly and reinstall the cotter pin to secure the brake link onto the drive assembly. Refer to Fig. 21 or Fig. 22.

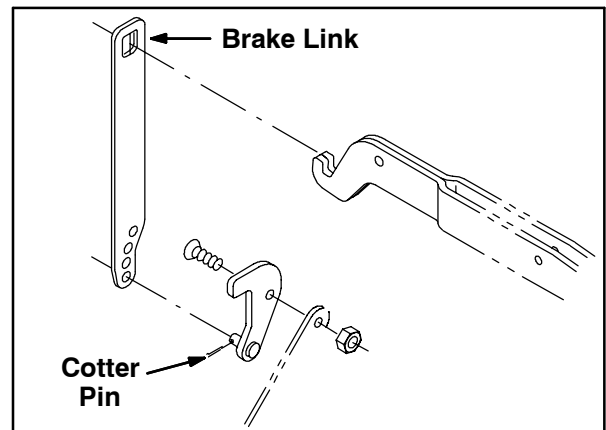

FIG. 21-Older Machines

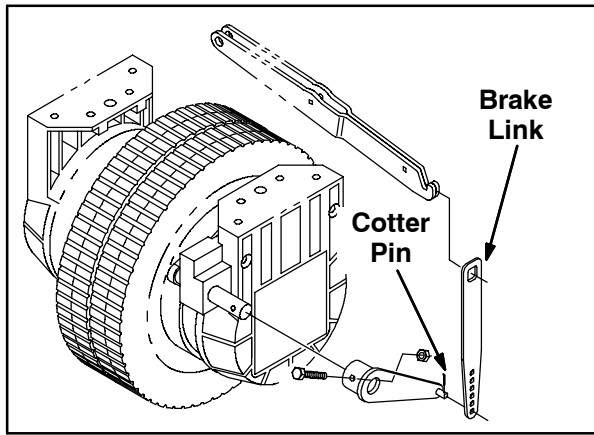

FIG. 22-Newer Machines

33. Lower the machine to the floor and remove the jack from underneath the machine.
34. Reconnect the battery cables to the batteries.
35. Test the machine. Check the front drive for proper operation.

Bill of Materials for Kit, Repmt, Brake Linkage-377411

	Ref.	Tennant Part No.	Description	Qty.
▽		377411	Kit, Repmt, Brake Linkage	1
▲	1	1019764	Bracket, Channel, Mtg, Brake	1
▲	2	1026028	Link, Brake, Upper	1
▲	3	1026017	Channel, Brake [6100]	1
▲	4	29558	Pin, Clevis, 0.37 D X 1.50L	1
▲	5	39005	Pin, Cotter, .094 X 0.75	1

TENNANT COMPANY
P. O. Box 1452
Minneapolis, MN 55440-1452