



INSTRUCTION BULLETIN

No. 340751
Machine: T7
Published: 12-2005
Rev. 00

NOTE: DO NOT DISCARD the Parts List from the Instruction Bulletin. Place the Parts List in the appropriate place in the machine manual for future reference. Retaining the Parts List will make it easier to reorder individual parts and will save the cost of ordering an entire kit.

NOTE: Numbers in parenthesis () are reference numbers for parts listed in Bill of Materials.

Installation instructions for **kit number 9001004**

SYNOPSIS:

This kit contains the parts needed to install a basket on the T7 machine.
Please follow step-by-step instructions.

SPECIAL TOOLS / CONSIDERATIONS: NONE

(Estimated time to complete: 1 minute)

PREPARATION:

1. Park the machine on a clean level surface.
2. Turn off the machine, remove the key, and set the parking brake.

FOR SAFETY: Before leaving or servicing machine, stop on level surface, set parking brake, turn off machine, and remove key.

INSTALLATION:

1. Open the recovery tank cover. Refer to Fig. 1.
2. Hook the basket (1) into the opening of the recovery tank. Refer to Fig. 1.
3. Close the recovery tank cover. Refer to Fig. 1.

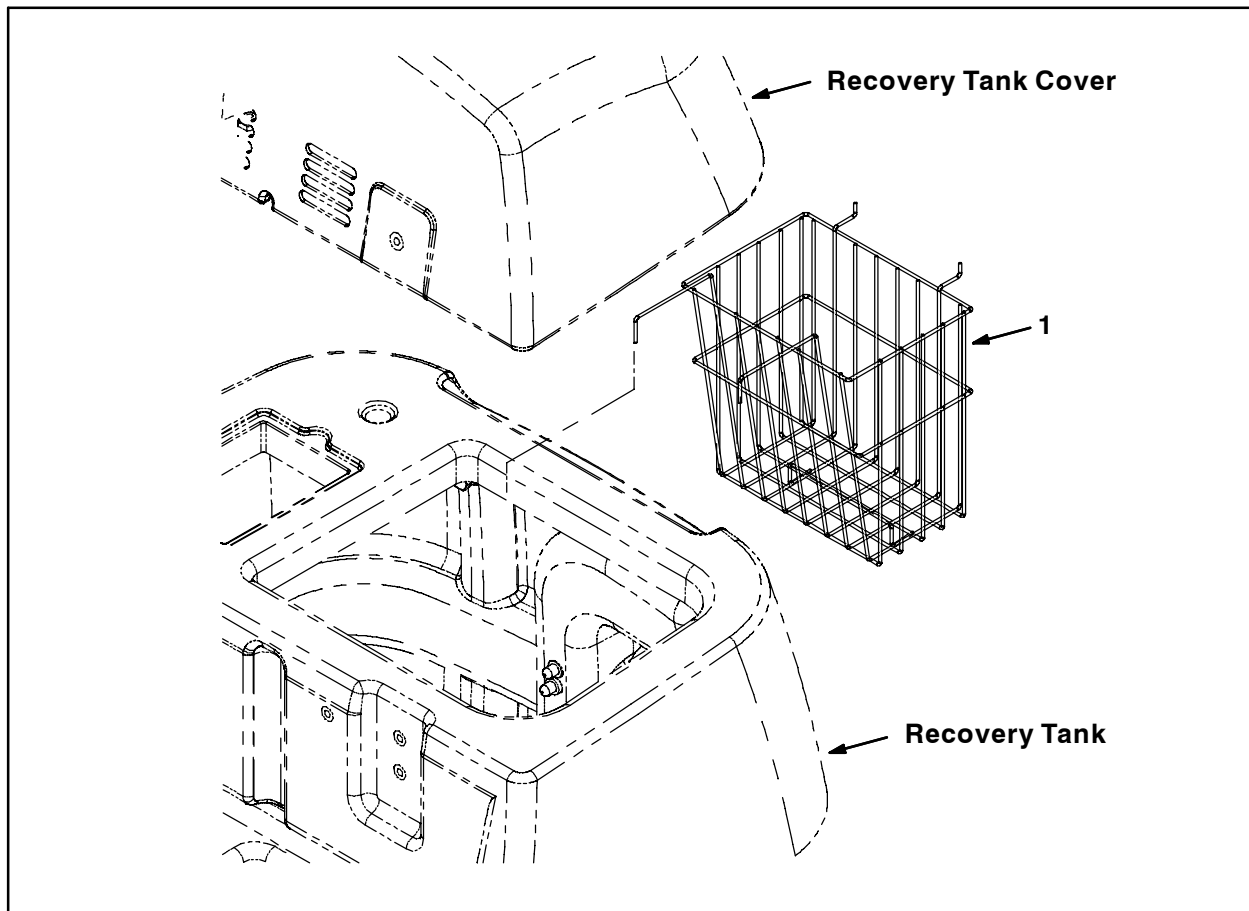

FIG. 1

Bill of Materials for Basket Kit, CI-9001004

	Ref.	Tennant Part No.	Description	Qty.
▽		9001004	Basket Kit, CI	1
▲	1	1018315	Tray, Basket	1

TENNANT COMPANY
P. O. Box 1452
Minneapolis, MN 55440-1452