



INSTRUCTION BULLETIN

No. 340746
Machine: Centurion
Published: 01-2005
Rev. 00

NOTE: DO NOT DISCARD the Parts List from the Instruction Bulletin. Place the Parts List in the appropriate place in the machine manual for future reference. Retaining the Parts List will make it easier to reorder individual parts and will save the cost of ordering an entire kit.

NOTE: Numbers in parenthesis () are reference numbers for parts listed in Bill of Materials.

Installation instructions for **kit number 9000906**

SYNOPSIS:

This kit contains the parts needed to install a water system valve modification on Centurion sweepers. Please follow step-by-step instructions.

SPECIAL TOOLS / CONSIDERATIONS: NONE

(Estimated time to complete: 2 hours)

PREPARATION:

1. Machines equipped with a valve on other end of hose attached to water pump (E): Close valve to shut off supply of water to water pump.

Machines not equipped with a valve on other end of hose attached to water pump (E): Open conveyor flush valve (located in front of water pump) to drain water from water tank. Refer to Fig. 5 for location of conveyor flush valve.

2. Park the machine on a clean level surface.
3. Raise the hopper.



WARNING: Lift arm pinch point. Stay clear of hopper lift arms.

4. Engage the hopper support bars/support pin.



WARNING: Tilted hopper may fall. Engage hopper support pin/support bars.

5. Turn off the machine, remove the key, and set the parking brake.

FOR SAFETY: Before leaving or servicing machine, stop on level surface, set parking brake, turn off machine, and remove key.

6. Disconnect battery cables from batteries.



WARNING: Always disconnect battery cables from machine before working on electrical components.

INSTALLATION:

1. Disconnect water lines (A), (B), and (C) from valves (G) and wire harness from water pump (E) and valves (G). **Do not** discard hose clamps. Refer to Fig. 1.

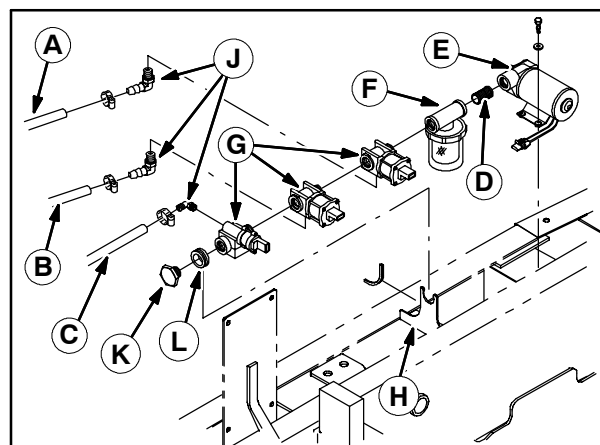

FIG. 1

2. Remove water pump (E), strainer (F), valves (G), and grommet (K) from valve mounting bracket (H). Remove components as an entire assembly. **Do not** separate. Components are separated in later steps. **Do not** discard hardware used to secure these items to the machine. Refer to Fig. 1.

3. Remove the strainer (F) and valves (G) from the water pump (E). Refer to Fig. 1.
4. Remove fittings (J) from valves (G). Discard the fittings. Refer to Fig. 1.
5. Remove the valves (G) from the strainer (F). Do not separate the valves or remove the cap (K) from the end valve. Refer to Fig. 1.
6. Remove the plastic fitting (D) from the water pump (E). Discard the plastic fitting. Refer to Fig. 1.
7. Use a torch or a cutting/grinding wheel to cut the valve mounting bracket (H) from the frame weldment. Refer to Fig. 2.
8. Drill two 19/64" holes into the right side channel of the frame weldment. Refer to Fig. 2.

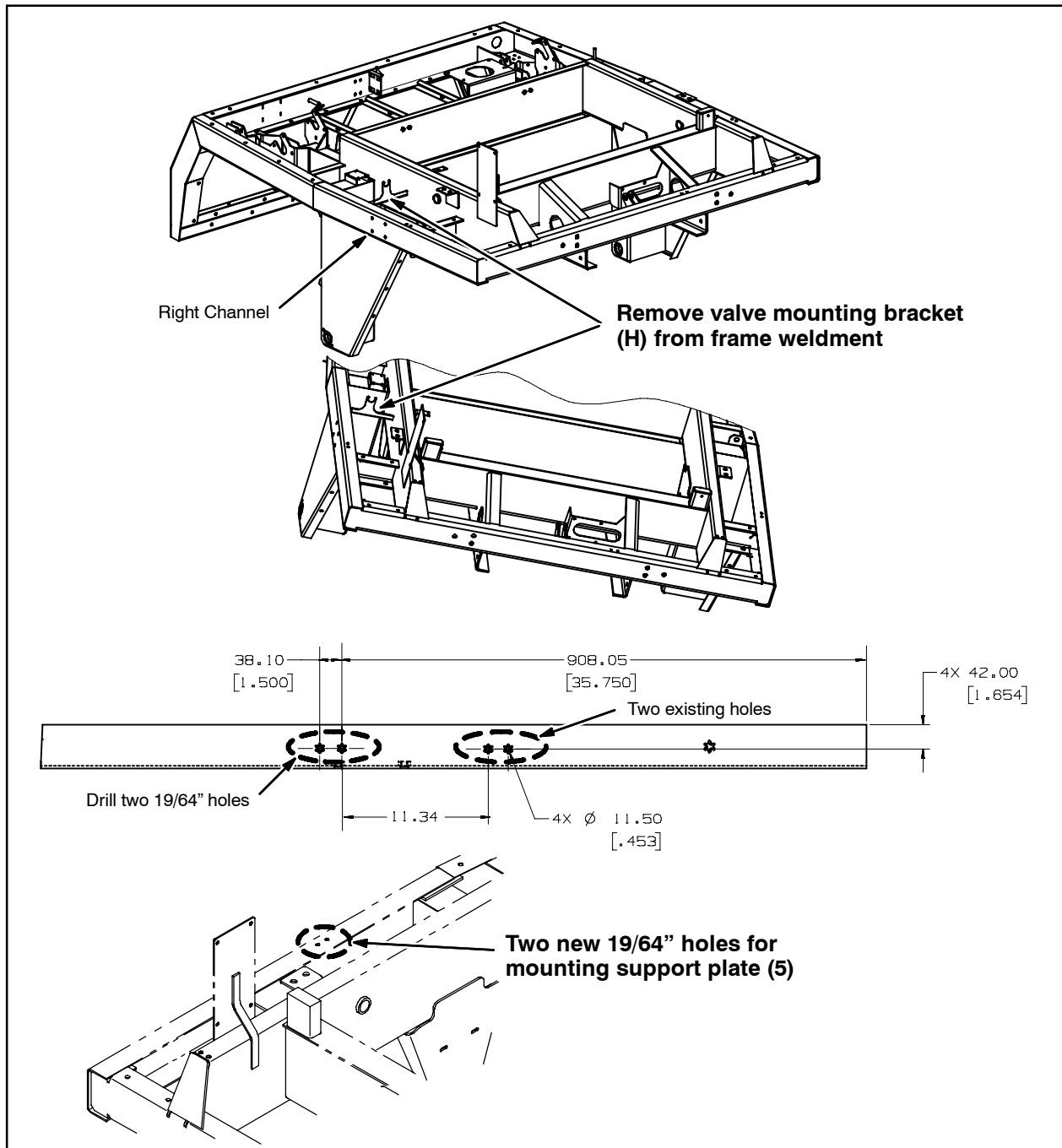

FIG. 2

9. Assemble fittings (1), (2), (3), (4), (6), and (7), onto the water pump (E), strainer (F), and valves (G). Note how parts are oriented. Refer to Fig. 3.

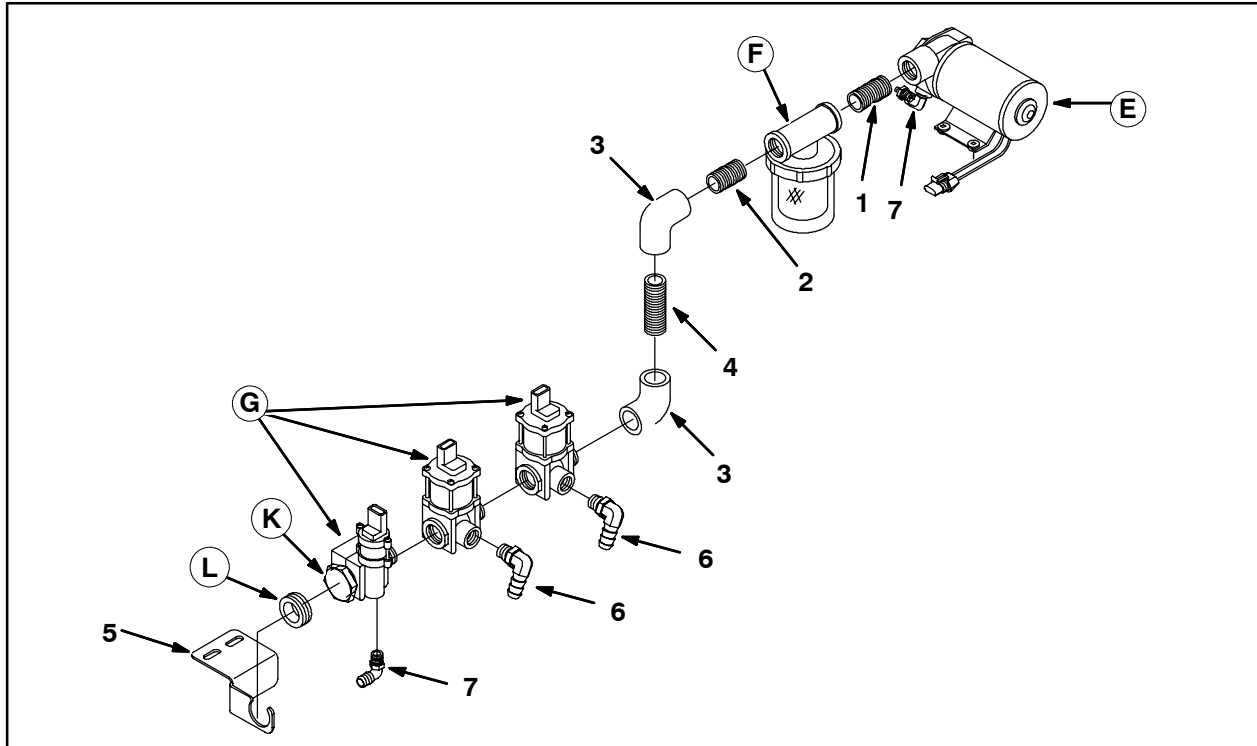

FIG. 3

10. Install the grommet (L) into the notch in the support plate (5). Refer to Fig. 4.

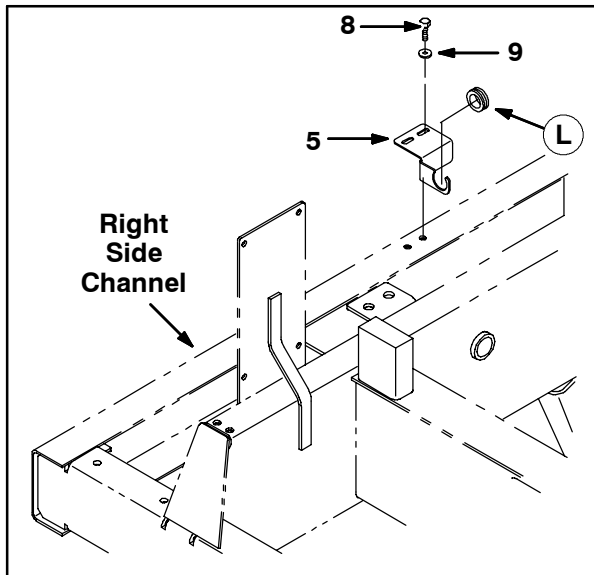

FIG. 4

11. Slide the grommet (L) installed into the support plate (5) in the previous step over the cap (K) in the end valve (G) and onto the pipe portion of the valve. Refer to Fig. 3 and Fig. 4.

12. Use two hex screws (8) and two flat washers (9) to install the support plate (5) onto the right side channel of the frame weldment. Refer to Fig. 4.

13. Use the previously removed hardware to reinstall the entire pump/strainer/valve assembly onto the machine. Refer to Fig. 5.

14. Reconnect water lines (A), (B), and (C) to the valves (G). Refer to Fig. 5.

15. Reconnect the wire harness to the water pump (E) and the valves (G). Refer to Fig. 3.

16. Reconnect the battery cables to the batteries.

17. Disengage the hopper support bars/support pin and lower the hopper.



WARNING: Lift arm pinch point. Stay clear of hopper lift arms.

18. Fill the water tank. Refer to operators manual for instructions.

19. Start the machine and observe the newly installed components for leaks.

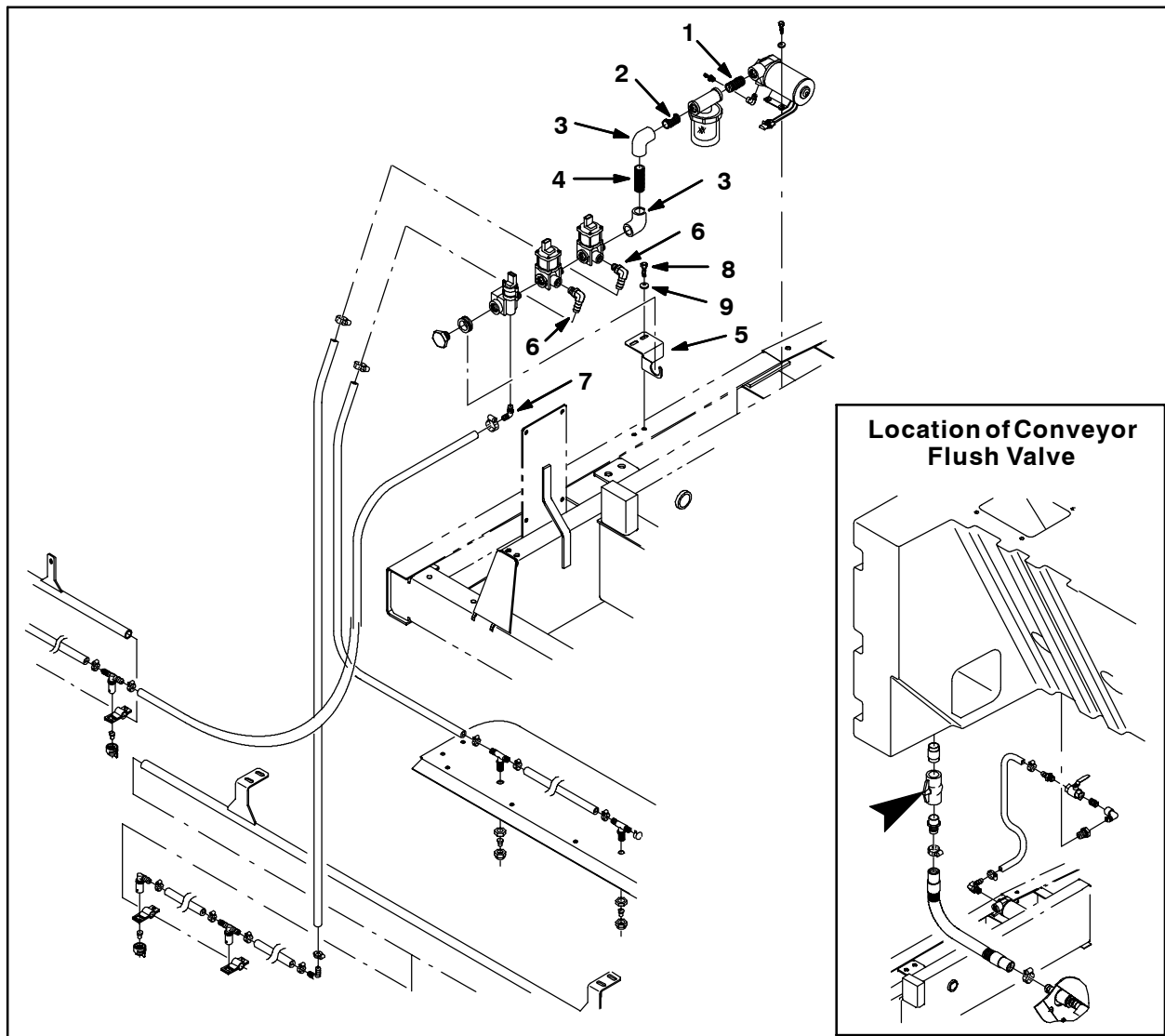

FIG. 5

Bill of Materials for Valve Kit, Water System, Modif-9000906

	Ref.	Tennant Part No.	Description	Qty.
▽		9000906	Valve Kit, Water System, Modif	1
▲	1	23265	Fitting, Plstc, Str, PM12/PM12 2.0Lg	1
▲	2	69784	Fitting, Plstc, Str, PM12/PM12 Close	1
▲	3	23271	Fitting, Plstc, E90, PF12/PF12	2
▲	4	385665	Fitting, Plstc, Str, PM12/PM12 3.0L	1
▲	5	1014309	Plate, Sppt	1
▲	6	63244-1	Fitting, Plstc, E90, BM08/PM/08, PP	2
▲	7	65581	Fitting, Plstc, E90, BM08/PM/04	2
▲	8	76099	Screw, Hex, M8 X 1.25 X 25, Fmg	2
▲	9	32491	Washer, Flat, 0.31 Std	2

TENNANT COMPANY
P. O. Box 1452
Minneapolis, MN 55440-1452