



INSTRUCTION BULLETIN

No. 340669
Machine: Centurion™
Published: 8-03
Rev. 00

NOTE: DO NOT DISCARD the Parts List from the Instruction Bulletin. Place the Parts List in the appropriate place in your machine manual for future reference. Retaining the Parts List will make it easier to reorder individual parts and will save you the cost of ordering an entire kit.

NOTE: Numbers in parenthesis () are reference numbers for parts listed in Bill of Materials.

Installation instructions for **kit number 9000215**

DESCRIPTION:

This kit contains the parts needed to replace the main broom side skirts on the model Centurion™ sweeper serial numbers 000000-001276.

Please follow step-by-step instructions.

SPECIAL TOOLS / CONSIDERATIONS: None

(Estimated time to complete: 1 hour)

PREPARATION:

(Refer to FIG. 1 and 2)

1. Start the machine, and lower the main brush assembly with the sweep switch.
2. Turn the machine off.

FOR SAFETY: Before leaving or servicing machine, stop on level surface and set parking brake. Then turn off machine and remove key.

INSTALLATION:

(Refer to FIG. 1 and 2)

1. Remove and set aside the left hand side panel 394385 and brush skirt 395105 from the machine. Remove and set aside retainer strip 395106 from brush skirt 395105.
(Refer to FIG. 1)
2. Orient one brush skirt 1009483 in mounting position for new left hand side panel 1009895. Mount new skirt strip 1009606 to brush skirt 1009483 with three hex screws 09007, fender washers 41178, flat washers 01684 and lock nuts 08712. Torque M6 hardware to 7.9 – 9.9 Nm (5.5 – 7 ft lb). (Refer to FIG. 1)
3. Mount brush skirt 1009483 to left hand side panel 1009895 with set aside retainer strip 395106 and mounting hardware. Torque M10 lock nut hardware to 37 – 48 Nm (25 – 35 ft lb). (Refer to FIG. 1)
4. Repeat steps 1–3 to install new right hand side panel 1009896 and brush skirt 1009483 on the right hand side of the machine. (Refer to FIG. 1)
5. Remove and replace right hand plate shield 394305 with new shield 1009588. Torque mounting hardware to 35–49 Nm (25–35 ft lbs). (Refer to FIG. 2)

6. Remove and replace left hand plate shield 394304 with new shield 1009584 (1).
(Refer to FIG. 2)

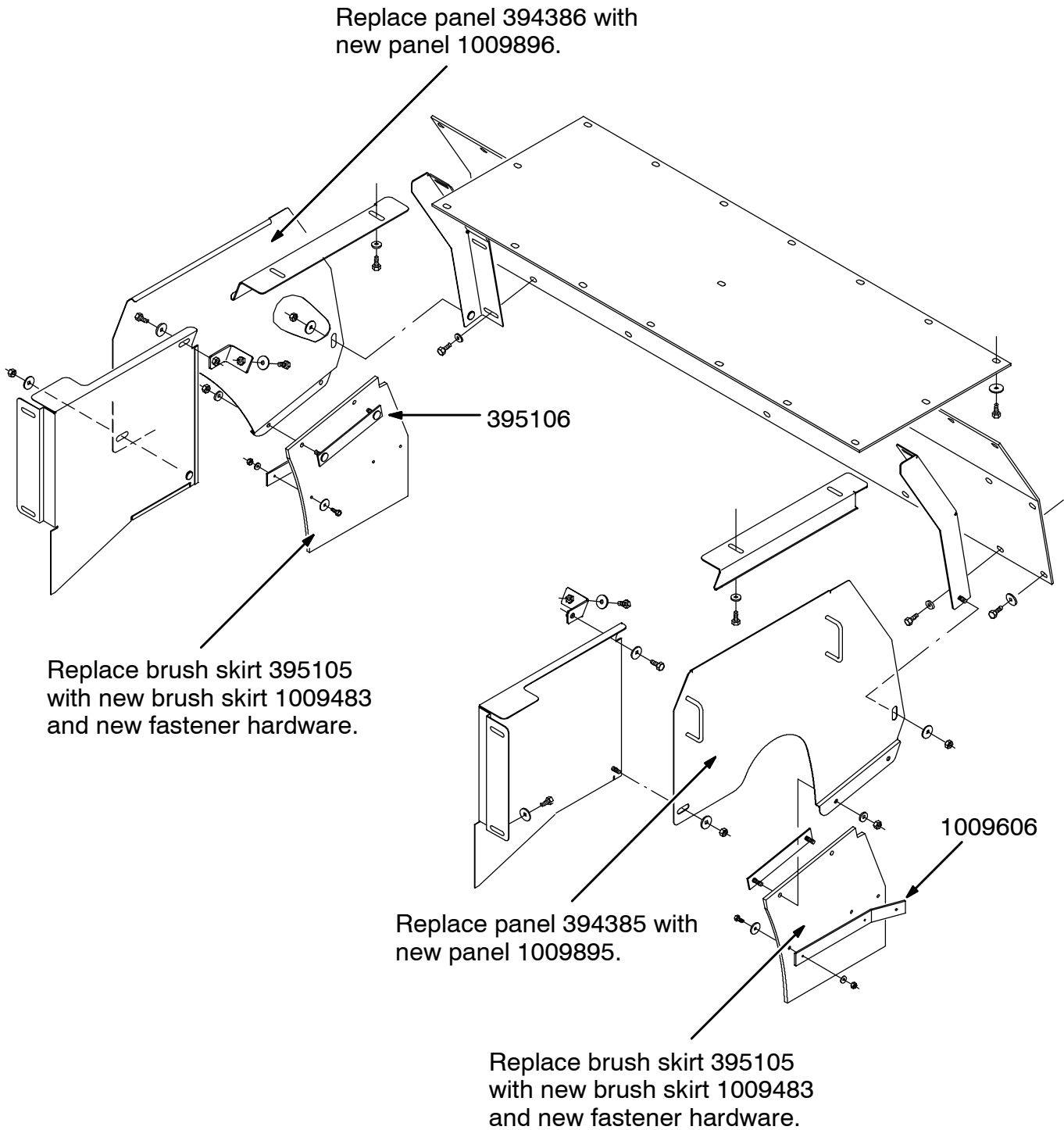

FIG. 1 - Main Brush Skirt and Shield Replacement

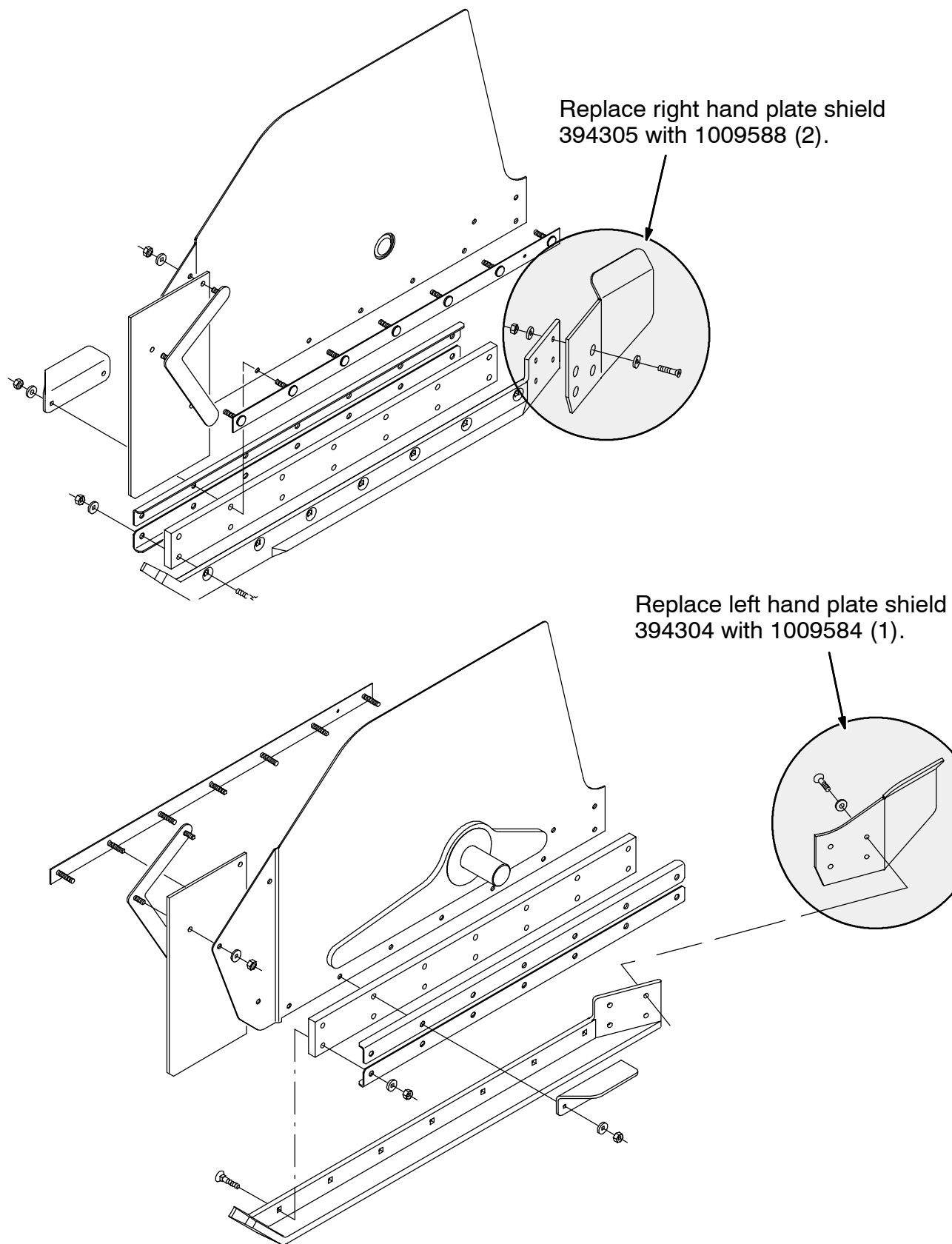

FIG. 2 - Drag Shoe Plate Shield Replacement

BILL OF MATERIALS FOR MAIN BROOM SIDE SKIRT KIT 9000215

Ref.	TENNANT Part No.	Description	Qty.
1	1009584	Plate, shield, brush, LH	1
2	1009588	Plate, shield, brush, RH	1
3	1009483	Skirt, brush	2
4	1009606	Strip, skirt	2
5	09007	Screw, hex, M6 X 1.0 X 25, Ss	6
6	41178	Washer, flat, 0.25 Fender	6
7	01684	Washer, flat, 0.25 Ss	6
8	08712	Nut, hex, lock, M6 X 1.0, NL, Ss	6
9	1009895	Panel wldt, LH	1
10	1009896	Panel wldt, RH	1

TENNANT COMPANY
P. O. Box 1452
Minneapolis, MN 55440-1452