



INSTRUCTION BULLETIN

No. 340659
Machine: Centurion™
Published: 7-03
Rev. 00

NOTE: DO NOT DISCARD the Parts List from the Instruction Bulletin. Place the Parts List in the appropriate place in your machine manual for future reference. Retaining the Parts List will make it easier to reorder individual parts and will save you the cost of ordering an entire kit.

NOTE: Numbers in parenthesis () are reference numbers for parts listed in Bill of Materials.

Installation instructions for **kit number 9000181**

DESCRIPTION:

This kit contains the parts needed to install a work light kit on the model Centurion™ sweeper.

Please follow step-by-step instructions.

SPECIAL TOOLS / CONSIDERATIONS: None

(Estimated time to complete: 1 hour)

PREPARATION:

(Refer to FIG. 1)

FOR SAFETY: Before leaving or servicing machine, stop on level surface and set parking brake. Then turn off machine and remove key.

INSTALLATION:

(Refer to FIG. 1, 2 and 3)

1. Install light **mounting plates (6) 396240** to the machine with **hex screws (7) 09011**, **washers (9) 01685** and **lock nuts (8) 08713** on both sides of the machine. (Refer to FIG. 1)
2. Remove mounting hardware and mount **flood lamps (1) 396463** to **mounting plates (6) 396240** with mounting hardware. (Refer to FIG. 1)
3. Connect **flood lamps (1) 396463** to main harness connectors, tagged work. (Refer to FIG. 2)
4. Secure wire harnesses to machine with **cable clamps (4) 76736** and **hex screws (5) 74455**. (Refer to FIG. 1)
5. Install work light **rocker switch (2) 394924** and **switch plug (3) 398501** in the switch console. (Refer to FIG. 3)
6. Start the machine, and check work lights for proper operation.

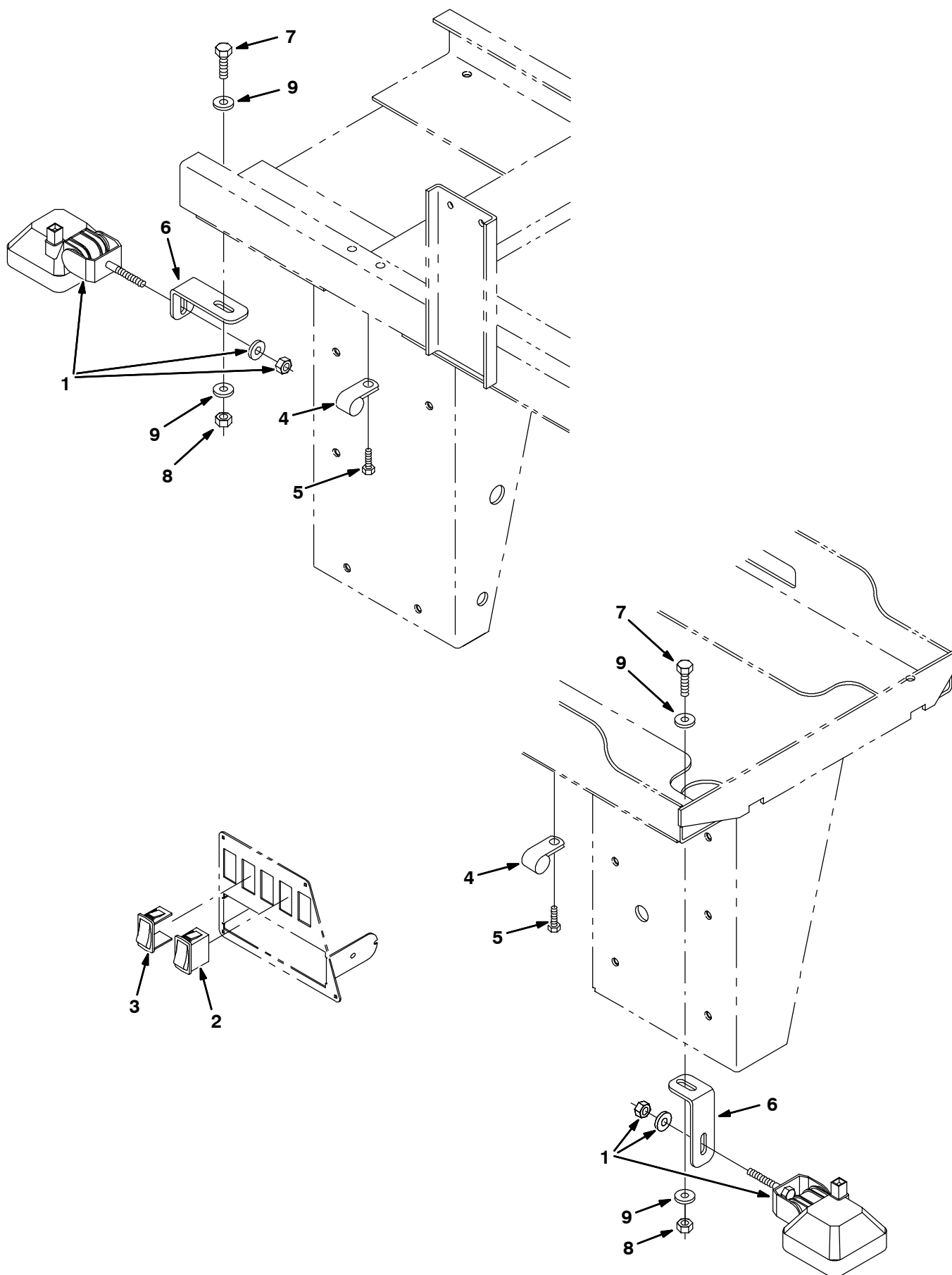

FIG. 1 - Work Light Installation

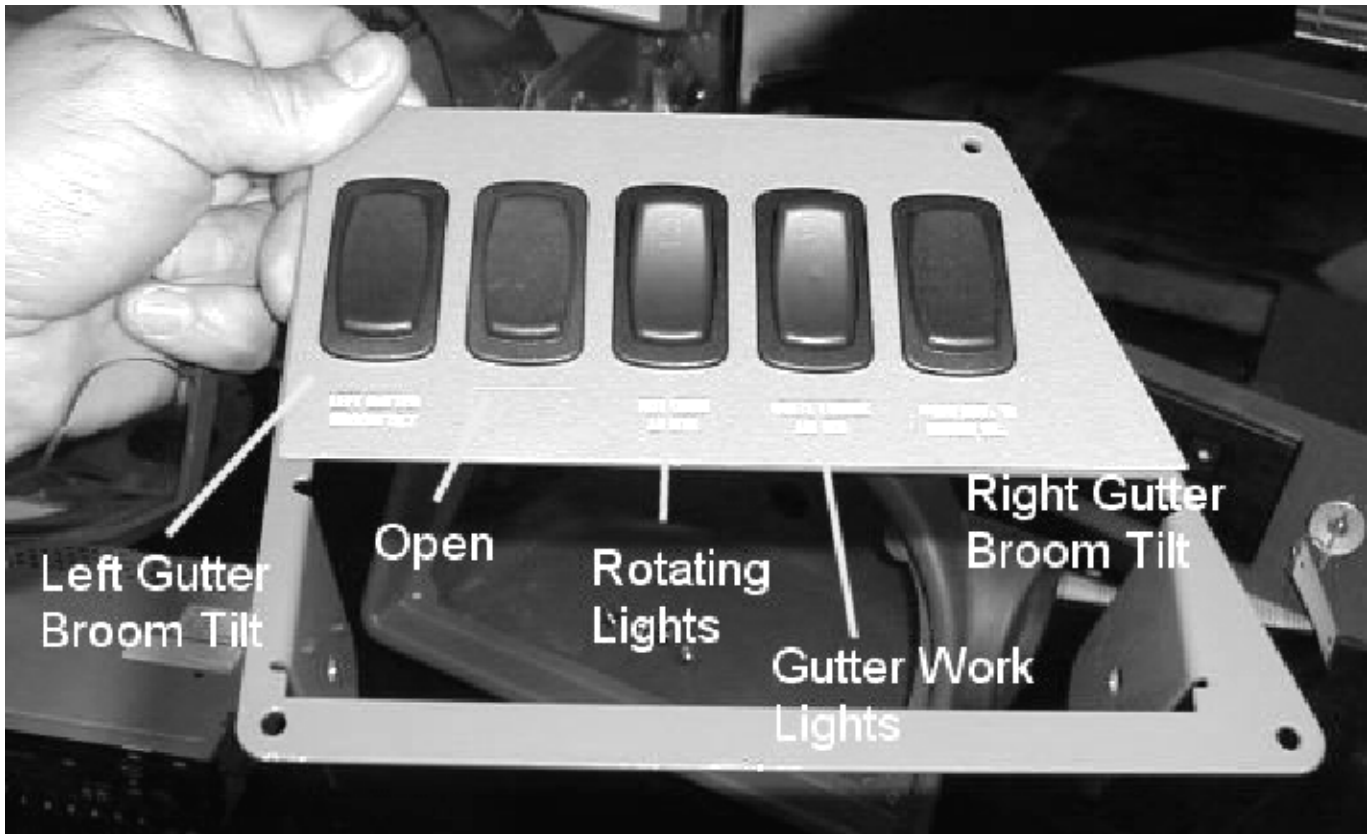

FIG. 3 - Work Light Switch Installation

BILL OF MATERIALS FOR WORK LIGHT KIT 9000181

Ref.	TENNANT Part No.	Description	Qty.
1	396463	Lamp, flood, 12VDC, 55W	2
2	394924	Switch, rocker, 36VDC 05A ON/N/ON	1
3	398501	Plug, hole, rockerswitch	1
4	76736	Clamp, cable, stl, 0.38D X 0.62W, 1H	4
5	74455	Screw, hex, M6 X 1.0 X 12, FMG	4
6	396240	Plate, mtg, light	2
7	09011	Screw, hex, M8 X 1.25, NL, Ss	2
8	08713	Nut, hex, lock, M8 X 1.25, NL, Ss	2
9	01685	Washer, flat, 0.31 Ss	4

TENNANT COMPANY
P. O. Box 1452
Minneapolis, MN 55440-1452