



INSTRUCTION BULLETIN

No. 340653
Machine: 7300, 8300
Published: 6-03
Rev. 00

NOTE: DO NOT DISCARD the Parts List from the Instruction Bulletin. Place the Parts List in the appropriate place in your machine manual for future reference. Retaining the Parts List will make it easier to reorder individual parts and will save you the cost of ordering an entire kit.

NOTE: Numbers in parenthesis () are reference numbers for parts listed in Bill of Materials.

Installation instructions for **kit number 387679**

DESCRIPTION:

Some machines equipped with vacuum-assisted debris trays are clogging up, resulting in poor cleaning performance. This kit contains the parts needed to rework the debris tray and disconnect it from the vacuum hose on the model 7300 scrubber and 8300 sweeper/scrubber.

Please follow step-by-step instructions.

SPECIAL TOOLS / CONSIDERATIONS: Hand Drill, 3/8 [9.5 mm] Drill Bit

(Estimated time to complete: 1 hour)

PREPARATION:

(Refer to FIG. 1, 2 and 3)

1. Turn the machine power on, and lower the scrubhead and the rear squeegee.
2. Turn the machine power off.

FOR SAFETY: Before leaving or servicing machine, stop on level surface and set parking brake. Then turn off machine and remove key.

3. Raise the rear machine cover and secure in place with the cover support rod.
4. Disconnect battery cables from machine.



WARNING: Always disconnect battery cables from machine before working on electrical components.

5. Disconnect the vacuum hose from the rear squeegee.
6. Loosen the breakaway knobs, and remove the rear squeegee from the machine.
7. Open the rear battery compartment door. Disconnect the safety cable from the battery pack. Remove the battery pack from the machine using a chain hoist or lift.

FOR SAFETY: Use a chain hoist or lift that will support the weight of the battery pack.

8. Remove and set aside the vacuum hose retainer bracket and left hand battery spacer. Cut away and discard the wire ties holding the recovery tank vacuum hose in place.

INSTALLATION:

(Refer to FIG. 1, 2 and 3)

1. Remove the debris trough from the right hand side of the machine. (Refer to FIG. 1)
2. Clean the debris trough and place on a clean work surface.
3. Mark and drill eleven new 3/8 [9.5 mm] hole locations in the front side of the debris trough, according to the dimensions shown in figure 2. (Refer to FIG. 2)
4. Disconnect the top end of vacuum hose 386514 from the recovery tank. Disconnect the bottom end of vacuum hose 386514 from tube 386518 under the machine. Discard vacuum hose 386514 from the machine. (Refer to FIG. 1)
5. Disconnect the far end of vacuum hose 387526 from tube 386518 under the machine. Discard vacuum hose 387526 from the machine. (Refer to FIG. 2)
6. Remove and discard tube 386518 and hose assembly 222788/398802 connecting tube 386518 to upper tube weld 386510. (Refer to FIG. 2)
7. Install the straight end of new vacuum hose 386267 to the recovery tank and secure in place with the recovery tank hose retainer bracket.
8. Route vacuum hose 386267 down along the side of the recovery tank, under the machine, over to the rear squeegee.
9. Replace the rear squeegee on the machine. Secure vacuum hose 386267 to the rear squeegee.
10. Secure vacuum hose 386267 to the machine with hose clamps and plastic wire ties.
11. Secure the reworked debris trough on the right hand side of the machine.
12. Install the left side battery spacer in the rear end of the machine.
13. Replace the battery pack in the back of the machine using a chain hoist or lift. Reconnect the safety cable to the battery pack. Close the rear battery compartment door.

FOR SAFETY: Use a chain hoist or lift that will support the weight of the battery pack.

14. Reconnect the battery cables to the machine and close the rear machine cover.
15. Turn the machine power on, and check the machine for proper operation.

BILL OF MATERIALS FOR DEBRIS TRAY REWORK KIT 387679

Ref.	TENNANT Part No.	Description	Qty.
1	386267	Hose, vacuum, 91.0L	1

TENNANT COMPANY
P. O. Box 1452
Minneapolis, MN 55440-1452

Remove hose assembly pieces 222788, 398802, 386518 and 386514

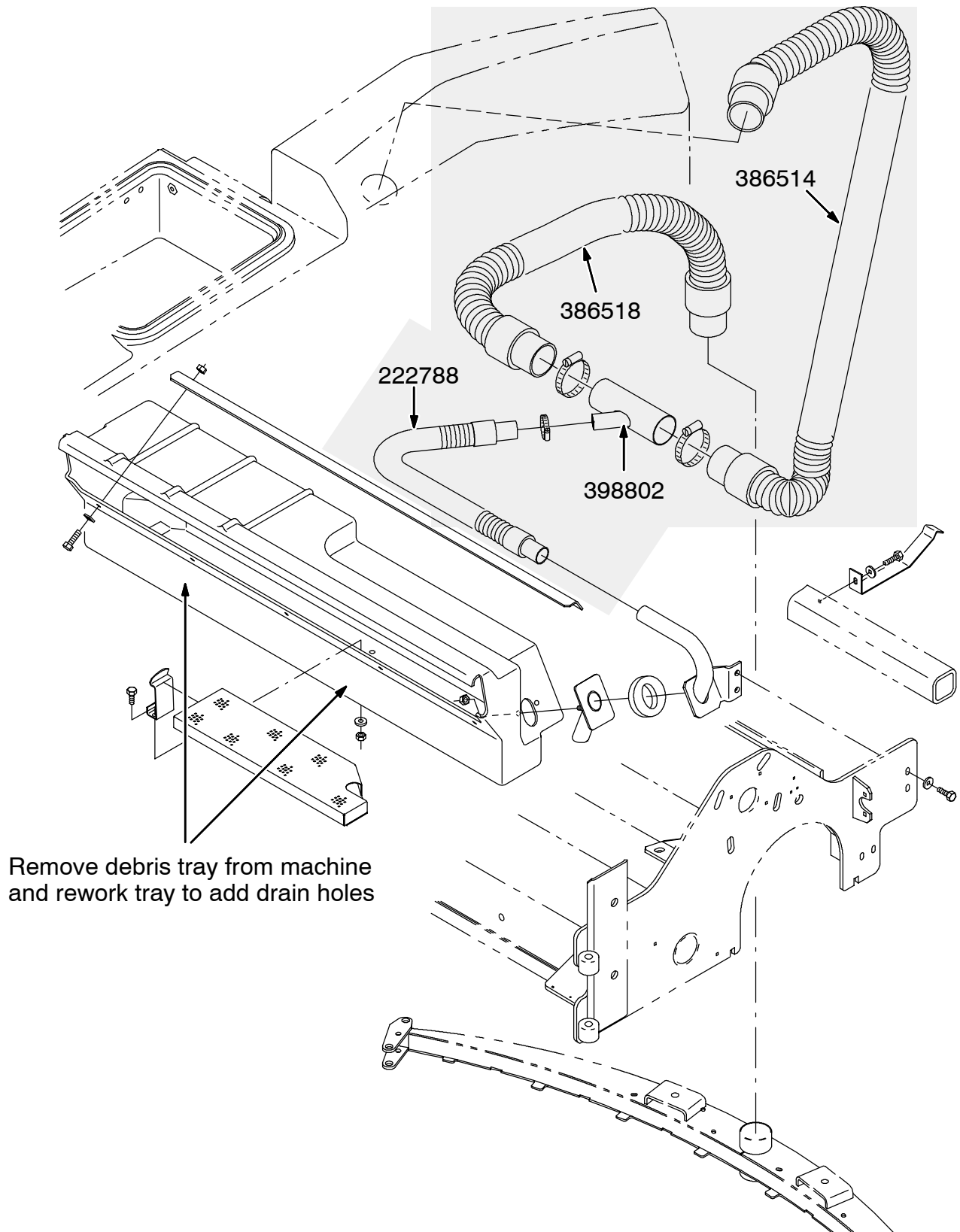

FIG. 1 - Vacuum Hose Removal

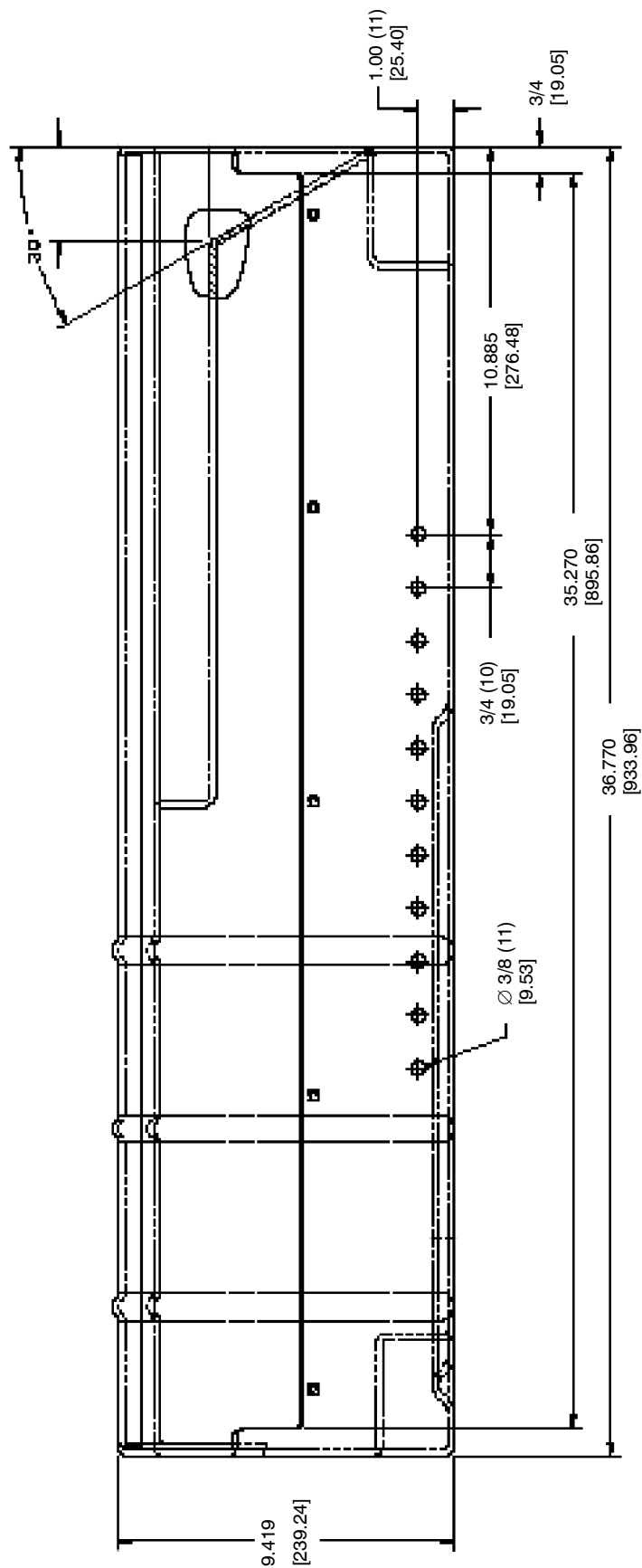
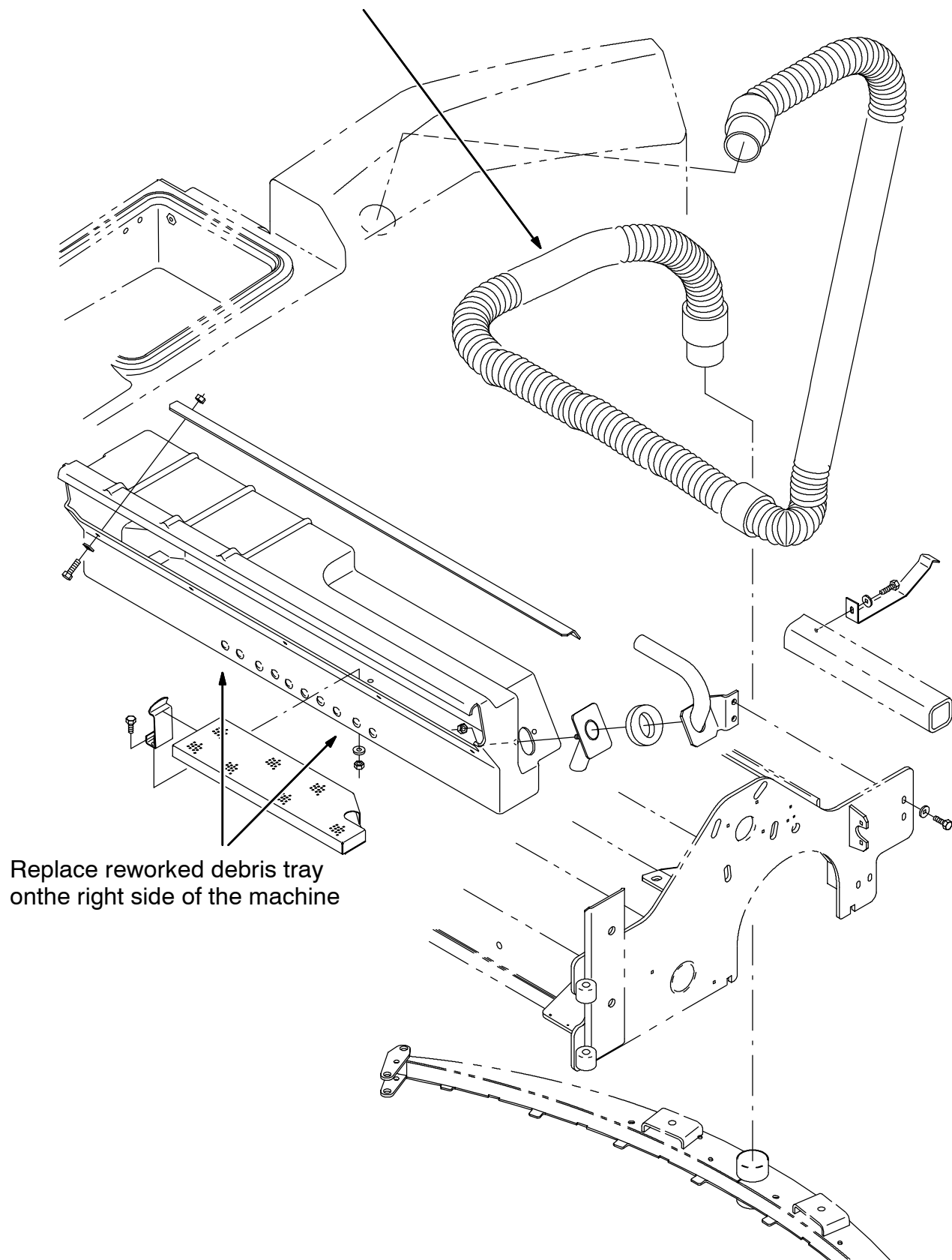

FIG. 2 - Debris Tray Rework

Install new hose 386267 in place of old hose assembly



Replace reworked debris tray
on the right side of the machine

FIG. 3 - Vacuum Hose Installation