



INSTRUCTION BULLETIN

No. 340642
Machine: 7100
Published: 9-03
Rev. 00

NOTE: DO NOT DISCARD the Parts List from the Instruction Bulletin. Place the Parts List in the appropriate place in your machine manual for future reference. Retaining the Parts List will make it easier to reorder individual parts and will save you the cost of ordering an entire kit.

NOTE: Numbers in parenthesis () are reference numbers for parts listed in Bill of Materials.

Installation instructions for **kit number 390619**

DESCRIPTION:

This kit contains the parts needed to replace the controller on the model 7100 scrubber.
Please follow step-by-step instructions.

SPECIAL TOOLS / CONSIDERATIONS: None

(Estimated time to complete: 1 hour)

PREPARATION:

(Refer to FIG. 1)

FOR SAFETY: Before leaving or servicing machine, stop on level surface and set parking brake. Then turn off machine and remove key.

1. Disconnect battery cables from machine.



WARNING: Always disconnect battery cables from machine before working on electrical components.

INSTALLATION:

(Refer to FIG. 1)

1. Remove and set aside the two control panel securing bolts. Open the control panel far enough to access the circuit board assembly on the back side of the control panel.
2. Remove and set side the black electrical cover 223046.
3. Remove the grounding strap from it's plastic package.
4. Unwrap the first two folds of the band and wrap the exposed adhesive side firmly around either wrist.
5. Unroll the rest of the band and peel the liner from the copper foil at the opposite end.
6. Attach the copper foil to a convenient and exposed electrical ground on the machine frame.
7. Un-plug the ribbon cables and wire connectors from the circuit board.
8. Pop the circuit board off the plastic stand-offs. Note the orientation of the circuit board, then remove the circuit board from the machine.
9. Position the new circuit board on the plastic stand-offs. Gently push the board down until the stand offs snap into place.

10. Reconnect the ribbon cables and wire connectors to the new circuit board.
11. Position the circuit board cover back up to the inside, front wall of the steering support, behind the control panel.
12. Reinstall the circuit board cover. Hand tighten with set aside hardware.
13. Place the control panel back in mounting position. Reinstall mounting hardware, and tighten to 18–24 Nm (15–20 ft lb).
14. Reconnect the battery to the machine.
15. Start the machine and initialize the new board.
16. Check the machine for proper operation.

BILL OF MATERIALS FOR CONTROLLER REPLACEMENT KIT 390619

Ref.	TENNANT Part No.	Description	Qty.
1	390607	Circuitboard assy, [7100]	1
2	27964	Strap, static ground, disposable	1
3	19103-10	Carton	1
4	1009521	Tool, micro removal	1

TENNANT COMPANY
P. O. Box 1452
Minneapolis, MN 55440-1452

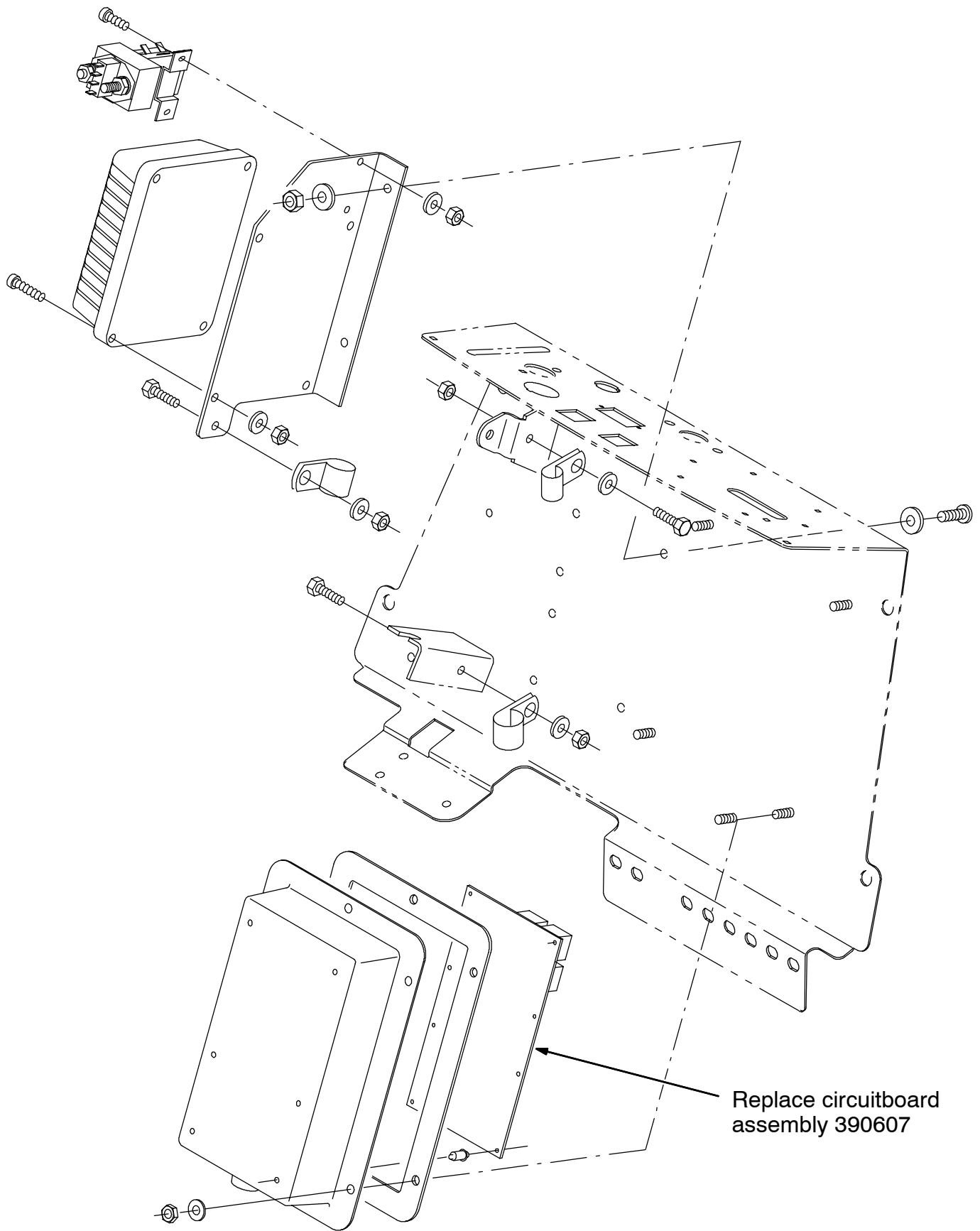

FIG. 1 - Controller Replacement