



INSTRUCTION BULLETIN

No. 340620
Machine: 8200, 8210
Published: 7-03
Rev. 00

NOTE: DO NOT DISCARD the Parts List from the Instruction Bulletin. Place the Parts List in the appropriate place in your machine manual for future reference. Retaining the Parts List will make it easier to reorder individual parts and will save you the cost of ordering an entire kit.

NOTE: Numbers in parenthesis () are reference numbers for parts listed in Bill of Materials.

Installation instructions for **kit number 374257**

DESCRIPTION:

This kit contains the parts needed to replace the recovery tank sleeve and prop bar with a new cable on the model 8200 and 8210 sweeper/scrubbers.

Please follow step-by-step instructions.

SPECIAL TOOLS / CONSIDERATIONS: None

(Estimated time to complete: 1/2 hour)

PREPARATION:

(Refer to FIG. 1)

1. Drain recovery tank.

FOR SAFETY: Before leaving or servicing machine, stop on level surface and set parking brake. Then turn off machine and remove key.

INSTALLATION:

(Refer to FIG. 1)

1. Open recovery tank and locate the recovery tank prop bar.
2. Remove and discard recovery tank prop bar from machine. Set mounting hardware aside.
3. Install one end of new **cable 87172 (1)** to the inside lip of the recovery tank with **hex screw 09010 (2)**, **washer 01685 (3)**, **bushing 46563 (4)** and **hex nut 07786 (5)**.
4. Mount the open end of new **cable 87172 (1)** to the recovery tank cover with set aside mounting hardware.

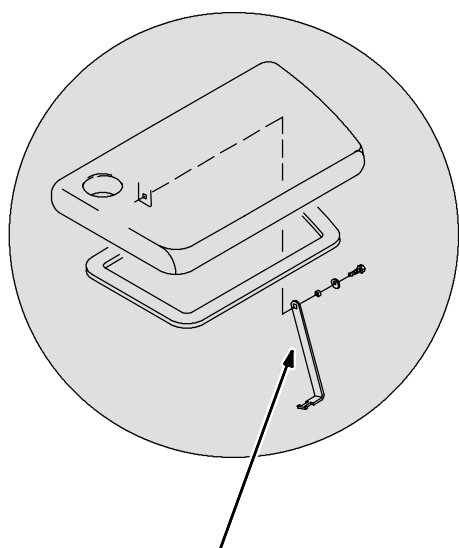

Remove **prop bar 364395** and **sleeve 360801**. Set mounting hardware aside.

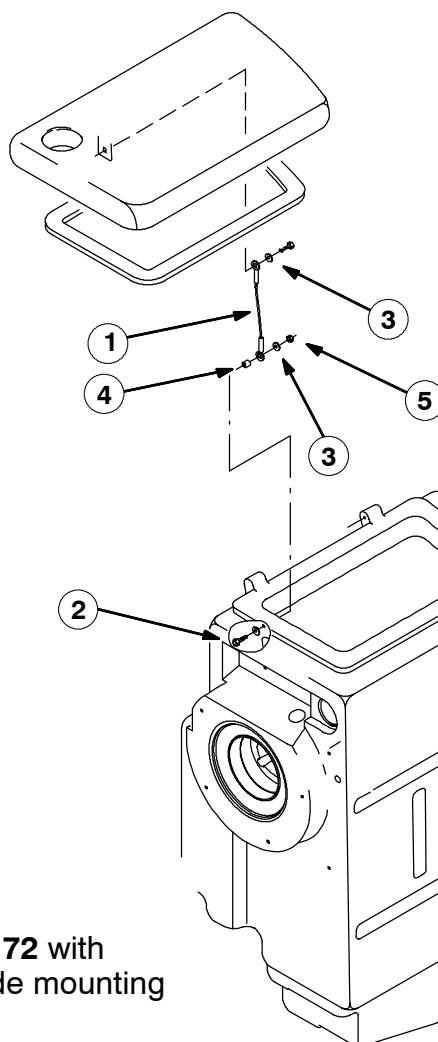

Install **cable 87172** with new and set aside mounting hardware.

FIG. 1 - Recovery Tank Cable Installation

BILL OF MATERIALS FOR RECOVERY TANK CABLE KIT 374257

Ref.	TENNANT Part No.	Description	Qty.
1	87172	Cable, 0.13D, 10.0L, 0.51 eye/ 0.51 eye	1
2	09010	Screw, hex, M8 X 1.25 X 25, Ss	1
3	01685	Washer, flat, 0.31 Ss	2
4	46563	Bushing, sleeve, 0.37B 0.50D 0.50L	1
5	07786	Nut, hex, std, M8 X 1.25, Ss	1

TENNANT COMPANY
P. O. Box 1452
Minneapolis, MN 55440-1452