



# INSTRUCTION BULLETIN

No. 340612  
Machine: 6600, 6650XP  
Published: 8-03  
Rev. 01

**NOTE: DO NOT DISCARD the Parts List from the Instruction Bulletin. Place the Parts List in the appropriate place in your machine manual for future reference. Retaining the Parts List will make it easier to reorder individual parts and will save you the cost of ordering an entire kit.**

*NOTE: Numbers in parenthesis ( ) are reference numbers for parts listed in Bill of Materials.*

Installation instructions for **kit number 377031**

## DESCRIPTION:

This kit contains the parts needed to install an overhead guard on the model 6600 and 6650 XP sweepers.

Please follow step-by-step instructions.

## SPECIAL TOOLS / CONSIDERATIONS: Overhead Hoist, Hand Drill, 7/32 [5.56 mm] Drill bit

(Estimated time to complete: 1 hour)

## PREPARATION:

(Refer to FIG. 1 and 2)

**FOR SAFETY: Before leaving or servicing machine, stop on level surface and set parking brake. Then turn off machine and remove key.**

## INSTALLATION:

(Refer to FIG. 1 and 2)

1. Orient **OHG top 391850 (3)** upside down on a clean floor, or piece of cardboard.
2. Mount **right side legs 59665 (1)** and **left side legs 59666 (2)** to **OHG top 391850 (3)** with **hex screws 39283 (4)**, **flat washers 32492 (5)** and **lock nuts 41430 (6)**.  
Leave the mounting hardware only finger tight at this time. (Refer to FIG. 1)
3. Orient the overhead guard assembly right side up.
4. Lift the overhead guard assembly into mounting position upon the machine.

***NOTE: The Right Rear Leg Of The Overhead Guard Must Be Positioned On The Outside Of The Right Rear Corner Post.***

5. Mount the overhead guard assembly to machine with **hex screws 41346 (7)**, **flat washers 32486 (8)** and **lock nuts 08711 (9)**. (Refer to FIG. 1)
6. Tighten **hex screws 39283 (4)** and **lock nuts 41430 (6)** connecting overhead guard to support legs to 37–48 Nm (26–34 ft lb).
7. Tighten **hex screws 41346 (7)** and **lock nuts 08711 (9)** connecting support legs to the machine to 64–83 Nm (46–60 ft lb).

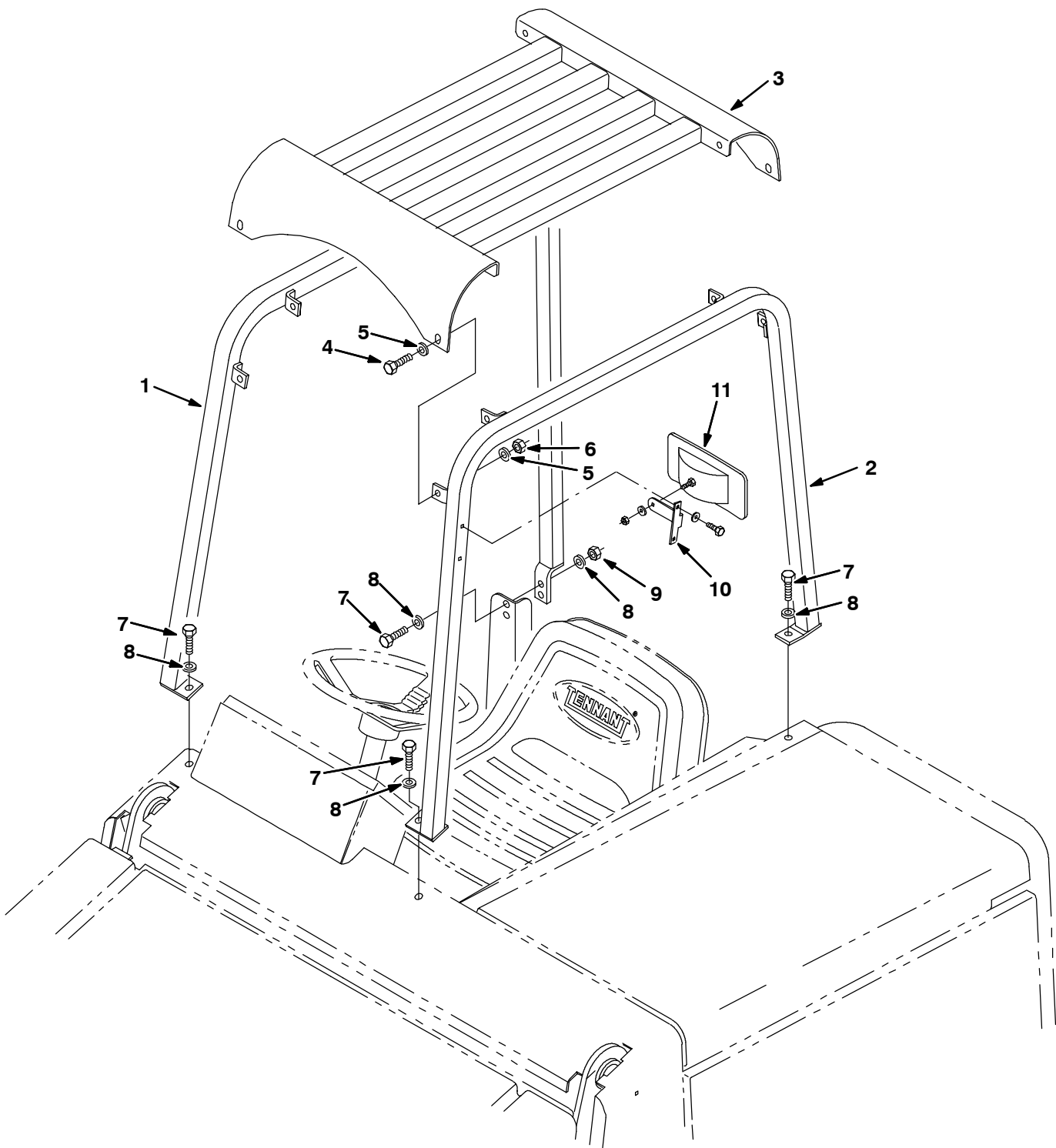

**FIG. 1 - Installation, Overhead Guard Kit 377031**

8. Orient **mirror mounting bracket 49032 (10)** with the mounting holes on the outside of the left, front support leg. If there are no mounting holes in the leg, use **mounting bracket 49032 (10)** as a template, and mark and drill two 7/32 in [5.56 mm] mounting holes in the overhead guard leg. Install **mirror mounting bracket 49032 (10)** with two thread rolling screws 24594. (Refer to FIG. 2)
9. Mount **mirror 49034 (11)** to **mirror mounting bracket 49032 (10)** with included hardware.

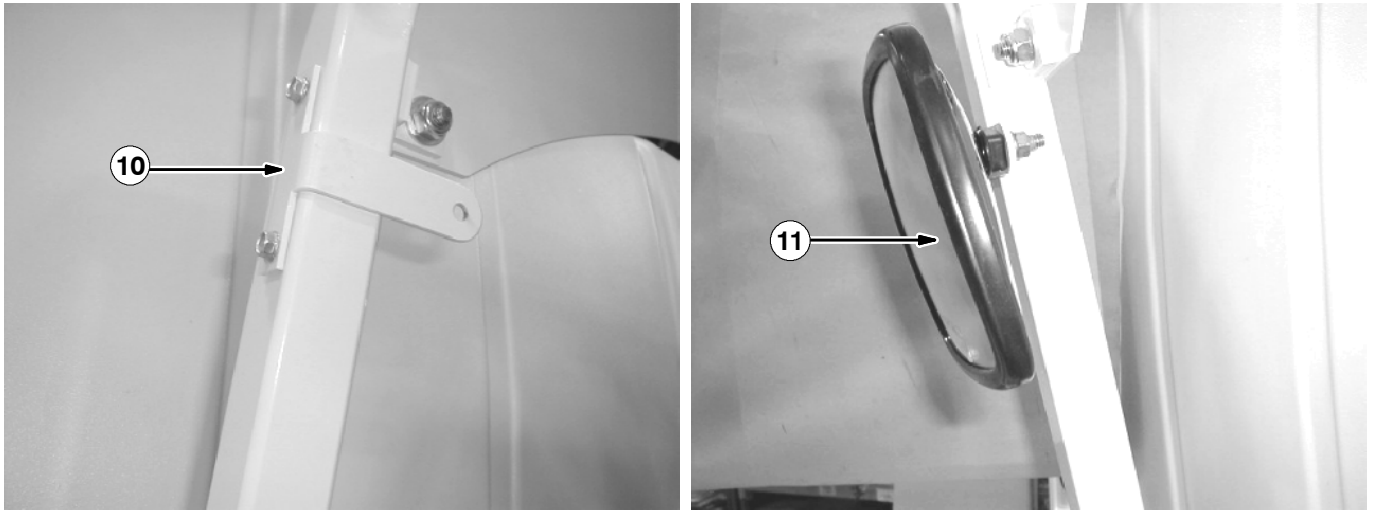

**FIG. 2 - Rear View Mirror Installation**

### **BILL OF MATERIALS FOR OHG [OVERHEAD GUARD] KIT 377031**

<b>Ref.</b>	<b>Tennant Part No.</b>	<b>Machine Serial Number</b>	<b>Description</b>	<b>Qty.</b>
▽	377031	(000000-	) Kit, Ci, Ohg [6600/6650]	1
▲ 1	59665	(000000-	) Tube Wldt, Leg, Ohg, Rh, White, [ 355]	1
▲ 2	59666	(000000-	) Tube Wldt, Leg, Ohg, Lh, White, [ 355]	1
▲ 3	391850	(000000-	) Guard Wldt, Ohg, Top	1
▲ 4	39283	(000000-	) Screw, Hex, M10 X 1.5 X 25, 8.8	8
▲ 5	32492	(000000-	) Washer, Flat, 0.38 Std	16
▲ 6	41430	(000000-	) Nut, Hex, Lock, M10 X 1.5, NI	8
▲ 7	41346	(000000-	) Screw, Hex, M12 X 1.75 X 30, 8.8	5
▲ 8	32486	(000000-	) Washer, Flat, 0.50 Sae	8
▲ 9	08711	(000000-	) Nut, Hex, Lock, M12 X 1.75, NI	3
▲ 10	49032	(000000-	) Bracket, Mtg, Mirror, Rearview	1
▲ 11	49034	(000000-	) Mirror, Convex, 06.7 X 06.2	1

TENNANT COMPANY  
P. O. Box 1452  
Minneapolis, MN 55440-1452