



INSTRUCTION BULLETIN

No. 340513
Machine: 5700
Published: 10-01/00
System: SCRUBBING

NOTE: DO NOT DISCARD the Parts List from the Instruction Bulletin. Place the Parts List in the appropriate place in your machine manual for future reference. Retaining the Parts List will make it easier to reorder individual parts and will save you the cost of ordering an entire kit.

NOTE: Numbers in parenthesis () are reference numbers for parts listed in Bill of Materials.

Installation instructions for kit number 374132

SYNOPSIS / PROBLEM:

This kit contains the parts needed to replace the solution control system on the model 5700 scrubber.

Please follow step-by-step instructions.

SPECIAL TOOLS / CONSIDERATIONS: NONE

(Estimated time to complete: 1 hour)

PREPARATION:

(Refer to FIG. 1 thru 4)

1. Empty the machine solution tank.
2. Move the machine to a clean level surface.

FOR SAFETY: Before leaving or servicing machine, stop on level surface and set parking brake. Then turn off machine and remove key.

3. Remove front cover from machine. Set the front cover and mounting hardware aside.
4. Locate the solution control group mounted underneath the front of the solution tank.
5. Raise the solution tank and engage the solution tank support arm.

INSTALLATION:

(Refer to FIG. 1 thru 4)

1. Disconnect and remove the front PVC hose from the solenoid valve and T-fitting mounted to the top of the scrub head. (Refer to FIG. 1)
2. Disconnect push/pull cable from the pinch lever on the valve mounting bracket.
3. Remove and set aside the pinch lever from the valve mounting bracket.
4. Remove and discard the straight hose connecting solution tank to solution control valve.
5. Remove and discard the old solenoid valve. (Refer to FIG. 1)
6. Remove the old valve mounting bracket from the machine. Set the mounting hardware aside. (Refer to FIG. 1)

7. Assemble the new solenoid valve (2) to the new mounting bracket (1) with two hex screws and lock nuts. Tighten hardware to 16–20 ft lbs. (Refer to FIG. 2)
8. Mount 90° water hose (3) to the solenoid valve (2) with wormdrive clamp. Hand tighten the wormdrive clamp with 5/16 nut driver. (Refer to FIG. 2)
9. Assemble the set aside pinch lever to the new mounting bracket (1) with a nylon washer (between the lever and bracket), hex screw, flat washer and lock nut. Hand tighten hardware. The pinch lever should move with a slight tension. (Refer to FIG. 2)
10. Mount the new solution valve (2) and bracket (1) assembly to the bottom of the solution tank, in place of the old assembly. Tighten hardware to 16–20 ft lbs. Connect the 90° water hose (3) to the tank with wormdrive clamp. Hand tighten the wormdrive clamp with 5/16 nut driver. (Refer to FIG. 2)
11. Connect the open end of the push pull cable to the pinch lever with the swivel and pan screw. Hand tighten the securing hardware. (Refer to FIG. 2)
12. Connect the machine harness 47A/GRY and 13M/BLK to the new solenoid valve (2). Secure the wire harness to the solenoid valve (2) with a plastic wire tie. (Refer to FIG. 3 and 4)
13. Replace the front cover on the machine. Disengage the solution tank support rod and lower the solution tank.
14. Check the machine and new solution control group for proper operation.

BILL OF MATERIALS FOR SOLUTION VALVE REPLACEMENT KIT 374754

Ref.	TENNANT Part No.	Description	Qty.
1	397787	Bracket, mtg, valve	1
2	374752	Valve, solenoid	1
3	397777	Hose, rbr, E90, 0.62ID 0.81ID (valve)	1
4	374753	Hose, PVC	1

TENNANT COMPANY
P. O. Box 1452
Minneapolis, MN 55440-1452

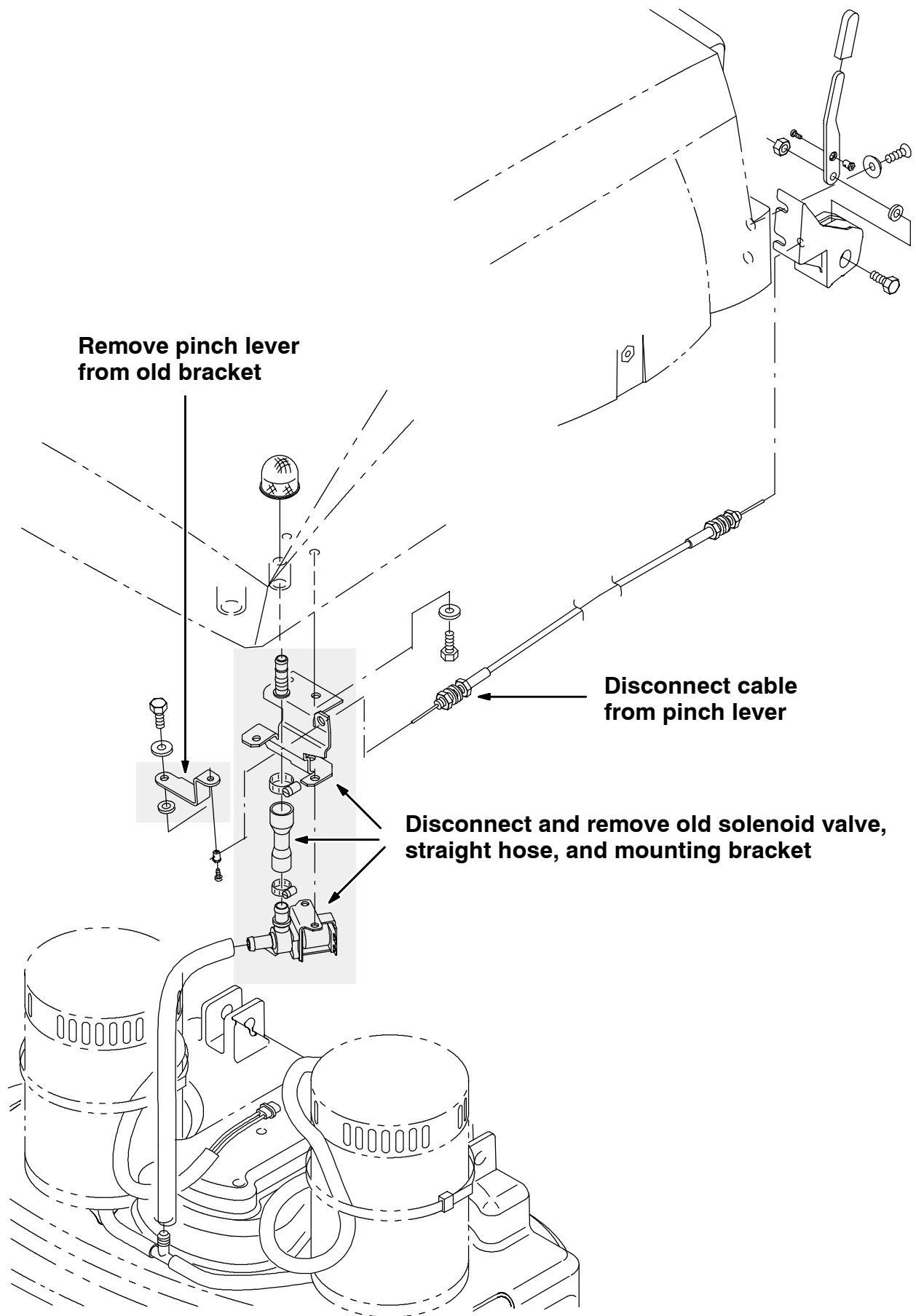

FIG. 1 - Old Solution Control Group, 5700

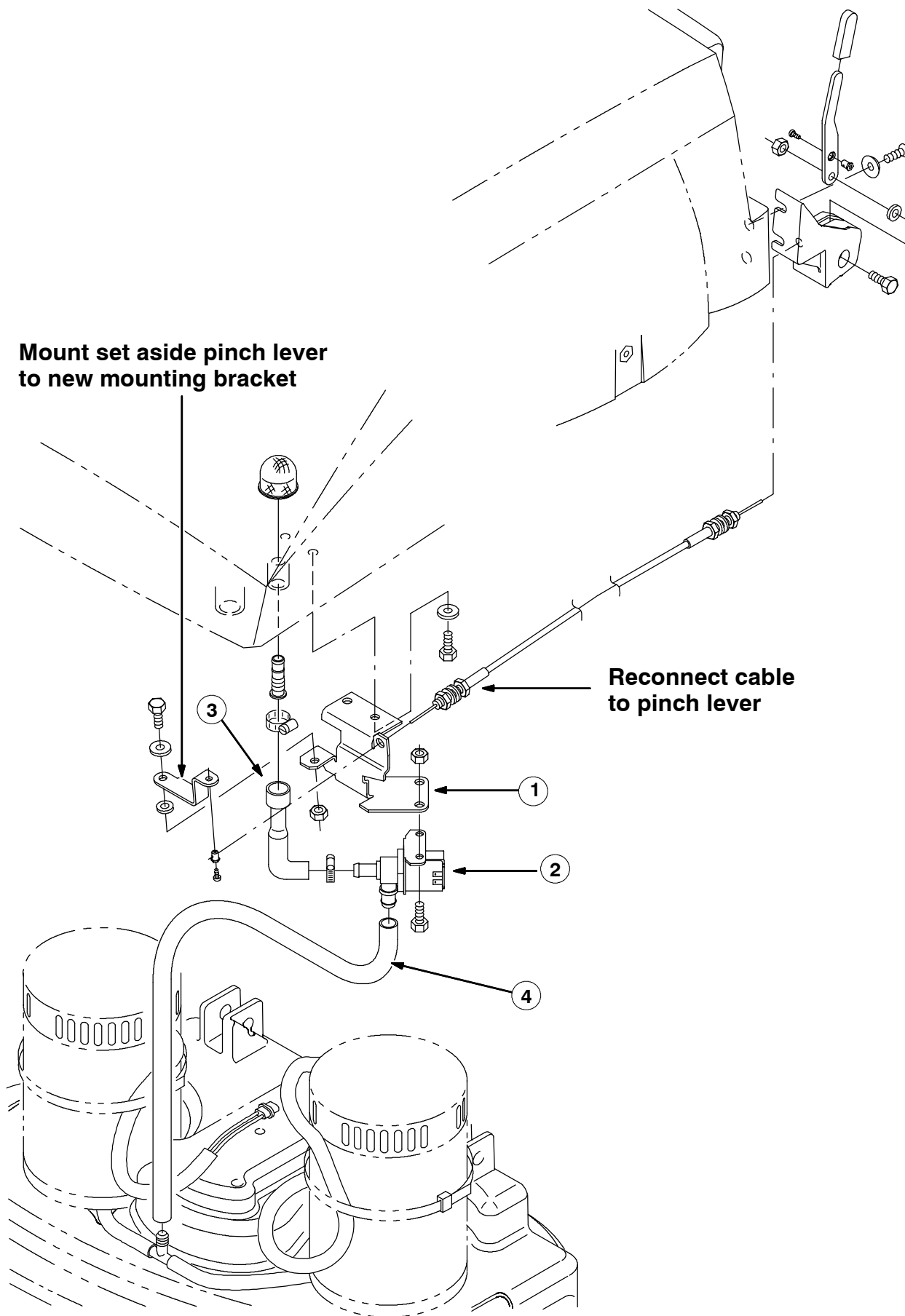

FIG. 2 - New Solution Control Group, 5700

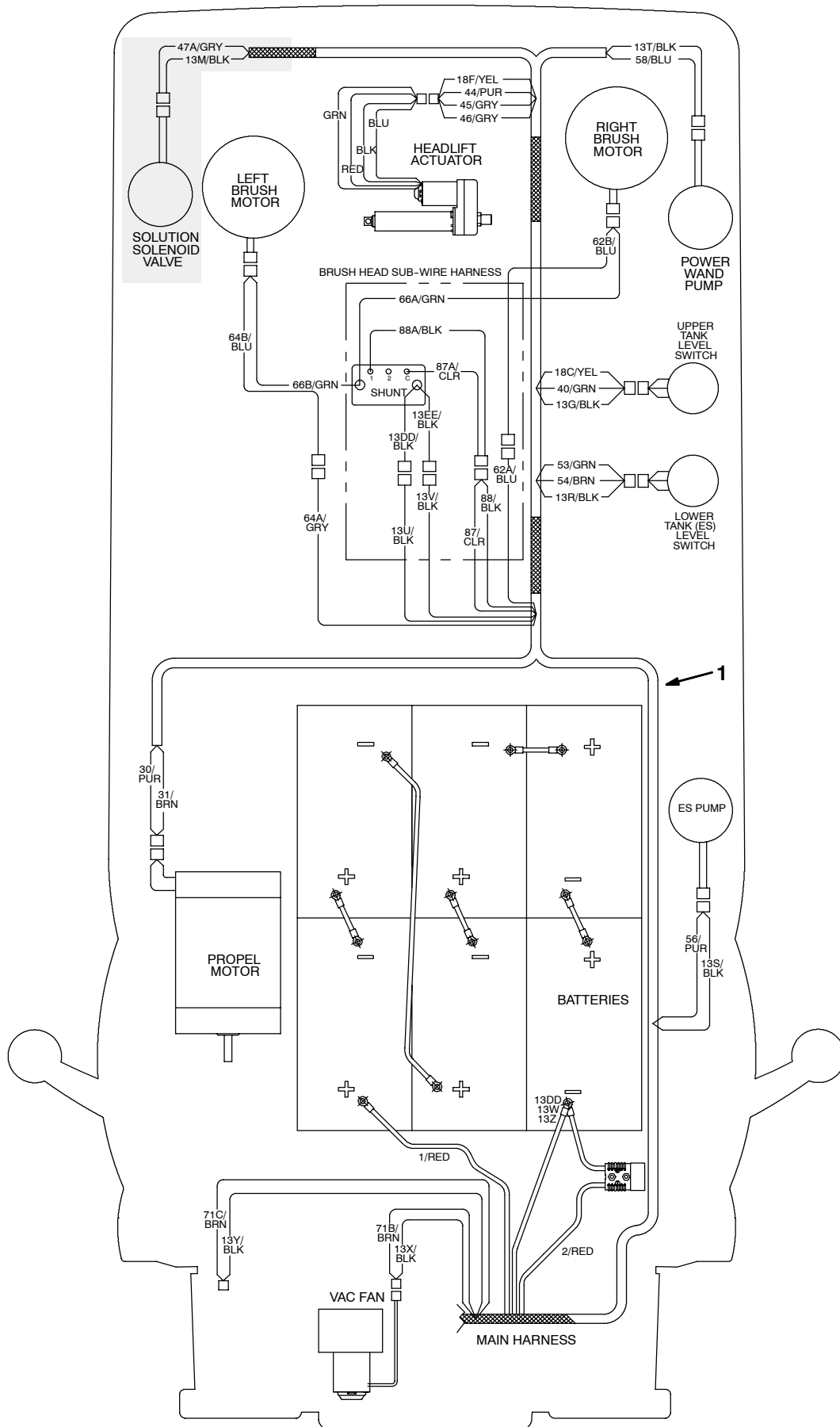

FIG. 3 - Wire Harness Group, 5700

