



INSTRUCTION BULLETIN

No. 340481
Machine: 8300
Published: 12-2009
Rev: 01

NOTE: DO NOT DISCARD the Parts List from the Instruction Bulletin. Place the Parts List in the appropriate place in the machine manual for future reference. Retaining the Parts List will make it easier to reorder individual parts and will save the cost of ordering an entire kit.

NOTE: Numbers in parenthesis () are reference numbers for parts listed in Bill of Materials.

Installation instructions for kit number 387542 / 387543 and 9006963 / 9006964

SYNOPSIS:

This kit contains the parts needed to install left and right panels on the model 8300 sweeper/scrubber.
Please follow step-by-step instructions.

SPECIAL TOOLS / CONSIDERATIONS: 1/2 Liter 50:50 water/Isopropyl alcohol mixture.

(Estimated time to complete: 2 hours)

PREPARATION:

1. Set the machine parking brake.
2. Unlatch and set aside the hopper cover.
3. Turn the machine power on.
4. Press and hold the hopper raise switch, until the hopper is in the fully raised position.

NOTE: Be aware that the minimum ceiling height needed to high dump the hopper is 1525 mm (60 in).

FOR SAFETY: When using machine, make sure adequate clearance is available before raising hopper.



WARNING: Lift arm pinch point. Stay clear of hopper lift arms.

5. Lower and position the hopper support bar onto the bar stop.



WARNING: Raised hopper may fall. Engage hopper support bar.

6. Press and hold the hopper lower switch until the hopper rests on the hopper support bar.
7. Turn the machine power off.

FOR SAFETY: Before leaving or servicing machine, stop on level surface, set parking brake, turn off machine, and remove key.

INSTALLATION:

(Refer to FIG. 1 and FIG. 2)

1. Disconnect and remove the right and left hand cable pulleys from each side of the hopper.
2. Remove the mounting hardware for each side panel. Set the mounting hardware aside.
3. Spray or use a rag to apply the 50/50 Isopropyl alcohol and water onto the mounting surface of the machine frame.
4. Scrub the machine frame surface with a separate clean rag or paper towel until the surface is dry. Change rags or towels often to avoid smearing dirt around or contaminating already clean surfaces.
5. Shake the Tape Primer 94 well before using. Use a brush or swab to apply a thin uniform coat of primer to the bonding surface. Apply the minimum amount of primer needed to fully coat the surface. Allow the primer to dry thoroughly before applying tape (5 min. at room temp).

NOTE: Porous surfaces may require two applications of Tape Primer 94. Allow the first coat of primer to dry before applying the second coat.

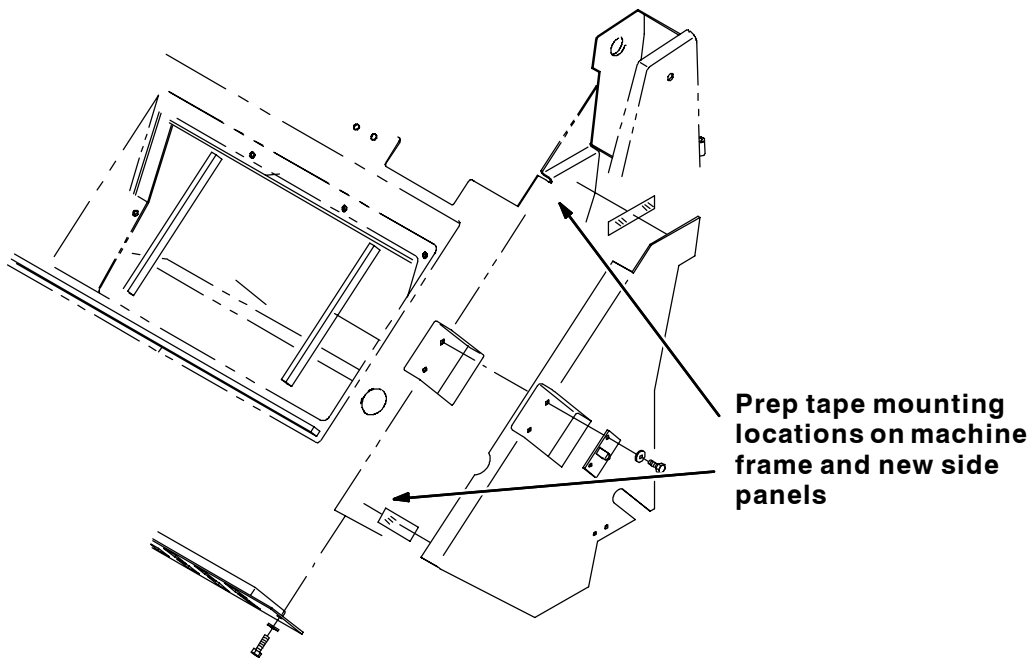

FIG. 1 - TAPE PREP

6. Mount the new side panels to the machine with the 3M tape. Secure the side panels to the machine with set aside mounting hardware.
7. Replace the right and left hand cable pulleys on each side of the machine.
8. Turn the machine power on
9. Press and hold the hopper raise switch, until the hopper is in the fully raised position.
10. Disengage the hopper support bar. Raise the hopper support bar into the storage position.
11. Press and hold the hopper lower switch, until the hopper is in the fully lowered position.
12. Reinstall the hopper cover
13. Check machine for proper operation.

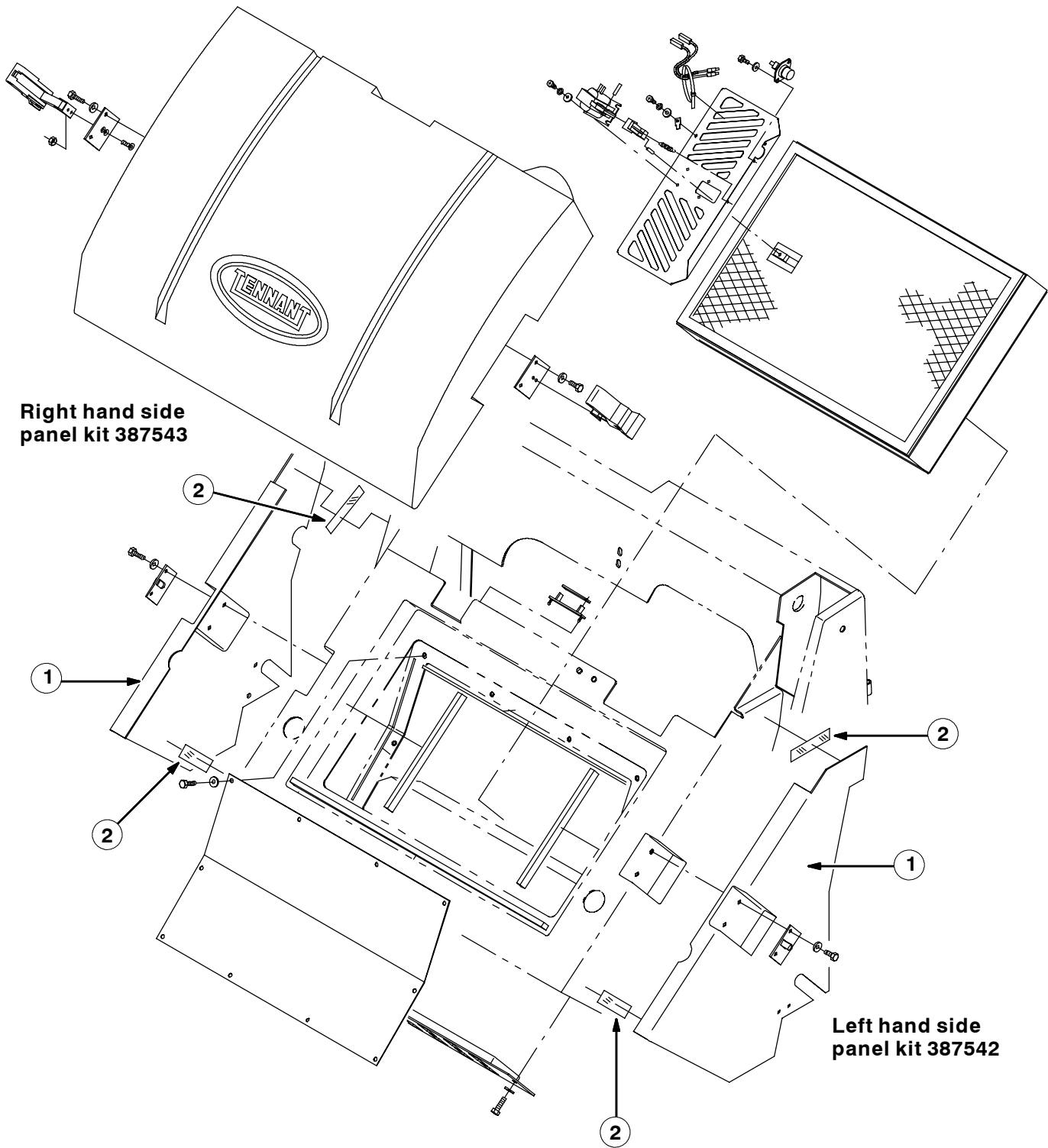

FIG. 2 - INSTALL RIGHT AND LEFT PANEL KITS

BILL OF MATERIALS FOR LEFT HAND PANEL KIT 387542

Ref.	TENNANT Part No.	Description	Qty.
1	387164	Panel, LH	1
2	387492	Tape	2
3	387493	Cleaner, primer, tape	1

BILL OF MATERIALS FOR RIGHT HAND PANEL KIT 387543

Ref.	TENNANT Part No.	Description	Qty.
1	387165	Panel, RH	1
2	387492	Tape	2
3	387493	Cleaner, primer, tape	1

BILL OF MATERIALS FOR LEFT HAND PANEL KIT 9006963

Ref.	TENNANT Part No.	Description	Qty.
4	1056797	Panel, LH, Teal	1
5	387492	Tape	2
6	387493	Cleaner, primer, tape	1

BILL OF MATERIALS FOR RIGHT HAND PANEL KIT 9006964

Ref.	TENNANT Part No.	Description	Qty.
1	1056798	Panel, RH, Teal	1
2	387492	Tape	2
3	387493	Cleaner, primer, tape	1

TENNANT COMPANY
P. O. Box 1452
Minneapolis, MN 55440-1452