



INSTRUCTION BULLETIN

No. 340471
Machine: 515, 8010
Published: 4-01/01
System: SCRUBBING

NOTE: DO NOT DISCARD the Parts List from the Instruction Bulletin. Place the Parts List in the appropriate place in your machine manual for future reference. Retaining the Parts List will make it easier to reorder individual parts and will save you the cost of ordering an entire kit.

NOTE: Numbers in parenthesis () are reference numbers for parts listed in Bill of Materials.

Installation instructions for kit number 383004

SYNOPSIS / PROBLEM:

This kit contains the parts needed to replace the scrub head lift actuator on the model 515 and 8010 sweeper/scrubber.

Please follow step-by-step instructions.

SPECIAL TOOLS / CONSIDERATIONS: None

(Estimated time to complete: 1 hour)

PREPARATION:

FOR SAFETY: Before leaving or servicing machine, stop on level surface and set parking brake. Then turn off machine and remove key.

1. Disconnect battery cables from machine.



WARNING: Always disconnect battery cables from machine before working on electrical components.

INSTALLATION:

(Refer to FIG. 1 thru 5)

1. Lower the rear squeegee and scrub head. Shut the machine off.

FOR SAFETY: Before Leaving Or Servicing Machine; Stop On Level Surface, Set Parking Brake, Turn Off Machine And Remove Key.

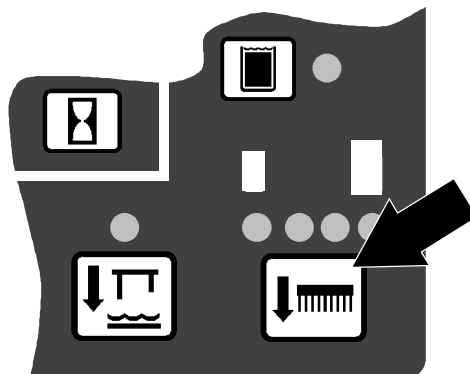

FIG. 1 - Lower scrub head

2. Remove the RH side squeegee assembly.

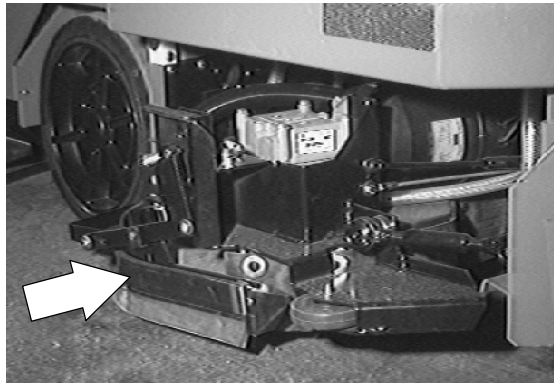

FIG. 2 - Remove RH squeegee

3. Disconnect the scrub head lift actuator from the main harness.
4. Go to the back of the machine, reach over the rear squeegee assembly, remove the cotter pin and clevis pin from the motor end of the scrub head lift actuator. Let the actuator drop down and rest on the rear squeegee mounting frame.

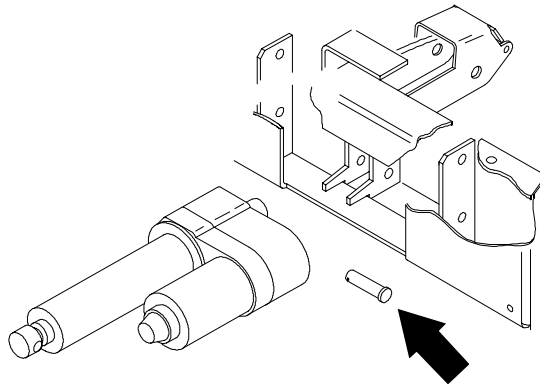

FIG. 3 - Remove actuator rear clevis pin

5. Reach in from the RH side of the machine and remove the cotter pin and clevis pin from the rod end of the scrub head lift actuator where it connects to the head lift bracket.
6. The scrub head lift actuator can now be removed from the machine. *Go out the right side of the machine.*

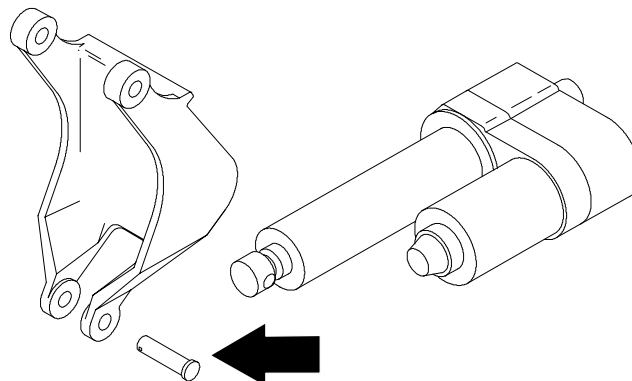

FIG. 4 - Remove actuator front clevis pin

7. Position the new scrub head lift actuator under the machine on the RH side.
8. Line up the hole in the rod end of the scrub head lift actuator with the mounting hole in the head lift bracket. Reinstall the clevis pin and cotter pin.

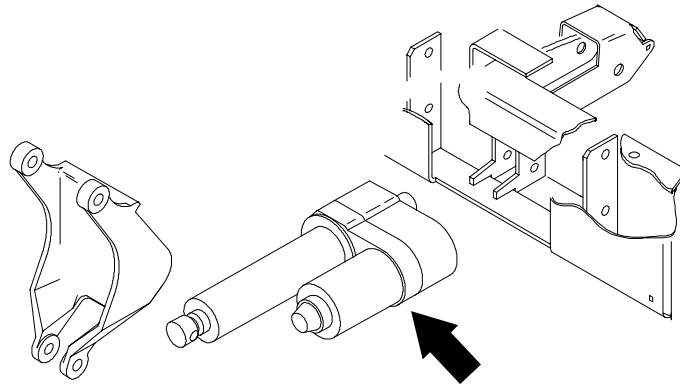

FIG. 5 -

9. Go to the back of the machine, reach over the rear squeegee assembly, lift up the motor end of the scrub head lift actuator, line up the mounting holes and install the clevis pin and cotter pin.
10. Reconnect the scrub head lift actuator to the main harness.
11. Operate the machine and check for proper scrub head lift actuator operation.

BILL OF MATERIALS FOR ACTUATOR REPLACEMENT KIT 383004

| Ref. | TENNANT Part No. | Description | Qty. |
|-------------|-----------------------------|--------------------|-------------|
| 1 | 383005 | Actuator | 1 |

TENNANT COMPANY
P. O. Box 1452
Minneapolis, MN 55440-1452