



INSTRUCTION BULLETIN

No. 340454
Machine: 6100
Published: 2-01/00
System: CHASSIS

NOTE: DO NOT DISCARD the Parts List from the Instruction Bulletin. Place the Parts List in the appropriate place in your machine manual for future reference. Retaining the Parts List will make it easier to reorder individual parts and will save you the cost of ordering an entire kit.

NOTE: Numbers in parenthesis () are reference numbers for parts listed in Bill of Materials.

Installation instructions for kit number 369784

SYNOPSIS / PROBLEM:

This kit contains the pilot hubs needed to center the wheels on the hubs when mounting the rear wheels on the model 6100 sweeper in the field.

Please follow step-by-step instructions.

SPECIAL TOOLS / CONSIDERATIONS: HYDRAULIC JACK, TORQUE WRENCH

(Estimated time to complete: 1 hour)

PREPARATION:

(Refer to FIG. 1)

FOR SAFETY: Before leaving or servicing machine, stop on level surface and set parking brake. Then turn off machine and remove key.

INSTALLATION:

(Refer to FIG. 1)

1. Set the machine parking brake, and block the front tire on the machine.
2. Block the rear tire on the right hand side of the machine.
3. Remove the hopper from the rear of the machine for access to axle pins.

FOR SAFETY: When servicing machine, block machine tires before jacking machine up.

4. Loosen the nut on the left rear axle pin, on the left hand side of the machine.
5. Lift the left rear corner of the machine with a jack at the designated jacking location.

FOR SAFETY: When servicing machine, block machine tires before jacking machine up. Jack machine up at designated locations only. Block machine up with jack stands. Use a jack that will support the weight of the machine.

6. Remove the left rear axle pin, wheel, washer and lock nut. Set the axle pin and hardware aside.
7. Remove the hex screws, washers and lock nuts connecting the wheel to the wheel housing. Set the wheel aside.
8. Place the new pilot (1) on the outside of the wheel housing. Align the pilot mounting holes with the wheel housing mounting holes. (Refer to FIG. 1)

9. Mount the set aside wheel to the pilot (1) and housing with three new hex screws (2), flat washers (3) and lock nuts (4). Tighten mounting hardware to 22-28 Nm(16-20 ft lbs). (Refer to FIG. 1)
10. Align flat edge of axle pin with flat edge of D hole in frame. Replace wheel assembly in machine with the set aside axle pin, washer and hex nut. Tighten hardware to 30-40 Nm (22-29 ft lbs). DO NOT OVERTIGHTEN. Too much torque can damage the axle. (Refer to FIG. 1)
11. Lower the machine to the floor. Repeat steps 3-9 on the right hand side of the machine.
12. Start the machine and check the rear wheels for proper rotation.

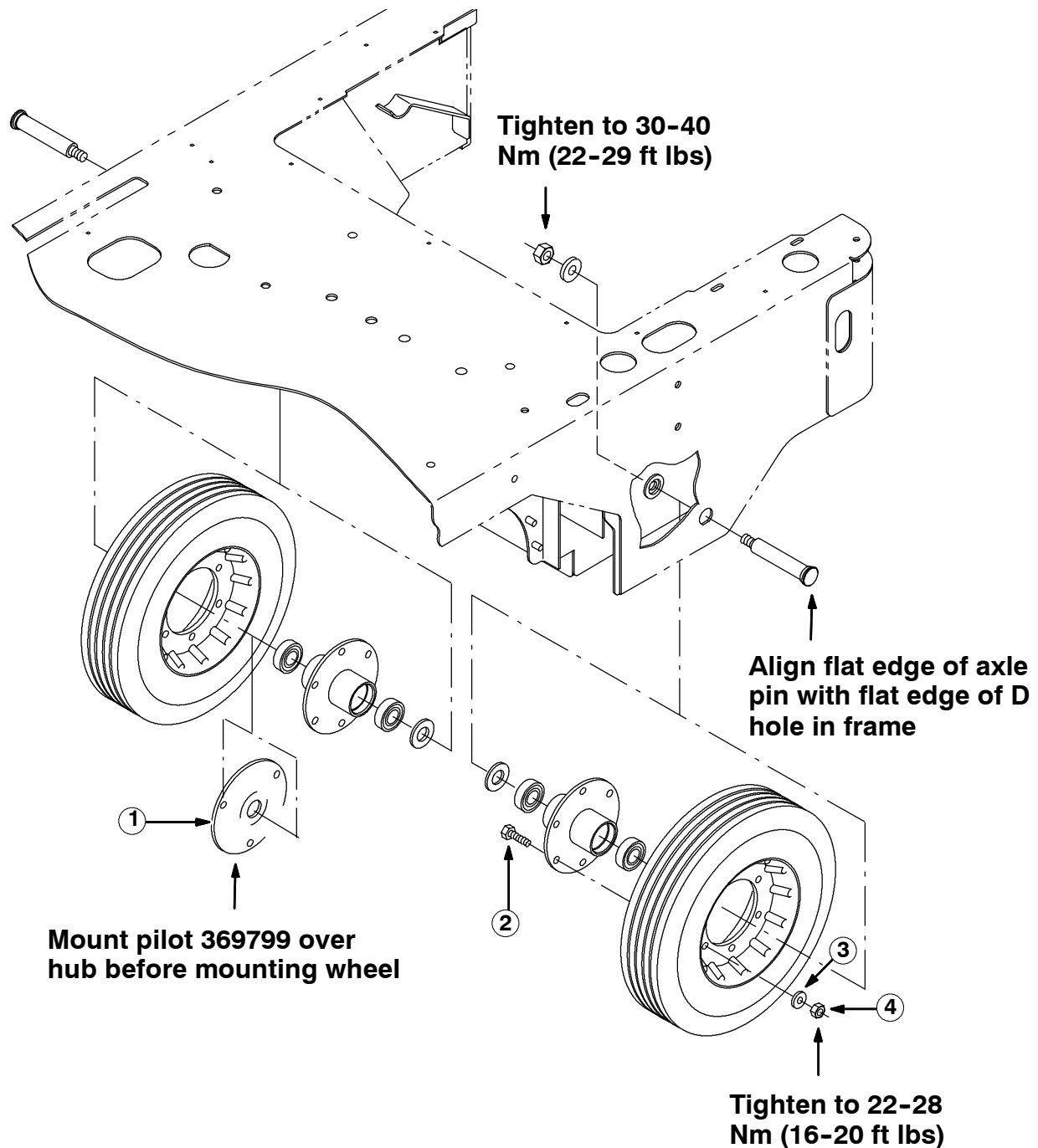

FIG. 1 - PILOT HUB KIT INSTALLATION

BILL OF MATERIALS FOR PILOT WHEEL MODIFICATION KIT 369784

Ref.	TENNANT Part No.	Description	Qty.
1	369799	Disc wldt, flange, wheel	2
2	39277	Screw, hex, M08 X 1.25 X 25, 8.8	6
3	39349	Washer, flt, 0.31 SAE	6
4	08709	Nut, hex, lock, M08 X 1.25, NL	6

TENNANT COMPANY
P. O. Box 1452
Minneapolis, MN 55440-1452