



# INSTRUCTION BULLETIN

No. 340433  
Machine: 7300/8300  
Published: 12-2009  
Rev: 01

**NOTE: DO NOT DISCARD the Parts List from the Instruction Bulletin. Place the Parts List in the appropriate place in the machine manual for future reference. Retaining the Parts List will make it easier to reorder individual parts and will save the cost of ordering an entire kit.**

*NOTE: Numbers in parenthesis ( ) are reference numbers for parts listed in Bill of Materials.*

Installation instructions for kit number 387324

## SYNOPSIS:

This kit contains the parts needed to install a 36V, 380AH, wet battery kit on 7300 / 8300 machines.  
Please follow step-by-step instructions.

## SPECIAL TOOLS / CONSIDERATIONS: NONE

(Estimated time to complete: 1 hour)

## PREPARATION:

**FOR SAFETY:** Before leaving or servicing machine, stop on level surface, set parking brake, turn off machine, and remove key.

1. Open the top battery compartment cover, and secure in position with the cover support rod.
2. Open the rear battery compartment door.
3. Disconnect battery pack from machine.



**WARNING:** Always disconnect battery cables from machine before working on electrical components.

## INSTALLATION:

(Refer to FIG. 1 and FIG. 2)

1. Remove the existing battery pack from battery compartment with chain hoist or lift.
2. Remove any existing battery pack spacers from the rear battery compartment.

**NOTE: When servicing machine, use hoist or lift that will support the weight of the battery pack.**

3. **7300 MACHINE:** Carefully install the new battery pack (1) in the front of the battery compartment, and secure in place with the battery spacers (2), hex screws (3), washers (4) and nuts (5).
4. **8300 MACHINE:** To insure proper machine balance, carefully install the new battery pack (1) in the very rear of the battery compartment, and secure in place with two battery spacers (2), hex screws (3), washers (4) and nuts (5). (Refer to FIG. 2)
5. Connect the battery connector to the machine connector. Close the rear battery compartment door and the top battery compartment cover.

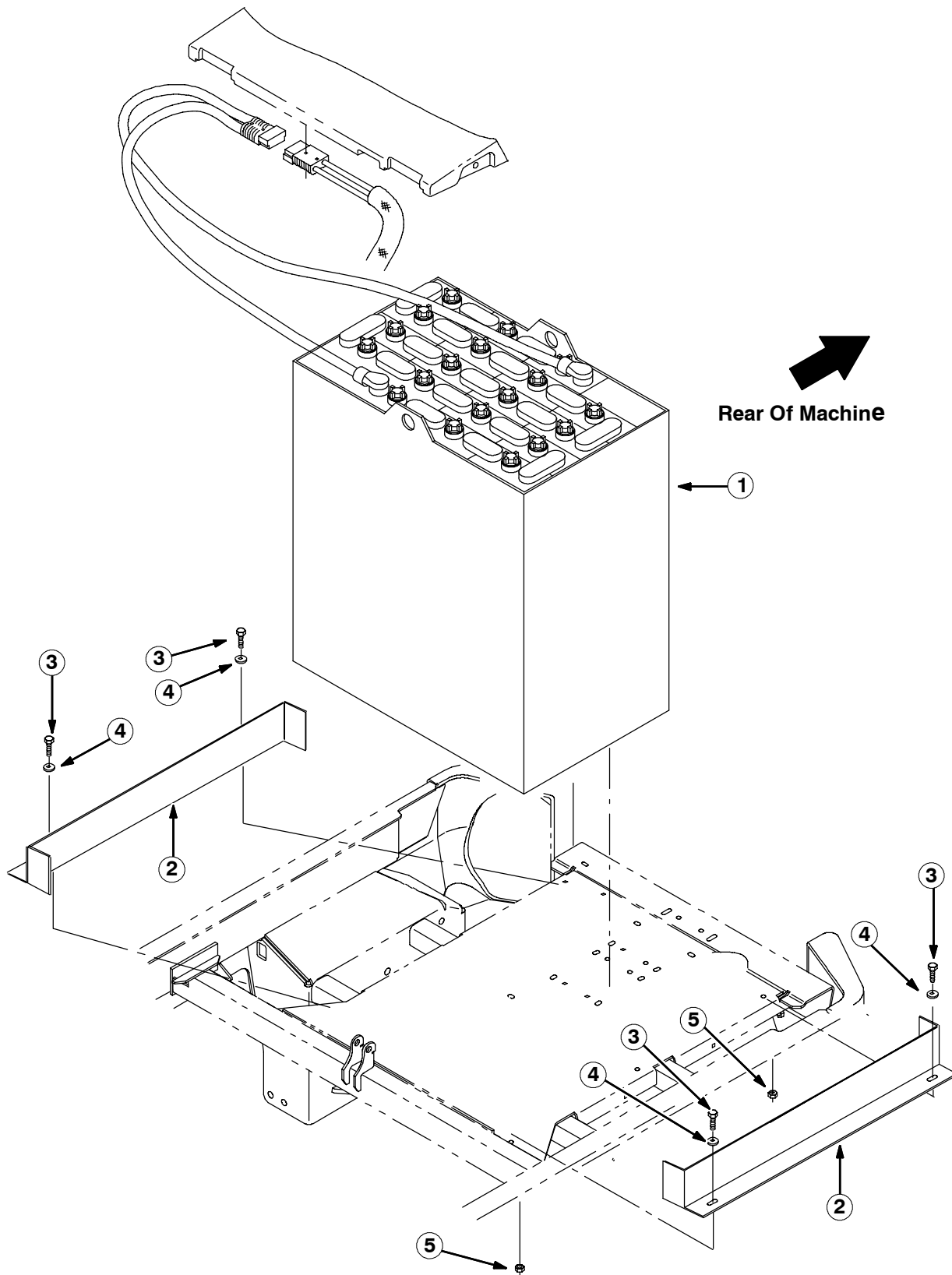

**FIG. 1 - BATTERY KIT, 7300 (36VDC, 380AH) INSTALLATION**

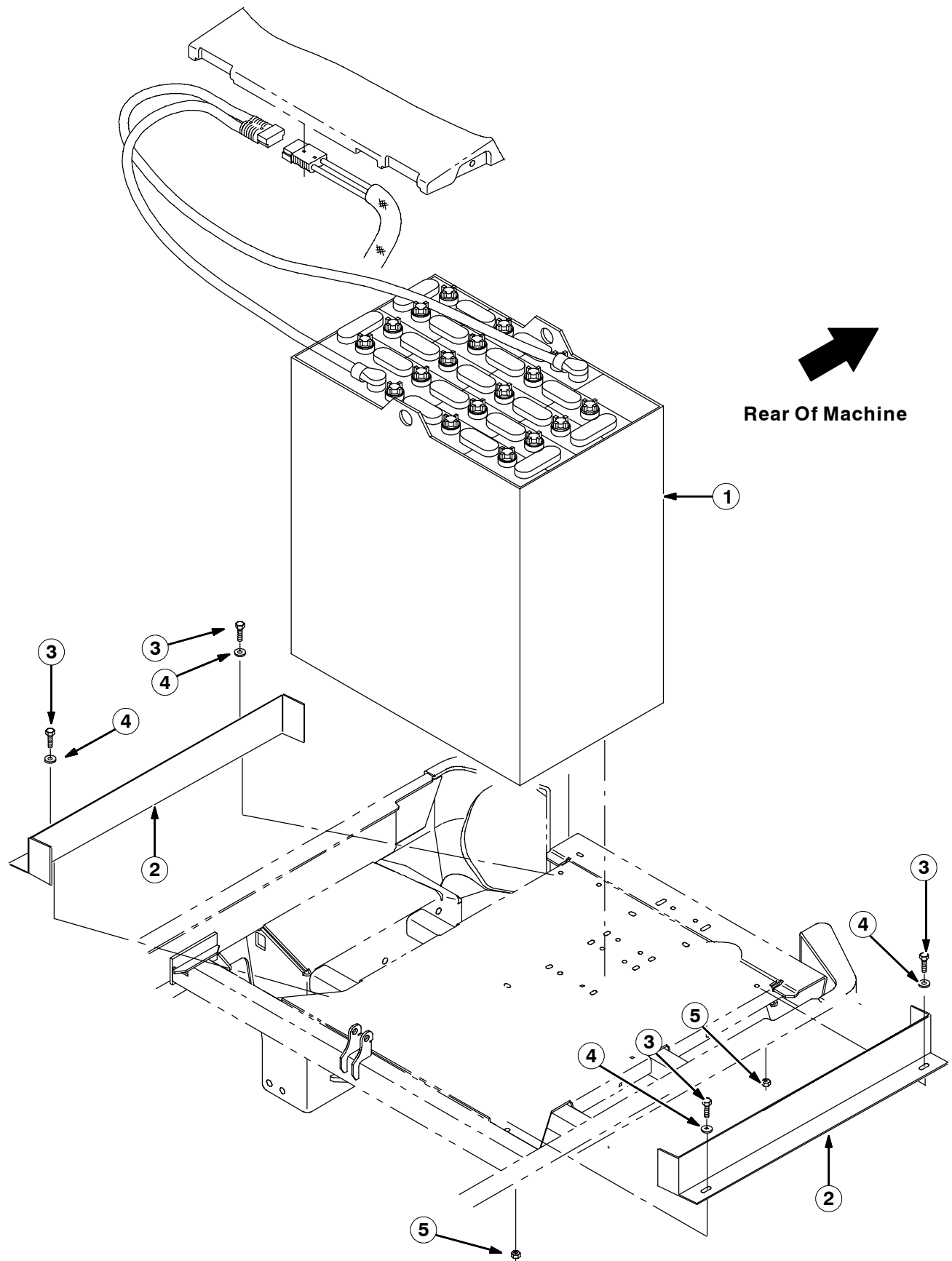

**FIG. 2 - BATTERY KIT, 8300 (36VDC, 380AH) INSTALLATION**

---

**BILL OF MATERIALS FOR 36V, 380AH, WET BATTERY KIT 387324**

---

<b>Ref.</b>	<b>TENNANT Part No.</b>	<b>Description</b>	<b>Qty.</b>
1	387322	Battery, 36V, 380AH, Wet	1
2	1056927	Spacer, Battery, Stl, Iron Gray	2
3	09740	Screw, Hex, M08-1.25 X 20, SS	4
4	01685	Washer, Flat, .31, SS	4
5	08713	Nut, Hex, Lock, M08-1.25, NL, SS	4

---

TENNANT COMPANY  
P. O. Box 1452  
Minneapolis, MN 55440-1452