



INSTRUCTION BULLETIN

No. 340423

Machine: 465, 480, 480EE
and 490

Published: 6-00/00

System: OPTIONS

NOTE: DO NOT DISCARD the Parts List from the Instruction Bulletin. Place the Parts List in the appropriate place in your machine manual for future reference. Retaining the Parts List will make it easier to reorder individual parts and will save you the cost of ordering an entire kit.

NOTE: Numbers in parenthesis () are reference numbers for parts listed in Bill of Materials.

Installation instructions for kit number 397647

SYNOPSIS / PROBLEM:

This kit replaces combination gauge #11488, which was used to indicate battery discharge, and brush down pressure. An interchangeable gauge with dual functions is not available. We are providing alternate gauges, but the hourmeter will be removed to mount the new battery discharge gauge. If a location to mount the old hourmeter can be found, reconnect wires 37/ORA and 13N/BLK to the hourmeter.

Please follow step-by-step instructions.

SPECIAL TOOLS / CONSIDERATIONS:

(Estimated time to complete: hour)

PREPARATION:

(Refer to FIG. 1 thru 5)

FOR SAFETY: Before leaving or servicing machine, stop on level surface and set parking brake. Then turn off machine and remove key.

1. Disconnect battery cables from machine.



WARNING: Always disconnect battery cables from machine before working on electrical components.

INSTALLATION:

(Refer to FIG. 1 thru 5)

1. Disconnect gauge #11488 from the shunt and wire harness. Remove the gauge from the instrument panel.
2. Disconnect the existing hourmeter #31988, and remove it from the instrument panel. Wrap the terminals on the ends of wires 37/ORA and 13N/BLK with electrical tape to insulate them, and prevent a short. The wrapped wires will not be used.
3. Install the new brush down pressure gauge #222215 in place of the old gauge. Install the new battery discharge indicator gauge #222215 in the panel where the hourmeter was located.
4. Install the new gauge harness #397646 as shown in the wiring schematic.

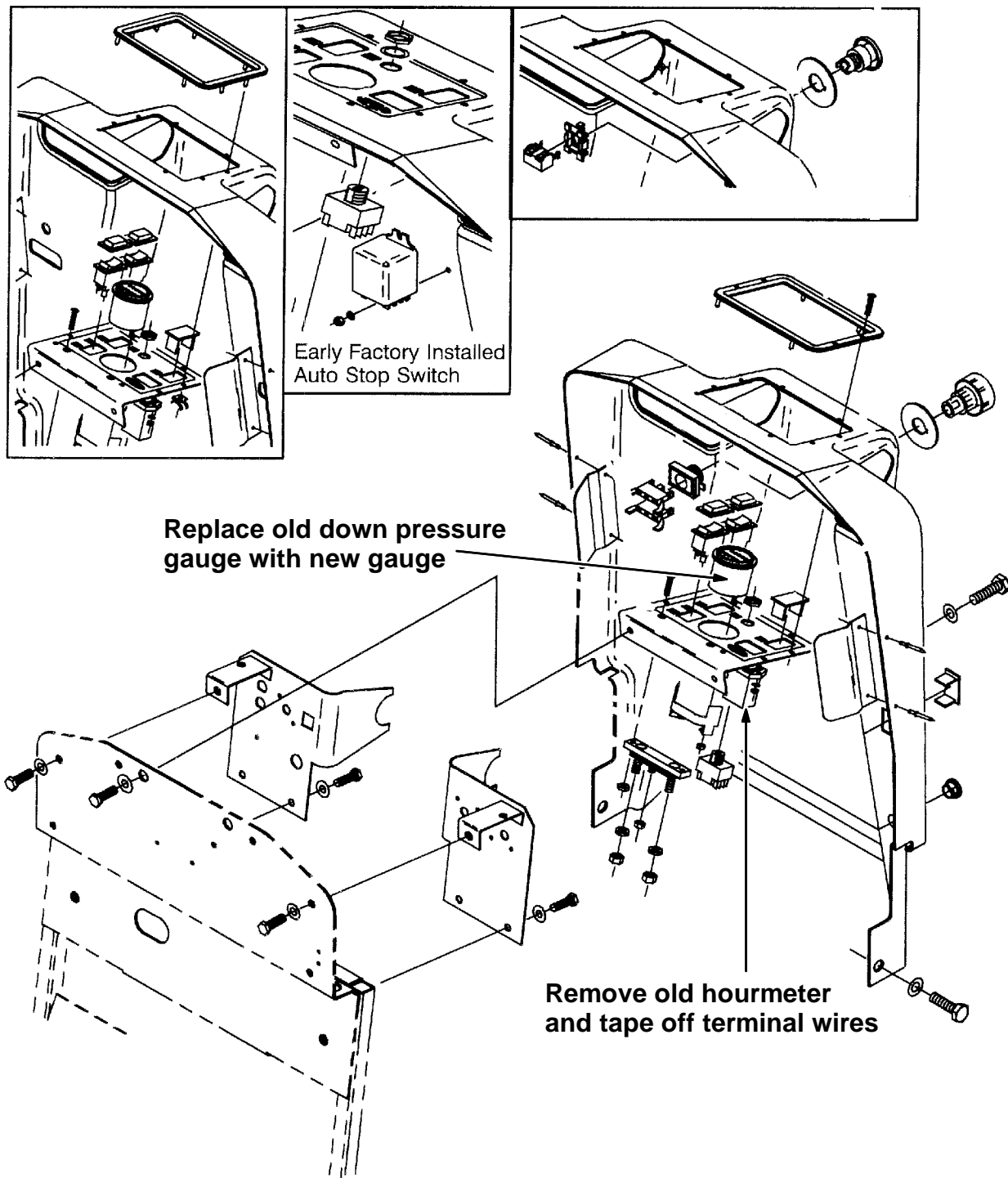

FIG. 1 - 465 REAR ELECTRICAL PANEL GROUP

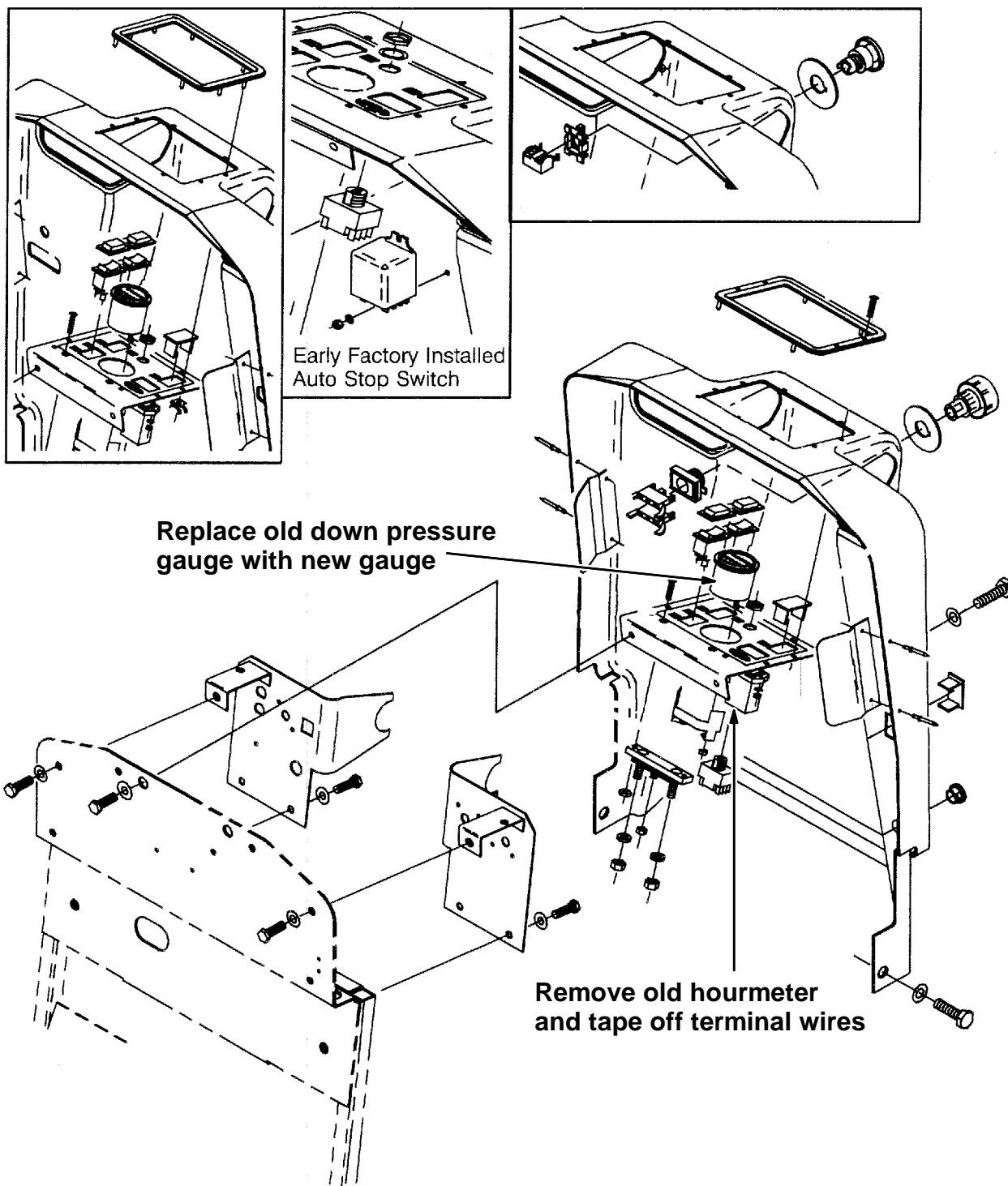
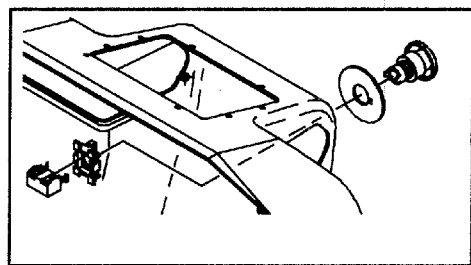
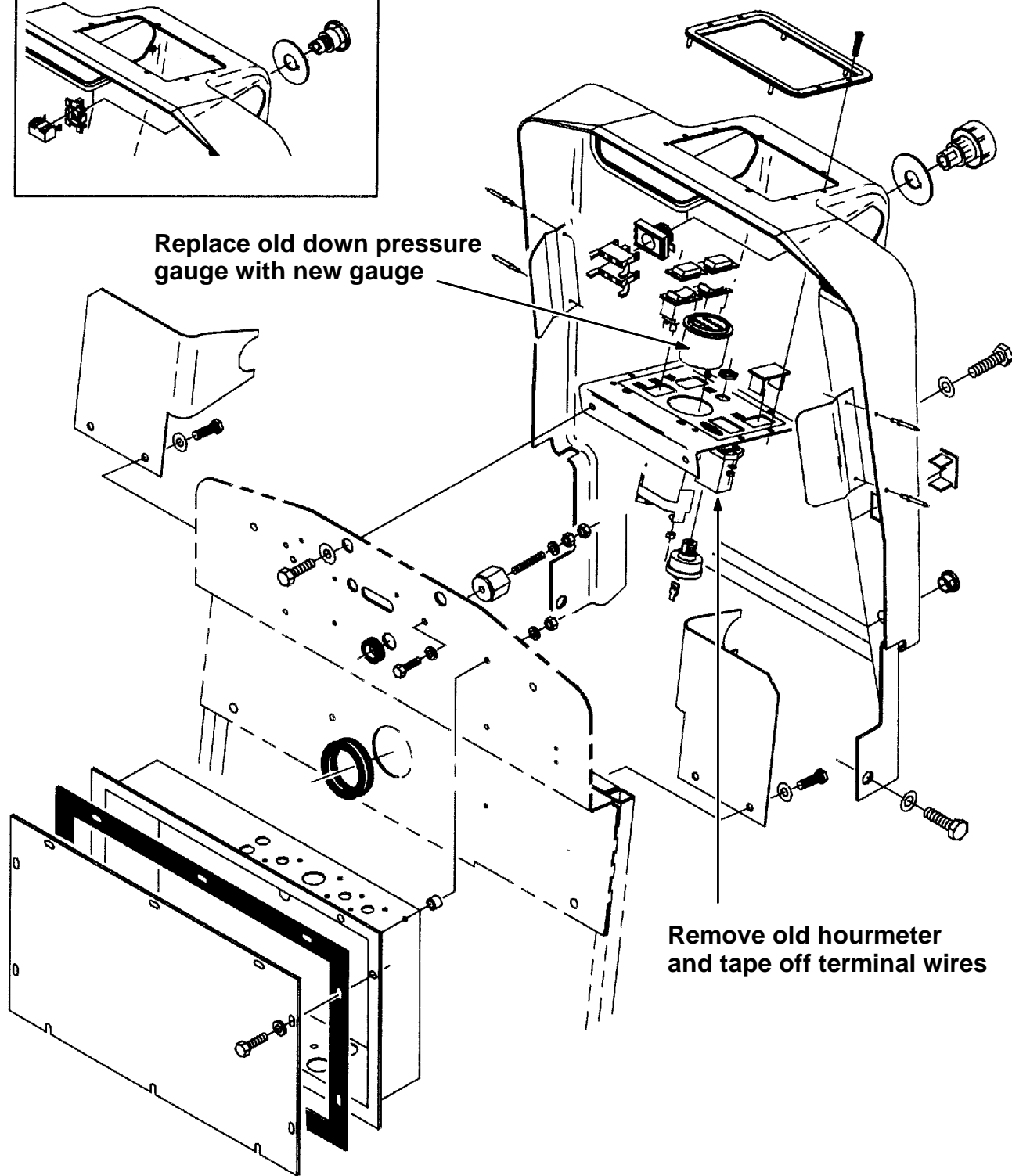

FIG. 2 - 480 REAR ELECTRICAL PANEL GROUP



Replace old down pressure gauge with new gauge



Remove old hourmeter and tape off terminal wires

FIG. 3 - 480EE REAR ELECTRICAL PANEL GROUP

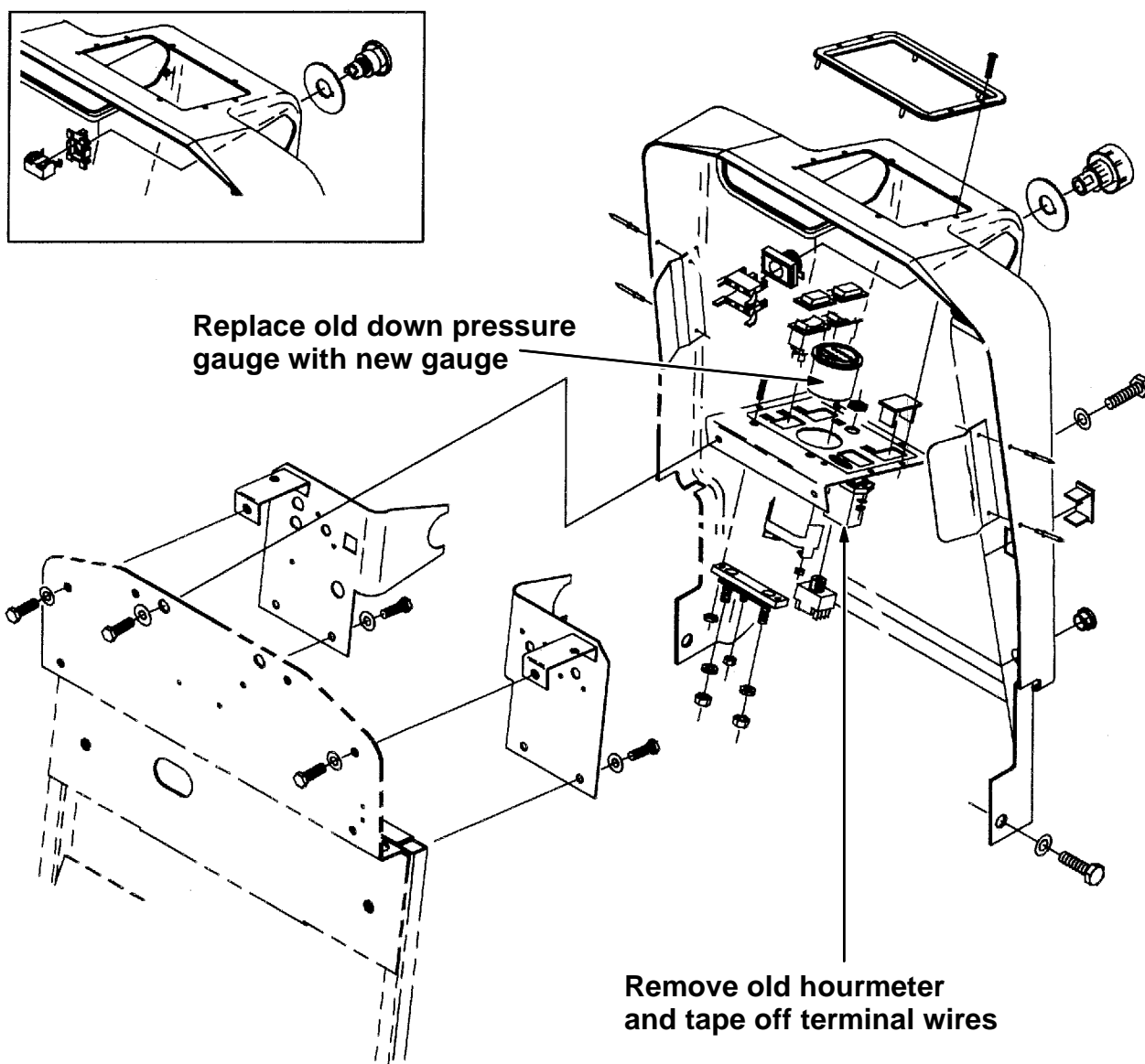

FIG. 4 - 490 REAR ELECTRICAL PANEL GROUP

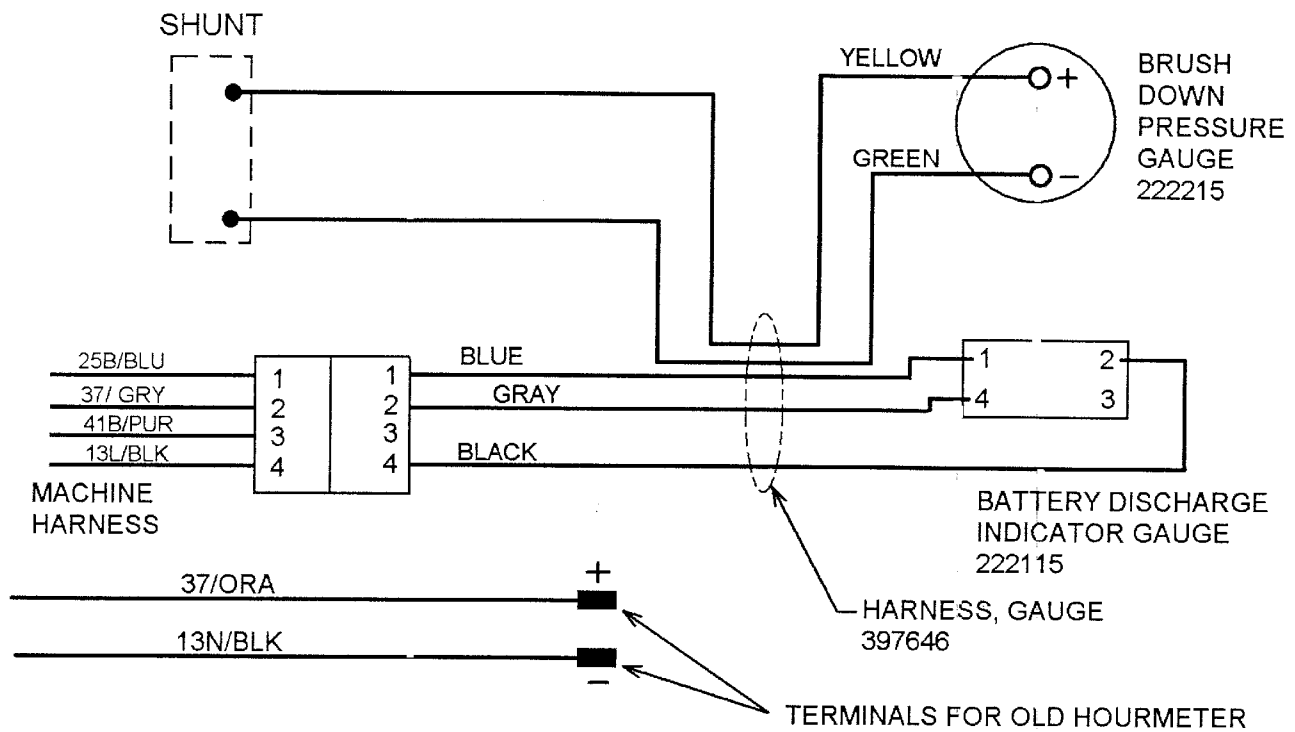

FIG. 5 - SCHEMATIC FOR KIT 397647

BILL OF MATERIALS FOR REPLACEMENT GAUGE KIT 397647

Ref.	TENNANT Part No.	Description	Qty.
1	397646	Harness, gauge	1
2	222215	Gauge, voltmeter	1
3	222215	Gauge, battery, 36VDC, 2.1 X 1.2	1

TENNANT COMPANY
P. O. Box 1452
Minneapolis, MN 55440-1452