



# INSTRUCTION BULLETIN

No. 340413  
Machine: 6400D  
Published: 7-00/00  
System: ENGINE

**NOTE: DO NOT DISCARD the Parts List from the Instruction Bulletin. Place the Parts List in the appropriate place in your machine manual for future reference. Retaining the Parts List will make it easier to reorder individual parts and will save you the cost of ordering an entire kit.**

*NOTE: Numbers in parenthesis ( ) are reference numbers for parts listed in Bill of Materials.*

Installation instructions for kit number 375062

## **SYNOPSIS / PROBLEM:**

This kit contains the parts needed to replace the fuel line, remove the fuel filter, add a jumper wire, and remove a diode on the model 6400D sweeper.

Please follow step-by-step instructions.

## **SPECIAL TOOLS / CONSIDERATIONS: NONE**

(Estimated time to complete: 2 hours)

## **PREPARATION:**

(Refer to FIG. 1 thru 6)

**FOR SAFETY: Before leaving or servicing machine, stop on level surface and set parking brake. Then turn off machine and remove key.**

1. Open the rear machine cover with the cover latch.
2. Locate the fuel tank group in the rear of the machine.

## **INSTALLATION:**

(Refer to FIG. 1 thru 6)

1. Loosen the hose clamps, and remove the 3 in. hose from the fuel tank. Set the hose clamps aside. (Refer to FIG. 1)
2. Remove the fuel line compression fitting connecting the fuel line to the fuel filter. (Refer to FIG. 1)
3. Disconnect and remove the fuel filter from the fuel pump. (Refer to FIG. 1)
4. Clean the threads leading into the fuel pump with a rag or air hose.
5. Apply the 242 blue locktite (3) completely around 3-4 threads of the new straight fitting (2). Install the new straight fitting (2) into the fuel pump. (Refer to FIG. 2)
6. Pull the metal fuel line to the new straight fitting (2), and install with the compression fitting. (Refer to FIG. 2)
7. Install the new fuel hose (1) with the set aside hose clamps. (Refer to FIG. 2)

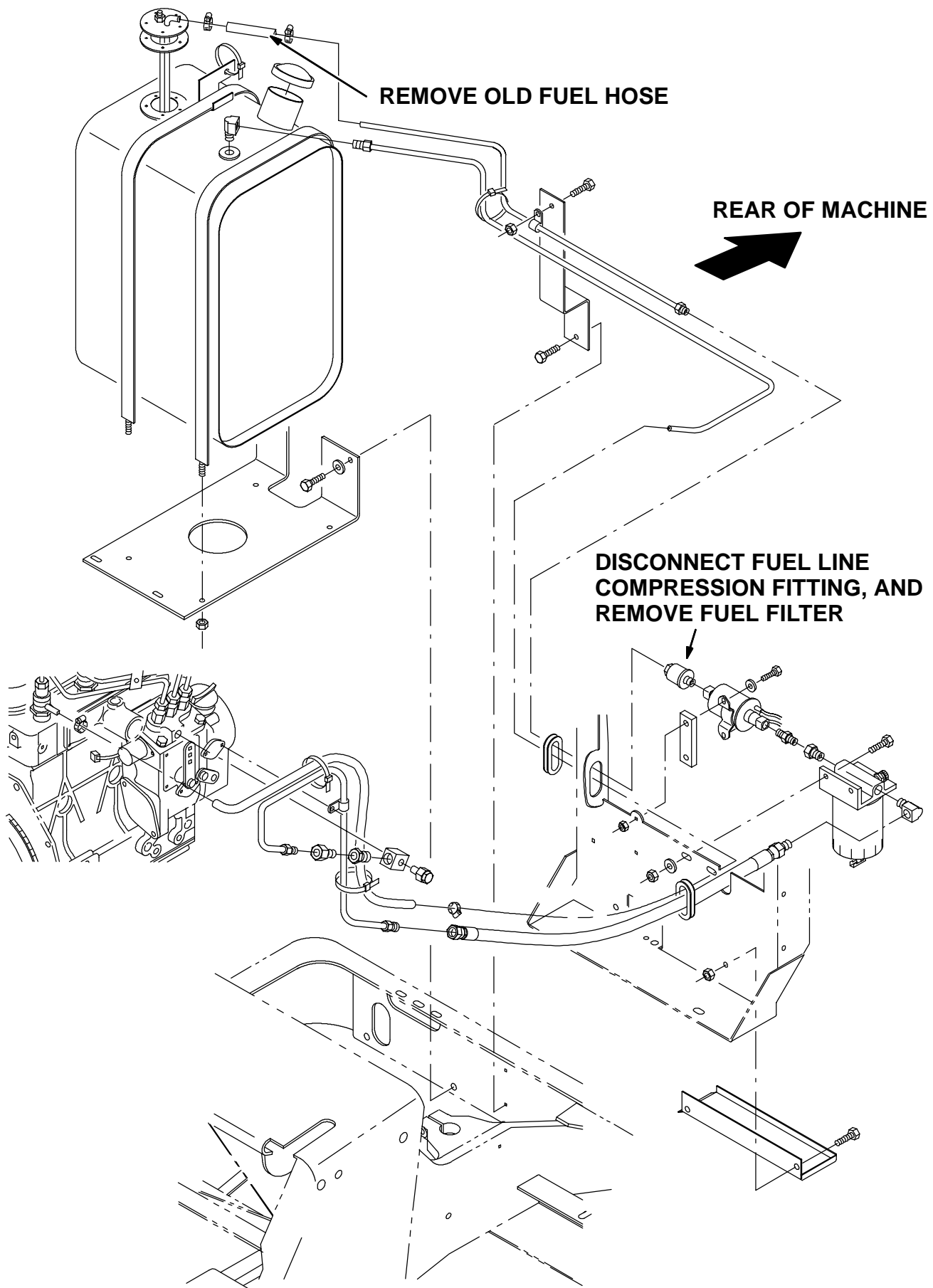

**FIG. 1 - FUEL FILTER AND OLD FUEL HOSE REMOVAL**

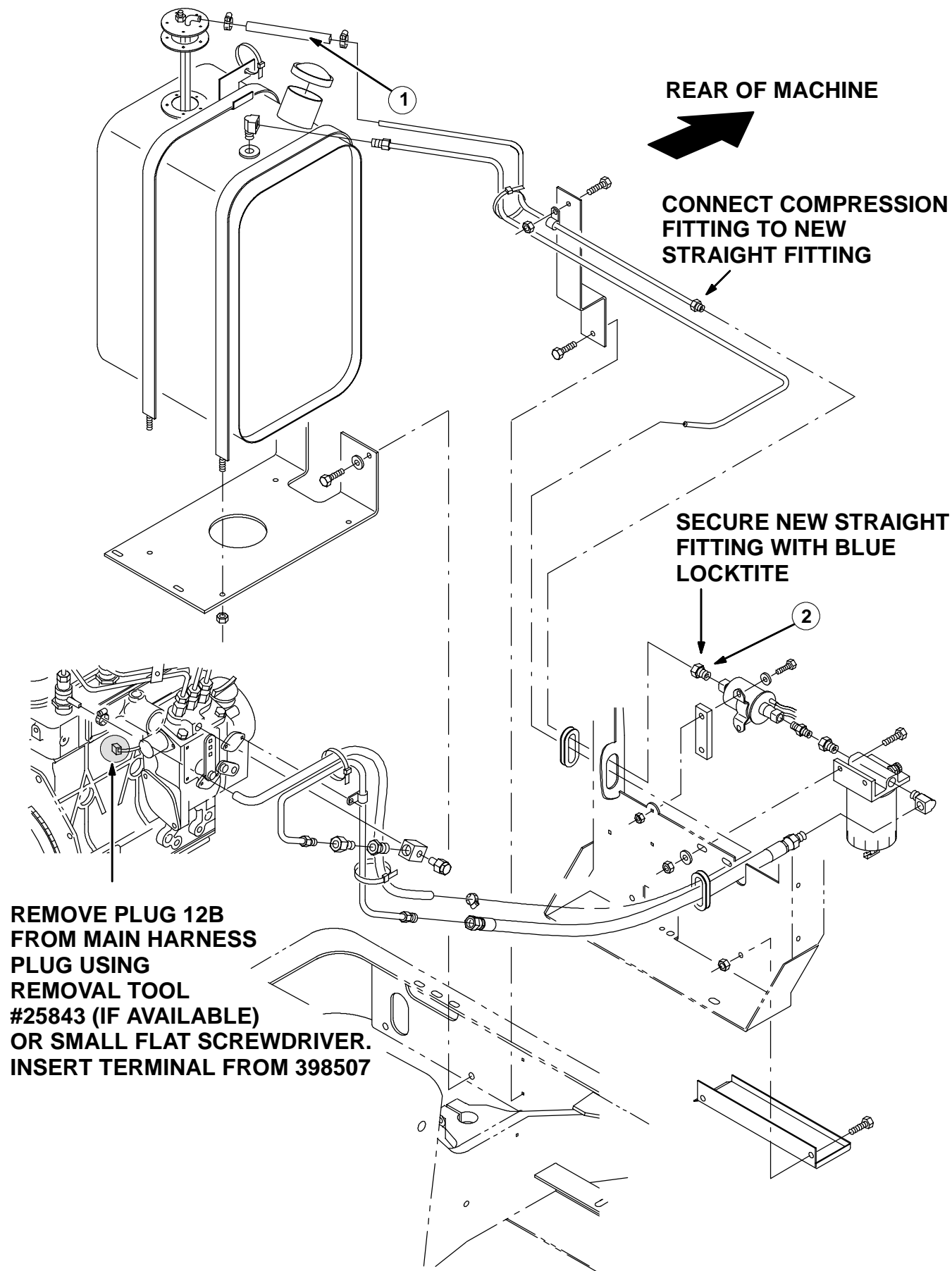
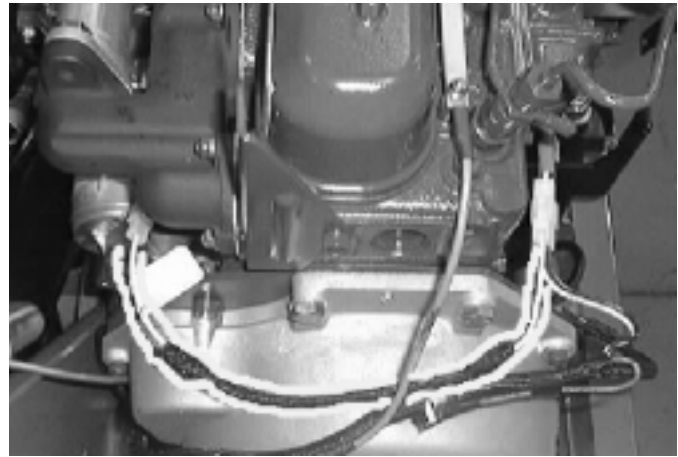

**FIG. 2 - NEW FUEL HOSE INSTALLATION**

8. Remove wire 12B from the main wire harness plug connection using removal tool #25843 (if available) or a small flat screwdriver. (Refer to FIG. 2, 3 and 4)
9. Insert the terminal from jumper wire 398507. (Refer to FIG. 3)
10. Route the jumper wire around the engine, and plug the other end of the jumper wire to the pigtail connection from the starter motor. (Refer to FIG. 3, 4 and 5)
11. Locate and remove the red diode from the main wire harness on the back side of the instrument panel. (Refer to FIG. 6)
12. Tape off the empty plug after removing the diode. (Refer to FIG. 6)
13. Close the rear machine cover.
14. Start the machine, and check the new fuel line connections for leaks.
15. Check the machine for proper operation.



**FIG. 3 - TAPING OFF 12B**



**FIG. 4 - JUMPER WIRE ROUTING**

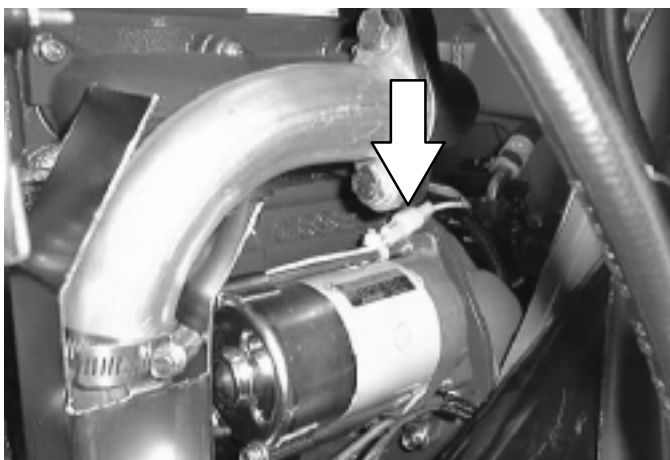

**FIG. 5 - PIGTAIL CONNECTION**

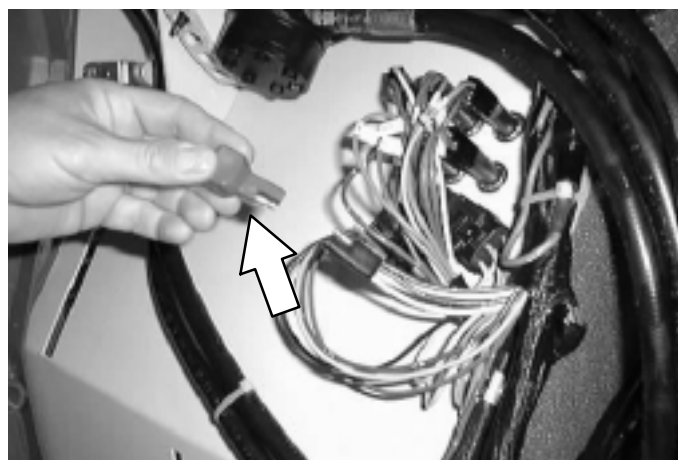

**FIG. 6 - DIODE REMOVAL**

**BILL OF MATERIALS FOR FUEL FILTER REMOVAL KIT 375062**

<b>Ref.</b>	<b>TENNANT Part No.</b>	<b>Description</b>	<b>Qty.</b>
1	81584	Hose, fuel line, 0.31 ID X 5.0 LG	1
2	40585	Ftg., brass, straight IF 05/PM 02	1
3	32676	Adhesive, 242 blue locktite, 0.5 ML	1
4	398507	Wire assy, jumper	1

TENNANT COMPANY  
P. O. Box 1452  
Minneapolis, MN 55440-1452