



INSTRUCTION BULLETIN

No. 340394
Machine: LitterHawk™
Published: 3-00/00
System: ELECTRICAL

NOTE: DO NOT DISCARD the Parts List from the Instruction Bulletin. Place the Parts List in the appropriate place in your machine manual for future reference. Retaining the Parts List will make it easier to reorder individual parts and will save you the cost of ordering an entire kit.

NOTE: Numbers in parenthesis () are reference numbers for parts listed in Bill of Materials.

Installation instructions for kit number 382958

SYNOPSIS / PROBLEM:

This kit contains the parts needed to replace the fuel shut-off harness on the model LitterHawk™ litter vacuum.

Please follow step-by-step instructions.

SPECIAL TOOLS / CONSIDERATIONS: NONE

(Estimated time to complete: 1 hour)

PREPARATION:

(Refer to FIG. 1, 2 and 3)

FOR SAFETY: Before leaving or servicing machine, stop on level surface and set parking brake. Then turn off machine and remove key.

1. Open the seat/rear cover on the machine.
2. Open the front cover assembly, and secure in place with the front cover support rod.
3. Remove and set aside the right and left hand cover plates. (Refer to FIG. 1)
4. Disconnect battery cables from machine.



WARNING: Always disconnect battery cables from machine before working on electrical components.

INSTALLATION:

(Refer to FIG. 1, 2 and 3)

1. Unplug the existing fuel shut-off harness from the fuel module solenoid. (Refer to FIG. 3)
2. Disconnect the fuel shut-off harness from the main harness, the key switch and battery ground. (Refer to FIG. 3)
3. Disconnect the fuel shut-off harness from the fuel shut-off solenoid. (Refer to FIG. 3)
4. Install the new fuel shut-off harness (1) in place of the old harness as shown in fig. 3.
(Run the trunk of the harness inside the upper right hand channel on the machine frame).
(Refer to FIG. 2)
5. Secure the harness with cable ties (2 and 3).

6. Connect the battery cables to the machine, and check the new fuel shut-off harness for proper operation. (Refer to FIG. 3)
7. Replace the right and left hand cover plates. (Refer to FIG. 1)
8. Close the seat/rear cover and the front cover assembly.

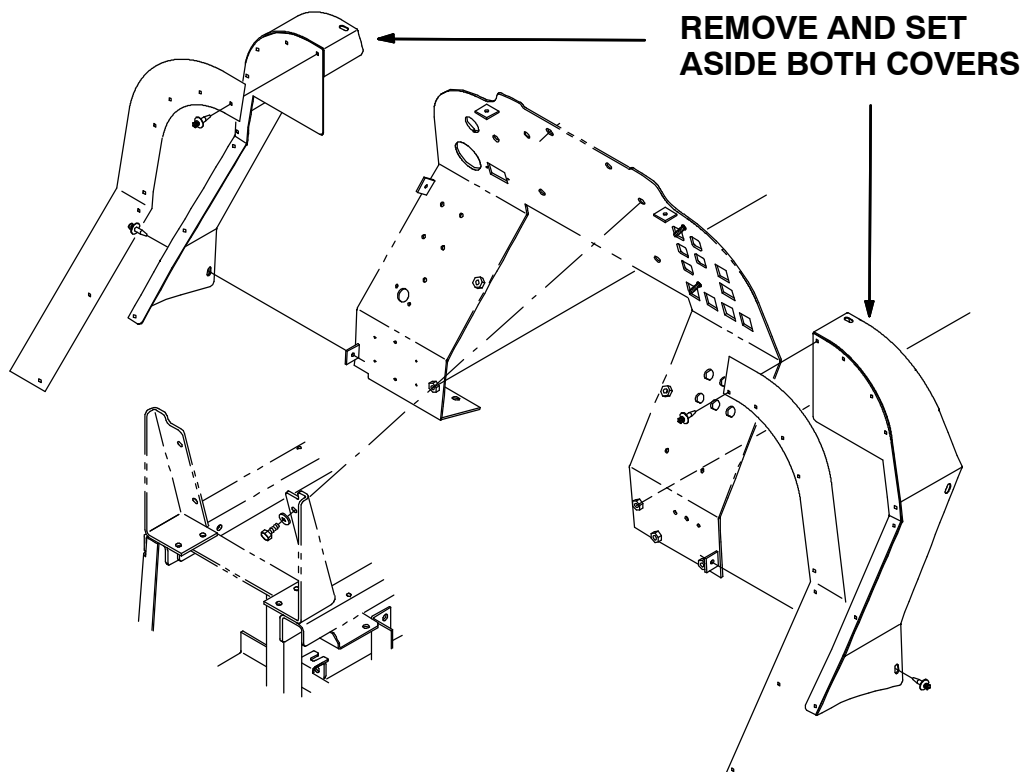

FIG. 1 - FRONT PANEL BREAKDOWN

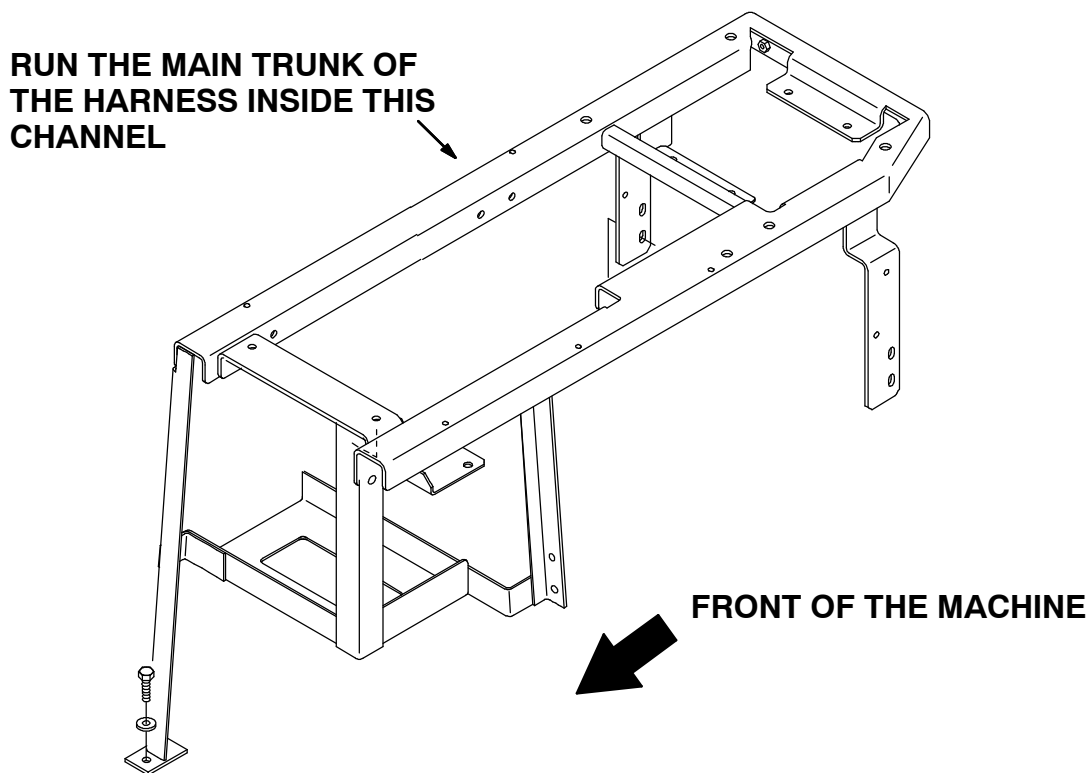

FIG. 2 - MACHINE FRAME



BILL OF MATERIALS FOR FUEL SHUT-OFF HARNESS KIT 382958

Ref.	TENNANT Part No.	Description	Qty.
1	382924	Harness, shut-off, fuel (Litter Hawk™)	1
2	49263	Tie, cable, 11.50L, 3.0D	4
3	44961	Tie, cable, 14.50L, 4.0D	4

TENNANT COMPANY
P. O. Box 1452
Minneapolis, MN 55440-1452