



INSTRUCTION BULLETIN

No. 340373
Machine: 7300/8300
Published: 3-00/00
System: ELECTRICAL

NOTE: DO NOT DISCARD the Parts List from the Instruction Bulletin. Place the Parts List in the appropriate place in your machine manual for future reference. Retaining the Parts List will make it easier to reorder individual parts and will save you the cost of ordering an entire kit.

NOTE: Numbers in parenthesis () are reference numbers for parts listed in Bill of Materials.

Installation instructions for kit number 387000

SYNOPSIS / PROBLEM:

This kit contains the parts needed to install a fork lift battery cradle on the model 7300 scrubber or 8300 sweeper/scrubber.

Please follow step-by-step instructions.

SPECIAL TOOLS / CONSIDERATIONS: LIFT OR CHAIN HOIST

(Estimated time to complete: 1 hour)

PREPARATION:

(Refer to FIG. 1)

FOR SAFETY: Before leaving or servicing machine, stop on level surface and set parking brake. Then turn off machine and remove key.

1. Open the top battery compartment cover, and secure in position with the cover support rod.
2. Open the rear battery compartment door.
3. Disconnect battery pack from the machine.



WARNING: Always disconnect battery cables from machine before working on electrical components.

INSTALLATION:

(Refer to FIG. 1)

1. Remove battery pack from battery compartment with chain hoist or lift.

NOTE: When servicing machine, use hoist or lift that will support the weight of the battery pack.

2. Install the new fork lift battery cradle (1) in the rear of the machine with hex screws (2) and nuts (3). (Refer to FIG. 1)
3. Adjust the gap between the fork lift forks to match the gap needed by the new battery cradle.
4. Replace the battery pack in the rear of the machine.
5. Connect the battery pack to the machine. Close the rear door and top compartment cover.

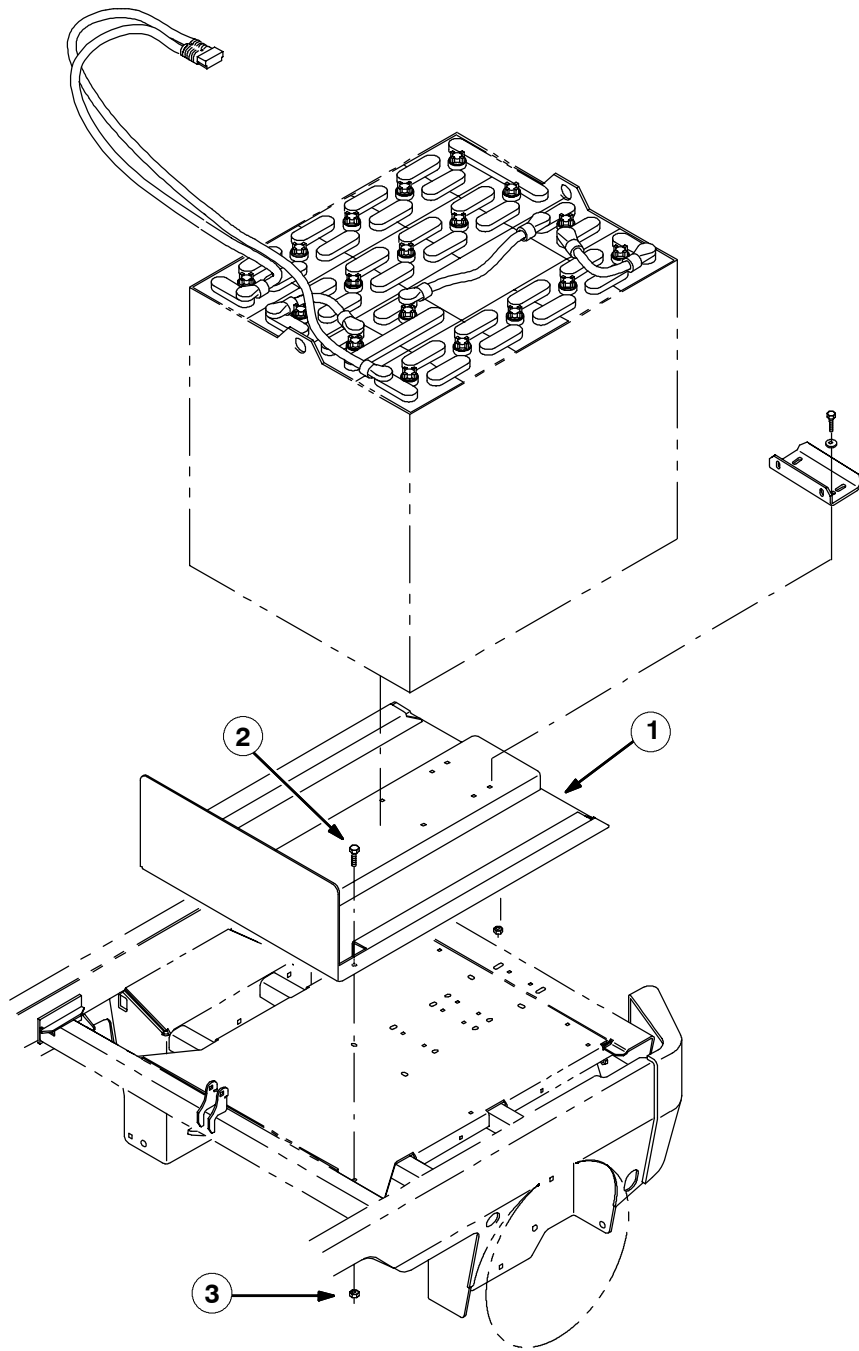

FIG. 1 - FORK LIFT BATTERY KIT INSTALLATION

BILL OF MATERIALS FOR FORK LIFT BATTERY KIT 387000

Ref.	TENNANT Part No.	Description	Qty.
1	386632	Cradle Wldt, Battery	1
2	09740	Screw, Hex, M08-1.25 X 20, SS	4
3	08713	Nut, Hex, Lock, M08-1.25, NL, SS	4

TENNANT COMPANY
P. O. Box 1452
Minneapolis, MN 55440-1452