



INSTRUCTION BULLETIN

No. 340361
Machine: 8300
Published: 12-2009
Rev: 01

NOTE: DO NOT DISCARD the Parts List from the Instruction Bulletin. Place the Parts List in the appropriate place in the machine manual for future reference. Retaining the Parts List will make it easier to reorder individual parts and will save the cost of ordering an entire kit.

NOTE: Numbers in parenthesis () are reference numbers for parts listed in Bill of Materials.

Installation instructions for kit number 386939 / 9006939

SYNOPSIS:

This kit contains the parts needed to install a 36V (1000AH) wet battery kit on the 8300 machine.
Please follow step-by-step instructions.

SPECIAL TOOLS / CONSIDERATIONS: NONE

(Estimated time to complete: 1 hour)

PREPARATION:

FOR SAFETY: Before leaving or servicing machine, stop on level surface, set parking brake, turn off machine, and remove key.

1. Open the top battery compartment cover, and secure in position with the cover support rod.
2. Open the rear battery compartment door.
3. Disconnect battery pack from machine.



WARNING: Always disconnect battery cables from machine before working on electrical components.

INSTALLATION:

(Refer to FIG. 1)

1. Remove the rear battery spacer from the rear of the compartment.
2. Remove the existing battery pack from battery compartment with chain hoist or lift.

NOTE: When servicing machine, use hoist or lift that will support the weight of the battery pack.

3. Install the right (2) and left (3) hand battery spacers on the sides of the battery compartment with hex screws (4), washers (5) and hex nuts (6). (Refer to FIG. 1)
4. Mount the rear battery spacer (4) in the rear of the battery compartment with hex screws (4), washers (5) and hex nuts (6). (Refer to FIG. 1)
5. Carefully install the new battery pack (1) into the battery compartment.
6. Connect the battery connector to the machine connector. Close the rear battery compartment door and the top battery compartment cover.
7. Reinstall the rear battery spacer into the rear of the battery compartment.

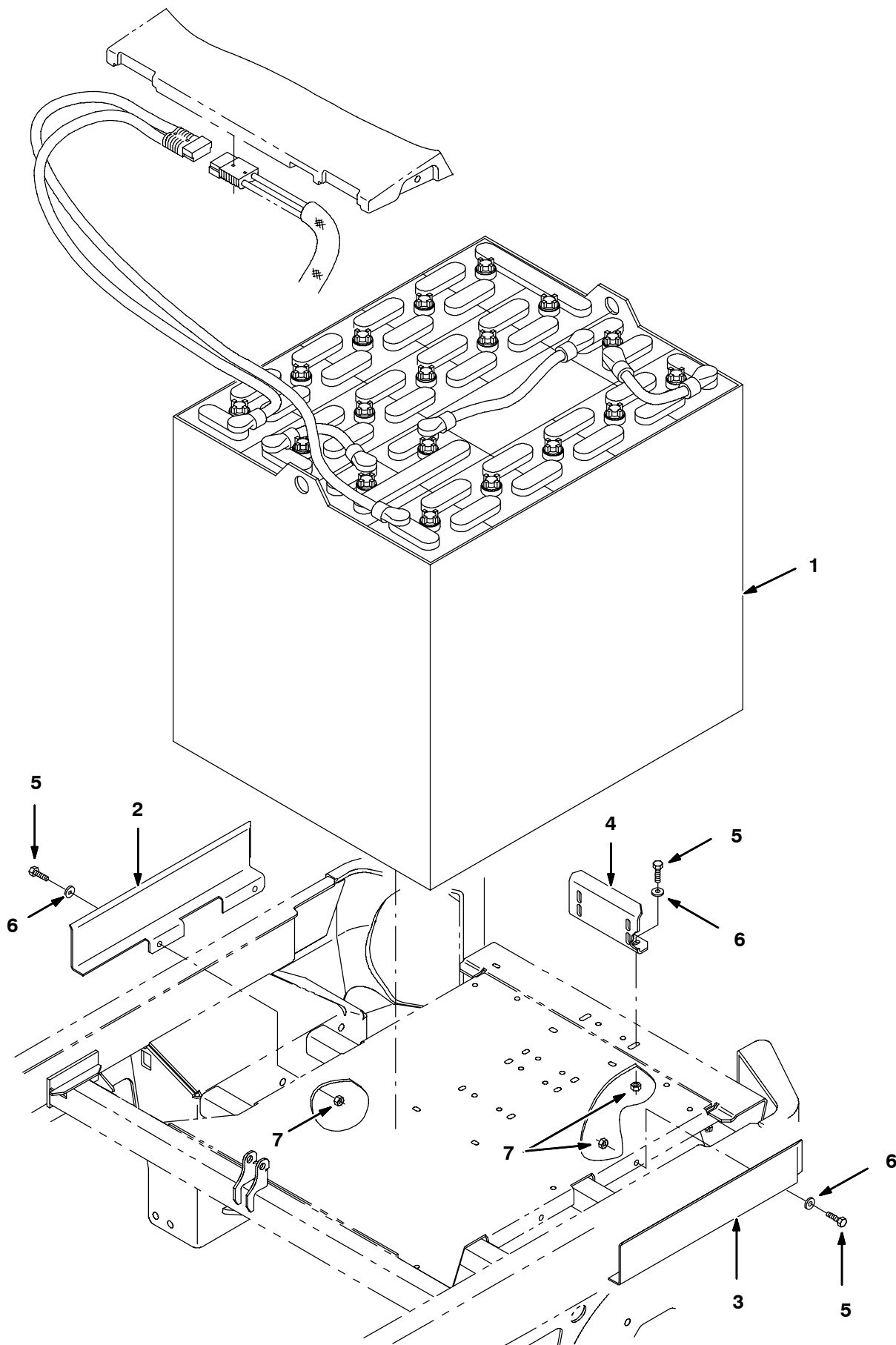

FIG. 1

BILL OF MATERIALS FOR 36V, 1000AH, WET BATTERY KIT 386939

Ref.	TENNANT Part No.	Description	Qty.
1	386337	Battery, 36V (1000AH), Wet	1
2	386677	Spacer, Battery, RH	1
3	386678	Spacer, Battery, LH	1
4	386575	Spacer, Battery, Rear	1
5	09740	Screw, Hex, M08-1.25 X 20, SS	6
6	01685	Washer, Flat, .31, SS	6
7	08713	Nut, Hex, Lock, M08-1.25, NL,SS	6

BILL OF MATERIALS FOR 36V, 1000AH, WET BATTERY KIT 9006939

Ref.	TENNANT Part No.	Description	Qty.
1	386337	Battery, 36V (1000AH), Wet	1
2	1056791	Spacer, Battery, RH, Iron Gray	1
3	1056790	Spacer, Battery, LH, Iron Gray	1
4	1056878	Spacer, Battery, Rear, Iron Gray	1
5	09740	Screw, Hex, M08-1.25 X 20, SS	6
6	01685	Washer, Flat, .31, SS	6
7	08713	Nut, Hex, Lock, M08-1.25, NL,SS	6

TENNANT COMPANY
P. O. Box 1452
Minneapolis, MN 55440-1452