



INSTRUCTION BULLETIN

No. 340283
Machine: 830-II
Published: 3-99/00
System: SWEEPING

NOTE: DO NOT DISCARD the Parts List from the Instruction Bulletin. Place the Parts List in the appropriate place in your machine manual for future reference. Retaining the Parts List will make it easier to reorder individual parts and will save you the cost of ordering an entire kit.

NOTE: Numbers in parenthesis () are reference numbers for parts listed in Bill of Materials.

Installation instructions for kit number 765399

SYNOPSIS / PROBLEM:

This kit contains the parts needed to replace main brush door mount brackets with a improved version on the model 830-II sweeper.

Please follow step-by-step instructions.

SPECIAL TOOLS / CONSIDERATIONS: None

(Estimated time to complete: 1 hour)

INSTALLATION:

(Refer to FIG. 1, 2, and 3)

FOR SAFETY: Before leaving or servicing machine, stop on level surface and set parking brake. Then turn off machine and remove key.

1. Remove the left and right brush doors.
2. Remove the rear hardware on the dry dust control skirt if the machine is equipped with dry dust control.
3. Check to see if the upper part of the bracket is made out of 5/16 inch material (parts of bracket that bolts to frame). If upper part is made out of thinner gage material, remove and discard. Install the new bracket (4 LH and 5 RH).
4. **IF MACHINE IS EQUIPPED WITH DRY DUST CONTROL: Check the size of the hardware holding the dry dust control skirt and the front of the brush doors to the frame brackets. If the hardware is M8- -this kit does not need to be installed. If the hardware is M6- -go to the next step.**
5. Remove the screws holding the existing brush door brackets to the machine frame. Remove and discard the brackets.
6. Install the new U-nuts (2) onto the brackets (4 LH and 5 RH).
7. Install the new brackets (4 LH and 5 RH).
8. Use the Belleville washers (3) and fender washers (1) to reinstall the brush doors and dry dust control skirt if the machine is equipped with dry dust control.
9. Reinstall the brush doors.

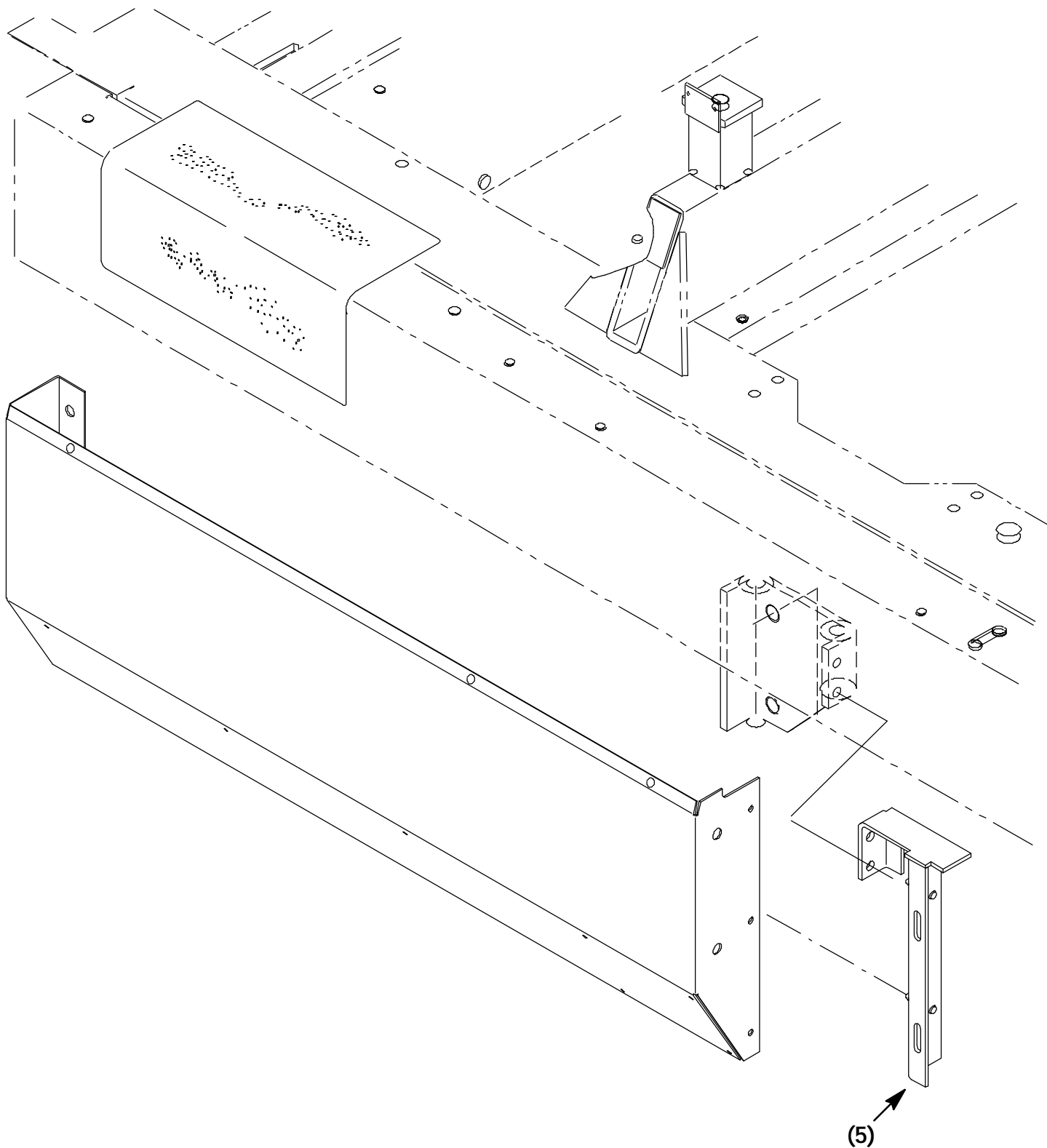

FIG. 1 - Right Hand Brush Door

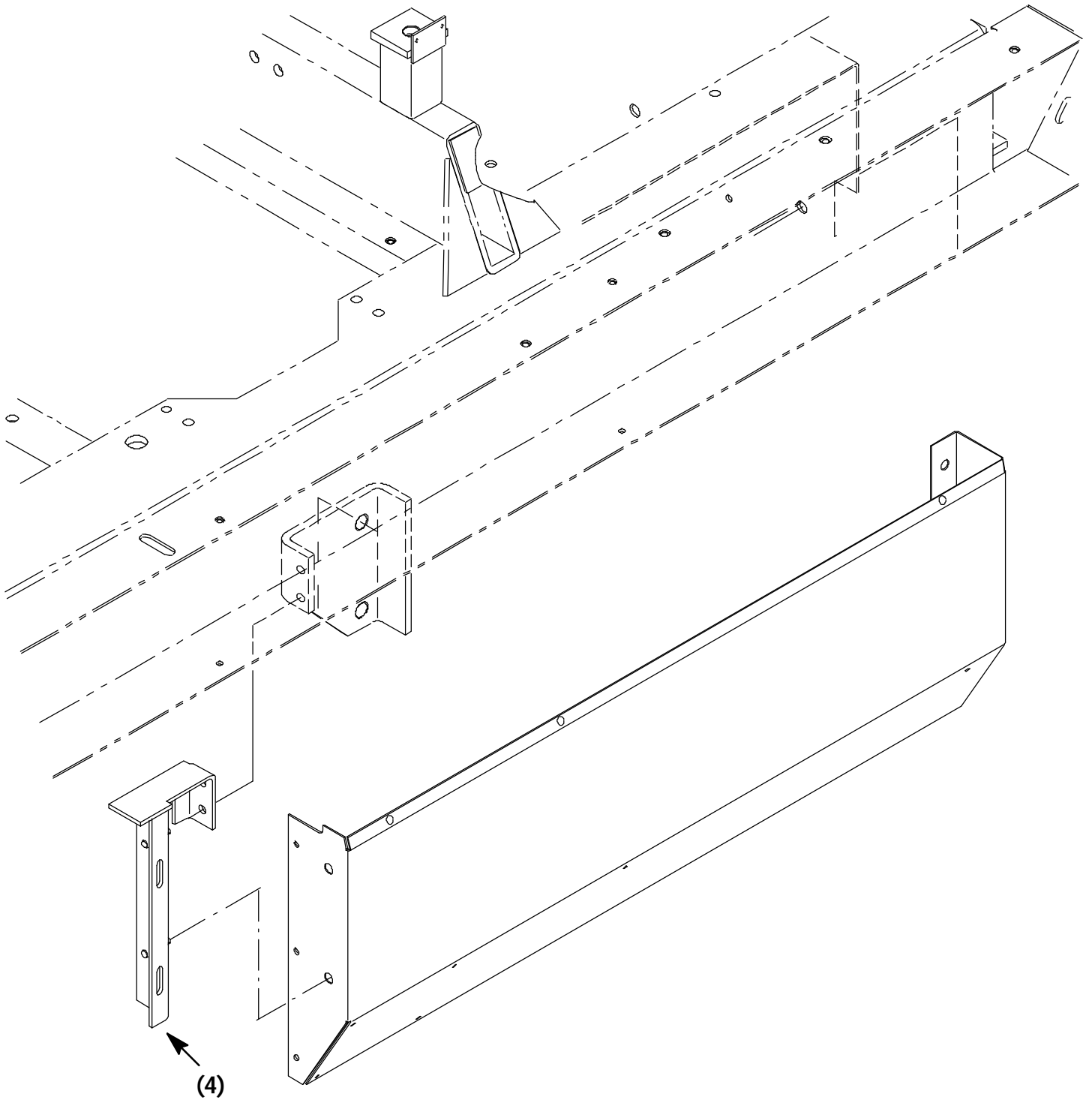

FIG. 2 - Left Hand Brush Door

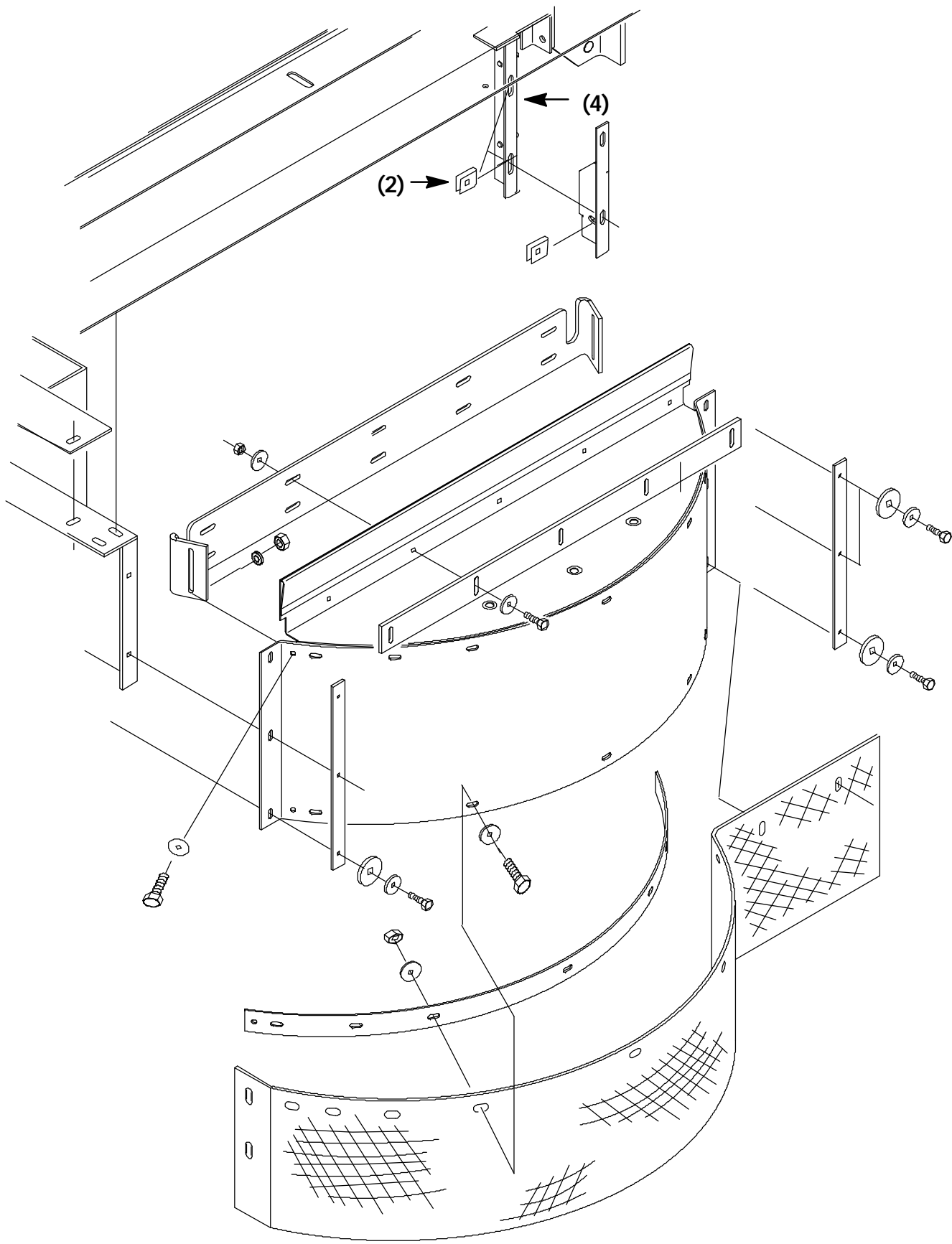

FIG. 3 - Left Side Dry Dust control assembly

BILL OF MATERIALS FOR MAIN BRUSH DOOR SUPPORT KIT 765399

Ref.	TENNANT Part No.	Description	Qty.
1	39890	M8 fender washer (2 extra)	6
2	58595	M8 U-nut (2 extra)	6
3	763041	M8 Belleville washer(2 extra)	6
4	765335	Brush door support weldment, LH	1
5	765336	Brush door support weldment, RH	1

TENNANT COMPANY
P. O. Box 1452
Minneapolis, MN 55440-1452