



## INSTRUCTION BULLETIN

No. 340216  
Machine: 8200, 8210  
Published: 11-98/00  
System: OPTIONS

**NOTE: DO NOT DISCARD the Parts List from the Instruction Bulletin. Place the Parts List in the appropriate place in your machine manual for future reference. Retaining the Parts List will make it easier to reorder individual parts and will save you the cost of ordering an entire kit.**

*NOTE: Numbers in parenthesis ( ) are reference numbers for parts listed in Bill of Materials.*

Installation instructions for kit number 365366

### **SYNOPSIS / PROBLEM:**

This kit contains the parts needed to replace the engine cover latch on the model 8200 sweeper/scrubbers with ID numbers lower than 6055 and 8210 sweeper scrubbers with ID numbers lower than 1061.

Please follow step-by-step instructions.

### **SPECIAL TOOLS / CONSIDERATIONS: Small file, small hand grinder, sand paper**

(Estimated time to complete: 1 hour)

### **PREPARATION:**

(Refer to FIG. 1 and 2)

**FOR SAFETY: Before leaving or servicing machine, stop on level surface and set parking brake. Then turn off machine and remove key.**

### **INSTALLATION:**

(Refer to FIG. 1 and 2)

1. Open engine cover.
2. Remove old engine cover latch.
3. Remove .320 inch of material from the top of the engine latch opening with a file or small hand detail grinder.
4. Sand the opened area smooth.
5. Install new engine cover latch (1).

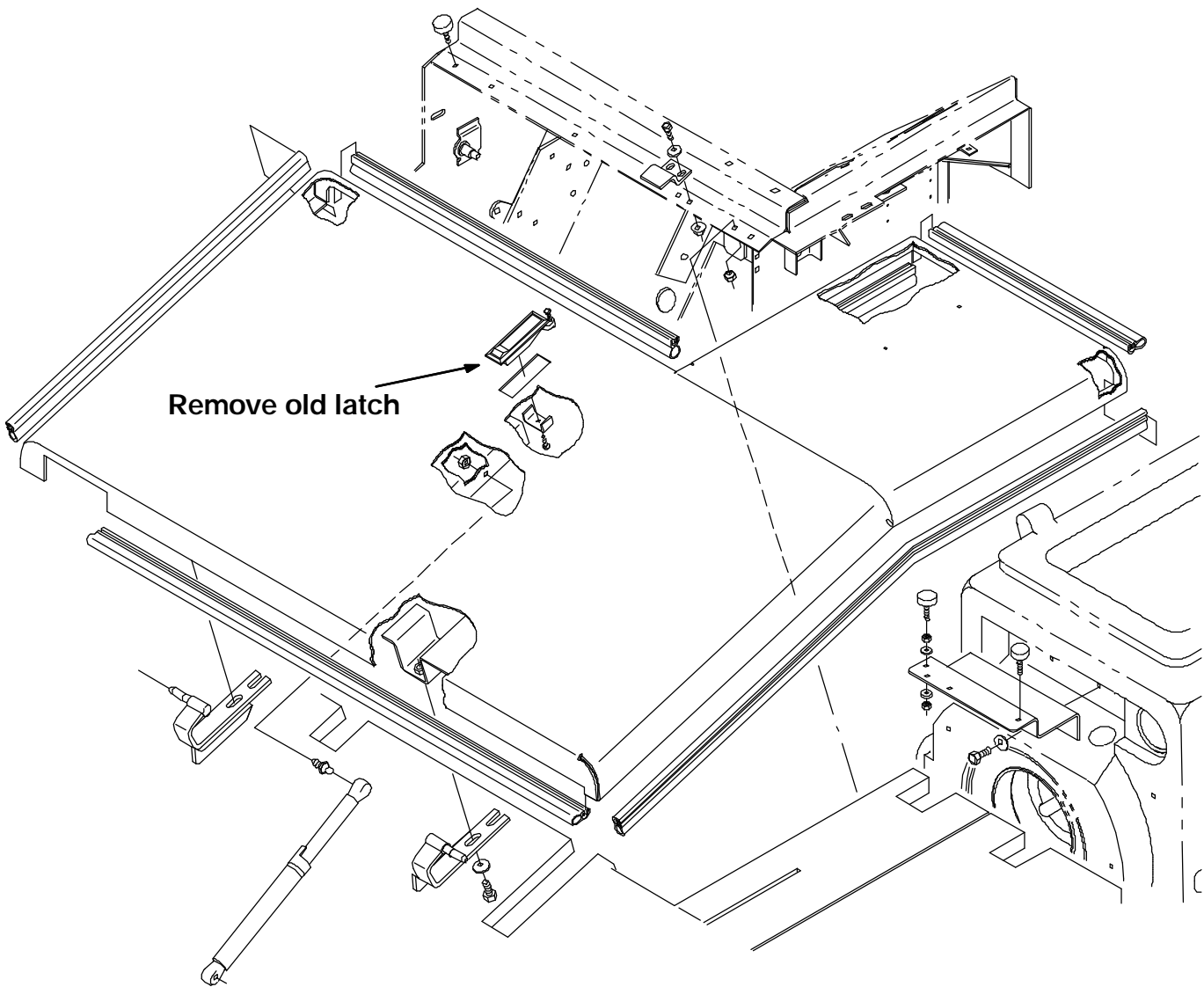

**FIG. 1 - Engine Cover Latch Removal**

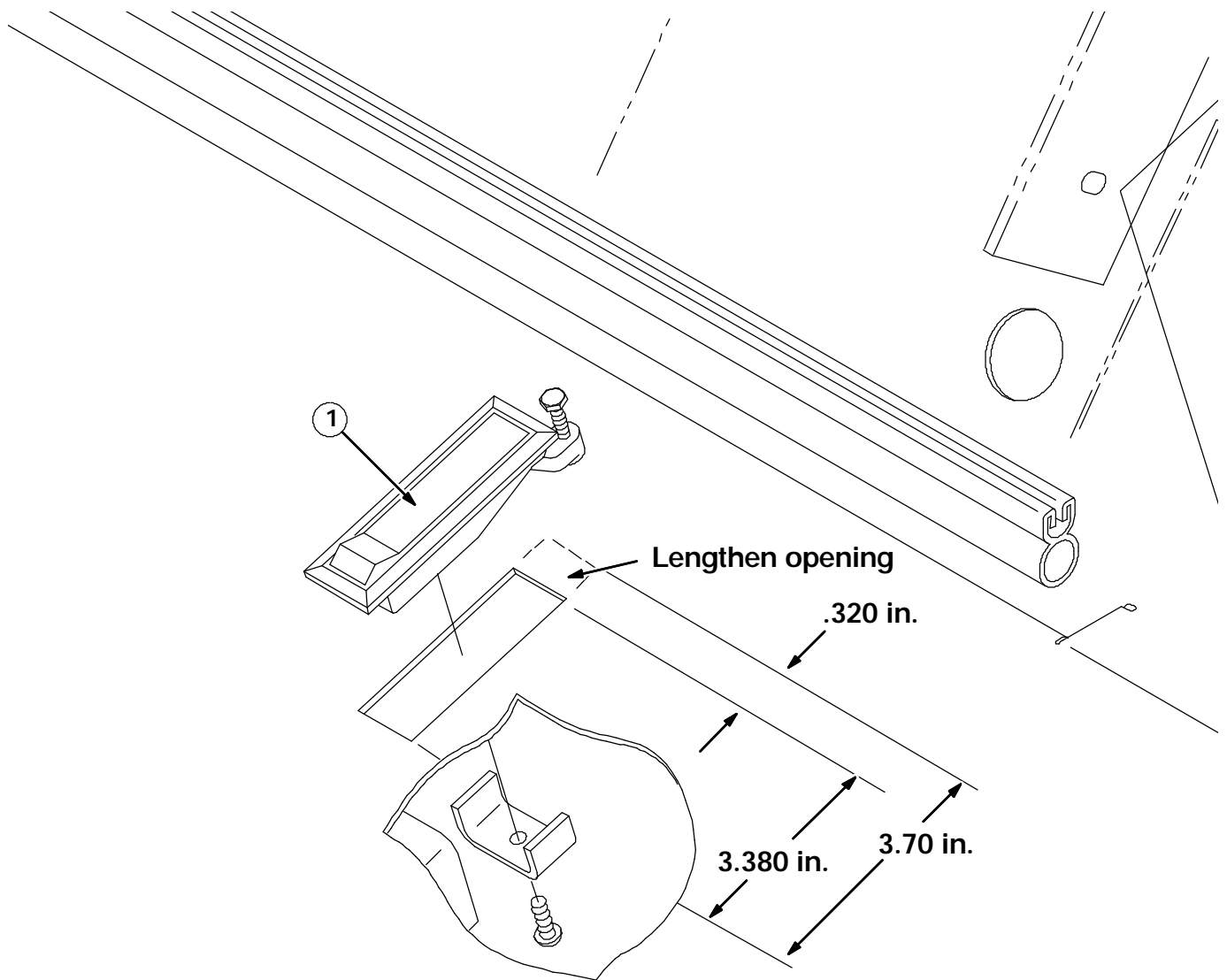

**FIG. 2 - REPLACEMENT LATCH INSTALLATION**

**BILL OF MATERIALS FOR ENGINE COVER REPLACEMENT LATCH KIT 365366**

Ref.	TENNANT Part No.	Description	Qty.
1	365214	Latch, lever	1

TENNANT COMPANY  
P. O. Box 1452  
Minneapolis, MN 55440-1452