



INSTRUCTION BULLETIN

No. 340191
Machine: 8210
Published: 8-98/00
System: ELECTRICAL

NOTE: DO NOT DISCARD the Parts List from the Instruction Bulletin. Place the Parts List in the appropriate place in your machine manual for future reference. Retaining the Parts List will make it easier to reorder individual parts and will save you the cost of ordering an entire kit.

NOTE: Numbers in parenthesis () are reference numbers for parts listed in Bill of Materials.

Installation instructions for kit number 370170

SYNOPSIS / PROBLEM:

This kit contains the parts needed to replace the touch panel on the model 8210 sweeper/scrubber.

Please follow step-by-step instructions.

SPECIAL TOOLS / CONSIDERATIONS: NONE

(Estimated time to complete: 1 hour)

PREPARATION:

(Refer to FIG. 1)

FOR SAFETY: Before leaving or servicing machine, stop on level surface and set parking brake. Then turn off machine and remove key.

1. Open engine cover.
2. Disconnect battery cables from machine.



WARNING: Always disconnect battery cables from machine before working on electrical components.

3. Lower the steering wheel.
4. Locate the back side of the instrument panel assembly.

INSTALLATION:

(Refer to FIG. 1)

1. Remove and set aside all four 7mm mounting bracket nuts and both mounting brackets, so instrument panel assembly may be removed from the front. (Refer to FIG. 1)
2. Gently lift instrument panel assembly out far enough to access rear electrical connections.
3. Remove and set aside the 1/4 in securing screw from each electrical plug, on the back side of the touch panel assembly. Unplug connections.
4. Place instrument panel assembly on a clean work surface.
5. Remove and set aside the last four securing nuts on bottom of assembly. (Refer to FIG. 1)
6. Unwrap the first two folds of the wrist strap, and wrap the exposed adhesive side firmly around your wrist.

7. Unroll the rest of the band and peel the liner from the copper foil at the opposite end. Attach the copper foil to a convenient and exposed electrical ground.
8. Separate touch panel from Instrument box, according to diagram. (Refer to FIG. 1)
9. Unplug the ribbon cable from the touch panel. (Refer to FIG. 1)
10. Plug the ribbon into the new touch panel. (Refer to FIG. 1)
11. Reassemble instrument panel assembly as shown in diagram. *Secure with hardware and blue locktite where indicated.* (Refer to FIG. 1)
12. Connect both electrical plugs and secure with 1/4 in securing screws.
13. Install instrument panel assembly back in dashboard. Align mounting brackets to hold the instrument panel in place, and tighten 7mm mounting bracket nuts.
14. Connect the battery cables.
15. Close the engine cover.
16. Start machine and check that the instrument panel operates properly.

BILL OF MATERIALS FOR TOUCH PANEL REPLACEMENT KIT 370170

Ref.	TENNANT Part No.	Description	Qty.
1	364306	Panel, touch, 8210	1
2	27964	Strap, grounding	1

TENNANT COMPANY
P. O. Box 1452
Minneapolis, MN 55440-1452

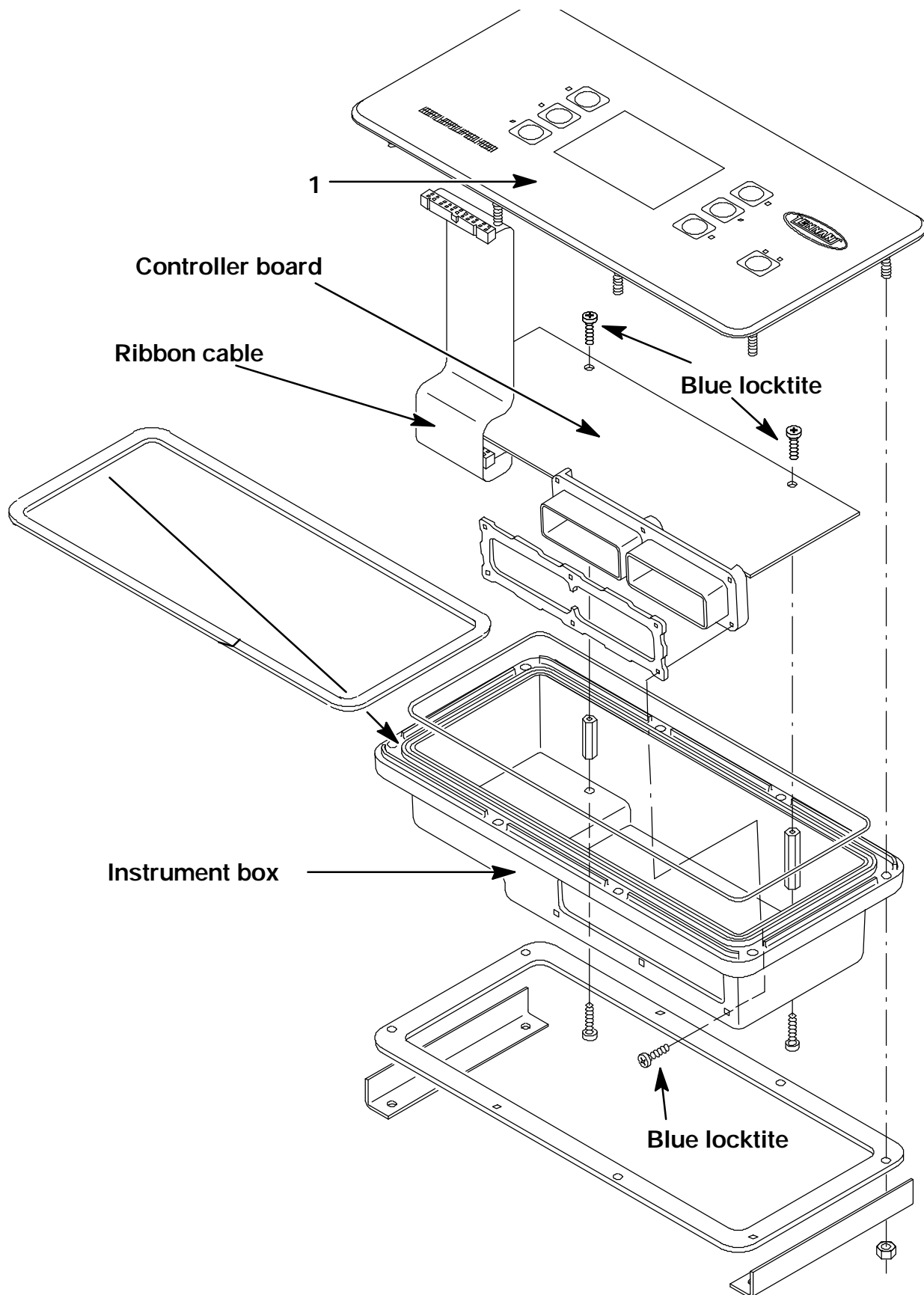

FIG. 1 - Instrument Panel Assembly Breakdown