



INSTRUCTION BULLETIN

No. 340175
Machine: 8200, 8210LPG
Published: 12-2004
Rev: 01

NOTE: DO NOT DISCARD the Parts List from the Instruction Bulletin. Place the Parts List in the appropriate place in the machine manual for future reference. Retaining the Parts List will make it easier to reorder individual parts and will save the cost of ordering an entire kit.

NOTE: Numbers in parenthesis () are reference numbers for parts listed in Bill of Materials.

Installation instructions for kit number 365253

SYNOPSIS / PROBLEM:

This kit contains parts needed to install a vertical LPG tank kit on the 8200 and 8210 LPG machines.
Please follow step-by-step instructions.

SPECIAL TOOLS / CONSIDERATIONS: RIVET GUN

(Estimated time to complete: 2 hours)

PREPARATION:

1. Park the machine on a clean level surface.
2. Turn off the machine, set the parking brake, and remove the key.

FOR SAFETY: Before leaving or servicing machine, stop on level surface, turn off machine, set parking brake, and remove key.

3. Raise the engine cover.
4. Open the side engine door.
5. Disconnect the battery cables from the machine.



WARNING: Always disconnect the battery cables from the machine before working on electrical components.

INSTALLATION:

1. Disconnect and remove LP gas tank from LPG tray. Set the tank aside. (Refer to FIG. 3)
2. Remove vaporizer from LPG tray. Set vaporizer and mounting hardware aside. (Refer to FIG. 3)
3. Disconnect old LPG tray from tank channel. Set the mounting hardware aside. (Refer to FIG. 3)
4. Remove and discard the old LPG tray. (Refer to FIG. 3)
5. Remove the old hydraulic reservoir holding straps, base channel, and thermal insulation. (Refer to FIG. 4)

6. Install the new insulation (1), base (2) and tank shield (3) under the new straps (4). Secure the straps with two flat washers (5) and two hex nuts (6). (Refer to FIG. 1, 2, 5, and 6)

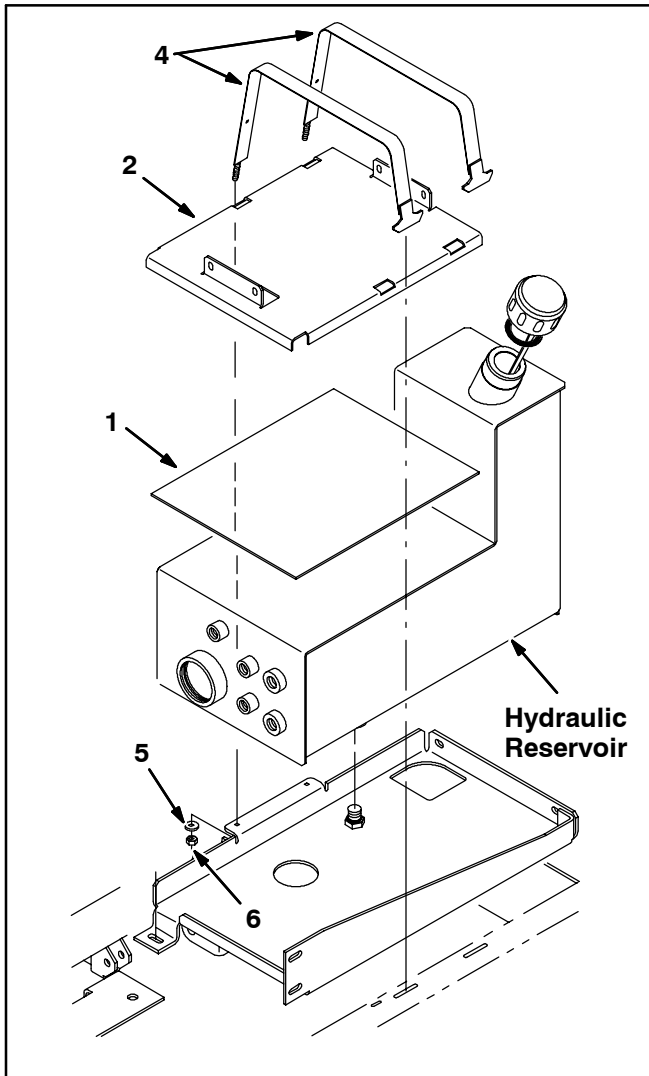

FIG. 1

7. Use rivets (9) to mount LP data plate (8) to the new tank channel weldment (7).

8. Install the acoustic insulation (15) and (16) onto the new tank channel weldment (7). (Refer to FIG. 2)

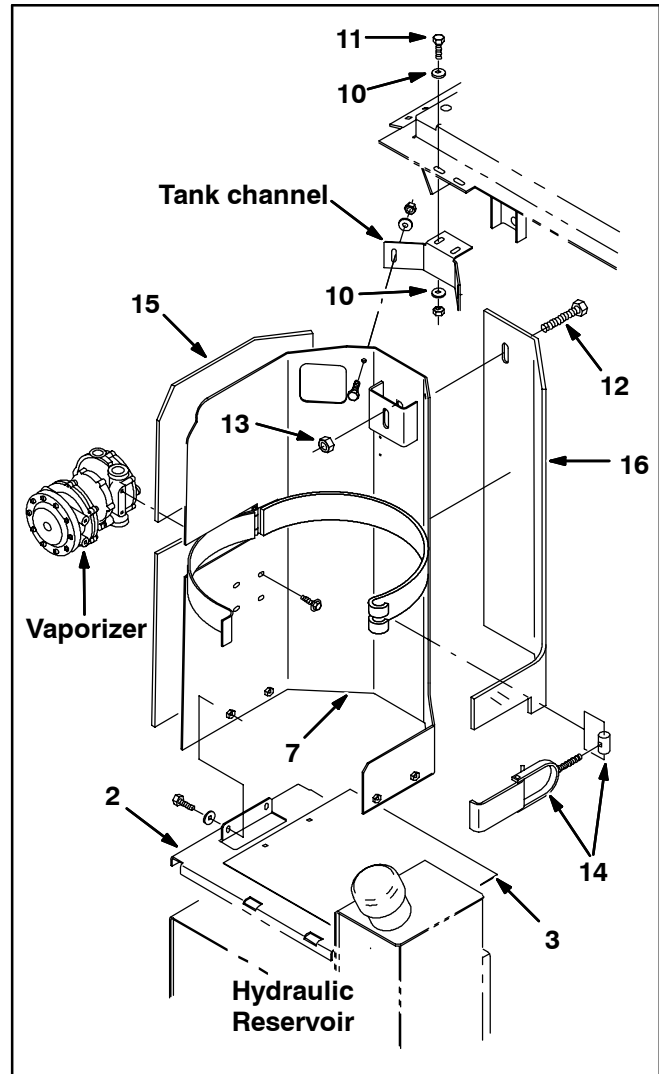

FIG. 2

9. Mount the new tank channel weldment (7) to the tank channel and the base (2) with mounting hardware. (Refer to FIG. 2 and 6)
10. Connect the vaporizer to the new tank channel weldment (7) with set aside hardware. (Refer to FIG. 2)
11. Install the tank latch assembly (14) onto the tank channel weldment (7). (Refer to FIG. 2)
12. Place the LPG tank into the tank channel weldment (7) and secure tank into place with the tank latch assembly (14) and a hex screw (12) and hex nut (13). (Refer to FIG. 2)

13. Reconnect the LPG tank to the LP lines and clamp the tank in the LPG tray (7). (Refer to FIG.3)

14. Reconnect the battery cables to the machine.

15. Open the LP tank flow.

16. Start the machine, and check tank and vaporizer group for proper operation.

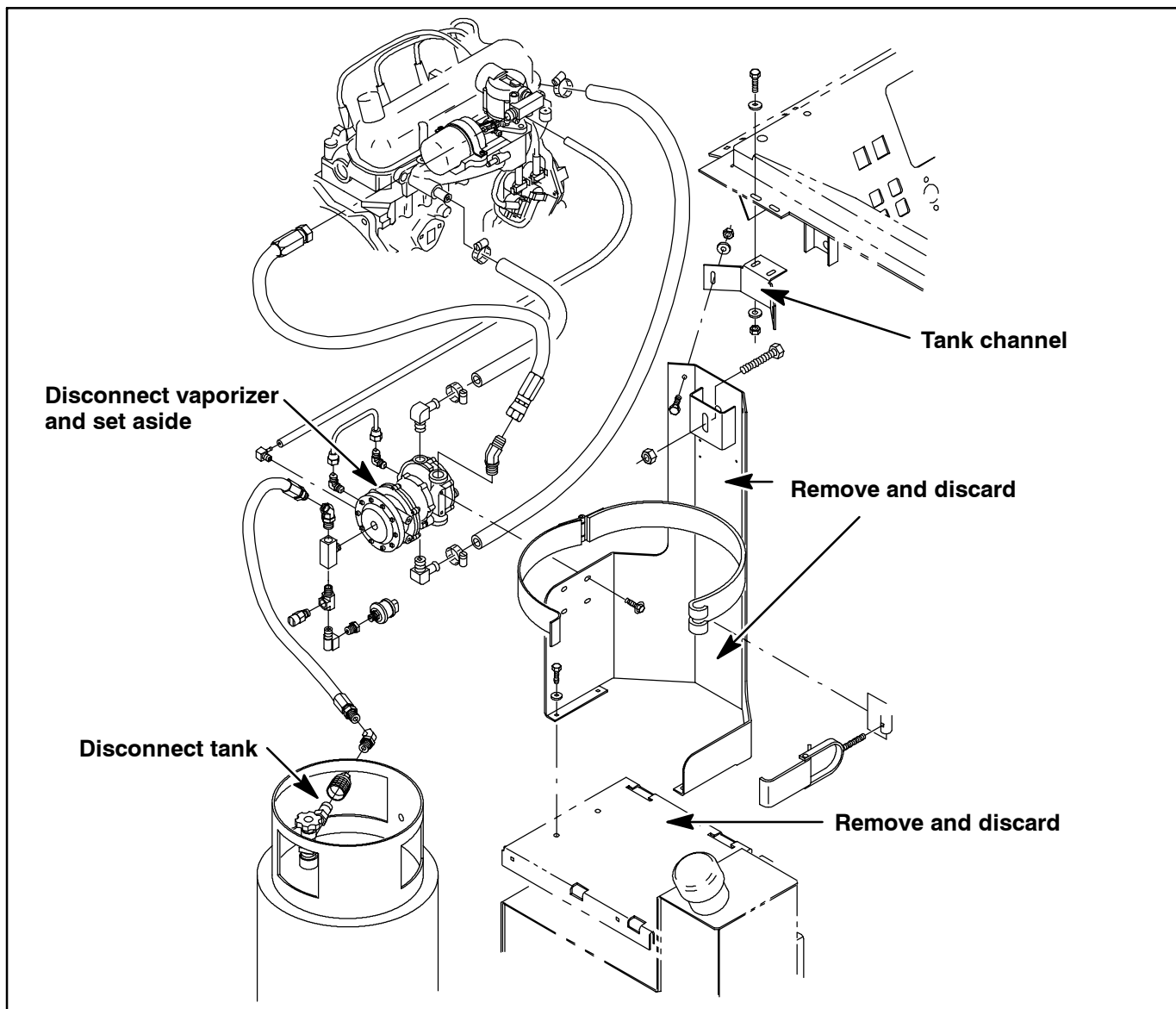

FIG. 3-Fuel Tank and Vaporizer Group, LPG

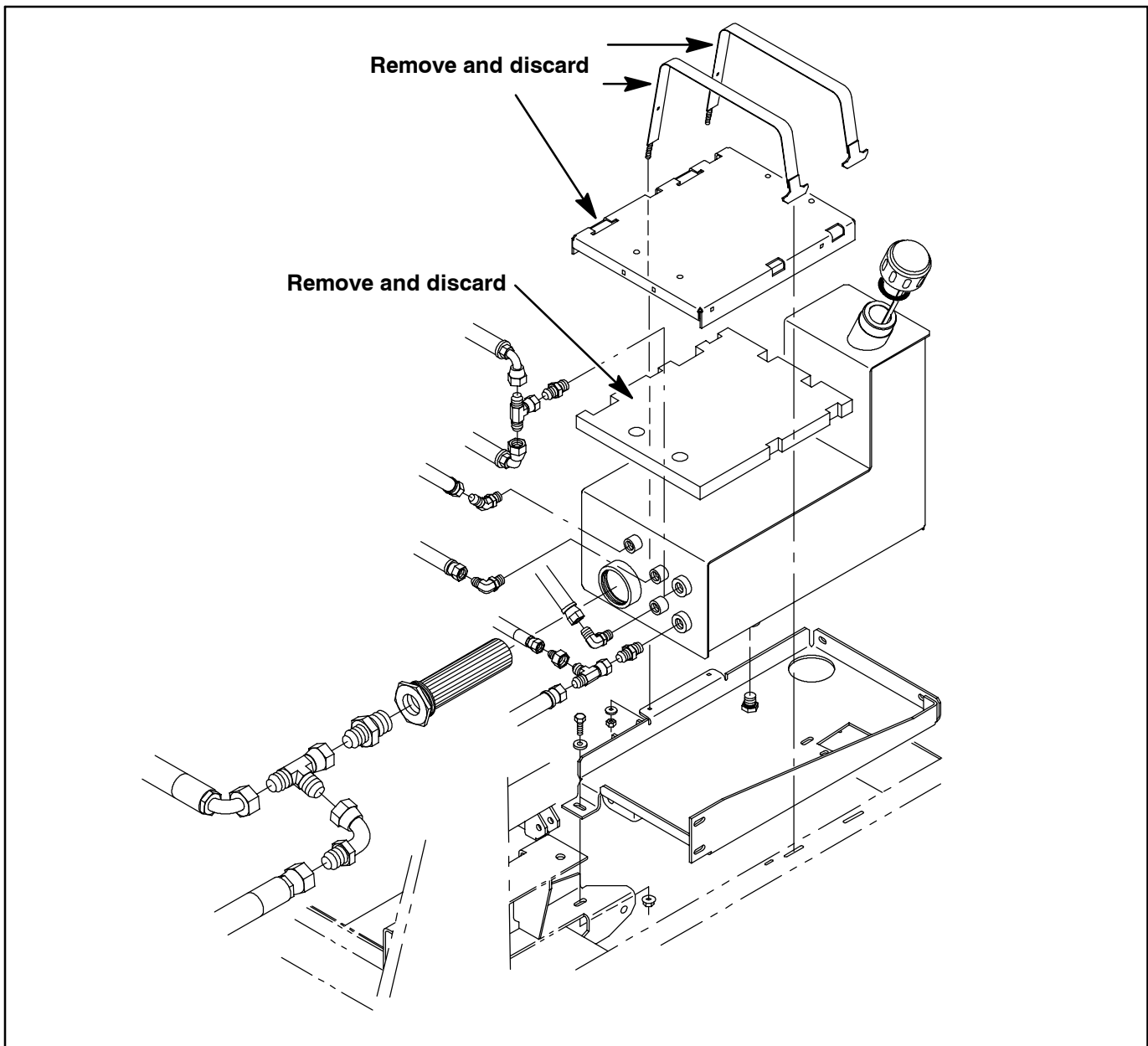

FIG. 4-Hydraulic Reservoir Group

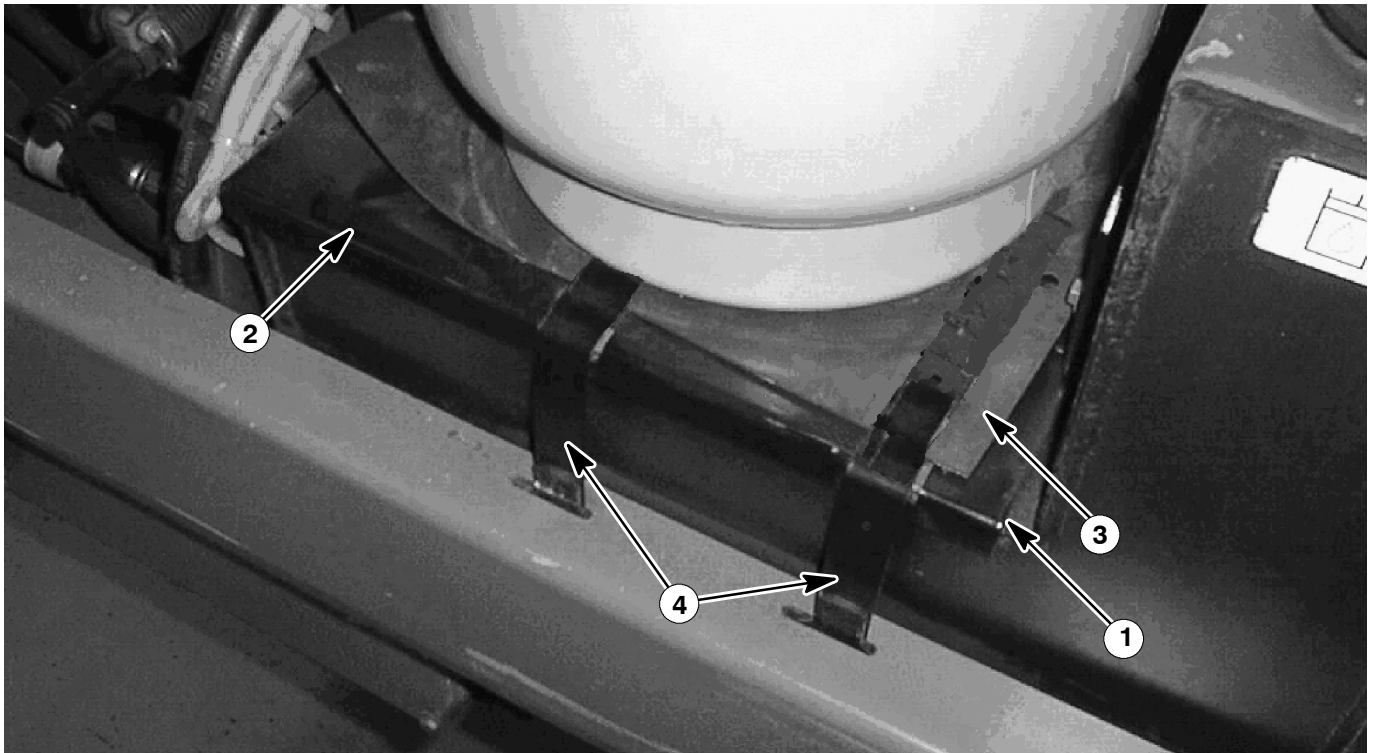

FIG. 5-New Base Installation



FIG. 6-New Tray Weldment Installation

Bill of Materials for Mtg Kit, Tank, Vertical, LPG, CI [8200]-365253

| Ref. | TENNANT Part No. | Description | Qty. |
|-------------|-----------------------------|--|-------------|
| 1 | 365223 | Insulation, Thermal, 0.1, 14.4 X 11.4 | 1 |
| 2 | 365220 | Base | 1 |
| 3 | 365169 | Shield, Tank | 1 |
| 4 | 365225 | Strap | 2 |
| 5 | 32490 | Washer, Flat, 0.25 Std | 2 |
| 6 | 32981 | Nut, Hex, Lock, .25-20, NI | 2 |
| 7 | 365291 | Tray Wldt | 1 |
| 8 | 58067 | Plate, Data, LPG 33 | 1 |
| 9 | 01335 | Rivet, Blind .125D X 0.44 X .25D, Alm | 4 |
| 10 | 32490 | Washer, Flat, 0.25 Std | 4 |
| 11 | 06943 | Screw, Hex, M6 X 1.0 X 20, 8.8 | 4 |
| 12 | 06416 | Screw, Hex, M12 X 1.75 X 50, FI | 1 |
| 13 | 08711 | Nut, Hex, Lock, M12 X 1.75, NI | 1 |
| 14 | 53400-1 | Latch Assy, MTG, Tank, LPG, w/Nut | 1 |
| 15 | 365327 | Insulation, Acstc, 0.3, 25.9 X 14.7 NTCH | 1 |
| 16 | 365328 | Insulation, Acstc, 0.3, 24.7 X 18.7 NTCH | 1 |

TENNANT COMPANY
P. O. Box 1452
Minneapolis, MN 55440-1452