



INSTRUCTION BULLETIN

No. 340164
Machine: 6100E
Published: 1-99/00
System: OPTIONS

NOTE: DO NOT DISCARD the Parts List from the Instruction Bulletin. Place the Parts List in the appropriate place in your machine manual for future reference. Retaining the Parts List will make it easier to reorder individual parts and will save you the cost of ordering an entire kit.

NOTE: Numbers in parenthesis () are reference numbers for parts listed in Bill of Materials.

Installation instructions for kit number 83188

SYNOPSIS / PROBLEM:

This kit contains the parts needed to install a heavy duty controller on the model 6100 sweeper.

Please follow step-by-step instructions.

SPECIAL TOOLS / CONSIDERATIONS: NONE

(Estimated time to complete: 1 hour)

PREPARATION:

(Refer to FIG. 1 and 2)

FOR SAFETY: Before leaving or servicing machine, stop on level surface and set parking brake. Then turn off machine and remove key.

1. Disconnect battery cables from machine.



WARNING: Always disconnect battery cables from machine before working on electrical components.

INSTALLATION:

(Refer to FIG. 1 and 2)

1. Remove left side machine cover panel.
2. Remove hopper from rear of machine.
3. Lower filter to access controller box mounting hardware.
4. Locate wire connections on controller box.
5. Make note of current harness connections and wire connections on controller box.

NOTE: Mount wires on the new controller box in the same orientation as old controller. Improper wire connections could damage the new controller box.

6. Unplug wire harness connection and disconnect wires from controller box.
7. Remove mounting hardware and set controller box aside.
8. Mount new controller box (1) with pan screws (2) and lock nuts (3). (Refer to FIG. 1 and 2)

9. Mount wire harness connection to controller box (1) with controller wire harness (4).
(Refer to FIG. 1 and 2)
10. Mount wire connections to new controller box (1) in same orientation as previous controller box. (Refer to FIG. 2)
11. Close air filter and replace hopper.
12. Replace side panel.
13. Start machine and check for proper machine operation.

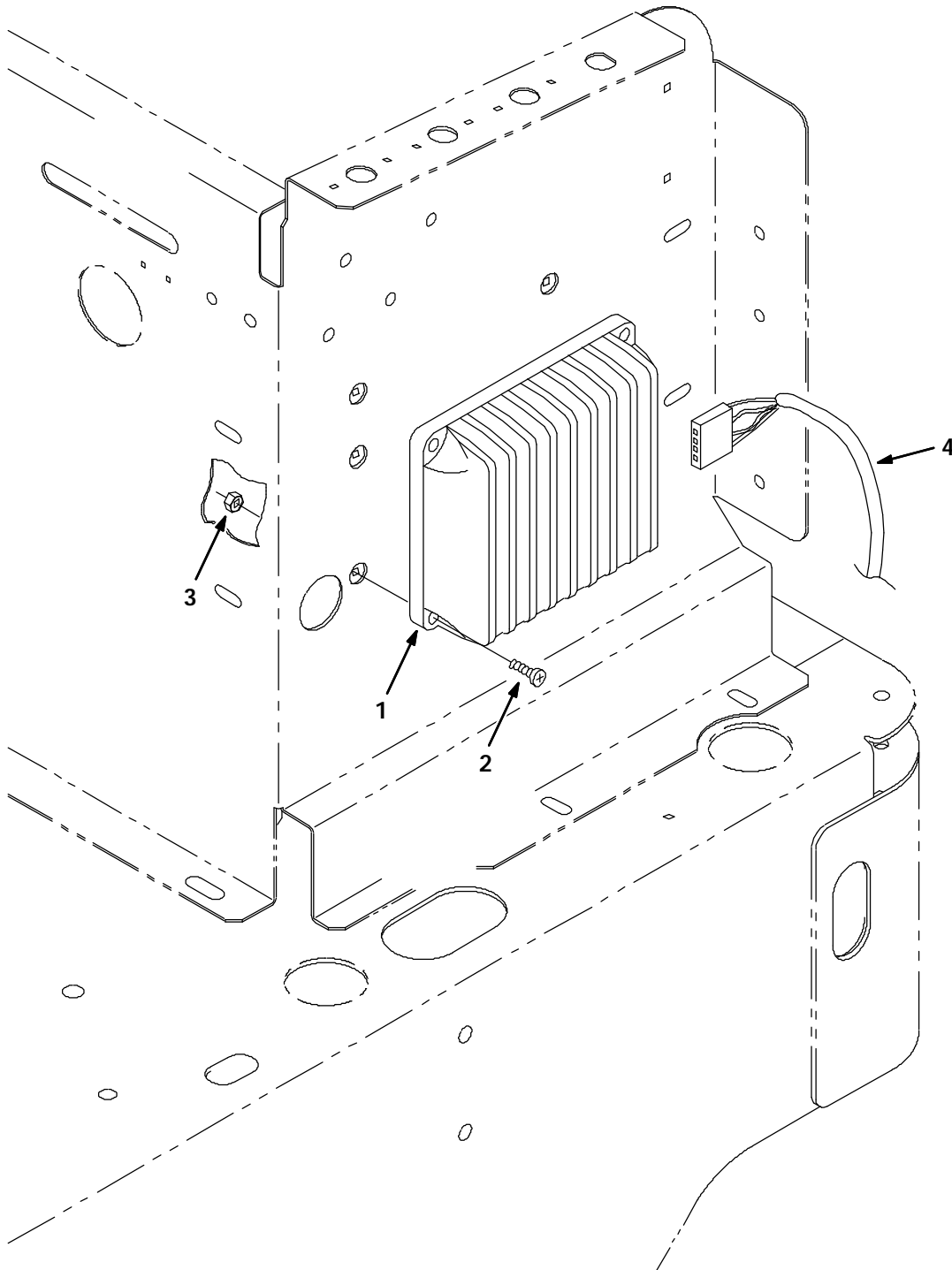

FIG. 1 - HEAVY DUTY CONTROLLER INSTALLATION

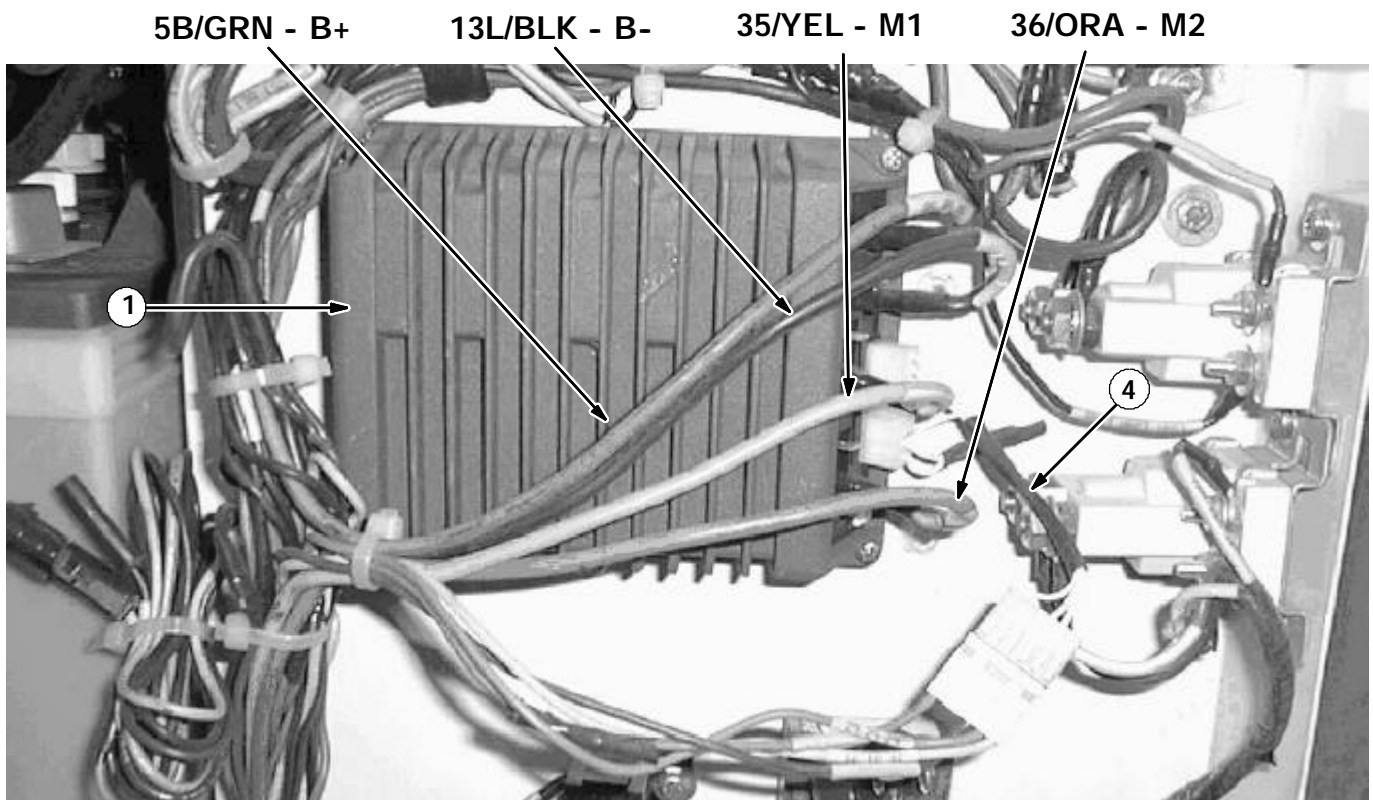

FIG. 2 - CONTROLLER WIRING INSTALLATION

BILL OF MATERIALS FOR HEAVY DUTY CONTROLLER KIT 83188

Ref.	TENNANT Part No.	Description	Qty.
1	81931	Controller, propel	1
2	06927	Scr, pan M4 X .7	4
3	02850	Nut, hxlocnyln M4 X .7	4
4	81932	Harness, wire, controller	1

TENNANT COMPANY
P. O. Box 1452
Minneapolis, MN 55440-1452