



INSTRUCTION BULLETIN

No. 340162
Machine: 6100
Published: 1-99/00
System: OPTIONS

NOTE: DO NOT DISCARD the Parts List from the Instruction Bulletin. Place the Parts List in the appropriate place in your machine manual for future reference. Retaining the Parts List will make it easier to reorder individual parts and will save you the cost of ordering an entire kit.

NOTE: Numbers in parenthesis () are reference numbers for parts listed in Bill of Materials.

Installation instructions for kit number 83267

SYNOPSIS / PROBLEM:

This kit contains the parts needed to install a seat belt kit on the model 6100 sweeper. Please follow step-by-step instructions.

SPECIAL TOOLS / CONSIDERATIONS: NONE

(Estimated time to complete: 1 hour)

PREPARATION:

(Refer to FIG. 1)

FOR SAFETY: Before leaving or servicing machine, stop on level surface and set parking brake. Then turn off machine and remove key.

INSTALLATION:

(Refer to FIG. 1)

1. Lift operator seat.
2. Mount seat belt (1) to the rear wall of battery/engine compartment with screws (2), washers (3) and nuts (4). (Refer to FIG. 1)
3. Lower operator seat.
4. Check seat belt adjustment for proper fit.

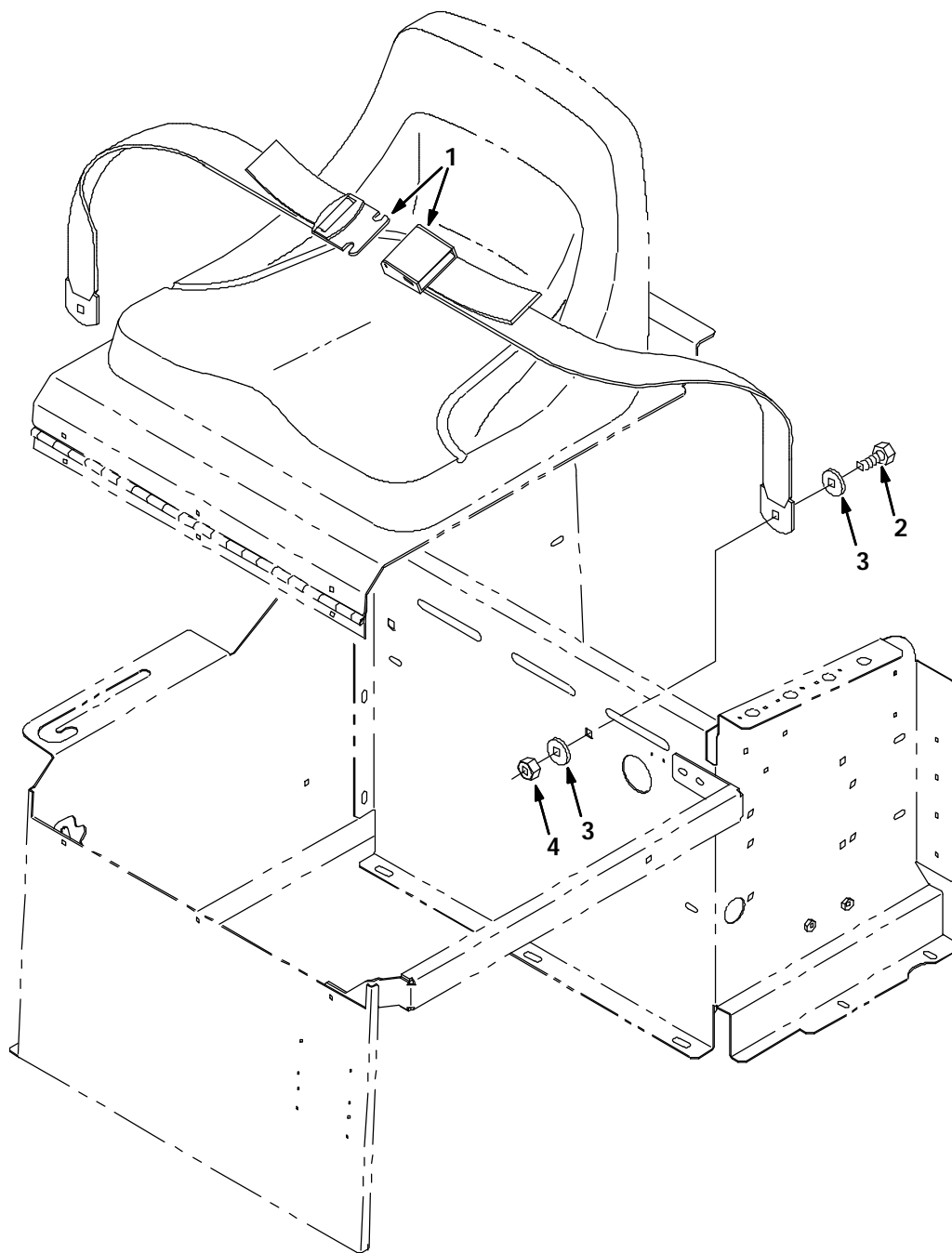

FIG. 1 - SEAT BELT KIT INSTALLATION
BILL OF MATERIALS FOR SEAT BELT KIT 83267

Ref.	TENNANT Part No.	Description	Qty.
1	30533	Seat belt	1
2	41345	Screw, hex M12 X 1.75	2
3	32486	Washer, flat	4
4	08711	Nut, Hxlocnyln M12 X 1.75	2

TENNANT COMPANY
P. O. Box 1452
Minneapolis, MN 55440-1452