



INSTRUCTION BULLETIN

No. 340161
Machine: 6100
Published: 2-99/00
System: OPTIONS

NOTE: DO NOT DISCARD the Parts List from the Instruction Bulletin. Place the Parts List in the appropriate place in your machine manual for future reference. Retaining the Parts List will make it easier to reorder individual parts and will save you the cost of ordering an entire kit.

NOTE: Numbers in parenthesis () are reference numbers for parts listed in Bill of Materials.

Installation instructions for kit number 83194

SYNOPSIS / PROBLEM:

This kit contains the parts needed to install seat slides kit on the model 6100 sweeper.
Please follow step-by-step instructions.

SPECIAL TOOLS / CONSIDERATIONS: NONE

(Estimated time to complete: 1 hour)

PREPARATION:

(Refer to FIG. 1)

FOR SAFETY: Before leaving or servicing machine, stop on level surface and set parking brake. Then turn off machine and remove key.

INSTALLATION:

(Refer to FIG. 1)

1. Raise seat plate assembly and allow to lock in upraised position.
2. Remove seat mounting screws and washers.
3. Mount seat slides (1, 2) to seat with pan screws (4) and washers (3). (Refer to FIG. 1)
4. Install seat with new seat slides (1,2) to seat plate assembly with washers (6) and lock nuts (5). (Refer to FIG. 1)
5. Lower seat plate assembly and check seat slides for proper operation.

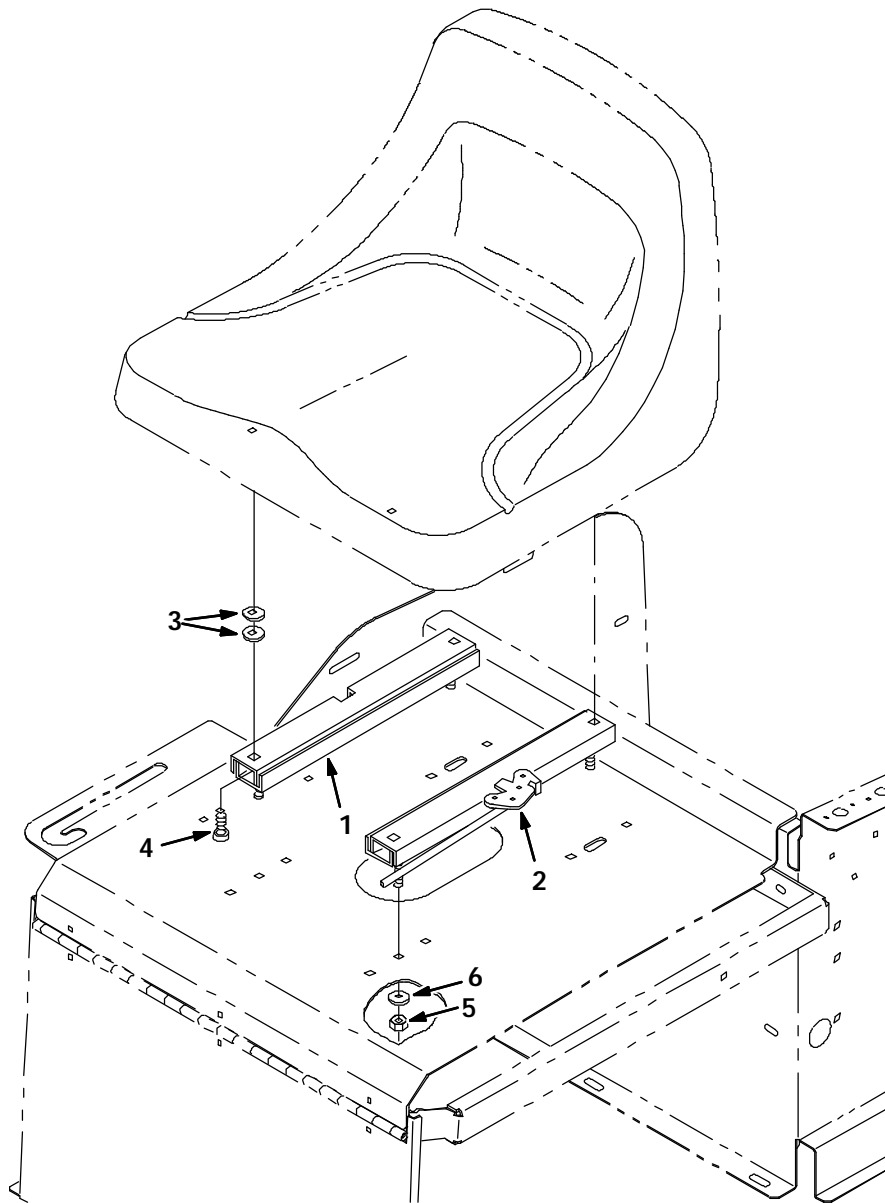

FIG. 1 - SEAT SLIDES KIT INSTALLATION

BILL OF MATERIALS FOR SEAT SLIDES KIT 83194

Ref.	TENNANT Part No.	Description	Qty.
1	360369	Rail	1
2	360370	Rail	1
3	69461	Washer	8
4	25537	Screw, Pan, .31 - 18 X 0.75, G1	4
5	32983	Nut, hex, loc, .31 - 18, NI	4
6	32491	Washer, flat, .31 hard	4

TENNANT COMPANY
P. O. Box 1452
Minneapolis, MN 55440-1452