



INSTRUCTION BULLETIN

No. 340126
Machine: 480EE
Published: 2-98/00
System: SCRUBBING

NOTE: DO NOT DISCARD the Parts List from the Instruction Bulletin. Place the Parts List in the appropriate place in your machine manual for future reference. Retaining the Parts List will make it easier to reorder individual parts and will save you the cost of ordering an entire kit.

NOTE: Numbers in parenthesis () are reference numbers for parts listed in Bill of Materials.

Installation instructions for kit number 374067

SYNOPSIS / PROBLEM:

This kit contains the parts needed to replace the vacuum fan on the model 480EE scrubber. Please follow step-by-step instructions.

SPECIAL TOOLS / CONSIDERATIONS: None

(Estimated time to complete: 2 hours)

PREPARATION:

1. Start the machine and lower the scrub head. Shut off the key.

FOR SAFETY: Before leaving or servicing machine, stop on level surface and set parking brake. Then turn off machine and remove key.

2. Open the machine cover.
3. Disconnect battery cables from machine. Disconnect the vacuum fan motor from the main harness.
4. Remove the vacuum fan belt cover.
5. Remove the top pin from the lift actuator where it attaches to the vacuum fan mount bracket.



WARNING: Always disconnect battery cables from machine before working on electrical components.

DISASSEMBLE:

(Refer to FIG. 1)

1. Remove the four hex screws holding the vacuum fan/motor assembly bracket to the machine. (Refer to FIG. 1)
2. Remove the vacuum fan/motor assembly mount bracket from the machine. (Refer to FIG. 1)
3. Pull on the vacuum fan idler pulley and remove the V-belt from the sheaves. (Refer to FIG. 1)
4. Loosen the set screws holding the vacuum fan sheave to the shaft. Remove the sheave and square key. (Refer to FIG. 1)
5. Remove the three hex screws holding the vacuum fan assembly to the mount bracket. (Refer to FIG. 1)
6. Discard the vacuum fan assembly and sheave. (Refer to FIG. 1)

REASSEMBLE:

(Refer to FIG. 1)

1. Position the vacuum fan seal (7) onto the bottom of the new vacuum fan assembly (1).
(Refer to FIG. 1)
2. Install the adaptor plate (3) on the top of the vacuum fan assembly (1). Line up the holes and install the four flat screws (4). Tighten to 18 - 24 Nm (15 - 20 ft. lb). (Refer to FIG. 1)
3. Position the new vacuum fan assembly on the mount bracket. Line up the holes in the vacuum fan adaptor plate (3) with the mount holes in the mount bracket. Install the three hex screws (5). Tighten to 18 - 24 Nm (15 - 20 ft. lb). (Refer to FIG. 1)
4. Install the new sheave (2), hex key, flat washer, star washer, and hex nut on the new vacuum fan (1) shaft. Tighten the hex nut tight. (Refer to FIG. 1)
5. Pull back on the idler pulley bracket. Place the V-belt over the new sheave (2). Release the idler bracket. (Refer to FIG. 1)
6. Check the alignment of the V-belt across the new sheave (2), idler sheave, and motor sheave. If the V-belt is not in alignment--loosen the set screws on the motor sheave and move it up or down on the shaft until the V-belt is aligned across all three sheaves. Retighten the set screws on the motor sheave. (Refer to FIG. 1)
7. Position the vacuum fan/motor assembly mount bracket back in the machine. Make sure to align the duct weldment with the vacuum fan seal and vacuum hose. (Refer to FIG. 1)
8. Before the hardware holding the vacuum fan/motor mount bracket is reinstalled--check the space between the mount bracket legs and the machine frame. There should be approximately 1/16 of an inch in order to properly compress the vacuum seal (7). If there is **more** than 1/16 inch--add as many flat washers (6) as needed, under the legs, to fill the space. If there is **less** than 1/16 inch of space--add washers (6) under the mount bracket (between the bracket and fan adaptor plate). (Refer to FIG. 1)
9. Reconnect the vacuum fan motor to the main electrical harness. (Refer to FIG. 1)
10. Reinstall the clevis pin in the top of the lift actuator. (Refer to FIG. 1)
11. Reconnect the batteries. Operate the vacuum fan and check for proper operation of the V-belt and new fan.
12. Reinstall the vacuum fan belt cover. Close the cover.

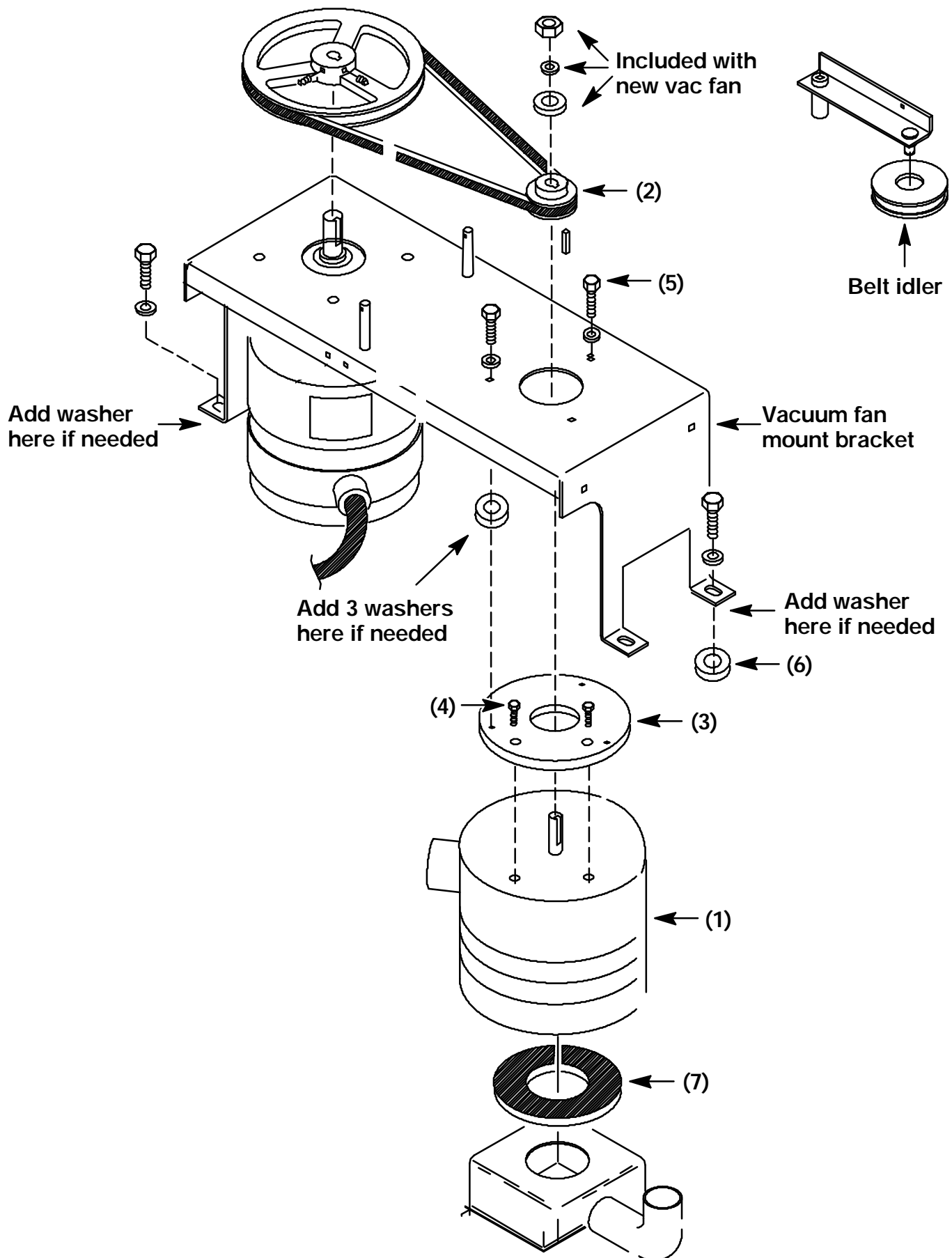

FIG. 1 - New Vacuum Fan Assembly

BILL OF MATERIALS FOR VACUUM FAN KIT 374067

Ref.	TENNANT Part No.	Description	Qty.
1	374068	Vacuum fan assembly	1
2	374069	Vacuum fan sheave	1
3	374070	Adaptor plate	1
4	16879	M6 flat screw	4
5	27993	1/4 - 20 x 1/2 in hex screw	3
6	32493	1/2 in flat washer	12
7	10912	Vacuum fan seal	1

TENNANT COMPANY
P. O. Box 1452
Minneapolis, MN 55440-1452