



INSTRUCTION BULLETIN

No. 340123
Machine: 6080
Published: 2-98/00
System: CHASSIS

NOTE: DO NOT DISCARD the Parts List from the Instruction Bulletin. Place the Parts List in the appropriate place in your machine manual for future reference. Retaining the Parts List will make it easier to reorder individual parts and will save you the cost of ordering an entire kit.

NOTE: Numbers in parenthesis () are reference numbers for parts listed in Bill of Materials.

Installation instructions for kit number 379007

SYNOPSIS / PROBLEM:

This kit contains the parts needed to replace the static drag chain on the model 6080sweeper. This new steel chain replaces the factory installed chain.

Please follow step-by-step instructions.

SPECIAL TOOLS / CONSIDERATIONS: None

(Estimated time to complete: .5 hour)

INSTALLATION:

(Refer to FIG. 1)

1. Remove the existing static chain and attachment hardware. Discard all of the parts.
(Refer to FIG. 1)
2. Install the new chain (1) using the hex screw (2), flat washers (3), lock washer (4), and nyloc nut (5). (Refer to FIG. 1)

BILL OF MATERIALS FOR STATIC CHAIN REPLACEMENT KIT 379007

Ref.	TENNANT Part No.	Description	Qty.
1	46307	Static chain	1
2	06943	M6 screw, 20mm	1
3	32490	Flat washer	2
4	41141	Lock washer	1
5	08708	M6 nyloc nut	1

TENNANT COMPANY
P. O. Box 1452
Minneapolis, MN 55440-1452

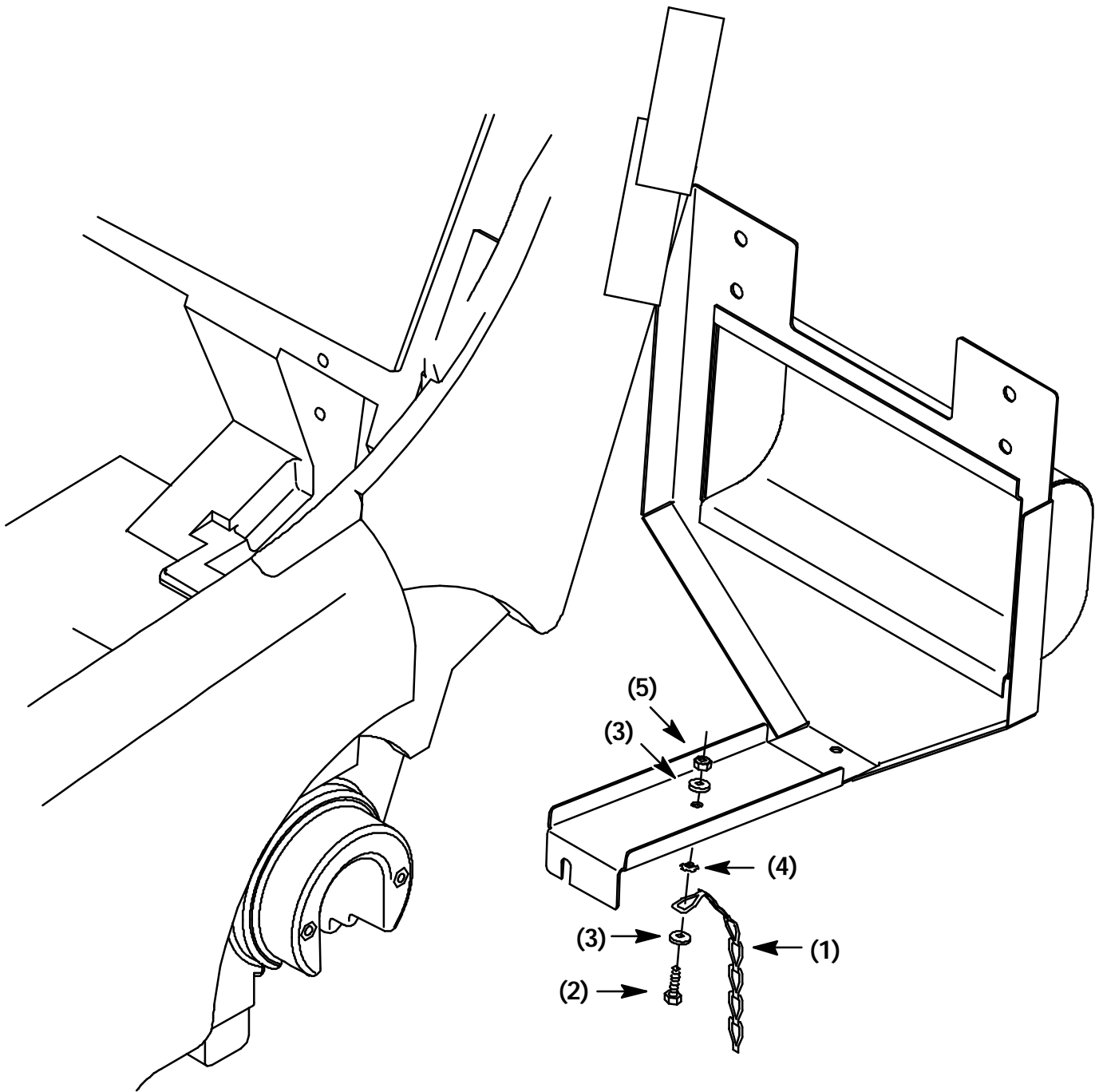

FIG. 1 - Chain And Hardware Assembly